

09G (TF-60SN), 09K (TF-61SN), 09M (TF-62SN)

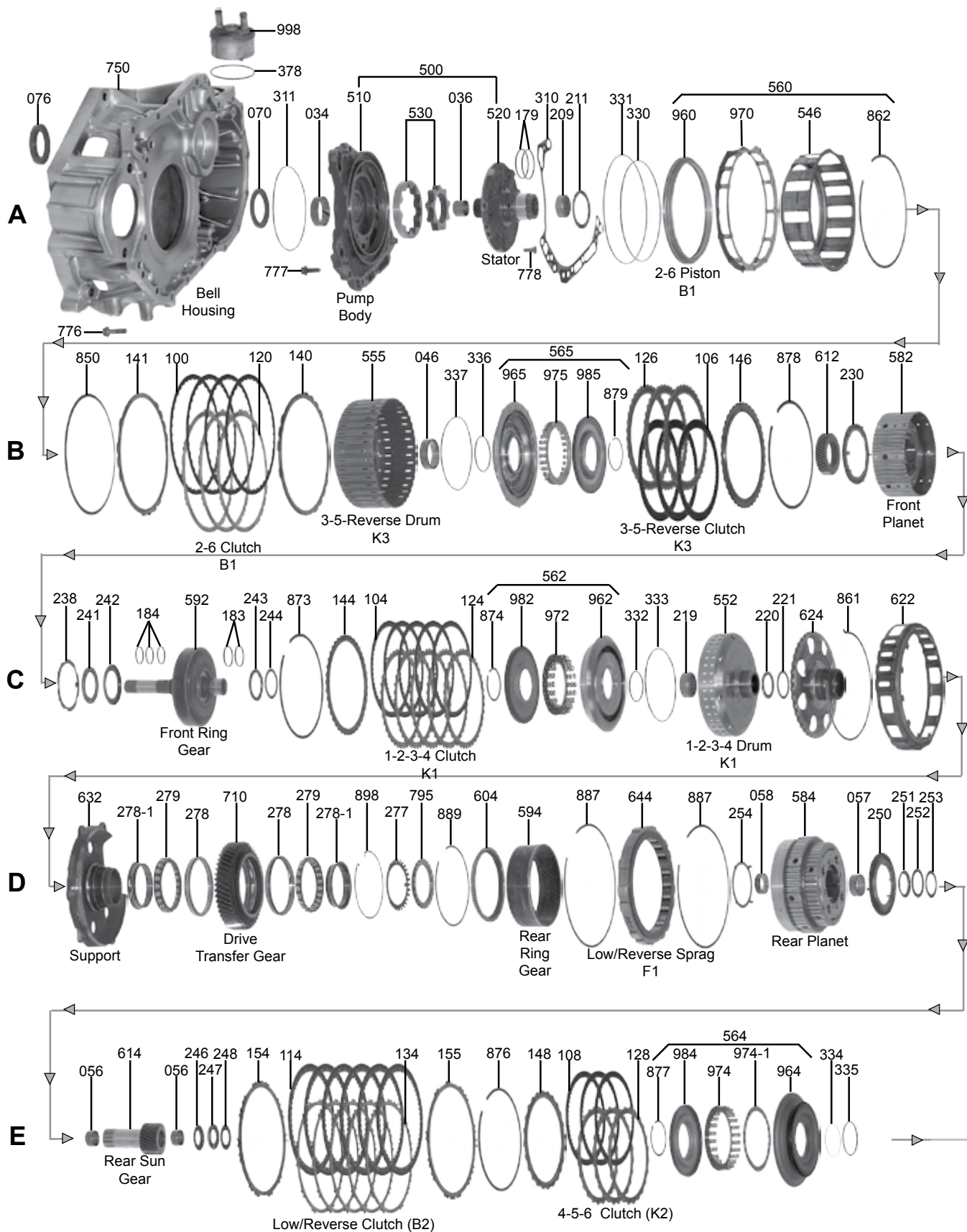

09G (TF-60SN), 09K (TF-61SN), 09M (TF-62SN)

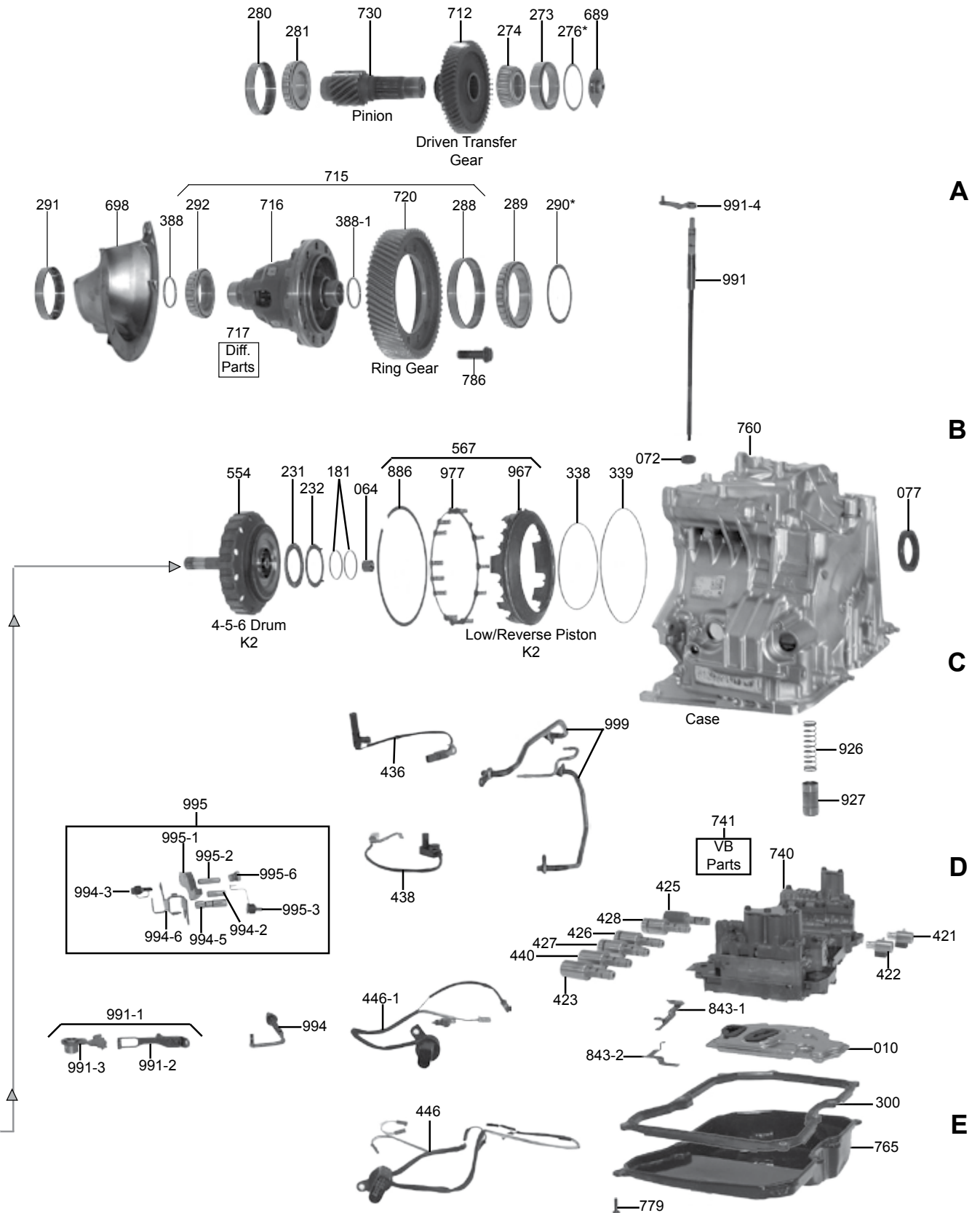

09G (TF-60SN), 09K (TF-61SN), 09M (TF-62SN)

ILL#	Part#		QTY	REF#
OVERHAUL KITS & PISTON KITS				
NI.....	K133900.....	Overhaul Kit, 09G/09K/09M (Combo) W/ Pistons, 2003-Up.....	1.....	N/A
NI.....	K133900X.....	Overhaul Kit, 09G/09K/09M (Combo) W/Out Pistons, 2003-Up.....	1.....	N/A
NI.....	K133900A.....	Overhaul Kit, 09G W/ Pistons, 2003-Up.....	1.....	N/A
NI.....	K133900AX.....	Overhaul Kit, 09G W/Out Pistons, 2003-Up.....	1.....	N/A
NI.....	K133900B.....	Overhaul Kit, 09K W/ Pistons, 2004-Up.....	1.....	N/A
NI.....	K133900BX.....	Overhaul Kit, 09K W/Out Pistons, 2004-Up.....	1.....	N/A
NI.....	K133900C.....	Overhaul Kit, 09M W/ Pistons, 2006-Up.....	1.....	N/A
NI.....	K133900CX.....	Overhaul Kit, 09M W/Out Pistons, 2006-Up.....	1.....	N/A
NI.....	K133900-99.....	Piston Kit, 09G/09K/09M 4 Pistons, 2003-Up.....	1.....	N/A
MASTER L/STEEL KITS				
NI.....	DK13300S.....	Master L/Steels Kit, 09G (W/ .066" K1 Frict) W/ Pistons, 2003-Up.....	1.....	N/A
NI.....	DK13300XS.....	Master L/Steels Kit, 09G (W/ .066" K1 Frict) W/Out Pistons, 2003-Up.....	1.....	N/A
NI.....	DK13300AS.....	Master L/Steels Kit, 09G (W/ .058" K1 Frict) W/ Pistons, 2005-Up.....	1.....	N/A
NI.....	DK13300BS.....	Master L/Steels Kit, 09K W/ Pistons, 2003-Up.....	1.....	N/A
NI.....	DK13300CS.....	Master L/Steels Kit, 09M W/ Pistons, 2006-Up.....	1.....	N/A
MASTER W/STEELS KITS				
NI.....	DK13300.....	Master W/Steels Kit, 09G (W/ .066" K1 Frict) W/ Pistons, 2003-Up.....	1.....	N/A
NI.....	DK13300X.....	Master W/Steels Kit, 09G (W/ .066" K1 Frict) W/Out Pistons, 2003-Up.....	1.....	N/A
NI.....	DK13300A.....	Master W/Steels Kit, 09G (W/ .058" K1 Frict) W/ Pistons, 2005-Up.....	1.....	N/A
NI.....	DK13300B.....	Master W/Steels Kit, 09K W/ Pistons, 2003-Up.....	1.....	N/A
NI.....	DK13300C.....	Master W/Steels Kit, 09M W/ Pistons, 2006-Up.....	1.....	N/A
FILTERS				
010.....	133710.....	Filter, 09G (AWTF60-SN) "Shallow" Pan Narrow, Flush, Intake, 2003-Up.....	1.....	09G-325-429
010.....	133710B.....	Filter, 09G (AWTF60-SN) "Deep" Pan Wide Raised Intake, 2003-Up.....	1.....	09G-325-429A
010.....	133710A.....	Filter, 09K (AWTF61-SN) 2004-Up.....	1.....	09K-325-429
010.....	133710C.....	Filter, 09M (AWTF62-SN) 2006-Up.....	1.....	PI# 79575V
010.....	133710D.....	Filter, 09G (AWTF60-SN) Mini Cooper, Shallow Pick-Up, 2005-Up.....	1.....	2434-7-566-358
010.....	133710E.....	Filter, 09G (AWTF60-SN) Mini Cooper, Deep Pick-Up, 2005-Up.....	1.....	2434-7-551-087
BUSHINGS				
NI.....	K133901.....	Bushing Kit, 2003-Up.....	1.....	TBA
034.....	133005.....	Bushing, Pump, 2003-Up.....	1.....	TBA
036.....	133002.....	Bushing, Stator, 2003-Up.....	1.....	TBA
046.....	133006.....	Bushing, K3 Drum, 2003-Up.....	1.....	TBA
056.....	133017.....	Bushing, Forward Sun Gear, 2003-Up.....	2.....	TBA
057.....	133015A.....	Bushing, Rear Planet, Rear, 2003-Up.....	1.....	TBA
058.....	133015.....	Bushing, Rear Planet, Front, 2003-Up.....	1.....	TBA
062.....	133000.....	Bushing, Case / K2 Drum, 2003-Up.....	1.....	TBA
062.....	133000X.....	Bushing, Case / K2 Drum, Oversized Repair, 2003-Up, Requires T90330 Tool (Omega).....	1.....	90448A
062.....	T90330.....	Reaming Tool For Oversized Case Bushings, Includes 3ea 133000X Bushings (Omega).....	1.....	90330
NI.....	59024.....	Bushing, Linear Solenoid Inductor Hsg (2ea Per Sol) See Tools At End Of Electrical.....	2.....	55526
METAL CLAD SEALS				
070.....	133151.....	Seal, Pump, 09G (AWTF60-SN) 2003-Up.....	1.....	09G-321-243
072.....	78197.....	Seal, Manual Shaft, 09G (AWTF60-SN) 2003-Up.....	1.....	TBA
076.....	59152.....	Seal, Axle (Both) 09G (AWTF60-SN) 2003-Up.....	2.....	TBA
076.....	133153A.....	Seal, Axle (Both) 09K (AWTF60-SN) 2003-Up.....	2.....	TBA
NI.....	133160.....	Seal, Case Halves, 09G (AWTF60-SN) 2003-Up.....	3.....	TBA
FRICTIONS				
100.....	133103.....	Friction, B1 (2-6) .066", 40T, 7.245" OD, Hi-Energy, 2003-Up.....	4.....	TBA
104.....	133107.....	Friction, K1 (1-2-3-4) .066", 56T, 5.790" OD, 2003-Up.....	5.....	TBA
104.....	133107A.....	Friction, K1 (1-2-3-4) .058", 56T, 5.790" OD, 2005-Up.....	5.....	TBA
106.....	133111.....	Friction, 09G/09K K3 (3-5/Rev) .066", 56T, 6.180" OD, 2003-Up.....	6.....	TBA
106.....	133111A.....	Friction, 09M K3 (3-5/Rev) .059", 56T, 6.180" OD, 2003-Up.....	6.....	TBA
108.....	133109.....	Friction, 09G K2 (4-5-6) .066", 55T, 5.725" OD, 2003-Up.....	3.....	512567
108.....	133109A.....	Friction, 09K K2 (4-5-6) .066", 60T, 5.722" OD, 2003-Up.....	6.....	512658
108.....	133109B.....	Friction, 09M K2 (4-5-6) .058", 60T, 5.722" OD, 2004-Up.....	4.....	512659
108.....	133109C.....	Friction, 09M K2 (4-5-6) .058", 60T, 4.969" OD, 2004-Up.....	6.....	R572754
114.....	133105.....	Friction, 09G B2 (Low/Reverse) .067", 56T, 6.716" OD, 2003-Up.....	6.....	TBA
114.....	133105A.....	Friction, 09M B2 (Low/Reverse) .060", 56T, 6.716" OD, 2003-Up.....	6.....	TBA
NI.....	K133F.....	Friction Module, 09G, 1.8L & 1.9L, 2003-Up.....	1.....	RCP96-201
NI.....	K133AF.....	Friction Module, 09G, 2.0L & 2.5L, 2003-Up.....	1.....	RCP96-219
NI.....	K133BF.....	Friction Module, 09M, 3.6L, 2004-Up.....	1.....	RCP96-244

09G (TF-60SN), 09K (TF-61SN), 09M (TF-62SN)

ILL#	Part#		QTY	REF#
NI	K133BAF	Friction Module, 09M, 3.6L (W/ 60T 5.725" OD K2 4-5-6 Fric) 2004-Up	1	FRMAISIN15
STEELS				
120	133102	Steel, B1 (2-6) .072", 12T, 6.611" ID, 2003-Up	3	TBA
124	133106	Steel, K1 (1-2-3-4) .070", 40T, 5.148" ID, 2003-Up	5	TBA
126	133110	Steel, K3 (3-5/Rev) .071", 40T, 5.149" ID, 2003-Up	3	TBA
128	133108	Steel, K2 (4-5-6) .071", 24T, 5.000" ID, 2003-Up	3	TBA
134	133104	Steel, B2 (Low/Reverse) .072", 14T, 6.220" ID, 2003-Up	5	TBA
NI	K133S	Steel Module, 09G (AWTF60-SN) 2003-Up	1	TBA
PRESSURE PLATES				
140	133131	Pressure Plate, B1 (2-6) .091", 12T, 6.611" ID, 2003-Up	1	TBA
141	133132	Apply Plate, 09G 2-6 Clutch (B1) (.091") (12 Teeth) (6 1/2" ID) 2003-Up	1	TBA
144	133133	Pressure Plate, 09G 1-2-3-4 Clutch (K1) Selective (40 Teeth) (5.144" ID) 2003-Up	1	TBA
146	133134	Pressure Plate, 09G 3-5 Reverse Clutch (K3) Selective (40 Teeth) (5.153" ID) 2003-Up	1	TBA
148	133135	Pressure Plate, 09G 4-5-6 Clutch (K2) (.114") (24 Teeth) (4.995" ID) 2003-Up	1	TBA
154	133136	Pressure Plate, 09G Low/Reverse Clutch (B2) Selective (14 Teeth) (6 1/8" ID) 2003-Up	1	TBA
155	133137	Apply Plate, 09G Low/Reverse Clutch (B2) (.118") (14 Teeth) (6 1/8" ID) 2003-Up	1	TBA
VALVE BODY KITS				
165	K133908	Valve Body Kit, 2003-Up (Transgo)	1	SK-09G
SEALING RINGS				
175	K133903	Ring Kit, 2003-Up	1	TBA
WASHERS & BEARINGS				
209	133401	Caged Needle Bearing, 09G Stator (Rear) (.480" Wide) (1.225" OD) (34 Needles) 2003-Up	1	TBA
211	133402	Washer, 09G Stator To 3-5 Reverse (K3) Drum (.047" Thick) (2.280" OD) (1 Tab, Plastic) 2003-Up	1	TBA
219	133403	Caged Needle Bearing, 09G 1-2-3-4 Clutch (K1) Drum (Inner) (1.233" OD) (34 Needles) 2003-Up	1	TBA
220	133404	Bearing W/Race, 09G 1-2-3-4 Clutch (K1) To Rear Planet (.110" Thick) (1.644" OD) (1.176" ID) 2003-Up	1	TBA
221	133405	Race, 09G 1-2-3-4 Clutch (K1) Drum To Rear Planet (.059" Thick) (1.707" OD) (1.288" ID) 2003-Up	1	TBA
230	133406	Washer, 09G 3-5 Rev/(K3) Drum To Front Planet (.130" Thk) (3.630" OD) (2.720" ID) (5-Leg, 1-Tab, Plastic)	1	TBA
231	133407	Bearing W/Race, 09G 4-5-6 Clutch (K2) Drum To Case (.153" Thick) (2.665" OD) (1.877" ID) 2003-Up	1	TBA
232	133408	Race, 09G 4-5-6 Clutch (K2) Drum To Case (.031" Thick) (2.626" OD) (1.955" ID) 2003-Up	1	TBA
238	133409	Washer, 09G Front Planet To Ring Gear (.047" Thick) (3.100" OD) (2.595" ID) (3 Tab) (Plastic)	1	TBA
241	133410	Bearing W/Race, 09G Front Planet Sun Gear To Ring Gear (.129" Thick) (2.204" OD) (1.493" ID)	1	TBA
242	133411	Race, 09G Front Planet Sun Gear To Ring Gear (Cupped) (2.467" OD) (1.617" ID)	1	TBA
243	133412	Brg W/Race, 09G Front Planet Ring Gear To 1-2-3-4/(K1) Drum (.110" Thk) (1.926" OD) (1.414" ID)	1	TBA
244	133413	Race, 09G Front Planet Ring Gear To 1-2-3-4 Clu (K1) Drum (.059" Thick) (1.803" OD) (1.370" ID)	1	TBA
246	133414	Race, 09G Rear Planet Rear Sun Gear To 4-5-6/(K2) Drum (.031" Thick) (1.517" OD) (.885" ID)	1	TBA
247	133415	Bearing, 09G Rear Planet Rear Sun Gear To 4-5-6/(K2) Drum (.137" Thick) (1.515" OD) (.823" ID)	1	TBA
248	133416	Race, 09G Rear Planet Rear Sun Gear To 4-5-6/(K2) Drum (.031" Thick) (1.635" OD) (.829" ID)	1	TBA
250	133417	Washer, 09G Rear Planet To 4-5-6 Clutch (K2) Drum (.110" Thick) (3.740" OD) (8 Tabs) (Plastic)	1	TBA
251	133418	Race, 09G Rear Planet Front Sun Gear To Rear Sun Gear (.030" Thk) (1.635" OD) (1.237" ID)	1	TBA
252	133419	Bearing, 09G Rear Planet Front Sun Gear To Rear Sun Gear (.078" Thick) (1.700" OD) (1.252" ID)	1	TBA
253	133420	Race, 09G Rear Planet Front Sun Gear To Rear Sun Gear (.030" Thick) (1.635" OD) (1.179" ID) Flat	1	TBA
254	133421	Washer, 09G Transfer Nut To Rear Planet (.047" Thick) (2.782" OD) (2.360" ID) (4 Tabs) 2003-Up	1	TBA
273	133422	Cup Race, 09G Pinion Shaft To Case (.747" Thick) (2.833" OD) (Cast # 32207J) 2003-Up	1	TBA
274	133423	Cone Bearing, 09G Pinion Shaft To Case (.912" Thick) (1.284" ID) (Cast # R32Z-4) 2003-Up	1	TBA
276	133424	Shim, 09G Pinion Shaft To Case (Selective) (2.803" OD) (2.381" ID) 2003-Up	1	TBA
277	133425	Lock Washer, 09G Under Retaining Nut (1 Inner Tab, 29 Outer Tabs) 2003-Up	1	TBA
278-1	133426	Cup Race, 09G Drive Transfer Gear Inner Race (.488" Thick) (2.436" ID) 2003-Up	2	TBA
278	133427	Cup Race, 09G Drive Transfer Gear Outer Race (.368" Thick) (3.597" OD) 2003-Up	2	TBA
279	133428	Ball Bearing, 09G Drive Transfer Gear (W/Plastic Cage) (22 Balls) 2003-Up	2	TBA
280	133429	Cup Race, 09G Pinion Shaft To Bell Housing (.647" Thick) (3.149" OD) (Cast # R39-4A) 2003-Up	1	TBA
281	133430	Cone Bearing, 09G Pinion Shaft To Bell Housing (.745" Thick) (1.536" ID) (Cast # R39-4) 2003-Up	1	TBA
288	133431	Cup Race, 09G Differential To Case (.634" Thick) (4.250" OD) 2003-Up	1	TBA
289	133432	Cone Bearing, 09G Differential To Case (.726" Thick) (2.992" ID) (Cast # TR151102) 2003-Up	1	TBA
290	133433	Shim, 09G Differential To Case (Selective) (3.560" OD) (3.005" ID) 2003-Up	1	TBA
291	133434	Cup Race, 09G Differential To Bell Housing (.608" Thick) (3.188" OD) (Cast # STA5181) 2003-Up	1	TBA
292	133435	Cone Bearing, 09G Differential To Bell Housing (2.006" ID) (25 Rollers) 2003-Up	1	TBA
GASKETS & RUBBER COMPONENTS				
300	133500	Gasket, Bottom Pan, 09G, 8-Bolt, 2003-Up	1	TBA
300	133500A	Gasket, Bottom Pan, 09K, 7-Bolt, 2004-Up	1	09K-321-370
300	133500B	Gasket, Bottom Pan, 09M, 9-Bolt, 2006-Up	1	TBA
310	133510	Gasket, Pump (Metal) 2003-Up	1	TBA
311	106274A	O-Ring, Front Pump, 2003-Up	1	TBA

09G (TF-60SN), 09K (TF-61SN), 09M (TF-62SN)

ILL#	Part#		QTY	REF#
NI.....	133526	Gasket, Main Valve Body To Plate 2003-Up.....	1	TBA
NI.....	133527	Gasket, Plate To Valve Body Cover 2003-Up.....	1	TBA
NI.....	133528	Gasket, Large Auxiliary Valve Body Plate To Cover 2003-Up.....	1	TBA
NI.....	133528A	Gasket, Large Auxiliary Valve Body To Plate 2003-Up.....	1	TBA
NI.....	133529	Gasket, Small Auxiliary Valve Body Plate To Cover 2003-Up.....	1	TBA
NI.....	133529A	Gasket, Small Auxiliary Valve Body To Plate 2003-Up.....	1	TBA

TECHNICAL MANUALS

NI.....	TM09G	Technical Manual, 09G / 09K / 09M.....	1	TBA
NI.....	TM09G/TF60SN	Diagnostic Guide, 09G / 09K / 09M.....	1	TBA

ELECTRICAL COMPONENTS

410.....	133991	Switch, MLPS, 2003-Up.....	1	TBA
NI.....	133980	Pressure Switch, 2003-Up.....	2	50-1167
421.....	133954	Solenoid, Shift (N89) On-Off, 2003-Up.....	1	52-0933
422.....	133954	Solenoid, Shift (N88) On-Off, 2003-Up.....	1	52-0933
423.....	133952	K3 (3-5/Rev) Clutch Linear Shift Control Solenoid (Green Connector) 2003-Up.....	1	52-0489
425.....	133951	TCC Linear Solenoid (N91) (Black Connector) 2003-Up.....	1	52-0488
426.....	133952	K1 (1-2-3-4) Clutch Linear Shift Control (Green Connector) 2003-Up.....	1	52-0489
427.....	133952	K2 (4-5-6) Clutch Linear Shift Control (Green Connector) 2003-Up.....	1	52-0489
428.....	133952	EPC Linear Solenoid (N93) (Green Connector) 2003-Up.....	1	52-0489
440.....	133952	B1 (2-6) Clutch, Band Linear Shift Control Solenoid (Green Connector) 2003-Up.....	1	52-0489
NI.....	K133952	Kit, Linear Solenoid, 6-Solenoids (TCC, EPC & 4-Shift) 2003-Up.....	1	TBA
436.....	133954	Output Speed Sensor, 2003-Up.....	1	TBA
438.....	133958	Input Speed Sensor, 2003-Up.....	1	TBA
446.....	K133954	Wire Harness, OSS/ISS Speed & Temp Sensors & VB Press Switches (8-Pin Conn) 2003-04.....	1	09G927363B
446.....	K133954A	Wire Harness, OSS/ISS Speed & Temp Sensors (6-Pin Conn) 2004-Up (Rostra# 350-0149).....	1	09G927363A
446.....	133986	Wire Harness, Internal, 6-Pin, 2003-Up.....	1	TBA
446.....	133986A	Wire Harness, Internal, 8-Pin, 2003-Up.....	1	TBA
446.....	133986B	Wire Harness, Internal, 14-Pin Case Conn, 2003-Up (Rostra# 350-0151).....	1	09G927363
NI.....	59024	Bushing, Linear Solenoid Inductor Hsg (2ea Per Sol) See Tools Below.....	2	55526
NI.....	T31333	Tool, Linear Solenoid Opening & Closing Tool.....	1	31333
NI.....	T551580	Reamer, Solenoid Bushing, May Be Needed To "Size" New Bushing After Installation.....	1	551580

PUMPS & PUMP COMPONENTS

500.....	133912	Pump Assembly, 2003-Up.....	1	TBA
510.....	133916	Pump Body, 2003-Up.....	1	TBA
520.....	133913	Pump Stator, 2003-Up.....	1	TBA
530.....	K133201	Pump Gear Set, 09G (.441" Thick) (10 Outer Gear Lobes)(9 Inner Gear Lobes) 2003-Up.....	1	TBA

DRUMS & PISTON KITS

546.....	133171	Apply Ring, B1 (2-6) Clutch (B1) (Steel) (2.156" Thick)(7 1/4" OD) 2003-Up.....	1	TBA
552.....	133732	Drum, K1 (1-2-3-4) 2003-Up.....	1	TBA
554.....	133735	Drum, K2 (4-5-6) 2003-Up.....	1	TBA
555.....	133734	Drum, K3 (3-5/Rev) 2003-Up.....	1	TBA
560.....	K133762	Piston Kit, B1 (2-6) Clutch (Aluminum) 2003-Up.....	1	TBA
562.....	K133763	Piston Kit, K1 (1-2-3-4) Clutch (With Steel Piston & Bonded Retainer) 2003-Up.....	1	TBA
564.....	K133764	Piston Kit, K2 (4-5-6) Clutch (W/Bonded Piston & Retainer) 2003-Up.....	1	TBA
565.....	K133765	Piston Kit, K3 (3-5 Rev) Clutch (Steel Piston)(Bonded Retainer) 2003-Up.....	1	TBA
567.....	K133766	Piston Kit, B2 (Low/Rev) Clutch (B2)(Aluminum Piston Cast # F010) 2003-Up.....	1	TBA

PLANETS, RING GEARS, SUN GEARS, HOUSINGS & HUBS

582.....	133747	Planet, Front, 2003-Up.....	1	TBA
584.....	133748	Planet, Rear, 2003-Up.....	1	TBA
592.....	133757	Ring Gear, Front Planet W/Input Shaft (81 Teeth Ring Gear) 2003-Up.....	1	TBA
594.....	133758	Ring Gear, Rear Planet (78 Teeth)(1.465" Thick) 2003-Up.....	1	TBA
604.....	133741	Hub, Rear Planet Ring Gear (.396" Thick)(4.494" OD) 2003-Up.....	1	TBA
612.....	133753	Sun Gear, Front Planet (45 Teeth)(.577" Thick)(2.485" OD) 2003-Up.....	1	TBA
614.....	133755	Sun Gear, Rear Planet (Rear)(30 Teeth, 1 Groove)(3.530" Long) 2003-Up.....	1	TBA
622.....	133736	Housing, B1 (2-6) Clutch (Steel)(A Snap Ring Holds This To The Center Support) 2003-Up.....	1	TBA
624.....	133742	Hub, K3 (3-5 Rev) Clutch, Driving (40 Outer Teeth) 2003-Up.....	1	TBA
632.....	133826	Center Support (6 Bolt, Cast Iron)(Cast # 5317) 2003-Up.....	1	TBA

SPRAGS

644.....	133727	Sprag Assembly Low/Reverse (F1) (20 Rollers)(14 Outer Lugs)(Plastic Cage) 2003-Up.....	1	TBA
----------	--------	--	---	-----

DIFFERENTIALS & COMPONENTS

689.....	133621	Oil Baffle, 09G Pinion Shaft To Case (Tin) 2003-Up.....	1	TBA
689.....	133621A	Oil Baffle, 09G Differential To Bell Housing (Tin, 3 Bolt) 2003-Up.....	1	TBA

09G (TF-60SN), 09K (TF-61SN), 09M (TF-62SN)

ILL#	Part#		QTY	REF#
712.....	133884	Gear, 09G Driven Transfer (52 Teeth)(With 13 Parking Lugs) 2003-Up.....	1	TBA
715.....	133910	Differential Assembly, 2WD, 2003-Up.....	1	TBA
715.....	133910A	Differential Assembly, AWD, 2003-Up.....	1	TBA
716.....	133911	Differential Housing, 09G Less Ring Gear (Uses A 25 & A 30 Roller Bearing) 2003-Up.....	1	TBA
720.....	133845	Ring Gear, 09G Differential (61 Teeth, 4 Groove)(12 Bolt Holes) 2003-Up.....	1	TBA
730.....	133876	Pinion, 09G (15 Teeth, 4 Groove) (6 1/4" Long) 2003-Up.....	1	TBA
VALVE BODIES				
740.....	133754	Valve Body, 09G (W/2 Press Switches) (Remote Oil Cooler) 2003-6/04.....	1	TBA
740.....	133754B	Valve Body, 09G (W/2 Press Switches) (Oil Cooler On Case) 2003-6/04.....	1	TBA
740.....	133754A	Valve Body, 09G (No Press Switches) (Remote Oil Cooler) 7/04-Up.....	1	TBA
740.....	133754C	Valve Body, 09G (No Press Switches) (Oil Cooler On Case) 7/04-Up.....	1	TBA
VALVE BODY COMPONENTS				
741.....	15741-35K	End Plug Kit (Small, 9mm Plugs)(5 End Plugs & 7 O-Rings) 2003-Up.....	1	15741-35K
741.....	15741-36K	End Plug Kit (Large, 10mm Plugs)(5 End Plugs & 7 O-Rings) 2003-Up.....	1	15741-36K
741.....	15741-29K	Lock-Up Control Valve Kit, (Sleeve, Valve, Spring, Spacer, Plunger Valve, & Plunger Sleeve)..... Must Use T-F-15741-TL29 & T-F-15741-TL29PL & VB-FIX.....	1	15741-29K
741.....	15741-25K	Clutch Control Valve Kit, C1 & K1 (Sleeve, Spring & Valve) (Must Use T-F-15741-TL25 & T-VB-FIX).....	1	15741-25K
741.....	15741-14K	Accumulator Piston Kit, Clutch/Band/Line Accumulator (1-Accum Piston & 1-O-Ring) 2003-Up.....	1	15741-14K
741.....	15741-18K	Valve Kit, Solenoid Modulator (Solenoid Modulator Valve, Solenoid Modulator Sleeve, Spring & Plug)..... Requires: T-F-15741-TL18, T-VB-FIX & T-F-15741-TL29PL If Reaming Upper Valve Body #2.....	1	15741-18K
759.....	15759-01K	Ring Tower Sleeve, 09G (K2 Clutch)(In Rear Of Case) 2003-Up.....	1	15759-01K
CASES & PANS				
750.....	133703	Bell Housing, 09G (Starter At 2:00)(Cast # 09G 321 107 A) 2003-Up.....	1	TBA
760.....	133701	Case, 09G (Cast # 09G 321 105) 2003-Up.....	1	TBA
765.....	133801	Pan, Bottom, 2003-Up.....	1	09G-321-351
SNAP RINGS				
795.....	133081	Nut, Drive Transfer Gear Retaining (.222" Thick)(24 Outer Notches) 2003-Up.....	1	TBA
850.....	133141	Cushion, B1 (2-6 Clutch) (.039" Thick)(7 1/4" OD) 2003-Up.....	1	TBA
861.....	133601	Snap Ring, Holds B1 (2-6) Housing To Center Supp (.038" Thick)(6 1/2" OD) (W/2 Hooked Ends).....	1	TBA
862.....	133602	Snap Ring, Holds B1 (2-6 Clutch) Spring Retainer In (.046" Thick)(6 13/16" OD) 2003-Up.....	1	TBA
873.....	133603	Snap Ring, Holds K1 (1-2-3-4 Clutch) Pressure Plate In Drum (.063" Thick)(6 1/4" OD) 2003-Up.....	1	TBA
874.....	133604	Snap Ring, Holds K1 (1-2-3-4 Clutch) Retainer In Drum (.059" Thick)(2.033" OD) 2003-Up.....	1	TBA
876.....	133605	Snap Ring, Holds K2 (4-5-6) Clutch) Pressure Plate In Drum (.063" Thick)(6 1/8" OD) 2003-Up.....	1	TBA
877.....	133606	Snap Ring, Holds K2 (4-5-6 Clutch) Spring Retainer In (.046" Thick)(2.158" OD) 2003-Up.....	1	TBA
878.....	133607	Snap Ring, Holds K3 (3-5 Reverse Clutch) Pressure Plate In Drum (.062" Thick)(6 1/2" OD) 2003-Up.....	1	TBA
879.....	133608	Snap Ring, Holds K3 (3-5 Reverse Clutch) Spring Retainer In Drum (.057" Thick)(2.025" OD) 2003-Up.....	1	TBA
886.....	133609	Snap Ring, Holds B2 (Low/Rev Clutch) Spring Retainer In Case (.062" Thick)(7 1/16" OD) 2003-Up.....	1	TBA
887.....	133610	Snap Ring, Holds F1 Low/Rev Sprag To Case (.047" Thick)(7 3/8" OD) 2003-Up.....	2	TBA
889.....	133611	Snap Ring, Holds Rear Planet Ring Gear Hub To Ring Gear (.047" Thick)(4.870" OD) 2003-Up.....	1	TBA
898.....	133612	Snap Ring, Drive Transfer Gear (.046" Thick)(4.050" OD) 2003-Up.....	1	TBA
PISTONS, RETAINERS & MISCELLANEOUS				
960.....	133762	Piston, B1 (2-6) Clutch (Aluminum) 2003-Up.....	1	TBA
962.....	133763	Piston, K1/C1 (1-2-3-4) Clutch (Steel) (2003-Up.....	1	TBA
964.....	133764	Piston, K2/C2 (4-5-6) Clutch (Bonded) 2003-Up.....	1	79423
965.....	133765	Piston, K3/C3 (3-5/Rev) Clutch (Steel) 2003-Up.....	1	TBA
967.....	133766	Piston, B2 (Low/Rev) Clutch (Aluminum) 2003-Up.....	1	TBA
982.....	133863	Retainer/Balance Piston, K1/C1 (1-2-3-4) Clutch (Bonded) (.390" Tall) 2003-Up.....	1	79425
982.....	133863A	Retainer/Balance Piston, K1/C1 (1-2-3-4) Clutch (Bonded) (.475" Tall) 2006-Up.....	1	79234
984.....	133864	Retainer/Balance Piston, K2/C2 (4-5-6) Clutch (Bonded) 2003-Up.....	1	79418
985.....	133865	Retainer/Balance Piston, K3/C3 (3-5/Rev) Clutch (Bonded) 2003-Up.....	1	79428
926.....	133281	Spring, B1 Accumulator (Pink) 2003-Up.....	1	TBA
927.....	133998	Piston, B1 Accumulator (1.875" Long)(.944" OD) 2003-Up.....	1	TBA
960.....	133762	Piston, B1 (2-6) Clutch (In Pump Body)(Aluminum)(.532" Thick)(6 3/8" OD) 2003-Up.....	1	TBA
962.....	133763	Piston, K1/C1 (1-2-3-4) Clutch (Steel) (20 Spring Pockets)(5.744" OD) 2003-Up.....	1	TBA
964.....	133764	Piston, K2/C2 (4-5-6) Clutch (Bonded) 2003-Up.....	1	79423
965.....	133765	Piston, K3/C3 (3-5/Rev) Clutch (Steel) (28 Spring Pockets) (10 Outer Teeth) 2003-Up.....	1	TBA
967.....	133766	Piston, B2 (Low/Rev) Clutch (Aluminum) (Cast # F010) 2003-Up.....	1	TBA
970.....	133872	Spring Retainer, B1 (2-6) Clutch Return (12 Springs) (7 1/2" OD) 2003-Up.....	1	TBA
972.....	133873	Spring, K1(1-2-3-4)B Clutch Return (20 Springs)(3.676" OD) 2003-Up.....	1	TBA
974-1	133622	Seat, K2 (4-5-6) Clutch Spring (24 Spring Pockets)(3.925" OD) 2003-Up.....	1	TBA
974.....	133874	Spring, K2 (4-5-6) Clutch Return (24 Springs)(3.898" OD) 2003-Up.....	1	TBA
975.....	133875	Spring, K3 (3-5/Rev) Clutch Return (28 Springs)(3.830" OD) 2003-Up.....	1	TBA
977.....	133877	Spring, B2 (Low/Rev) Clutch Return (13 Springs)(6 3/4" OD) 2003-Up.....	1	TBA

09G (TF-60SN), 09K (TF-61SN), 09M (TF-62SN)

ILL#	Part#		QTY	REF#
982.....	133863	Retainer/Balance Piston, K1/C1 (1-2-3-4) Clutch (Bonded) (.390" Tall) 2003-Up	1	79425
982.....	133863A.....	Retainer/Balance Piston, K1/C1 (1-2-3-4) Clutch (Bonded) (.475" Tall) 2006-Up	1	79234
984.....	133864	Retainer/Balance Piston, K2/C2 (4-5-6) Clutch (Bonded) 2003-Up	1	79418
985.....	133865	Retainer/Balance Piston, K3/C3 (3-5/Rev) Clutch (Bonded) 2003-Up	1	79428
991-1	K133623.....	Linkage Assembly, 09G Internal 2003-Up	1	TBA
991.....	133623	Linkage Rod, 09G (14 1/16" Long) 2003-Up	1	TBA
994.....	133624	Park Pawl Actuator, 09G 2003-Up.....	1	TBA
995.....	K133624.....	Park Pawl Assembly, 09G 2003-Up.....	1	TBA
998.....	133625	Oil Cooler, 09G (Bolts On Top Of Bell Housing)(Cast #09G 409 061) 2003-Up.....	1	TBA
999.....	133626	Tube Set, 09G Lube (3 Tubes) 2003-Up	1	TBA

09G (TF-60SN), 09K (TF-61SN), 09M (TF-62SN)

Notes