

## U660E

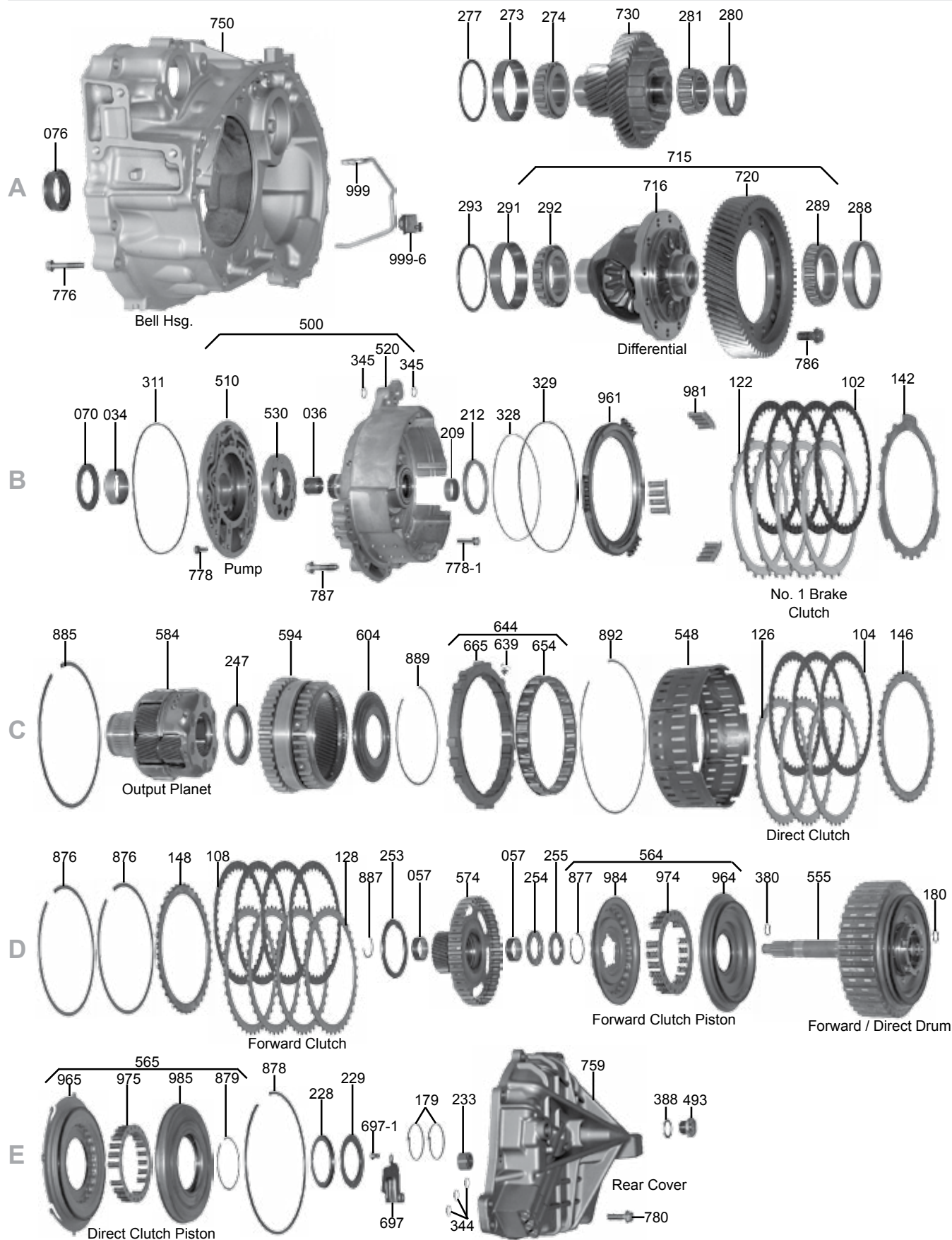

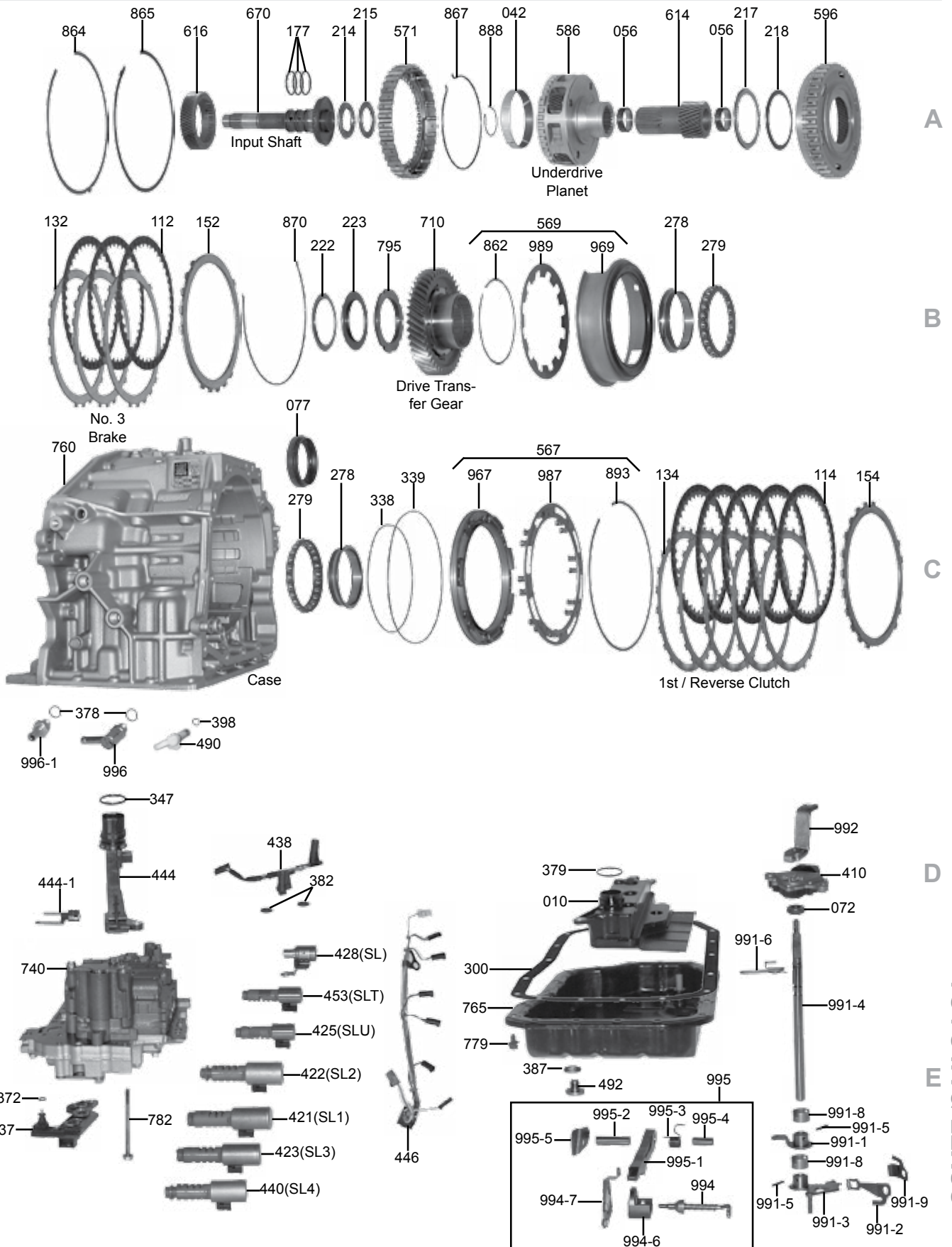

## U660E

ILL#	Part#		QTY	REF#
<b>OVERHAUL KITS &amp; PISTON KITS</b>				
NI.....	K157900.....	Overhaul Kit, U660E W/ Pistons, 2007-Up.....	1.....	TBA
NI.....	K157900X.....	Overhaul Kit, U660E W/ Out Pistons, 2007-Up.....	1.....	TBA
NI.....	K157900-99.....	Kit, U660E, Bonded Pistons (5 Pistons) 2007-Up.....	1.....	TBA
<b>MASTER L/STEEL KITS</b>				
NI.....	DK15700S.....	Master L/Steels Kit, U660E, W/ Pistons, 2007-Up.....	1.....	TBA
NI.....	DK15700XS.....	Master L/Steels Kit, U660E, W/ Out Pistons, 2007-Up.....	1.....	TBA
<b>MASTER W/STEELS KITS</b>				
NI.....	DK15700.....	Master W/Steels Kit, U660E, W/ Pistons, 2007-Up.....	1.....	TBA
NI.....	DK15700X.....	Master W/Steels Kit, U660E, W/ Out Pistons, 2007-Up.....	1.....	TBA
<b>FILTERS</b>				
010.....	157710.....	Filter, U660E (2 Bolt)(Plastic) (2 1/4" Thick)(8 1/2" Long)(5 1/4" Wide) 2007-Up.....	1.....	TBA
NI.....	157711.....	Screen, Valve Body, U660E, 2007-Up.....	2.....	TBA
<b>BUSHINGS</b>				
030.....	K157901.....	Bushing, U660E, 2007-Up.....	1.....	TBA
034.....	157005.....	Bushing, U660E Pump Body (Front) (.500" Thick)(1.830" OD)(1.690" ID) 2007-09.....	1.....	TBA
034.....	157005A.....	Bushing, U660E Pump Body (Front) 2010-Up.....	1.....	TBA
NI.....	157004.....	Bushing, U660E, Input Shaft, 2007-Up.....	1.....	TBA
036.....	157002.....	Bushing, U660E Stator (Front) (.680" Thick)(1.013" OD)(.880" ID) 2007-Up.....	1.....	TBA
042.....	157016.....	Bushing, U660E Underdrive Planet (Front)(.460" Thick)(3.300" OD)(3.105" ID)(With 4 Holes).....	1.....	TBA
056.....	157017.....	Bushing, U660E Sun Gear # 614 (Front & Rear)(.430" Thick)(1.105" OD)(1.000" ID).....	2.....	TBA
057.....	157013.....	Bushing, U660E Output Rear Sun Gear Hub (1.105" OD)(1.010" ID)(Front & Rear) 2007-Up.....	2.....	TBA
<b>METAL CLAD SEALS</b>				
070.....	157151.....	Seal, U660E Pump (Front) (.230" Thick)(2.445" OD)(1.650" ID) 2007-Up.....	1.....	TBA
072.....	78197.....	Seal, U660E Linkage (.275" Thick)(.870" OD)(.460" ID) 2007-Up.....	1.....	TBA
076.....	89159.....	Seal, U660E Axle (Bell Housing Side)(2.210" OD) 2007-Up.....	1.....	TBA
077.....	57152B.....	Seal, U660E Axle (Case Side) (.600" Thick)(2.680" OD)(1.880" ID) 2007-Up.....	1.....	TBA
<b>FRICTIONS</b>				
102.....	157101.....	Friction, U660E (B1) #1 Brake / 2-6 (.074", 40T, 6.982" OD) 2007-Up.....	4.....	TBA
106.....	157103.....	Friction, U660E (C2) Direct Clutch / 4-5-6 (.070", 40T, 6.552" OD) 2007-Up.....	3.....	TBA
108.....	157103.....	Friction, U660E (C1) Forward Clutch / 1-2-3-4 (.070", 40T, 6.552" OD) 2007-Up.....	4.....	TBA
112.....	157101.....	Friction, U660E (B3) #3 Brake / 3-5/Rev (.074", 40T, 6.982" OD) 2007-Up.....	3.....	TBA
114.....	157105.....	Friction, U660E (B2) 1st-Rev Brake (.062", 40T, 7.242" OD) 2007-Up.....	5.....	TBA
119.....	K157F.....	Friction Module, U660E, 2007-Up.....	1.....	TBA
<b>STEELS</b>				
122.....	157100.....	Steel, U660E (B1) No.1 Brake / 2-6 (.072", 11T, 6.045" ID) 2007-Up.....	4.....	TBA
126.....	157102.....	Steel, U660E (C2) Direct Clutch / 4-5-6 (.085", 40T, V-Notched, 5.674" ID) 2007-Up.....	3.....	TBA
128.....	157104.....	Steel, U660E (C1) Forward Clutch / 1-2-3-4 (.071", 40T - No Notches, 5.674" ID) 2007-Up.....	4.....	TBA
132.....	157106.....	Steel, U660E (B3) No.3 Brake / 3-5/Rev (.087", 11T, 6.045" ID) 2007-Up.....	3.....	TBA
134.....	157108.....	Steel, U660E (B2) 1st-Rev Brake (.062", 16T, 6.375" ID) 2007-Up.....	5.....	TBA
139.....	K157S.....	Steel Module, U660E, 2007-Up.....	1.....	TBA
<b>PRESSURE PLATES</b>				
142.....	157715.....	Pressure Plate, U660E No. 1 Brake Clutch (.130", 14T, 6.050" ID, Stamped# 33) 2007-Up.....	1.....	TBA
146.....	157716.....	Pressure Plate, U660E Direct Clutch (.134", 40T, 5.670" ID, Cast #34) 2007-Up.....	1.....	TBA
146.....	157716A.....	Pressure Plate, U660E Direct Clutch (.137", 40T, 5.670" ID, Cast #35) 2007-Up.....	1.....	TBA
148.....	157716.....	Pressure Plate, U660E Forward Clutch (.134", 40T, 5.670" ID, Cast #34) 2007-Up.....	1.....	TBA
148.....	157716A.....	Pressure Plate, U660E Forward Clutch (.137", 40T, 5.670" ID, Cast #35) 2007-Up.....	1.....	TBA
152.....	157717.....	Pressure Plate, U660E No. 3 Brake Clutch (.153", 11T, 6.050" ID, Cast # 39) 2007-Up.....	1.....	TBA
154.....	157718.....	Pressure Plate, U660E 1st/Reverse Clutch (.160", 16T, 6.375" ID, Cast #41) 2007-Up.....	1.....	TBA
<b>VALVE BODY KITS</b>				
165.....	K157908.....	Shift Kit, U660E, 3.5L (Camry 07-09, Avalon 2008, ES350 07-08) 2007-Up (Transgo).....	1.....	SKU660E
<b>SEALING RINGS</b>				
175.....	K157903.....	Ring Kit, U660E, 2007-Up.....	1.....	TBA
177.....	157301.....	Ring, U660E Input Shaft (.089" Thick)(1.195" OD)(Teflon) 2007-Up.....	3.....	TBA
179.....	157302.....	Ring, U660E Forward/Direct Clu Drum To Rear Cover (.090" Thick)(1.900" OD)(Teflon).....	2.....	TBA
180.....	157303.....	Ring, U660E Forward/Direct Clutch Drum (Rear)(.092" Thick)(.630" OD)(Teflon) 2007-Up.....	1.....	TBA
<b>WASHERS &amp; BEARINGS</b>				



ILL#	Part#		QTY	REF#
200.....	K157907.....	Washer Kit, U660E, 2007-Up .....	1.....	TBA
201.....	K157906.....	Bearing Kit, U660E, 2007-Up .....	1.....	TBA
209.....	157415.....	Caged Needle Bearing, U660E Stator (Rear)(.400" Thick)(1.525" OD) 2007-Up.....	1.....	TBA
212.....	157416.....	Bearing W/Races, U660E Stator To Sun Gear (.180" Thick)(2.955" OD)(2.275" ID) 2007-Up.....	1.....	TBA
214.....	157417.....	Bearing W/Race, Input Shaft To Underdrive Planet (.168" Thick)(1.905" OD)(1.153" ID) .....	1.....	TBA
215.....	157436.....	Race, U660E Input Shaft To Underdrive Planet (.078" Thick)(1.893" OD)(1.215" ID) 2007-Up .....	1.....	TBA
217.....	157418.....	Bearing W/Race, U660E Underdrive Planet To Ring Gear (.129" Thick)(3.230" OD)(2.470" ID) .....	1.....	TBA
218.....	157437.....	Race, U660E Underdrive Planet To Ring Gear (.032" Thick)(3.150" OD)(2.600" ID)(Cupped).....	1.....	TBA
222.....	157438.....	Race, U660E UD Planet Ring Gear To Drive Transfer Gear Nut (.031" Thick)(3.020" OD)(2.340" ID).....	1.....	TBA
223.....	157419.....	Brg W/Race, UD Planet Ring Gear To Drive Transfer Gear Nut (.120" Thick)(3.100" OD)(2.095" ID).....	1.....	TBA
228.....	157439.....	Race, Fwd/Direct Clu Drum To Rear Cover (.057" Thick)(2.763" OD)(2.060" ID) (Cupped).....	1.....	TBA
229.....	157420.....	Bearing W/Race, Fwd/Direct Clutch Drum To Rear Cover (.150" Thick)(2.825" OD)(1.930" ID).....	1.....	TBA
230.....	157421.....	Caged Needle Bearing, U660E In Rear Cover (.565" Wide)(.945" OD)(Cast # NSK DB501810) .....	1.....	TBA
247.....	157422.....	Bearing W/Races, Output Planet To Rear Sun Gear Hub (.209" Thick)(3.175" OD)(2.210" ID) .....	1.....	TBA
253.....	157423.....	Brg W/Races, Output Planet Ring Gr Hub To Rear Sun Gr Hub (.160" Thick)(3.105" OD)(2.415" ID) .....	1.....	TBA
254.....	157424.....	Brg W/Race, Sun Gear Hub To Forward/Direct Drum (.188" Thick)(1.848" OD)(1.105" ID) .....	1.....	TBA
255.....	157440.....	Race, U660E Sun Gear Hub To Forward/Direct Drum (.118" Thick)(1.725" OD)(1.035" ID) .....	1.....	TBA
273.....	157441.....	Cup Race, Pinion Gear To Bell Hsg (.665" Thick)(3.230" OD)(2.765" ID)(Cast # KOYO STA4282) .....	1.....	TBA
274.....	157425.....	Cone Brg, Pinion Gear To Bell Hsg (20 Rollers)(1.653" ID)(Cast # KOYO STA4282).....	1.....	TBA
277.....	157442.....	Shim, U660E Pinion Gear To Bell Housing (Selective)(3.210" OD)(2.810" ID) 2007-Up .....	1.....	TBA
278.....	157443.....	Inner Race, Drive Transfer Gr To Case Brg #279 (.590" Thick)(3.320" OD)(2.830" ID)(# HTF 2E) .....	2.....	TBA
279.....	157426.....	Cone Ball Brg, Drive Transfer Gear To Case (24 Ball Plastic Cage)(.465" Thick)(4.135" ID) .....	2.....	TBA
280.....	157444.....	Cup Race, Pinion To Case (.685" Thick)(2.675" OD)(2.175" ID)(Cast # KOYO STF3568) .....	1.....	TBA
281.....	157427.....	Cone Bearing, Pinion To Case (16 Rollers)(1.378" ID)(Cast # KOYO STF3568) 07-Up .....	1.....	TBA
288.....	157445.....	Cup Race, Diff To Case (.605" Thick)(3.543" OD)(3.058" ID)(Cast # KOYO ST5590A).....	1.....	TBA
289.....	157428.....	Cone Bearing, U660E Differential To Case (25 Rollers)(2.165" ID)(Cast # KOYO ST5590A) .....	1.....	TBA
291.....	157446.....	Cup Race, Diff To Bell Hsg (.665" Thick)(3.543" OD)(2.975" ID)(Cast # KOYO 30210J) .....	1.....	TBA
292.....	157429.....	Cone Bearing, Diff To Bell Housing (19 Rollers)(1.968" ID)(Cast # KOYO 30210JR-1).....	1.....	TBA
293.....	157447.....	Shim, U660E Diff Cup Race To Bell Housing (Selective)(3.525" OD)(3.125" ID) 2007-Up .....	1.....	TBA

## GASKETS &amp; RUBBER COMPONENTS

300.....	157500.....	Gasket, U660E Bottom Pan (18 Bolt) 2007-Up .....	1.....	TBA
311.....	157529.....	O-Ring, U660E Pump Body (6 3/4" OD) 2007-Up.....	1.....	TBA
344.....	157272.....	O-Ring, U660E Case To Rear Cover (.069" Thick)(.550" OD) 2007-Up.....	3.....	TBA
347.....	157514A.....	O-Ring, U660E Case Connector (.136" Thick)(1.400" OD) 2007-Up .....	1.....	TBA
372.....	157514B.....	O-Ring, U660E Temperature Sensor To Valve Body (.075" Thick)(.395" OD) 2007-Up .....	1.....	TBA
379.....	157548.....	O-Ring, U660E Filter (.101" Thick)(1 1/16" OD) 2007-Up .....	1.....	TBA
380.....	157562.....	O-Ring, U660E Forward/Direct Clutch Drum Shaft (Front)(.086" Thick)(.650" OD) 2007-Up.....	1.....	TBA
382.....	157530.....	Lathe Cut Seal, U660E Valve Body To Case (.145" Thick)(.610" OD)(With 6 OD Notches) .....	2.....	TBA
388.....	157509.....	Washer/Seal, U660E Fill Plug To Rear Cover (.960" OD)(.705" ID) 2007-Up .....	1.....	TBA

## ELECTRICAL COMPONENTS

410.....	157991.....	Neutral Safety Switch, U660E (7 Pin & 2 Blade Connector)(Cast # 84540-83010-AV2351).....	1.....	TBA
421.....	157930.....	Solenoid, U660E Shift 1 (SL1) (2 Prong, Brown Conn) 2007-Up (Also Fits Shift 3 (SL3) #423) .....	1-2.....	TBA
422.....	157931.....	Solenoid, U660E Shift 2 (SL2) (2 Prong, Black Conn) 2007-Up (Also Fits Shift 4 (SL4) #440) .....	1-2.....	TBA
423.....	157930.....	Solenoid, U660E Shift 3 (SL3) (2 Prong Brown Conn) 2007-Up .....	1-2.....	TBA
425.....	157929.....	Solenoid, U660E Lock-Up (SLU) (2 Prong, Black Connector) 2007-Up.....	1.....	TBA
428.....	157936.....	Solenoid, U660E Line Pressure Control (SL)(1 Prong, Blue Connector) 2007-Up .....	1.....	TBA
437.....	157952.....	Temperature Sensor Assembly, U660E (4 Bolt, W/3 O-Rings) 2007-Up.....	1.....	TBA
438.....	157954.....	Speed Sensor Assy, Input & Output (Both On A Bracket 4-Wire Conn) 2007-3/10 .....	1.....	TBA
438.....	157954A.....	Speed Sensor Assy, Input & Output (Both On A Bracket) 4/2010-Up.....	1.....	TBA
440.....	157931.....	Solenoid, U660E Shift 4 (SL4) (2 Prong Black Conn) 2007-Up .....	1-2.....	TBA
444-1 .....	157629.....	Bracket, U660E Case Connector Extension To Valve Body (1 Bolt) 2007-Up.....	1.....	TBA
444.....	157984.....	Case Connector Extension, (22 Blades On Top)(18 Blades On Bottom)(4 Blades On Side).....	1.....	TBA
446.....	157988.....	Wire Harness, Internal (18 Prong Connector, With 6 Two Wire Connectors, 1 One Wire .....	1.....	TBA
		Connector, & 1 Four Wire Connector) 2007-Up .....		
453.....	157938.....	Solenoid, U660E (SLT) (2 Prong, Black Connector) 2007-Up.....	1.....	TBA

## MISCELLANEOUS COMPONENTS

490.....	157621.....	Vent, U660E (Plastic, Elbow) (1.970" Long) 2007-Up .....	1.....	TBA
493.....	157622.....	Fill Plug, U660E (24mm Hex Head)(.665" Long) 2007-Up .....	1.....	TBA

## HARD PARTS

500.....	157912.....	Pump, U660E (Cast Iron Body, Alum Stator)(Cast # J6A10530 On Stator) 2007-Up.....	1.....	TBA
510.....	157916.....	Pump Body W/Gears, (Cast Iron) (10 Teeth Inner, 11 Teeth Outer Pump Gears) 2007-Up .....	1.....	TBA
520.....	157915.....	Stator, U660E (Aluminum) (Cast # J6A10530) 2007-Up .....	1.....	TBA
548.....	157852.....	Apply Sleeve, Direct Clutch Piston (2.655" Thick) (W/8 Notches) (Snap Ring # 878 Holds .....	1.....	TBA
		This To The Direct Clutch Piston) 2007-Up .....		

## U660E

ILL#	Part#		QTY	REF#
555.....	157732	Drum, Forward/Direct Clutch W/Shaft (9 1/4" Long) (4 Forward Clutch & 3 Direct Clutch).....	1	TBA
564.....	K157763	Piston Kit, U660E Forward Clutch (Bonded Piston & Retainer) (4 Pieces) 2007-Up.....	1	TBA
565.....	K157764	Piston Kit, U660E Direct Clutch (Bonded Piston W/Housing) (4 Pieces) 2007-Up.....	1	TBA
567.....	K157765	Piston Kit, U660E 1st/Reverse Clutch (Aluminum Piston) (3 Pieces) 2007-Up.....	1	TBA
569.....	K157766	Piston Kit, U660E No. 3 Brake Clutch (1.580" Thick Bonded Piston) (3 Pieces) 2007-Up.....	1	TBA
571.....	157741	Hub, No.1 Brake Clutch (40 Outer & 36 Inner Splines) (Aluminum) (.900" Thick) (5.907" OD).....	1	TBA
574.....	157742	Sun Gear Hub, U660E Output Planet (Rear) (W/Forward Clutch Hub) (30 Teeth Sun Gear).....	1	TBA
		(40 Teeth Hub)(2.405" Tall) 2007-Up.....		
584.....	157748	Planet, U660E Output / Rear, 6 Gear, 5 1/8" Tall, Uses 30T Rear Sun Gear, 2007-Up.....	1	TBA
586.....	157749	Planet, U660E Underdrive W/ Hub, 2007-Up.....	1	TBA
594.....	157758	Ring Gear, U660E Output Planet (69 Teeth) (40 Outer Splines Front, 32 Outer Splines Rear).....	1	TBA
596.....	157759	Ring Gear, U660E Underdrive Planet (110 Teeth) (40 Clutch Splines) (1.325" Thick) (6 Slots).....	1	TBA
604.....	157743	Hub, U660E Output Planet Ring Gear (69 Teeth) (4.775" OD) (2.240" ID) 2007-Up.....	1	TBA
614.....	157755	Sun Gear, U660E Output Planet (Front)(27 Teeth) (24 Splines) (3.720" Long) 2007-Up.....	1	TBA
616.....	157756	Sun Gear, U660E Underdrive Planet (66 Teeth)(.755" Thick)(2.985" OD)(W/39 Inner Splines).....	1	TBA
639.....	157639	Anti-Clunk Spring, U660E Sprag Outer Race (.177" Thick) 2007-Up.....	1	TBA

### SPRAGS

644.....	K157724	Sprag Assembly, U660E (1 Way Clutch)(20 Elements W/Plastic Cage) 2007-Up.....	1	TBA
654.....	157724	Sprag, U660E (1 Way Clutch)(20 Elements W/Plastic Cage)(.720" Wide)(6 1/4" OD) 2007-Up.....	1	TBA
665.....	157730	Outer Race, U660E (1 Way Clutch) Sprag (14 Lugs)(.645" Thick) 2007-Up.....	1	TBA
670.....	157851	Input Shaft, (.6055" Long)(.750" OD Pilot)(22 Conv Splines)(18 Rear Inner Splines) (3-Ring).....	1	TBA
697-1	K157624	Bolt Set, U660E Oils Shield To Rear Cover (2 Pieces) 2007-Up.....	1	TBA
697.....	157624	Oil Shield, U660E Rear Cover (2 Bolt, W/Slot)(2.610" Long) 2007-Up.....	1	TBA
710.....	157818	Gear, U660E Drive Transfer (44 Teeth)(36 Inner Splines)(1.925" Thick)(5.550" OD) 2007-Up.....	1	TBA
715.....	157910	Differential Assy, (69T, 1 Groove Ring Gr) (12 Bolt) (6 1/4" Tall Hsg) (1.378" ID Axle Hole).....	1	TBA
730.....	157846	Pinion, U660E (20 Teeth 1 Groove Pinion Gear) (47 Teeth Driven Transfer Gear) 2007-Up.....	1	TBA
740.....	157754	Valve Body, U660E (W/7 Solenoids)(Cast # U660) 2007-Up.....	1	TBA
NI.....	157940	Valve, U660E Manual (3.755" Long) 2007-Up.....	1	TBA
750.....	157703	Bell Housing / Front Case Half, U660E, 2007-Up.....	1	TBA
759.....	157704	Rear Cover, U660E (Aluminum)(14 Bolt, With 4 Extra Holes) 2007-Up.....	1	TBA
760.....	157701	Case / Rear Case Half, U660E, 2007-Up.....	1	TBA
765.....	157801	Pan, U660E Bottom (18 Bolt)(2 1/4" Deep At Deep End) 2007-Up.....	1	TBA
795.....	157081	Nut, Holds Output Planet To Drive Transf Gr (.275"(.3330" OD)(2.305" ID)(9 OD Notches).....	1	TBA
862.....	157301	Snap Ring, Holds No. 3 Brake Clutch Piston Return Spring In Case (.047" Thick)(4.445" OD).....	1	TBA
864.....	157302	Snap Ring, U660E Holds No. 1 Brake Clutch Press Plate In Stator (.063" Thick)(7 1/2" OD).....	1	TBA
		(.255" Wide)(W/1 Tab On The Outside & In The Center Between The Ends) 2007-Up.....		
865.....	157303	Snap Ring, Holds No. 3 Brake Clutch Steel # 132 In The Stator (.063" Thick)(7 1/2" OD).....	1	TBA
		(.258" Wide)(W/1 Tab On The Outside & At The End) 2007-Up.....		
867.....	157304	Snap Ring, U660E No. 1 Brake Clutch Hub To Underdrive Planet (.089" Thick)(4.880" OD).....	1	TBA
870.....	157305	Snap Ring, Holds No. 3 Brake Clutch Press Plate In Stator (.098" Thick)(7 7/8" OD) Hooked Ends.....	1	TBA
876.....	157306	Snap Ring, U660E Holds Direct & Forward Clutch Press Plate In (.079" Thick)(6 7/8" OD).....	2	TBA
877.....	157307	Snap Ring, U660E Holds Forward Clutch Piston Retainer In Drum (.047" Thick)(1.650" OD).....	1	TBA
878.....	157308	Snap Ring, Holds Direct Clutch Piston # 965 To The Apply Sleeve # 548 (.101" Thick)(7 1/2" OD).....	1	TBA
879.....	157309	Snap Ring, U660E Holds Direct Clutch Piston Housing To Drum (.047" Thick)(2.775" OD).....	1	TBA
885.....	157310	Snap Ring, U660E Holds 1st/Reverse Clutch Pressure Plate In (.082" Thick)(7 5/8" OD).....	1	TBA
887.....	157311	Snap Ring, U660E Holds Sun Gear Hub # 574 In Drum # 555 (.048" Thick)(1.190" OD).....	1	TBA
888.....	157312	Snap Ring, U660E Holds Sun Gear # 614 To UD Planet (.055" Thick)(1.465" OD) 2-Eyelets.....	1	TBA
889.....	157313	Snap Ring, U660E Holds Hub To Ring Gear (.055" Thick)(5.260" OD) 2007-Up.....	1	TBA
892.....	157314	Snap Ring, U660E Holds Sprag Outer Race In Case (.055" Thick)(8" OD) 2007-Up.....	1	TBA
893.....	157315	Snap Ring, Holds 1st/Reverse Clutch Piston Retainer In Case (.062" Thick)(7 3/4" OD).....	1	TBA
961.....	157762	Piston, U660E No. 1 Brake Clutch (Aluminum)(.630" Thick)(5.395" OD) 2007-Up.....	1	TBA
964.....	157763	Piston, U660E Forward Clutch (Bonded)(.830" Thick)(6 1/4" OD)(1.898" ID) 2007-Up.....	1	TBA
965.....	157764	Piston, U660E Direct Cl, Outer (Bonded)(2.665" ID)(8 Lugs)(4 Slots) 2007-09.....	1	TBA
965.....	157764A	Piston, U660E Direct Cl, Outer (Bonded) 2010-Up.....	1	TBA
965.....	157764B	Piston, U660E Direct Cl, Inner (Bonded) (Pictured Still On #555D Drum In Pic) 2007-Up.....	1	TBA
967.....	157765	Piston, U660E 1st/Reverse Clu (Aluminum)(.620" Thick)(7" OD)(5 3/8" ID)(16 Spring Pockets).....	1	TBA
969.....	157766	Piston, U660E No. 3 Brake Clutch (Bonded)(1.580" Thick)(6 13/16" OD) 2007-Up.....	1	TBA
974.....	157641	Retainer W/Springs, Fwd Clu Piston Return (21 Springs)(.745" Thick)(4.405" OD)(3.30" ID).....	1	TBA
975.....	157642	Retainer W/Springs, Direct Clu Piston Return (.720") (4.075" OD)(3.205" ID) (21 Springs).....	1	TBA
981.....	K157872	Return Spring Set, U660E No. 1 Brake Clutch Return (3 Pieces)(4 Springs Per Pieces).....	1	TBA
984.....	157644	Retainer, U660E Forward Clu Piston (Bonded)(.665" Thick)(5.660" OD)(1.460" ID) 2007-Up.....	1	TBA
985.....	157853	Retainer, U660E Direct Clutch Piston (Steel)(6 1/4" OD)(2.635" ID) 2007-Up.....	1	TBA
987.....	157645	Retainer W/Springs, U660E 1st/Reverse Clutch Piston (16 Springs)(7 1/4" OD)(5.755" ID).....	1	TBA
989.....	157873	Spring, No.3 Brake Clutch Piston Return (.058" Thick)(6.030" OD)(12 Fingers) 2007-Up.....	1	TBA
991-1	157631A	Lever, U660E Park Pawl (2.095" Long)(.475" ID) 2007-Up.....	1	TBA
991-2	157631B	Detent, U660E Rooster Comb (3.906" Long)(1 Bolt) 2007-Up.....	1	TBA
991-3	157631C	Rooster Comb, U660E (.475" ID Hole)(W/4 Notches) 2007-Up.....	1	TBA

## U660E

ILL#	Part#		QTY	REF#
991-4 ....	157631D.....	Linkage Shaft, U660E(9 1/2" Long)(W/Threaded End) 2007-Up.....	1 .....	TBA
991-5 ....	157631E.....	Roll Pin, U660E Holds Internal Levers To Manual Shaft (.775" Long)(.155" OD) 2007-Up.....	2 .....	TBA
991-6 ....	157631F.....	Wire Clip, U660E Holds Linkage Shaft To Case (.077" Thick Wire, 2.320" Long) 2007-Up .....	1 .....	TBA
991-8 ....	157631G .....	Retainer, U660E Linkage Roll Pin (Sleeve)(.475" Wide)(.835" OD) 2007-Up .....	2 .....	TBA
991-9 ....	157631H.....	Bracket, U660E Detent (1.320" Long)(1.045" Wide)(1 Bolt) 2007-Up .....	1 .....	TBA
992.....	157631J .....	Manual Lever, U660E External (.830" Wide)(W/2 Key Hole Slots) 2007-Up.....	1 .....	TBA
995.....	K157824.....	Park Pawl Assembly, U660E (8 Pieces) 2007-Up .....	1 .....	TBA
996-1 ....	157635 .....	Fitting, U660E Cooler Line (Front, Upper)(Straight)(2.120" Long) 2007-Up.....	1 .....	TBA
996.....	157636 .....	Fitting, U660E Cooler Line (Rear, Lower)(Elbow)(2.160" Long) 2007-Up .....	1 .....	TBA
999-6 ....	157630 .....	Bracket, U660E Holds Oil Tube To Bell Housing 2007-Up .....	1 .....	TBA
999.....	157637 .....	Oil Tube, U660E In Bell Housing (.255" OD) 2007-Up .....	1 .....	TBA