

## RE0F09A (JF010E), RE0F10A (JF011E)

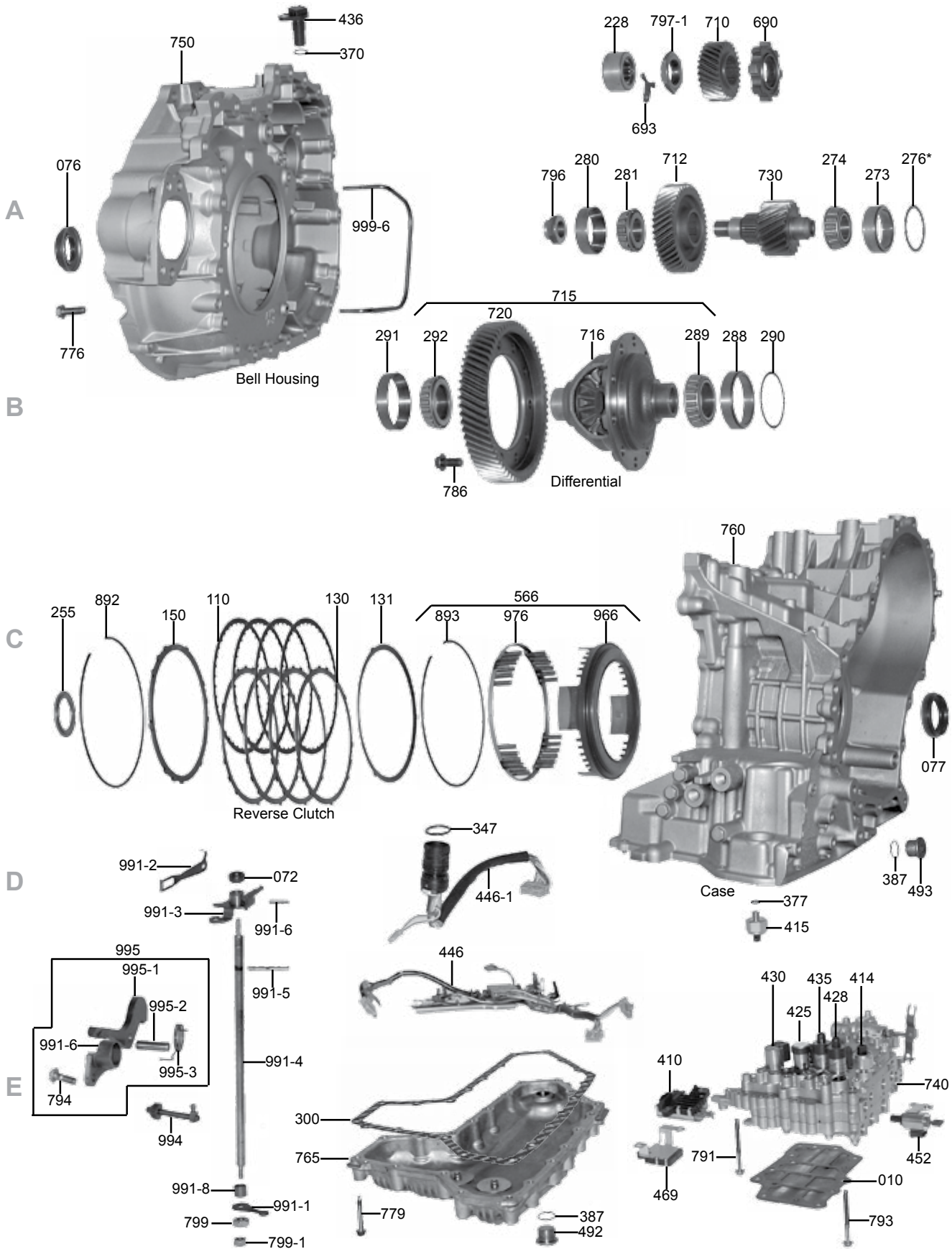

## RE0F09A (JF010E), RE0F10A (JF011E)

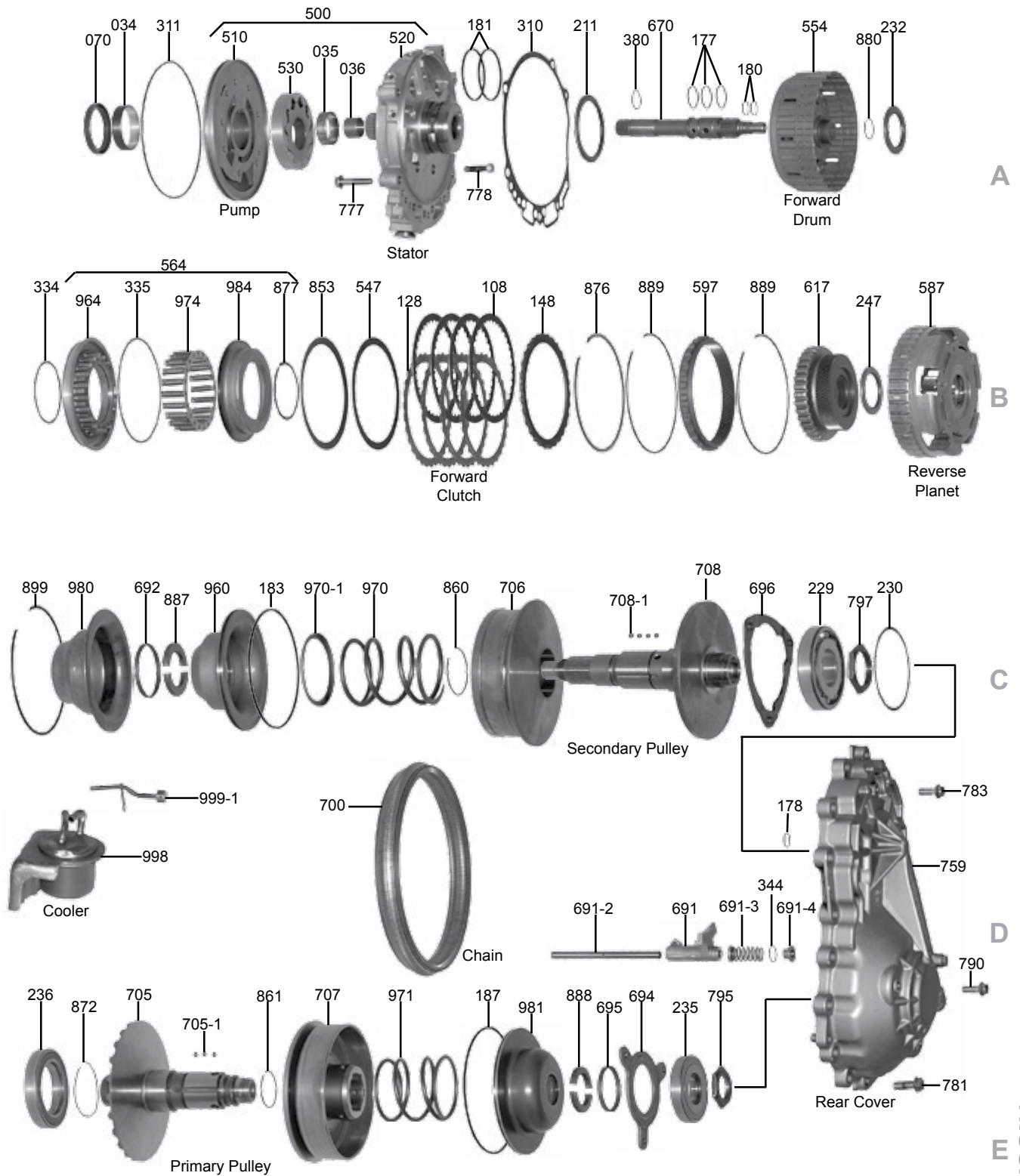

## RE0F09A (JF010E), RE0F10A (JF011E)

| ILL#                                   | Part#            |   | QTY    | REF#        |
|--|------------------|---|--------|-------------|
| <b>OVERHAUL KITS &amp; PISTON KITS</b> |                  |   |        |             |
| NI.....                                | K125900.....     | Overhaul Kit, W/Pistons RE0F09A(JF010E) 2003-Up.....                                      | 1..... | N/A         |
| NI.....                                | K125900X.....    | Overhaul Kit, W/Out Pistons RE0F09A(JF010E) 2003-Up.....                                  | 1..... | N/A         |
| NI.....                                | K125900B.....    | Overhaul Kit, W/Pistons JF011E(RE0F10A) 2007-Up.....                                      | 1..... | N/A         |
| NI.....                                | K125900BX.....   | Overhaul Kit, W/Out Pistons JF011E(RE0F10A) 2007-Up.....                                  | 1..... | N/A         |
| NI.....                                | K125900-99.....  | Piston Kit RE0F09A(JF010E) (2-Pistons) 2003-Up.....                                       | 1..... | N/A         |
| NI.....                                | K125900B-99..... | Piston Kit JF011E(RE0F10A) (3-Pistons) 2007-Up.....                                       | 1..... | N/A         |
| <b>MASTER L/STEEL KITS</b>             |                  |   |        |             |
| NI.....                                | DK12500S.....    | Master L/Steels Kit, W/Pistons RE0F09A(JF010E) 2003-Up.....                               | 1..... | N/A         |
| NI.....                                | DK12500XS.....   | Master L/Steels Kit, W/Out Pistons RE0F09A(JF010E) 2003-Up.....                           | 1..... | N/A         |
| NI.....                                | DK12500BS.....   | Master L/Steels Kit, W/Pistons JF011E(RE0F10A) 2007-Up.....                               | 1..... | N/A         |
| NI.....                                | DK12500BXS.....  | Master L/Steels Kit, W/Out Pistons JF011E(RE0F10A) 2007-Up.....                           | 1..... | N/A         |
| <b>MASTER W/STEELS KITS</b>            |                  |   |        |             |
| NI.....                                | DK12500.....     | Master W/Steels Kit, W/Pistons RE0F09A(JF010E) 2003-Up.....                               | 1..... | N/A         |
| NI.....                                | DK12500X.....    | Master W/Steels Kit, W/Out Pistons RE0F09A(JF010E) 2003-Up.....                           | 1..... | N/A         |
| NI.....                                | DK12500B.....    | Master W/Steels Kit, W/Pistons JF011E(RE0F10A) 2007-Up.....                               | 1..... | N/A         |
| NI.....                                | DK12500BX.....   | Master W/Steels Kit, W/Out Pistons JF011E(RE0F10A) 2007-Up.....                           | 1..... | N/A         |
| <b>FILTERS</b>                         |                  |   |        |             |
| 010.....                               | 125710.....      | Filter, RE0F09A 2003-Up.....  | 1..... | TBA         |
| 010.....                               | 125710B.....     | Filter, JF011E Chrysler/Mitsubishi 2007-Up.....   | 1..... | 5191890AA   |
| 010.....                               | 125710C.....     | Filter, JF011E Nissan 2007-Up.....  | 1..... | TBA         |
| 013.....                               | 125711B.....     | Filter, JF011E (Cooler/Auxiliary) 2007-Up.....  | 1..... | 31726-1XF00 |
| <b>BUSHINGS</b>                        |                  |   |        |             |
| 034.....                               | 125005.....      | Bushing, RE0F09A Pump Body (1.920" ID)(Babbitt) 2003-Up.....                              | 1..... | TBA         |
| 034.....                               | 125005B.....     | Bushing, JF011E Pump Body 2007-Up.....  | 1..... | TBA         |
| 035.....                               | 125007.....      | Bushing, RE0F09A Inner Pump Gear (.560" Wide)(1.558" OD)(1.360" ID)(Babbitt) 2003-Up..... | 1..... | TBA         |
| 035.....                               | 125007B.....     | Bushing, JF011E Inner Pump Gear 2007-Up.....  | 1..... | TBA         |
| 036.....                               | 125002.....      | Bushing, RE0F09A Stator (Front) (.675" Wide)(.925" ID)(Babbitt) 2003-Up.....              | 1..... | TBA         |
| 036.....                               | 125002B.....     | Bushing, JF011E Stator (Front) 2007-Up.....   | 1..... | TBA         |
| <b>METAL CLAD SEALS</b>                |                  |   |        |             |
| 070.....                               | 125151.....      | Seal, RE0F09A Front (Pump) (.315" Thick)(2.530" OD)(1.905" ID) 2003-Up.....               | 1..... | TBA         |
| 070.....                               | 125151B.....     | Seal, JF011E Front (Pump) 2007-Up.....  | 1..... | TBA         |
| 072.....                               | 78197.....       | Seal, RE0F09A/JF011E Manual Shaft 2003-Up.....  | 1..... | TBA         |
| 076.....                               | 125154.....      | Seal, RE0F09A Axle (Bell Housing Side)(.620" Thick)(2.330" OD)(1.275" ID) 2003-Up.....    | 1..... | TBA         |
| 076.....                               | 63153B.....      | Seal, RE0F09A Axle, (Bell Housing Side) AWD Transfer Unit, 2003-Up.....                   | 1..... | TBA         |
| 076.....                               | 125152A.....     | Seal, JF011E Axle, Chrysler/Mitsubishi (Both Sides) 2007-Up.....                          | 2..... | TBA         |
| 076.....                               | 123154C.....     | Seal, JF011E Axle, Nissan (Bell Housing Side) 2007-Up.....                                | 1..... | TBA         |
| 077.....                               | 125153.....      | Seal, RE0F09A Axle (Case Side) (.535" Thick)(2.330" OD)(1.505" ID) 2003-Up.....           | 1..... | TBA         |
| 077.....                               | 125152A.....     | Seal, JF011E Axle, Nissan (Case Side) 2007-Up.....  | 1..... | TBA         |
| <b>FRICTIONS</b>                       |                  |   |        |             |
| 108.....                               | 125101.....      | Friction, RE0F09A Forward Clutch .059", 36T, 5.435" OD, 2003-Up.....                      | 4..... | TBA         |
| 108.....                               | 125101.....      | Friction, JF011E Forward Clutch .059", 36T, 5.435" OD, 2007-Up.....                       | 3..... | TBA         |
| 110.....                               | 125103.....      | Friction, RE0F09A Reverse Clutch .062", 40T, 7.030" OD 2003-Up.....                       | 4..... | TBA         |
| 110.....                               | 125103.....      | Friction, JF011E Reverse Clutch .062", 40T, 7.030" OD 2007-Up.....                        | 3..... | TBA         |
| NI.....                                | K125F.....       | Friction Module, RE0F09A 2003-Up.....   | 1..... | TBA         |
| NI.....                                | K125BF.....      | Friction Module, JF011E 2007-Up.....  | 1..... | TBA         |
| <b>STEELS</b>                          |                  |   |        |             |
| 128.....                               | 125100.....      | Steel, RE0F09A Forward Clutch .055", 30T, 4.715" ID, 2003-Up.....                         | 4..... | TBA         |
| 128.....                               | 125100.....      | Steel, JF011E Forward Clutch .055", 30T, 4.715" ID, 2007-Up.....                          | 3..... | TBA         |
| 130.....                               | 125102.....      | Steel, RE0F09A Reverse Clutch .055", 12T, 6.450" ID, 2003-Up.....                         | 4..... | TBA         |
| 130.....                               | 125102B.....     | Steel, JF011E Reverse Clutch .055", 12T, 6.465" ID, 2007-Up.....                          | 3..... | TBA         |
| NI.....                                | K125S.....       | Steel Module, RE0F09A 2003-Up.....  | 1..... | TBA         |
| NI.....                                | K125BS.....      | Steel Module, JF011E 2007-Up.....   | 1..... | TBA         |
| <b>PRESSURE PLATES</b>                 |                  |   |        |             |
| 131.....                               | 125142.....      | Cushion RE0F09A Reverse Clutch .073", 3T, 6.465" ID (Dished) 2003-Up.....                 | 1..... | TBA         |
| 131.....                               | 125142B.....     | Cushion JF011E Reverse Clutch, 2007-Up.....   | 1..... | TBA         |
| 148.....                               | 125131.....      | Pressure Plate, RE0F09A/JF011E Forward Clutch .140", 30T, 4.719" ID 2003-Up.....          | 1..... | TBA         |
| 150.....                               | 125132.....      | Pressure Plate, RE0F09A Reverse Clutch .140", 12T, 6 1/2" OD 2003-Up.....                 | 1..... | TBA         |
| 150.....                               | 125132B.....     | Pressure Plate, JF011E Reverse Clutch, 2007-Up.....                                       | 1..... | TBA         |
| <b>SEALING RINGS</b>                   |                  |   |        |             |

## RE0F09A (JF010E), RE0F10A (JF011E)

| ILL#                                   | Part#           |   | QTY     | REF# |
|--|-----------------|---|---------|------|
| NI .....                               | K125903 .....   | Kit, Sealing Ring, RE0F09A , 2003-Up .....  | 1 ..... | TBA  |
| NI .....                               | K125903B .....  | Kit, Sealing Ring, JF011E , 2007-Up .....   | 1 ..... | TBA  |
| <b>WASHERS &amp; BEARINGS</b>          |                 |   |         |      |
| NI .....                               | 125414B .....   | Bearing, JF011E, Pump Gear, 2007-Up .....   | 1 ..... | TBA  |
| 211 .....                              | 125415 .....    | Bearing W/Races, RE0F09A Stator To Forward Cl Drum (.155" Thk, 3.340" OD, 2.660" ID) .....      | 1 ..... | TBA  |
| 211 .....                              | 125415B .....   | Bearing W/Races, JF011E Stator To Forward Cl Drum, 2007-Up .....                                | 1 ..... | TBA  |
| 228 .....                              | 125416 .....    | Bearing, RE0F09A Secondary Pulley Shaft To Bell Hsg, 2003-Up (#HTFVP26Z-1G NSK) .....           | 1 ..... | TBA  |
| 228 .....                              | 125416B .....   | Bearing, JF011E Secondary Pulley Shaft To Bell Hsg, 2007-Up .....                               | 1 ..... | TBA  |
| 229 .....                              | 125417 .....    | Ball Brg, RE0F09A Secondary Pulley (Rear) To Rear Cover, 2003-Up (#NSK B45-111E) .....          | 1 ..... | TBA  |
| 229 .....                              | 125417B .....   | Ball Bearing, JF011E Secondary Pulley (Rear) To Rear Cover, 2007-Up .....                       | 1 ..... | TBA  |
| 230 .....                              | 125431 .....    | Shim, RE0F09A Secondary Pulley Brg To Rear Cover (Selective, 4.113" OD, 3.78" ID, 2003-Up ..... | 1 ..... | TBA  |
| 232 .....                              | 125418 .....    | Brg W/Races, RE0F09A/JF011E Fwd Drum To Sun Gear Hub (.149" Thk, 2.39" OD, 1.58" ID) .....      | 1 ..... | TBA  |
| 235 .....                              | 125419 .....    | Ball Bearing, RE0F09A Primary Pulley (Rear) To Rear Cover (# NSK 32TM12U40AL) .....             | 1 ..... | TBA  |
| 235 .....                              | 125419B .....   | Ball Bearing, JF011E Primary Pulley (Rear) To Rear Cover, 2007-Up .....                         | 1 ..... | TBA  |
| 236 .....                              | 125421 .....    | Ball Bearing, RE0F09A Primary Pulley (Front) To Case (# 65TM02U40A NSK) 2003-Up .....           | 1 ..... | TBA  |
| 236 .....                              | 125421B .....   | Ball Bearing, JF011E Primary Pulley (Front) To Case, 2007-Up .....                              | 1 ..... | TBA  |
| 247 .....                              | 125418 .....    | Brg W/Races, RE0F09A/JF011E, Sun Gear Front & Rear .....  | 2 ..... | TBA  |
| 255 .....                              | 125418 .....    | Brg W/Races, RE0F09A/JF011E, Planet To Case .....   | 1 ..... | TBA  |
| 273 .....                              | K125420 .....   | Kit, Bearing & Race, RE0F09A Pinion Shaft, Rear, 2003-Up .....                                  | 1 ..... | TBA  |
| 273 .....                              | K125420B .....  | Kit, Bearing & Race, JF011E Pinion Shaft, Rear, 2007-Up .....                                   | 1 ..... | TBA  |
| 273 .....                              | 125430 .....    | Cup Race, RE0F09A Pinion Shaft, Rear (# Koyo 32206J Or STJ3062) 2003-Up .....                   | 1 ..... | TBA  |
| 274 .....                              | 125420 .....    | Cone Bearing, RE0F09A Pinion Shaft, Rear (# Koyo STA3062-1) 2003-Up .....                       | 1 ..... | TBA  |
| 276 .....                              | 125432 .....    | Shim, RE0F09A Pinion Cup Race To Case (Selective)(2.422" OD)(2.050" ID) 2003-Up .....           | 1 ..... | TBA  |
| 280 .....                              | K125420 .....   | Kit, Bearing & Race, RE0F09A Pinion Shaft, Front, 2003-Up .....                                 | 1 ..... | TBA  |
| 280 .....                              | K125420B .....  | Kit, Bearing & Race, JF011E Pinion Shaft, Front, 2007-Up .....                                  | 1 ..... | TBA  |
| 280 .....                              | 125430 .....    | Cup Race, RE0F09A Pinion Shaft, Front (# Koyo 32206J Or STJ3062) 2003-Up .....                  | 1 ..... | TBA  |
| 281 .....                              | 125420 .....    | Cone Bearing, RE0F09A Pinion Shaft, Front (# Koyo STA3062-1) 2003-Up .....                      | 1 ..... | TBA  |
| 288 .....                              | K125420A .....  | Kit, Bearing & Race, RE0F09A Differential To Case, 2003-Up .....                                | 1 ..... | TBA  |
| 288 .....                              | K125420BA ..... | Kit, Bearing & Race, JF011E Differential To Case, 2007-Up .....                                 | 1 ..... | TBA  |
| 288 .....                              | 125430A .....   | Cup Race, RE0F09A Differential To Case (# Koyo STA4575) 2003-Up .....                           | 1 ..... | TBA  |
| 289 .....                              | 125420A .....   | Cone Bearing, RE0F09A Differential To Case (# Koyo STA4575-1) 2003-Up .....                     | 1 ..... | TBA  |
| 291 .....                              | K125420A .....  | Kit, Bearing & Race, RE0F09A Differential To Bell Housing, 2003-Up .....                        | 1 ..... | TBA  |
| 291 .....                              | K125420BB ..... | Kit, Bearing & Race, JF011E Differential To Bell Housing, 2007-Up .....                         | 1 ..... | TBA  |
| 291 .....                              | 125430A .....   | Cup Race, RE0F09A Differential To Bell Housing (# Koyo STA4575) 2003-Up .....                   | 1 ..... | TBA  |
| 292 .....                              | 125420A .....   | Cone Bearing, RE0F09A Differential To Bell Housing (# Koyo STA4575-1) 2003-Up .....             | 1 ..... | TBA  |
| <b>GASKETS &amp; RUBBER COMPONENTS</b> |                 |   |         |      |
| 300 .....                              | 125500 .....    | Gasket, RE0F09A Bottom Pan, 2003-Up .....   | 1 ..... | TBA  |
| 300 .....                              | 125500B .....   | Gasket, JF011E, Chrysler/Mitsubishi Bottom Pan, 2007-Up .....                                   | 1 ..... | TBA  |
| 300 .....                              | 125500C .....   | Gasket, JF011E, Nissan Bottom Pan, 2007-Up .....  | 1 ..... | TBA  |
| 310 .....                              | 125510 .....    | Gasket, RE0F09A Pump Stator To Case (Metal) 2003-Up .....                                       | 1 ..... | TBA  |
| 311 .....                              | 125211 .....    | O-Ring, RE0F09A Pump Body (.115" Thick)(6 7/8" OD) 2003-Up .....                                | 1 ..... | TBA  |
| NI .....                               | 125211B .....   | O-Ring, JF011E, Pump Cover, Inner, 2007-Up .....  | 1 ..... | TBA  |
| 380 .....                              | 125214 .....    | O-Ring, RE0F09A Input Shaft (Front)(.070" Thick)(.955" OD) 2003-Up .....                        | 1 ..... | TBA  |
| NI .....                               | 125215 .....    | O-Ring, RE0F09A, Case To Rear Cover, 2003-Up .....  | 1 ..... | TBA  |
| <b>ELECTRICAL COMPONENTS</b>           |                 |   |         |      |
| 410 .....                              | 125991 .....    | Park/Neutral Switch, RE0F09A, W/TFT 7-Prong Conn (Cast # PA66-GF30) 2003-Up .....               | 1 ..... | TBA  |
| 410 .....                              | 125991B .....   | Park/Neutral Switch, JF011E, 2007-Up .....  | 1 ..... | TBA  |
| 414 .....                              | 125998A .....   | Sensor, RE0F09A Secondary Pressure (FPS A) 3-Prong Conn, Screws Into VB 2003-Up .....           | 1 ..... | TBA  |
| 414 .....                              | 125998B .....   | Sensor, JF011E Secondary Pressure (FPS A) Screws Into VB 2003-Up .....                          | 1 ..... | TBA  |
| 415 .....                              | 125997 .....    | Sensor, RE0F09A Primary Pressure (FPS B) 3 Prong Conn, Screws Into Case 2003-Up .....           | 1 ..... | TBA  |
| 415 .....                              | 125997B .....   | Sensor, JF011E Primary Pressure (FPS B) Screws Into Case 2003-Up .....                          | 1 ..... | TBA  |
| 425 .....                              | 125955 .....    | Solenoid, RE0F09A TCC (1 Bolt Plastic Bracket) 2003-Up .....                                    | 1 ..... | TBA  |
| 425 .....                              | 125955A .....   | Solenoid, RE0F09A TCC (1 Bolt Metal Bracket) 2003-Up .....                                      | 1 ..... | TBA  |
| 428 .....                              | 125934 .....    | Solenoid, RE0F09A Line Pressure A (Cast # 06Z05-2) 2003-Up .....                                | 1 ..... | TBA  |
| 428 .....                              | 123934A .....   | Solenoid, RE0F09A Line Pressure A (Bosch # 0 260 130 030 On Plastic Conn) 2003-Up .....         | 1 ..... | TBA  |
| 428 .....                              | 125934B .....   | Solenoid, JF011E Line Pressure A, 2007-Up .....   | 1 ..... | TBA  |
| 430 .....                              | 123954 .....    | Solenoid, RE0F09A Lock-up Select (1 Bolt Metal Bracket) 2003-Up .....                           | 1 ..... | TBA  |
| 435 .....                              | 125934 .....    | Solenoid, RE0F09A Line Pressure B (Cast # 06Z05-2) 2003-Up .....                                | 1 ..... | TBA  |
| 435 .....                              | 123934A .....   | Solenoid, RE0F09A Line Pressure B (Bosch # 0 260 130 030 On Plastic Conn) 2003-Up .....         | 1 ..... | TBA  |
| 435 .....                              | 125934B .....   | Solenoid, JF011E Line Pressure B, 2007-Up .....   | 1 ..... | TBA  |
| 436 .....                              | 125958 .....    | Sensor, RE0F09A VSS (3 Prong Connector) 2003-Up .....   | 1 ..... | TBA  |
| 446-1 .....                            | 125987 .....    | Wire Harness, RE0F09A Internal, 2-Pc Type, Used With 125988 (22-Prong Case Conn) .....          | 1 ..... | TBA  |
| 446 .....                              | 125988 .....    | Wire Harness, RE0F09A Internal, 2-Pc Type, Used With 125987 (23 Prong Harn Conn) .....          | 1 ..... | TBA  |
| 446 .....                              | 125988A .....   | Wire Harness, RE0F09A Internal, 1-Pc Type, ILL#446-1 & ILL #446 (22-Prong Case Conn) .....      | 1 ..... | TBA  |
| 452 .....                              | 125947A .....   | Step Motor / Ratio Control Motor, RE0F09A, 6 Prong Conn (Cast # SM01 3128) 2003-Up .....        | 1 ..... | TBA  |



## RE0F09A (JF010E), RE0F10A (JF011E)

| ILL#  | Part#    |  | QTY | REF# |
|---|----------|--|-----|------|
| 452   | 125947B  | Step Motor / Ratio Control Motor, JF011E, 2007-Up  | 1   | TBA  |
| 469   | 125948   | ROM Assy, RE0F09A, 1.335" Wide Plastic Body, 3-Metal Tabs That Hold Bracket On             | 1   | TBA  |
| 469   | 125948A  | ROM Assy, RE0F09A, 1.405" Wide Plastic Body, 4-Metal Tabs That Hold Bracket On             | 1   | TBA  |
| <b>MISCELLANEOUS COMPONENTS</b>                           |          |  |     |      |
| 492   | 125620   | Drain Plug, RE0F09A Bottom Pan (19mm Hex Head)(Fits Steel Pan) 2003-Up                     | 1   | TBA  |
| 492   | 125620A  | Drain Plug, RE0F09A Bottom Pan (10mm Allen Head)(Fits Aluminum Pan) 2003-Up                | 1   | TBA  |
| 493   | 125620A  | Rear Plug, RE0F09A, 2003-Up)   | 1   | TBA  |
| <b>PUMPS &amp; PUMP COMPONENTS</b>                        |          |  |     |      |
| 500   | 125912   | Pump, RE0F09A (Cast # 6Y17 On Cover) 2003-Up   | 1   | TBA  |
| 500   | 125912B  | Pump (Remote) JF011E (Driven Sprocket, Cover, Rotor, Vanes, Shaft, Slide, End Cover, Body) | 1   | TBA  |
| NI  | 125886B  | Chain, Pump Drive, JF011E, 2007-Up   | 1   | TBA  |
| NI  | 125882B  | Sprocket, Driven, Pump, JF011E, 2007-Up  | 1   | TBA  |
| 510   | 125916   | Pump Body, RE0F09A (Cover, Cast Iron, Cast # 6Y17) 2003-Up                                 | 1   | TBA  |
| 520   | 125915   | Stator W/Gears, RE0F09A (Aluminum, 7 Bolts To Case) 2003-Up                                | 1   | TBA  |
| 530   | K125201  | Pump Gear Set, RE0F09A (10T Inner, 11T Outer Gear, .620" Thick, 3.760" OD)                 | 1   | TBA  |
| <b>DRUMS, PLANETS, RING GEARS, SUN GEARS &amp; SHAFTS</b> |          |  |     |      |
| 547   | 125433   | Spacer, RE0F09A Forward Cl Cushion (.044", 5.506" OD, 4.735" ID) 2003-Up                   | 1   | TBA  |
| 554   | 125732   | Drum, RE0F09A Forward Clutch (4-Clutch) 2003-Up  | 1   | TBA  |
| 554   | 125732B  | Drum, JF011E Forward Clutch (3-Clutch) 2007-Up   | 1   | TBA  |
| 566   | K125763  | Piston Kit, RE0F09A Reverse Clutch (# 966, 976, 893) 2003-Up                               | 1   | TBA  |
| 566   | K125763B | Piston Kit, JF011E Reverse Clutch (# 966, 976, 893) 2003-Up                                | 1   | TBA  |
| 587   | 125748   | Planet, RE0F09A Reverse (4-Gear) 2003-Up   | 1   | TBA  |
| 587   | 125748A  | Planet, RE0F09A Reverse (6-Gear) 2003-Up   | 1   | TBA  |
| 587   | 125748B  | Planet, JF011E, 2007-Up  | 1   | TBA  |
| 597   | 125759   | Ring Gear, RE0F09A Reverse Planet (110T, .730" Thick, 30 Outer Lugs) 2003-Up               | 1   | TBA  |
| 597   | 125759B  | Ring Gear, JF011E, Reverse Planet (.580" Thick) 2007-Up                                    | 1   | TBA  |
| 617   | 125753   | Sun Gear, RE0F09A Reverse Planet (82T, 3.730" OD Gear, 36-Spline Clutch Hub) 2003-Up       | 1   | TBA  |
| 617   | 125753B  | Sun Gear, JF011E, Reverse Planet, 2007-Up  | 1   | TBA  |
| 670   | 125851   | Input Shaft, RE0F09A (8" Long, Uses 3 Large & 1 Small Teflon Rings) 2003-Up                | 1   | TBA  |
| 670   | 125851A  | Input Shaft, RE0F09A (8" Long, Uses 3 Large & 2 Small Teflon Rings) 2003-Up                | 1   | TBA  |
| 670   | 125851B  | Input Shaft, JF011E (6-3/4" Long) 2007-Up  | 1   | TBA  |
| 690   | 125824   | Park Gear, RE0F09A (8 Outer Lugs, .575" Thick, 3.115" OD) 2003-Up                          | 1   | TBA  |
| 690   | 125824B  | Park Gear, JF011E, 2007-Up   | 1   | TBA  |
| <b>CVT COMPONENTS</b>                                     |          |  |     |      |
| 691   | K125652  | Assembly, Follower, RE0F09A (#691, #691-2, #691-3, #691-4) 2003-Up                         | 1   | TBA  |
| 691   | K125652B | Assembly, Follower, JF011E (#691, #691-2, #691-3, #691-4) 2007-Up                          | 1   | TBA  |
| 693   | 125628   | Bracket, RE0F09A Holds Secondary Pulley Brg (#228) To Bell Hsg (2-Bolt) 2003-Up            | 1   | TBA  |
| 693   | 125628A  | Bracket, RE0F09A Holds Secondary Pulley Brg (#228) To Bell Hsg (1-Bolt) 2003-Up            | 1   | TBA  |
| 693   | 125628B  | Bracket, JF011E Holds Secondary Pulley Brg (#228) To Bell Hsg, 2007-Up                     | 1   | TBA  |
| 694   | 125629   | Bracket, RE0F09A Holds Rear Primary Pulley Brg (#235) To Rear Cover, 2003-Up               | 1   | TBA  |
| 694   | 125629B  | Bracket, JF011E Holds Rear Primary Pulley Brg (#235) To Rear Cover, 2007-Up                | 1   | TBA  |
| 696   | 125630   | Bracket, RE0F09A Holds Rear Secondary Pulley Brg (#229) To Rear Cover, 2003-Up             | 1   | TBA  |
| 696   | 125630B  | Bracket, JF011E Holds Rear Secondary Pulley Brg (#229) To Rear Cover, 2007-Up              | 1   | TBA  |
| 700   | 125885   | Belt, RE0F09A Drive 2003-Up  | 1   | TBA  |
| 700   | 125885B  | Belt, JF011E Drive 2007-Up   | 1   | TBA  |
| 705   | K125650  | Kit, CVT Drive, RE0F09A, Complete Primary & Secondary Pulleys & Drive Belt, 2003-Up        | 1   | TBA  |
| 705   | K125650B | Kit, CVT Drive, JF011E, Complete Primary & Secondary Pulleys & Drive Belt, 2007-Up         | 1   | TBA  |
| 705   | 125651   | Primary Pulley Complete, RE0F09A, 2003-Up  | 1   | TBA  |
| 705   | 125651B  | Primary Pulley Complete, JF011E, 2007-Up   | 1   | TBA  |
| 707   | 125650   | Secondary Pulley Complete, RE0F09A, 2003-Up  | 1   | TBA  |
| 707   | 125650B  | Secondary Pulley Complete, JF011E, 2007-Up   | 1   | TBA  |
| <b>DIFFERENTIAL COMPONENTS</b>                            |          |  |     |      |
| 710   | 125809   | Gear, RE0F09A Drive Transfer (28 Teeth)(3.080" OD)(Splined ID) 2003-Up                     | 1   | TBA  |
| 710   | 125809B  | Gear, JF011E, Drive Transfer, 2007-Up  | 1   | TBA  |
| 712   | 125810   | Gear, RE0F09A Driven Transfer (43 Teeth)(4.595" OD)(Splined ID) 2003-Up                    | 1   | TBA  |
| 712   | 125810B  | Gear, JF011E Driven Transfer, 2007-Up  | 1   | TBA  |
| 715   | 125910   | Differential Assembly, RE0F09A (64 Teeth Ring Gear)(10 Bolt)(1.245" ID Axle Hole) 2003-Up  | 1   | TBA  |
| 715   | 125910A  | Differential Assembly, RE0F09A, AWD, 2003-Up   | 1   | TBA  |
| 715   | 125910B  | Differential Assembly, JF011E, 2007-Up   | 1   | TBA  |
| 716   | 125911   | Differential Housing, RE0F09A (Less Ring Gear)(10 Bolt)(1.245" ID Axle Hole) 2003-Up       | 1   | TBA  |
| 716   | 125911B  | Differential Housing, JF011E, 2007-Up  | 1   | TBA  |
| 720   | 125845   | Ring Gear, RE0F09A Differential (64 Teeth)(10 Bolt)(8 3/8" OD) 2003-Up                     | 1   | TBA  |
| 720   | 125845B  | Ring Gear, JF011E, Differential, 2007-Up   | 1   | TBA  |

## RE0F09A (JF010E), RE0F10A (JF011E)

| ILL#  | Part#    |  | QTY    | REF# |
|---|----------|--|--------|------|
| 730.....                                      | 125846   | Pinion Shaft, RE0F09A (19 Teeth)(5.190" Long) 2003-Up .....                                      | 1..... | TBA  |
| 730.....                                      | 125846B  | Pinion Shaft, JF011E, 2007-Up .....  | 1..... | TBA  |
| <b>VALVE BODIES</b>                           |          |  |        |      |
| 740.....                                      | 125754   | Valve Body, RE0F09A (Cast # FYO#2A On Solenoid Side) 2003-Up .....                               | 1..... | TBA  |
| 740.....                                      | 125754A  | Valve Body, RE0F09A (Cast # FYO#1B On Solenoid Side) 2003-Up .....                               | 1..... | TBA  |
| 740.....                                      | 125754B  | Valve Body, JF011E, 2007-Up .....  | 1..... | TBA  |
| <b>CASES, COVERS, PANS &amp; HOUSINGS</b>     |          |  |        |      |
| 750.....                                      | 125703   | Bell Housing, RE0F09A (Cast # VQ2 & ACO) (1-Bolt Bracket For # 693) .....                        | 1..... | TBA  |
| 750.....                                      | 125703A  | Bell Housing, RE0F09A (Cast # VO2 & ACO) (2-Bolt Bracket For # 693) .....                        | 1..... | TBA  |
| 750.....                                      | 125703B  | Bell Housing, JF011E, 2007-Up .....  | 1..... | TBA  |
| 759.....                                      | 125704   | Rear Cover, RE0F09A (Aluminum)(18 Bolt)(Cast # AKO #1) 2003-Up .....                             | 1..... | TBA  |
| 759.....                                      | 125704B  | Rear Cover, JF011E, 2007-Up .....  | 1..... | TBA  |
| 760.....                                      | 125701   | Case, RE0F09A (Cast # AKO # 3) (2 Big Bosses By The Cooler Are 2" Apart) 2003-Up .....           | 1..... | TBA  |
| 760.....                                      | 125701A  | Case, RE0F09A (Cast # ACO # 2) (2 Big Bosses By The Cooler Are 3-1/4" Apart) 2003-Up .....       | 1..... | TBA  |
| 760.....                                      | 125701B  | Case, JF011E, Chrysler / Mitsubishi, 2007-Up .....   | 1..... | TBA  |
| 760.....                                      | 125701C  | Case, JF011E, Nissan, 2007-Up .....  | 1..... | TBA  |
| 765.....                                      | 125801   | Pan, RE0F09A Bottom (Steel) 2003-Up .....  | 1..... | TBA  |
| 765.....                                      | 125801A  | Pan, RE0F09A Bottom (Aluminum) 2003-Up .....   | 1..... | TBA  |
| 765.....                                      | 125801B  | Pan, JF011E, Bottom, Chrysler / Mitsubishi, 2007-Up .....  | 1..... | TBA  |
| 765.....                                      | 125801C  | Pan, JF011E, Bottom, Nissan, 2007-Up .....   | 1..... | TBA  |
| 795.....                                      | 125081   | Nut, RE0F09A Holds Bearing # 235 To Primary Pulley Shaft (46mm)(.275" Thick)(1.140" ID) .....    | 1..... | TBA  |
| 795.....                                      | 125081B  | Nut, JF011E Holds Bearing # 235 To Primary Pulley Shaft .....                                    | 1..... | TBA  |
| 796.....                                      | 125082   | Nut, RE0F09A Pinion Shaft (32mm)(.730" Thick)(1.442" OD) 2003-Up .....                           | 1..... | TBA  |
| 796.....                                      | 125082B  | Nut, JF011E Pinion Shaft .....   | 1..... | TBA  |
| 797-1   | 125083   | Nut, RE0F09A Holds Drive Transfer Gear To Secondary Pulley Shaft (50mm)(.470" Thick) .....       | 1..... | TBA  |
| 797-1   | 125083B  | Nut, JF011E Holds Drive Transfer Gear To Secondary Pulley Shaft .....                            | 1..... | TBA  |
| 797.....                                      | 125084   | Nut, RE0F09A Holds Bearing # 229 To Secondary Pulley Shaft (55mm)(.327" Thick) .....             | 1..... | TBA  |
| 797.....                                      | 125084B  | Nut, JF011E Holds Bearing # 229 To Secondary Pulley Shaft .....                                  | 1..... | TBA  |
| NI.....                                       | 125805B  | Cover / Housing, JF011E, Cooler Filter, 2007-Up .....  | 1..... | TBA  |
| 853.....                                      | 125143   | Cushion, RE0F09A Forward Cl (.057") (Dished) 2003-Up (Used W/ Spacer #547) .....                 | 1..... | TBA  |
| 853.....                                      | 125143A  | Cushion, RE0F09A Forward Cl (.070") (Waved) 2003-Up (Does Not Use Spacer #547) .....             | 2..... | TBA  |
| 853.....                                      | 125143B  | Cushion, JF011E Forward Clutch, 2007-Up .....  | 1..... | TBA  |
| <b>SNAP RINGS</b>                             |          |  |        |      |
| NI.....                                       | K125908  | Kit, Snap Ring, RE0F09A 2003-Up .....  | 1..... | TBA  |
| NI.....                                       | K125908B | Kit, Snap Ring, JF011E 2007-Up .....   | 1..... | TBA  |
| 860.....                                      | 125601   | Snap Ring, RE0F09A Holds The Steel Ball Pulley Guides In The Secondary Pulley .....              | 1..... | TBA  |
| 861.....                                      | 125602   | Snap Ring, RE0F09A Holds The Steel Ball Pulley Guides In The Primary Pulley .....                | 1..... | TBA  |
| 872.....                                      | 125603   | Snap Ring, RE0F09A Holds Bearing # 236 To The Primary Pulley Shaft (Hidden) .....                | 1..... | TBA  |
| 876.....                                      | 125604   | Snap Ring, RE0F09A Holds Forward Clutch Pressure Plate In Drum 5.845" OD (Selective) .....       | 1..... | TBA  |
| 877.....                                      | 125605   | Snap Ring, RE0F09A Holds Forward Clutch Spring Retainer In Drum (.039" Thick) .....              | 1..... | TBA  |
| 880.....                                      | 125606   | Snap Ring, RE0F09A Holds Input Shaft To Forward Clutch Drum (.047" Thick)(1.062" OD) .....       | 1..... | TBA  |
| 889.....                                      | 125607   | Snap Ring, RE0F09A Holds Ring Gear To Forward Drum (.070" Thick)(5.930" OD) .....                | 2..... | TBA  |
| 892.....                                      | 125608   | Snap Ring, RE0F09A Holds Reverse Cl Press Plate In (Selective)(.094" Thick, 7.75" OD) .....      | 1..... | TBA  |
| 893.....                                      | 125609   | Snap Ring, RE0F09A Holds Reverse Clutch Spring Retainer In (.070" Thick)(7 9/16" OD) .....       | 1..... | TBA  |
| 899.....                                      | 125610   | Snap Ring, RE0F09A Holds Retainer In Front Secondary Pulley Half (.083" Thick)(6 5/16" OD) ..... | 1..... | TBA  |
| <b>PISTONS, RETAINERS &amp; MISCELLANEOUS</b> |          |  |        |      |
| 964.....                                      | 125762   | Piston, RE0F09A Forward Clutch (Aluminum) 2003-Up .....  | 1..... | TBA  |
| 964.....                                      | 125762B  | Piston, JF011E Forward Clutch (Bonded) 2007-Up .....   | 1..... | TBA  |
| 966.....                                      | 125763   | Piston, RE0F09A Reverse Clutch (Bonded) 2003-Up .....  | 1..... | TBA  |
| 966.....                                      | 125763B  | Piston, JF011E Reverse Clutch (Bonded) 2007-Up .....   | 1..... | TBA  |
| 974.....                                      | 125872   | Spring/Retainer, RE0F09A Forward Clu Return (1.286" Thick, 3.957" OD, 20 Springs) 2003-Up .....  | 1..... | TBA  |
| 974.....                                      | 125872B  | Spring/Retainer, JF011E Forward Clu Return, 2007-Up .....  | 1..... | TBA  |
| 976.....                                      | 125873   | Spring/Retainer, RE0F09A Reverse Clu Return (1.095" Thick, 7.062" OD) 2003-Up .....              | 1..... | TBA  |
| 976.....                                      | 125873B  | Spring/Retainer, JF011E Reverse Clu Return, 2007-Up .....  | 1..... | TBA  |
| 984.....                                      | 125862   | Piston Retainer, RE0F09A Forward Clutch Balance (Bonded) (2003-Up .....                          | 1..... | TBA  |
| 984.....                                      | 125862B  | Piston Retainer, JF011E Forward Clutch Balance (Bonded) 2007-Up .....                            | 1..... | TBA  |
| 991.....                                      | K125631  | Assy Manual Lever, RE0F09A (# 991-1, 991-2, 991-3, 991-4, 991-5, 991-6, 991-8) 2003-Up .....     | 1..... | TBA  |
| 991.....                                      | K125631B | Assy Manual Lever, JF011E (# 991-1, 991-2, 991-3, 991-4, 991-5, 991-6, 991-8) 2007-Up .....      | 1..... | TBA  |
| 994.....                                      | 125639   | Park Rod Actuator, RE0F09A (1.470" Long) 2003-Up .....   | 1..... | TBA  |
| 994.....                                      | 125639B  | Park Rod Actuator, JF011E, 2007-Up .....   | 1..... | TBA  |
| 995.....                                      | K125632  | Park Pawl Assembly, RE0F09A (Contains: # 995-1, 995-2, 995-3 & 991-6) 2003-Up .....              | 1..... | TBA  |
| 995.....                                      | K125632B | Park Pawl Assembly, JF011E (Contains: # 995-1, 995-2, 995-3 & 991-6) 2007-Up .....               | 1..... | TBA  |
| 998.....                                      | 125480   | Cooler, RE0F09A Transmission External (Steel) 2003-Up .....                                      | 1..... | TBA  |
| 998.....                                      | 125480A  | Cooler, RE0F09A Transmission External (Aluminum) 2003-Up .....                                   | 1..... | TBA  |

## RE0F09A (JF010E), RE0F10A (JF011E)

| ILL#       | Part#        |   | QTY     | REF# |
|------------|--------------|---|---------|------|
| 998.....   | 125480B..... | Cooler Housing, JF011E, (Uses 125711B Filter) 2007-Up .....                           | 1 ..... | TBA  |
| 999-1 .... | 125637 ..... | Oil Tube, RE0F09A Bolts To Rear Of Case (1-Bolt, 3.860" Long) 2003-Up .....           | 1 ..... | TBA  |
| 999-6 .... | 125638 ..... | Oil Tube, RE0F09A On Bell Housing For Front Pinion Bearing Lube (Copper) 2003-Up..... | 1 ..... | TBA  |

**RE0F09A (JF010E), RE0F10A (JF011E)****Notes**