

## 5-SPEED, 4-SHAFT (BCLA, B90A, MZJA)

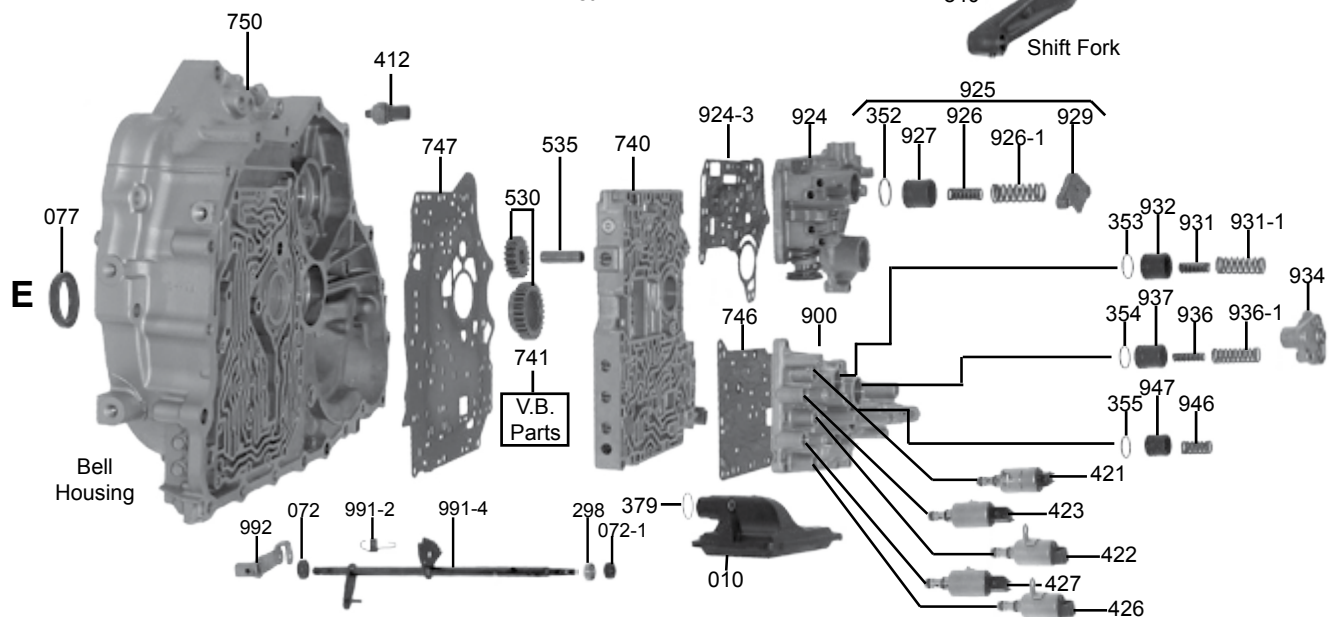

## 5-SPEED, 4-SHAFT (BCLA, B90A, MZJA)

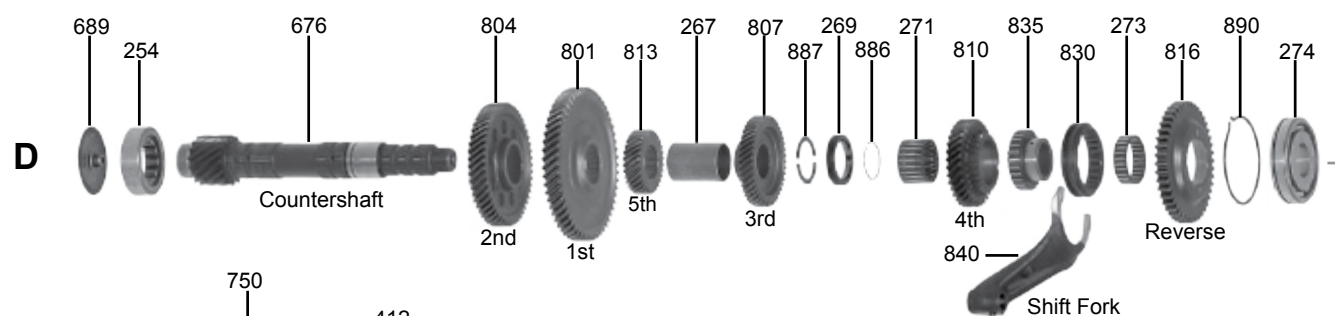
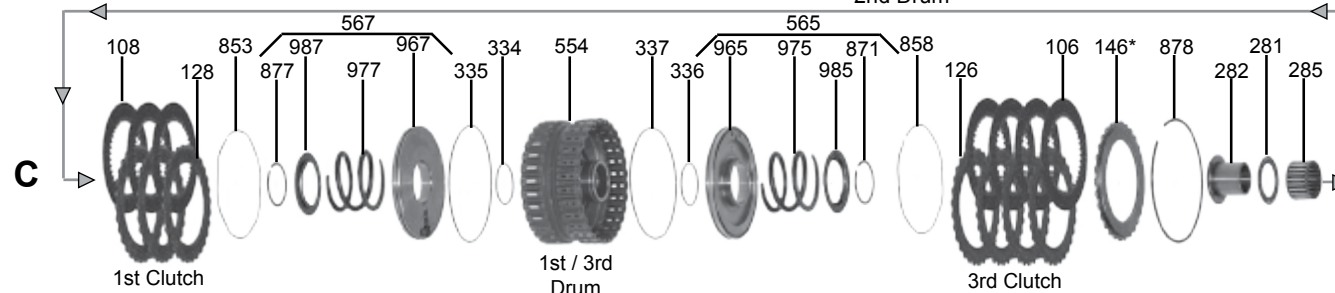
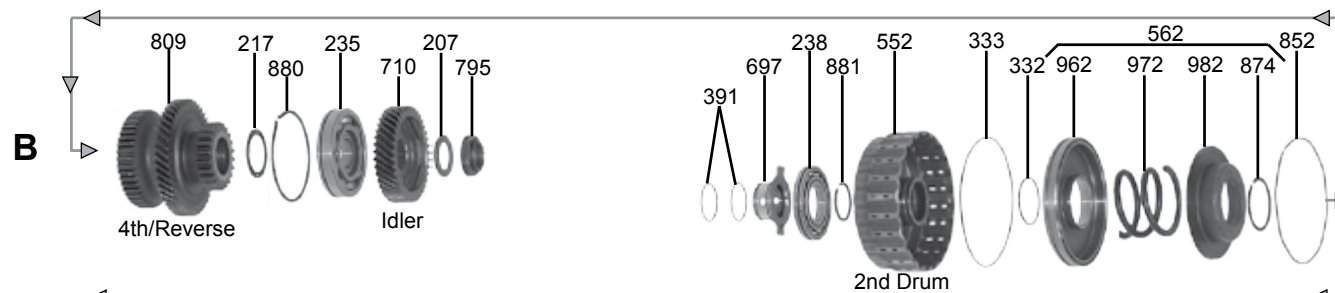
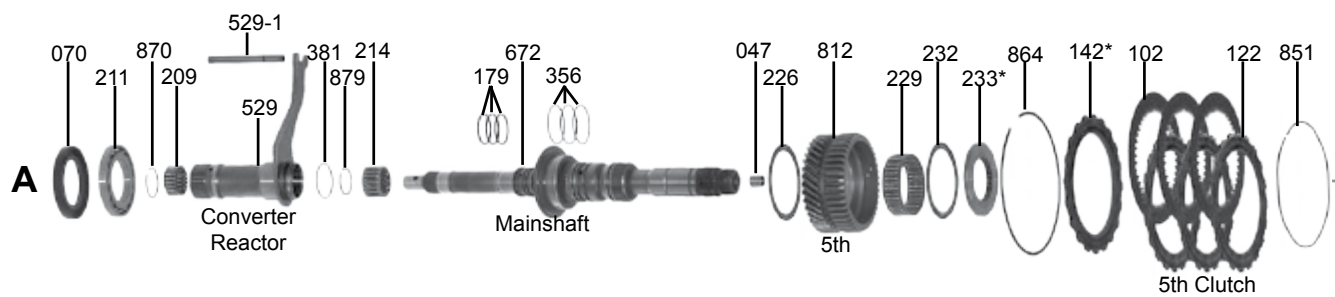
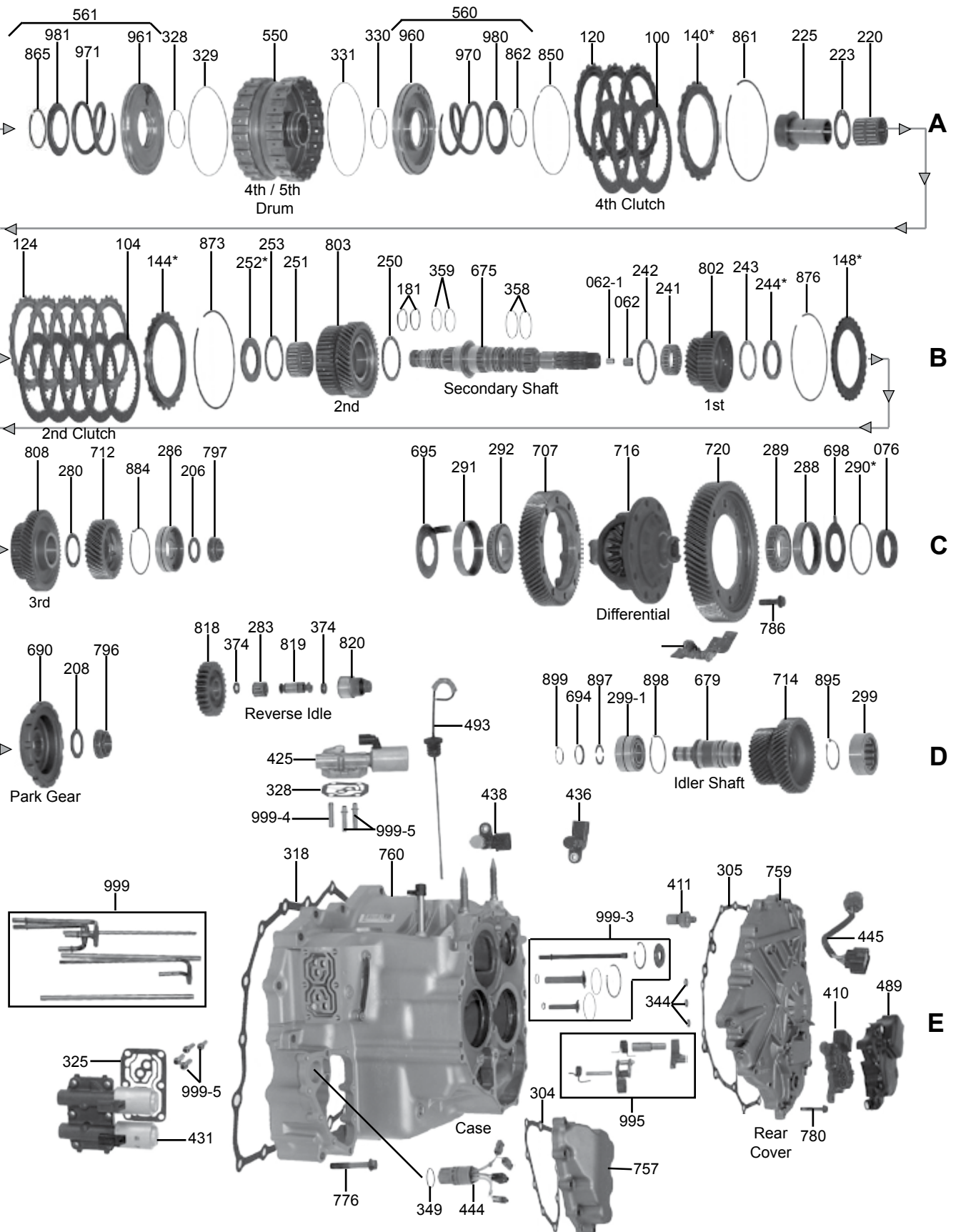

# HONDA & ACURA

## 5-SPEED, 4-SHAFT (BCLA, B90A, MZJA)

ILL#	Part#		QTY	REF#
<b>KITS</b>				
		BCLA/BZHA/BZJA/BZKA-1/BZNA/B90A/GPLA/GPPA-3-4/.....		
		MCLA/MCTA/MKYA/MKZA/MM7A/MNZA/MRMA/MZHA/MZJA/MZKA-5/M91A-.....		
		**SEE HONDA/ACURA OVERHAUL / BANNER / MASTER KIT QUICK REF **		
<b>FILTERS</b>				
		BCLA/BZHA/BZJA/BZNA/B90A/GPLA/GPPA/MCLA/MCTA/.....		
		MKYA/MKZA/MM7A/MNZA/MRMA/MZHA/MZJA/M91A.....		
		**SEE HONDA/ACURA FILTER QUICK REF FOR INTERNAL & AUX FILTERS**		
<b>BUSHINGS</b>				
047.....	186047.....	Bushing, Mainshaft (.398" Wide)(.415" OD)(.315" ID) 2002-11.....	1.....	TBA
062-1 ..	184062-1.....	Bushing, 2ndary Shaft (Small, Inner)(.318" Wide)(.275" ID) 2002-11.....	1.....	TBA
062.....	184062.....	Bushing, 2ndary Shaft (Large, Outer)(.393" Wide)(.455" ID) 2002-11.....	1.....	TBA
<b>METAL CLAD SEALS</b>				
		**SEE HONDA/ACURA KIT & FRONT SEAL / AXLE SEAL QUICK REF**		
072-1 ..	88198.....	Seal, MCVA/MRVA/BZKA/MZKA/GPPA Position Sensor (In Rear Cover)(.715" OD) 2006-11.....	1.....	91201-PA9-004
072.....	78197.....	Seal, MCVA/MRVA/BZKA/MZKA/GPPA Manual Control Shaft, 2006-11.....	1.....	91209-612-003
<b>FRICTIONS</b>				
100.....	98105G.....	Friction, 4th/5th, All Except B90A/M91A/MCTA (.075", 44T, 4.830" OD) 2002-Up.....	6-8.....	22545-P7T-003
100.....	121109.....	Friction, 4th/5th, B90A/M91A (.076", 44T, 4.881" OD) 2008-Up.....	8.....	22546-PPV-A03
100.....	98101G.....	Friction, 4th/5th, MCTA (.076", 44T, 4.670" OD) 2004.....	8.....	22544-PRP-003
100.....	98105G.....	Friction, 4th/5th, MCTA (.075", 44T, 4.830" OD) 2005-08.....	8.....	22545-P7T-003
104.....	98101G.....	Friction, 1st/2nd/3rd, All Except B90A/M91A/MCTA (.076", 44T, 4.670" OD) 2002-Up.....	12-15.....	22544-PRP-003
104.....	98101.....	Friction, 1st/2nd/3rd, B90A/M91A (.076", 44T, 4.725" OD) 2008-Up.....	10-11.....	22544-RCL-A01
104.....	98101.....	Friction, 1st/3rd, MCTA (.076", 44T, 4.725" OD) 2004-Up.....	10.....	22544-RCL-A01
104.....	98101G.....	Friction, 2nd, MCTA (.076", 44T, 4.670" OD) 2004-08.....	5.....	22544-PRP-003
119.....	K121ZVF.....	Friction Module, BCLA/BZKA/GPLA/GPPA/MCLA/MKYA/MRMA/MZKA 2003-Up (GPX).....	1.....	RCP96-230
119.....	K121NF.....	Friction Module, B90A 2008-Up.....	1.....	RCP96-255
119.....	K121EF.....	Friction Module, MCTA 2004 (With GPX Frictions).....	1.....	RCP96-269
119.....	K121EAF.....	Friction Module, MCTA 2005 (With GPX Frictions).....	1.....	RCP96-270
119.....	K121EBF.....	Friction Module, MCTA 2006-08 (With GPX Frictions).....	1.....	RCP96-271
<b>STEELS</b>				
120.....	121116B.....	Steel, 4th/5th Clu, All Exc BCLA/MCLA/MRMA/B90A/M91A/MCTA (.079", 24T, 3.695") 2002-Up.....	6-8.....	22653-PRP-901
120.....	121115.....	Steel, 4th/5th Clu, BCLA/MCLA (.090", 24T, 3.695") 2003-04.....	6.....	22653-RCL-003
120.....	121116B.....	Steel, 4th/5th Clu, BCLA/MCLA (.079", 24T, 3.695") 2005-Up.....	6-8.....	22653-PRP-901
120.....	98111G.....	Steel, 4th/5th Clu, MRMA (.079", 20T, 3.675") 2005-Up.....	6.....	22653-PRP-003
120.....	121116B.....	Steel, 4th/5th Clu, B90A/M91A (.079", 24T, 3.695") 2008-Up.....	6.....	22653-PRP-901
120.....	98111.....	Steel, 4th/5th Clu, MCTA (.079", 24T, 3.682" ID) 2004.....	8.....	22653-PRP-901
120.....	121116B.....	Steel, 4th/5th Clu, MCTA (.079", 24T, 3.695") 2005-Up.....	8.....	22653-PRP-901
124.....	98111.....	Steel, 2nd Clutch, All Except B90A/M91A/MCTA (.079", 24T, 3.682" ID) 2002-Up.....	4.....	22543-PX4-003
124.....	121112D.....	Steel, 2nd Clutch, B90A/M91A (.077", 24T, 3.675" ID) 2008-Up.....	6.....	22643-R90-003
124.....	98111.....	Steel, 2nd Clutch, MCTA (.079", 24T, 3.682" ID) 2004-Up.....	4.....	22543-PX4-003
126.....	98119.....	Steel, 1st/3rd Clutch, All Except MRMA/B90A/M91A/MCTA (.063", 24T, 3.675" ID) 2002-Up.....	10.....	22543-RCL-003
126.....	121111B.....	Steel, 1st/3rd Clutch, MRMA (.079", 20T, 3.680" ID) 2002-Up.....	8.....	22543-PRP-003
126.....	121115B.....	Steel, 1st/3rd Clutch, B90A/M91A (.062", 24T, 3.675" ID) 2008-Up.....	6.....	22543-R90-003
126.....	121111A.....	Steel, 1st/3rd Clutch, MCTA (.062", 30T, 3.690" ID) 2004-Up.....	10.....	22543-RCT-004
<b>PRESSURE PLATES</b>				
140.....	187140.....	Pressure Plate, All Exc 2004 MCTA 4th & 5th Clu (.082")(24T, 5.125" OD, 3.675" ID) 2002-11.....	1-2.....	22581-RCL-003
140.....	187140A.....	Pressure Plate, All Exc 2004 MCTA 4th & 5th Clu (.086")(24T, 5.125" OD, 3.675" ID) 2002-11.....	1-2.....	22582-RCL-003
140.....	187140B.....	Pressure Plate, All Exc 2004 MCTA 4th & 5th Clu (.090")(24T, 5.125" OD, 3.675" ID) 2002-11.....	1-2.....	22583-RCL-003
140.....	187140C.....	Pressure Plate, All Exc 2004 MCTA 4th & 5th Clu (.094")(24T, 5.125" OD, 3.675" ID) 2002-11.....	1-2.....	22584-RCL-003
140.....	187140D.....	Pressure Plate, All Exc 2004 MCTA 4th & 5th Clu (.098")(24T, 5.125" OD, 3.675" ID) 2002-11.....	1-2.....	22585-RCL-003
140.....	187140E.....	Pressure Plate, All Exc 2004 MCTA 4th & 5th Clu (.102")(24T, 5.125" OD, 3.675" ID) 2002-11.....	1-2.....	22586-RCL-003
140.....	187140F.....	Pressure Plate, All Exc 2004 MCTA 4th & 5th Clu (.106")(24T, 5.125" OD, 3.675" ID) 2002-11.....	1-2.....	22584-RCL-003
140.....	187140G.....	Pressure Plate, All Exc 2004 MCTA 4th & 5th Clu (.110")(24T, 5.125" OD, 3.675" ID) 2002-11.....	1-2.....	22588-RCL-003
140.....	187140H.....	Pressure Plate, All Exc 2004 MCTA 4th & 5th Clu (.114")(24T, 5.125" OD, 3.675" ID) 2002-11.....	1-2.....	22589-RCL-003
140.....	187140AA.....	Pressure Plate, MCTA 4th & 5th Clu (.082")(24T, 4.995" OD, 3.675" ID) 2004.....	1-2.....	22581-RAY-003
140.....	187140AB.....	Pressure Plate, MCTA 4th & 5th Clu (.086")(24T, 4.995" OD, 3.675" ID) 2004.....	1-2.....	22582-RAY-003
140.....	187140AC.....	Pressure Plate, MCTA 4th & 5th Clu (.090")(24T, 4.995" OD, 3.675" ID) 2004.....	1-2.....	22583-RAY-003
140.....	187140AD.....	Pressure Plate, MCTA 4th & 5th Clu (.094")(24T, 4.995" OD, 3.675" ID) 2004.....	1-2.....	22584-RAY-003
140.....	187140AE.....	Pressure Plate, MCTA 4th & 5th Clu (.098")(24T, 4.995" OD, 3.675" ID) 2004.....	1-2.....	22585-RAY-003
140.....	187140AF.....	Pressure Plate, MCTA 4th & 5th Clu (.102")(24T, 4.995" OD, 3.675" ID) 2004.....	1-2.....	22586-RAY-003
140.....	187140AG.....	Pressure Plate, MCTA 4th & 5th Clu (.106")(24T, 4.995" OD, 3.675" ID) 2004.....	1-2.....	22587-RAY-003



## 5-SPEED, 4-SHAFT (BCLA, B90A, MZJA)

ILL#	Part#		QTY	REF#
140.....	187140AH.....	Pressure Plate, MCTA 4th & 5th Clu (.110")(#8)(24T, 4.995" OD, 3.675" ID) 2004.....	1-2.....	22588-RAY-003
140.....	187140AJ.....	Pressure Plate, MCTA 4th & 5th Clu (.114")(#9)(24T, 4.995" OD, 3.675" ID) 2004.....	1-2.....	22589-RAY-003
142.....	See 187140.....	Use 187140 - 187140H All Exc 2004 MCTA 5th Clutch, 2002-11.....	1-2.....	TBA
142.....	See 187140AA.....	Use 187140AA - 187140AJ MCTA 5th Clutch, 2004.....	1-2.....	TBA
144.....	See 186148.....	Use 186148 - 186148H BCLA/BZKA-1/GPLA/GPPA-3/MCTA/MKYA/MKZA/MRMA 2nd Clu 2002-08.....	1-3.....	TBA
144.....	187144.....	P Plate, BZHA/BZNA/B90A/MCLA/MM7A/MNZA/MZHA/MZJA 2nd (.094") (24T, 3.680" ID, 5.085" OD).....	1.....	22569-RCL-A01
144.....	187144A.....	P Plate, BZHA/BZNA/B90A/MCLA/MM7A/MNZA/MZHA/MZJA 2nd (.098") (24T, 3.680" ID, 5.085" OD).....	1.....	22570-RCL-A01
144.....	187144B.....	P Plate, BZHA/BZNA/B90A/MCLA/MM7A/MNZA/MZHA/MZJA 2nd (.102") (24T, 3.680" ID, 5.085" OD).....	1.....	22571-RCL-A01
144.....	187144C.....	P Plate, BZHA/BZNA/B90A/MCLA/MM7A/MNZA/MZHA/MZJA 2nd (.106") (24T, 3.680" ID, 5.085" OD).....	1.....	22572-RCL-A01
144.....	187144D.....	P Plate, BZHA/BZNA/B90A/MCLA/MM7A/MNZA/MZHA/MZJA 2nd (.110") (24T, 3.680" ID, 5.085" OD).....	1.....	22573-RCL-A01
144.....	187144E.....	P Plate, BZHA/BZNA/B90A/MCLA/MM7A/MNZA/MZHA/MZJA 2nd (.114") (24T, 3.680" ID, 5.085" OD).....	1.....	22574-RCL-A01
144.....	187144F.....	P Plate, BZHA/BZNA/B90A/MCLA/MM7A/MNZA/MZHA/MZJA 2nd (.118") (24T, 3.680" ID, 5.085" OD).....	1.....	22575-RCL-A01
144.....	187144G.....	P Plate, BZHA/BZNA/B90A/MCLA/MM7A/MNZA/MZHA/MZJA 2nd (.122") (24T, 3.680" ID, 5.085" OD).....	1.....	22576-RCL-A01
145.....	121112A.....	Apply Plate, BCLA/GPLA/GPPA-3/MCTA/MKYA/MKZA 2nd Clutch (.157") (24T, 3.675" ID, 4.990" OD).....	1.....	22643-RCL-801
146.....	187146.....	Pressure Plate, MRMA 3rd & 1st (#148) Clutch (.090")(#1)(20T, 3.670" ID) 2002-06.....	1-2.....	22551-PRP-003
146.....	187146A.....	Pressure Plate, MRMA 3rd & 1st (#148) Clutch (.094")(#2)(20T, 3.670" ID) 2002-06.....	1-2.....	22552-PRP-003
146.....	187146B.....	Pressure Plate, MRMA 3rd & 1st (#148) Clutch (.098")(#3)(20T, 3.670" ID) 2002-06.....	1-2.....	22553-PRP-003
146.....	187146C.....	Pressure Plate, MRMA 3rd & 1st (#148) Clutch (.102")(#4)(20T, 3.670" ID) 2002-06.....	1-2.....	22554-PRP-003
146.....	187146D.....	Pressure Plate, MRMA 3rd & 1st (#148) Clutch (.106")(#5)(20T, 3.670" ID) 2002-06.....	1-2.....	22555-PRP-003
146.....	187146E.....	Pressure Plate, MRMA 3rd & 1st (#148) Clutch (.110")(#6)(20T, 3.670" ID) 2002-06.....	1-2.....	22556-PRP-003
146.....	187146F.....	Pressure Plate, MRMA 3rd & 1st (#148) Clutch (.114")(#7)(20T, 3.670" ID) 2002-06.....	1-2.....	22557-PRP-003
146.....	187146G.....	Pressure Plate, MRMA 3rd & 1st (#148) Clutch (.118")(#8)(20T, 3.670" ID) 2002-06.....	1-2.....	22558-PRP-003
146.....	187146H.....	Pressure Plate, MRMA 3rd & 1st (#148) Clutch (.122")(#9)(20T, 3.670" ID) 2002-06.....	1-2.....	22559-PRP-003
146.....	187146J.....	Pressure Plate, MRMA 3rd & 1st (#148) Clutch (.126")(#10)(20T, 3.670" ID) 2002-06.....	1-2.....	22560-PRP-003
146.....	187146K.....	Pressure Plate, MRMA 3rd & 1st (#148) Clutch (.130")(#11)(20T, 3.670" ID) 2002-06.....	1-2.....	22561-PRP-003
146.....	187146L.....	Pressure Plate, MRMA 3rd & 1st (#148) Clutch (.134")(#12)(20T, 3.670" ID) 2002-06.....	1-2.....	22562-PRP-003
146.....	187146AA.....	P Plate, Except MRMA/MCTA 3rd & 1st (.082")(#1)(24T, 3.675" ID) 2003-11.....	1-2.....	22551-RZH-003
146.....	187146AB.....	P Plate, Except MRMA/MCTA 3rd & 1st (.086")(#2)(24T, 3.675" ID) 2003-11.....	1-2.....	22552-RZH-003
146.....	187146AC.....	P Plate, Except MRMA/MCTA 3rd & 1st (.090")(#3)(24T, 3.675" ID) 2003-11.....	1-2.....	22553-RZH-003
146.....	187146AD.....	P Plate, Except MRMA/MCTA 3rd & 1st (.094")(#4)(24T, 3.675" ID) 2003-11.....	1-2.....	22554-RZH-003
146.....	187146AE.....	P Plate, Except MRMA/MCTA 3rd & 1st (.098")(#5)(24T, 3.675" ID) 2003-11.....	1-2.....	22555-RZH-003
146.....	187146AF.....	P Plate, Except MRMA/MCTA 3rd & 1st (.102")(#6)(24T, 3.675" ID) 2003-11.....	1-2.....	22556-RZH-003
146.....	187146AG.....	P Plate, Except MRMA/MCTA 3rd & 1st (.106")(#7)(24T, 3.675" ID) 2003-11.....	1-2.....	22557-RZH-003
146.....	187146AH.....	P Plate, Except MRMA/MCTA 3rd & 1st (.110")(#8)(24T, 3.675" ID) 2003-11.....	1-2.....	22558-RZH-003
146.....	187146AJ.....	P Plate, Except MRMA/MCTA 3rd & 1st (.114")(#9)(24T, 3.675" ID) 2003-11.....	1-2.....	22559-RZH-003
146.....	187146BA.....	Pressure Plate, MCTA 3rd & 1st (#148) (.102")(#1)(30T, 3.690" ID) 2004-05.....	1-2.....	22551-RCT-004
146.....	187146BB.....	Pressure Plate, MCTA 3rd & 1st (#148) (.106")(#2)(30T, 3.690" ID) 2004-05.....	1-2.....	22552-RCT-004
146.....	187146BC.....	Pressure Plate, MCTA 3rd & 1st (#148) (.110")(#3)(30T, 3.690" ID) 2004-05.....	1-2.....	22553-RCT-004
146.....	187146BD.....	Pressure Plate, MCTA 3rd & 1st (#148) (.114")(#4)(30T, 3.690" ID) 2004-05.....	1-2.....	22554-RCT-004
146.....	187146BE.....	Pressure Plate, MCTA 3rd & 1st (#148) (.118")(#5)(30T, 3.690" ID) 2004-05.....	1-2.....	22555-RCT-004
146.....	187146BF.....	Pressure Plate, MCTA 3rd & 1st (#148) (.122")(#6)(30T, 3.690" ID) 2004-05.....	1-2.....	22556-RCT-004
146.....	187146BG.....	Pressure Plate, MCTA 3rd & 1st (#148) (.126")(#7)(30T, 3.690" ID) 2004-05.....	1-2.....	22557-RCT-004
146.....	187146BH.....	Pressure Plate, MCTA 3rd & 1st (#148) (.130")(#8)(30T, 3.690" ID) 2004-05.....	1-2.....	22558-RCT-004
146.....	187146BJ.....	Pressure Plate, MCTA 3rd & 1st (#148) (.134")(#9)(30T, 3.690" ID) 2004-05.....	1-2.....	22559-RCT-004
146.....	See 186148.....	Use 186148 - 186148H BCLA/GPLA/GPPA-3/MKYA/MKZA 3rd Clutch 2003-06.....	1-3.....	TBA
148.....	See 187146.....	Use 187146 - 187146L MRMA 1st Clutch 2002-06.....	1-2.....	TBA
148.....	See 187144.....	Use 187144 - 187144G BZHA/BZNA/B90A/MCLA/MM7A/MNZA/MZHA/MZJA 1st Clutch 2003-11.....	1.....	TBA
148.....	See 187146BA.....	Use 187146BA - 187146BJ MCTA 1st Clutch 2004-05.....	1-2.....	TBA
148.....	186148.....	Pressure Plate, BCLA/GPLA/GPPA-3/MKYA/MKZA 1st Clutch (.102")(#1)(24T, 3.675" ID) 2003-06.....	1-3.....	22551-RCL-003
148.....	186148A.....	Pressure Plate, BCLA/GPLA/GPPA-3/MKYA/MKZA 1st Clutch (.106")(#1)(24T, 3.675" ID) 2003-06.....	1-3.....	22552-RCL-003
148.....	186148B.....	Pressure Plate, BCLA/GPLA/GPPA-3/MKYA/MKZA 1st Clutch (.110")(#1)(24T, 3.675" ID) 2003-06.....	1-3.....	22553-RCL-003
148.....	186148C.....	Pressure Plate, BCLA/GPLA/GPPA-3/MKYA/MKZA 1st Clutch (.114")(#1)(24T, 3.675" ID) 2003-06.....	1-3.....	22554-RCL-003
148.....	186148D.....	Pressure Plate, BCLA/GPLA/GPPA-3/MKYA/MKZA 1st Clutch (.118")(#1)(24T, 3.675" ID) 2003-06.....	1-3.....	22555-RCL-003
148.....	186148E.....	Pressure Plate, BCLA/GPLA/GPPA-3/MKYA/MKZA 1st Clutch (.122")(#1)(24T, 3.675" ID) 2003-06.....	1-3.....	22556-RCL-003
148.....	186148F.....	Pressure Plate, BCLA/GPLA/GPPA-3/MKYA/MKZA 1st Clutch (.126")(#1)(24T, 3.675" ID) 2003-06.....	1-3.....	22557-RCL-003
148.....	186148G.....	Pressure Plate, BCLA/GPLA/GPPA-3/MKYA/MKZA 1st Clutch (.130")(#1)(24T, 3.675" ID) 2003-06.....	1-3.....	22558-RCL-003
148.....	186148H.....	Pressure Plate, BCLA/GPLA/GPPA-3/MKYA/MKZA 1st Clutch (.134")(#1)(24T, 3.675" ID) 2003-06.....	1-3.....	22559-RCL-003
<b>SEALING RINGS</b>				
175.....	187175.....	Ring Kit, 2002-11.....	1.....	TBA
<b>WASHERS &amp; BEARINGS</b>				
206.....	98401.....	Washer, 2ndary Shaft To Nut 2002.....	1-3.....	23926-P24-J00
207.....	98401.....	Washer, Mainshaft To Nut 2002-Up.....	1-3.....	23926-P24-J00
208.....	98401.....	Washer, Countershaft To Nut 2002-Up.....	1-3.....	23926-P24-J00
209.....	88209M.....	Caged Needle Bearing, Stator (Front)(1.040" OD) 2002-11.....	1.....	TBA
214.....	186214.....	Caged Needle Bearing, Mainshaft To Converter Reactor (.695" Thick) (1.115" OD) 2002-11.....	1.....	91017-PZK-003
217.....	98432.....	Bearing, 4th/Reverse Gear (Rear) (.078" Thick)(1.800" OD) 2002-11.....	1.....	91018-PW7-A02

## 5-SPEED, 4-SHAFT (BCLA, B90A, MZJA)

ILL#	Part#		QTY	REF#
220	186229	Caged Needle Bearing, 4th/Reverse Gear To Mainshaft (1.535" Long) (1.545" OD) 2002-11	1	91107-PRP-003
223	98429	Bearing, Collar To 4th/Reverse Gear (.097" Thick)(2.094" OD) 2002-11	1	91023-P7Z-003
225	186225	Collar, 4th/5th Drum To 4th Gear (Mainshaft)(2.615" Long)(1.060" ID) 2002-11	1	90501-PRP-000
226	186217	Thrust Bearing, Mainshaft To 3rd Gear (2.790" OD, 2.270" ID) 2002-11	1-2	91026-PRP-003
229	186220	Caged Needle Bearing, Mainshaft To 5th Gear (.697" Thick)(2.215" OD) 2002-11	1	91109-PRP-003
232	186217	Thrust Bearing, 5th Gear (Rear)(Mainshaft) (2.790" OD, 2.270" ID) 2002-11	1-2	91026-PRP-003
233	186224	Washer, 5th Gear (Mainshaft) To 4th/5th Drum (.175" Thick)(2.765" OD) 2002-11	1	90414-RCT-000
233	186224A	Washer, 5th Gear (Mainshaft) To 4th/5th Drum (.176" Thick)(2.765" OD) 2002-11	1	90415-RCT-000
233	186224B	Washer, 5th Gear (Mainshaft) To 4th/5th Drum (.177" Thick)(2.765" OD) 2002-11	1	90416-RCT-000
233	186224C	Washer, 5th Gear (Mainshaft) To 4th/5th Drum (.216" Thick)(2.765" OD) 2002-11	1	90418-RCT-000
233	186224D	Washer, 5th Gear (Mainshaft) To 4th/5th Drum (.219" Thick)(2.765" OD) 2002-11	1	90419-RCT-000
233	186224E	Washer, 5th Gear (Mainshaft) To 4th/5th Drum (.255" Thick)(2.765" OD) 2002-11	1	90417-PRP-010
235	187235	Ball Bearing, Mainshaft To Case (.710" Thick)(3.330" OD)(1.060" ID) (8-Balls)(#27BCS11) 2002-11	1	91002-RCR-026
238	186238	Ball Bearing, Bell Housing To 2ndary Shaft (Cast # TA-SX06C51NV1) 2002-11	1	91005-PRP-003
241	187241	Caged Needle Bearing, 1st Gear To 2ndary Shaft (.615" Thick)(1.827" OD) 2002-11	1	91105-PRP-005
242	186242	Thrust Bearing, (.099" Thick)(2.338" OD)(1.842" ID) 2002-11	1-3	91022-PRP-003
243	188232	Bearing, 1st Gear To 1st/3rd Drum (.099" Thick)(2.065" OD)(1.580" ID) 2002-11	1	91021-PRP-013
244	186244	Washer, 1st Gear To 1st/3rd Drum (.189" Thick)(2.030" OD) 2002-11	1	90503-RCT-000
244	186244A	Washer, 1st Gear To 1st/3rd Drum (.191" Thick)(2.030" OD) 2002-11	1	90504-RCT-000
244	186244B	Washer, 1st Gear To 1st/3rd Drum (.193" Thick)(2.030" OD) 2002-11	1	90505-PRP-000
244	186244C	Washer, 1st Gear To 1st/3rd Drum (.195" Thick)(2.030" OD) 2002-11	1	90506-RCT-000
244	186244D	Washer, 1st Gear To 1st/3rd Drum (.197" Thick)(2.030" OD) 2002-11	1	90507-PRP-000
244	186244E	Washer, 1st Gear To 1st/3rd Drum (.199" Thick)(2.030" OD) 2002-11	1	90508-PRP-000
250	186242	Thrust Bearing, 2nd Gear To 2ndary Shaft (.099" Thick)(2.338" OD)(1.842" ID) 2002-11	1	91022-PRP-003
251	186251	Caged Needle Bearing, 2nd Gear To 2ndary Shaft (.790" Thick)(1.783" OD) 2002-11	1	91106-PRP-025
252	186252	Washer, 2nd Drum To 2nd Gear (.153" Thick)(2.285" OD) 2002-11	1	90511-PRP-010
252	186252A	Washer, 2nd Drum To 2nd Gear (.154" Thick)(2.285" OD) 2002-11	1	90512-PRP-010
252	186252B	Washer, 2nd Drum To 2nd Gear (.155" Thick)(2.285" OD) 2002-11	1	90513-PRP-010
252	186252C	Washer, 2nd Drum To 2nd Gear (.156" Thick)(2.285" OD) 2002-11	1	90514-PRP-010
252	186252D	Washer, 2nd Drum To 2nd Gear (.157" Thick)(2.285" OD) 2002-11	1	90515-PRP-010
252	186252E	Washer, 2nd Drum To 2nd Gear (.158" Thick)(2.285" OD) 2002-11	1	90516-PRP-010
252	186252F	Washer, 2nd Drum To 2nd Gear (.159" Thick)(2.285" OD) 2002-11	1	90517-PRP-010
252	186252G	Washer, 2nd Drum To 2nd Gear (.160" Thick)(2.285" OD) 2002-11	1	90518-PRP-010
252	186252H	Washer, 2nd Drum To 2nd Gear (.161" Thick)(2.285" OD) 2002-11	1	90519-PRP-010
252	186252J	Washer, 2nd Drum To 2nd Gear (.162" Thick)(2.285" OD) 2002-11	1	90520-PRP-010
252	186252K	Washer, 2nd Drum To 2nd Gear (.163" Thick)(2.285" OD) 2002-11	1	90521-PRP-010
252	186252L	Washer, 2nd Drum To 2nd Gear (.164" Thick)(2.285" OD) 2002-11	1	90522-PRP-010
252	186252M	Washer, 2nd Drum To 2nd Gear (.165" Thick)(2.285" OD) 2002-11	1	90523-RP-000
252	186252N	Washer, 2nd Drum To 2nd Gear (.166" Thick)(2.285" OD) 2002-11	1	90524-PRP-000
252	186252P	Washer, 2nd Drum To 2nd Gear (.167" Thick)(2.285" OD) 2002-11	1	90525-PRP-000
252	186252Q	Washer, 2nd Drum To 2nd Gear (.168" Thick)(2.285" OD) 2002-11	1	90526-PRP-000
252	186252R	Washer, 2nd Drum To 2nd Gear (.169" Thick)(2.285" OD) 2002-11	1	90527-PRP-000
252	186252S	Washer, 2nd Drum To 2nd Gear (.170" Thick)(2.285" OD) 2002-11	1	90528-PRP-000
252	186252T	Washer, 2nd Drum To 2nd Gear (.171" Thick)(2.285" OD) 2002-11	1	90529-PRP-000
252	186252U	Washer, 2nd Drum To 2nd Gear (.172" Thick)(2.285" OD) 2002-11	1	90530-PRP-000
253	186242	Thrust Bearing, 2nd Drum To 2nd Gear (.099" Thick)(2.338" OD)(1.842" ID) 2002-11	1-3	91022-PRP-003
254	187254	Brg, B/MCLA/BZKA-1/BZNA/B90A/MCTA/MM7A/MNZA/MZHA/MZJA Bell To Counter(.780")	1	91102-PPV-003
254	187254A	Brg, GPLA/GPPA-3/MKYA/MKZA/MRMA Bell Hsg To Countershaft (.765" Thick) 2002-06	1	91102-RFK-003
267	187267	Collar, BCLA/MCTA/MRMA 3rd Gear To 5th Gear (Counter)(2.275" Thick)(1.615" OD) (1.460" ID) 03-08	1	90441-PRP-010
267	187267A	Collar, 3rd Gear To 5th Gear (Countershaft)(2.138" Thick)(1.165" OD)(1.460" ID) 2003-11	1	90441-RFK-010
269	186269	Collar, Holds Horse Shoe Clips To Countershaft (.305" Thick)(1.845" OD) (1.380" ID) 2002-11	1	90445-PPV-000
271	98440	Caged Needle Bearing, 4th Gear (Countershaft)(Inner)(1.007" Thick) 2002-11	1	91028-POZ-013
273	186273	Caged Needle Bearing, Rev Gear (Countershaft)(Inner)(.560" Thick)(1.780" OD) 2002-11	1	91024-PRP-004
274	187274	Ball Bearing, Countershaft To Case (3.150" OD)(1.215" ID)(9 Balls) (# NSK HFT B31-28) 2002-11	1	91003-RFK-025
280	187280	Bearing, Idler Gear To 3rd Gear (2ndary)(.099" Thick)(2.235" OD) (1.463" ID) 2002-11 (Also # 281)	1-2	91027-PRP-003
281	187280	Bearing, (.099" Thick)(2.235" OD) (1.463" ID) 2002-11 (Also # 280)	1-2	91027-PRP-003
282	187282	Collar, 3rd Gear To 2ndary Shaft (.208" Thick Flange) (1.730" Long) (W/12 Inner Splines) 2002-11	1	90443-PRP-000
283	186283	Caged Needle Bearing, Rev Idler Gear To Shaft (.615" Thick)(.750" OD) 2002-11	1	91025-POX-003
285	187285	Bearing, 3rd Gear (Inner) To 2ndary Shaft (1.310" Thick)(1.670" OD) 2002-11	1	91028-PRP-003
286	187286	Ball Bearing, 2ndary Shaft To Case (.570" Thick)(2.165" OD)(1.052" ID) (9-Balls)(Cast # S7K LE3)	1	91004-RCR-003
288	187288	Race, BZHA/BZKA-1/BZNA/MCLA/MNZA/MZHA/MZJA Diff To Case (.655" Thk)(#08818-1) 2003-11	1	TBA
288	186288	Race, BCLA/B90A/GPLA/GPPA-3/MCTA/MKYA/MKZA/MM7A/MRMA Diff To Case (.540" Thk)(#08A78-1)	1	TBA
289	187289	Brg, BZHA/BZKA-1/BZNA/MCLA/MNZA/MZHA/MZJA Diff To Case (Cast # NTN ECO CR-08822-1)	1	TBA
289	186289	Brg, BCLA/B90A/GPLA/GPPA-3/MCTA/MKYA/MKZA/MM7A/MRMA Diff To Case (#CR-08A78-1/2)	1	TBA
290	*186290	*Selective Shim, Diff Cup Race To Case (.061" To .121" Thick) (2.980" OD, 2.680" ID) 2002-11	1	41428-PRP-000
291	187291	Race, BCLA/B90A/GPLA/GPPA-3/MCTA/MKYA/MKZA/MM7A/MRMA Diff To Bell (#ECO CR08A97-1)	1	91121-RFK-013
291	187291A	Race, BZHA/BZKA-1/BZNA/MCLA/MNZA/MZHA/MZJA Diff To Bell (Cast # ECO CR08817-1) 2003-11	1	91121-RZH-003
292	187292	Brg, BCLA/B90A/GPLA/GPPA-3/MCTA/MKYA/MKZA/MM7A/MRMA Diff To Bell (#CR08802-1) 02-11	1	91121-RFK-013

## 5-SPEED, 4-SHAFT (BCLA, B90A, MZJA)

ILL#	Part#		QTY	REF#
292.....	187292A.....	Bearing, BZHA/BZKA-1/BZNA/MCLA/MNZA/MZHA/MZJA Diff To Bell (#ECO CR08817-2) 2003-11 .....	1 .....	91121-RZH-003
298.....	188298.....	Ball Bearing, Shift Rod To Case (.235" Thick)(.945" OD)(.472" ID) 2002-11 .....	1 .....	91010-RJF-005
299-1.....	186299-1.....	Double Ball Brg, Idler Shaft To Case (.943" Thick)(1.890" OD)(.785" ID) (# 20BG04S6N) 2002-11 .....	1 .....	91006-PRP-026
299.....	186299.....	Brg, Idler Gear To Idler Shaft (.727" Thick)(2.165" OD)(11 Rollers) (# HL-BE-NK 32X55X18.5PX1).....	1 .....	91103-RCL-023
<b>GASKETS &amp; RUBBER COMPONENTS</b>				
305.....	121958.....	Gasket, Rear/Left Side Cover, MRMA, 2002-Up.....	1 .....	21812-PRP-010
305.....	121958A.....	Gasket, Rear/Left Side Cover, Except MRMA, 2002-Up .....	1 .....	21812-PRP-030
318.....	121597.....	Gasket, Converter Case, BCLA/MCLA/MRMA/MKYA/GPLA, 2002-Up .....	1 .....	21811-PRP-010
318.....	121597A.....	Gasket, Converter Case, MKZA/GPPA, 2005-07 .....	1 .....	21811-PRH-000
<b>ELECTRICAL COMPONENTS</b>				
		**SEE HONDA/ACURA SOLENOID QUICK REF FOR SOLENOIDS & PRESS SWITCHES** .....		
410.....	187410.....	Switch, Neutral Safety (10-Blade Conn) 2002-11 .....	1 .....	28900-RCR-003
436.....	188436.....	Sensor, BZHA/BZKA-1/BZNA/B90A/MCLA/MM7A/MNZA/MZHA/MZJA, Rear Case (#7511F) .....	1 .....	28820-RWE-003
436.....	98910.....	Sensor, BCLA/GPLA/GPPA-3/MCTA/MKYA/MKZA/MRMA (Side, Rear Case) (.700" OD Plastic Tip).....	1 .....	28820-PPW-013
438.....	98910A.....	Sensor, BCLA/GPLA/GPPA-3/MCTA/MKYA/MKZA/MRMA (3 Prg)(.750" OD Chrome Tip) (Front Case).....	1 .....	28810-PPW-013
438.....	187438.....	Sensor, BZHA/BZKA-1/BZNA/B90A/MCLA/MM7A/MNZA/MZHA/MZJA (2.780" Long)(Side, Front Case).....	1 .....	28810-RZH-004
444.....	187444.....	Case Connector, (7-Pin Case Conn, W/3 One Pin & 2 Two Pin Connectors) 2002-11 .....	1 .....	28360-PRP-003
445.....	186445.....	Wire Harness, (10 7/8" Long)(10-Wire) 2002-11 .....	1 .....	28950-PRP-010
<b>MISCELLANEOUS COMPONENTS</b>				
489.....	187489.....	Cover, Neutral Safety Switch (Black) 2002-11 .....	1 .....	21720-PRP-020
492.....	184492.....	Drain Plug, 2002-11 .....	1 .....	90081-PX4-003
493.....	184493A.....	Dip Stick, BCLA/BZHA/MCLA/MCTA/MM7A/MZHA/MZJA (11-7/8" Long)(In Solenoid Cover) 2003-11 .....	1 .....	25610-RG5-003
493.....	186493.....	Dip Stick, BZKA-1/BZNA/B90A/GPLA/GPPA-3/MKYA/MKZA/MRMA/MNZA (12", Top Rear Of Case).....	1 .....	25610-PPW-023
<b>PUMP COMPONENTS</b>				
529-1....	186529-1.....	Dowel Pin, Stator Tube Stop (.313" OD)(3.145" Long) 2002-11 1 .90701-PK4-000.....	1 .....	90701-PK4-000
529.....	186529.....	Tube, Stator (3.910" Long Shaft) 2002-11 1 .25155-PRP-000 .....	1 .....	25155-PRP-000
530.....	88201.....	Pump Gears (38 Spline Gear)(28 Teeth) (.470" Thick) 1 .....	1 .....	TBA
535.....	88535M.....	Pin, Pump Gear 2002-11 .....	1 .....	25145-PA9-010
<b>DRUMS</b>				
550.....	187550.....	Drum, All Except MCTA 4th/5th Drum (2.745" Thick)(5.255" OD) 2002-11 1 .22651-RFK-003.....	1 .....	22651-RFK-003
550.....	187550A.....	Drum, MCTA 4th/5th Drum (2.755" Thick)(5.133" OD) 2004-08 1 .22651-RFK-J01.....	1 .....	22651-RFK-J01
552.....	187552.....	Drum, BCLA/GPLA/GPPA-3/MCTA/MKYA/MKZA 2nd Clutch (1.890" Thick)(5.156" OD) 2003-08.....	1 .....	22621-RCL-003
552.....	187552A.....	Drum, MRMA 2nd Clutch (1.665" Thick)(5.156" OD)(Uses 24T Steels) 2003-06 1 .22621-PRP-013 .....	1 .....	22621-PRP-013
552.....	187552B.....	Drum, BZHA/BZKA-1/BZNA/B90A/MCLA/MM7A/MNZA/MZHA/MZJA 2nd (1.935" Thk) (5.245" OD) 03-11 .....	1 .....	22621-RCL-A02
554.....	187554.....	Drum, BCLA/GPLA/GPPA-3/MKYA/MKZA 1st/3rd Clutch (3.440" Thick)(5.161" OD) 2003-06.....	1 .....	22510-RCL-003
554.....	187554A.....	Drum, MRMA 1st/3rd Clutch (3.290" Thick)(5.230" OD) 2002-06 1 .22510-PRP-003.....	1 .....	22510-PRP-003
554.....	187554B.....	Drum, BZHA/BZKA-1/BZNA/B90A/MCLA/MM7A/MNZA/MZHA/MZJA 1st/3rd Clu (3.430" Thk)(5.250" OD) .....	1 .....	22510-RCL-A02
554.....	187554C.....	Drum, MCTA 1st/3rd Clutch (3.443" Thick)(5.233" OD) 2004-08 1 .22510-RCT-014 .....	1 .....	22510-RCT-014
560.....	187560.....	Piston Kit, BCLA/GPLA 4th & 5th (#561) Clutch 2003-06 2002-11 .....	1-2 .....	TBA
560.....	187560A.....	Piston Kit, All Except BCLA/GPLA 4th & 5th (#561) Clutch 2002-11 .....	1-2 .....	TBA
<b>SHAFTS</b>				
672.....	187672.....	Mainshaft, All Except MRMA (14-3/8" Long) (2 Or 3-ID) (2.750" OD Flange) 2003-11.....	1 .....	23210-RCL-010
672.....	187672A.....	Mainshaft, MRMA (14-3/8" Long) (No-ID)(2.750" OD Flange) 2002-06 .....	1 .....	23210-PRP-000
675.....	187675.....	2ndary Shaft (12"-Long) 2002-11 .....	1 .....	23230-PRP-020
676.....	187676.....	Countershaft, BCLA/MCTA (16-Teeth, 4-ID) 2003-08 .....	1 .....	23221-RCT-010
676.....	187676A.....	Countershaft, MRMA (16-Teeth, No-ID) 2002-06 .....	1 .....	23221-PRP-000
676.....	187676B.....	Countershaft, BZHA/BZKA-1/BZNA/MCLA/MNZA/MZHA/MZJA (16T, 2-ID) (11-5/8" Long) 2003-11 .....	1 .....	23221-RZH-000
676.....	187676C.....	Countershaft, B90A/MM7A (16-Teeth, 1 Wide ID) 2008-11 .....	1 .....	23221-RH3-020
676.....	187676D.....	Countershaft, GPLA/GPPA-3/MKYA/MKZA (16 Teeth, 3-ID)(11-5/8" Long) 2005-06 .....	1 .....	23221-RTH-000
679.....	186679.....	Shaft, Idler (3.400" Long)(.152" Thick Flange) 2002-11.....	1 .....	23516-RCL-010
<b>DIFFERENTIALS</b>				
689.....	187689.....	Oil Baffle, Diff Housing To Bell Hsg (.037" Thick)(3.135" OD) (1.615" ID)(W/1 Large Tab) 2002-11 .....	1 .....	41381-PPV-000
689.....	186689.....	Oil Guide, Bell Housing To Countershaft (Tin)(.026" Thick)(2.510" OD) 2002-11.....	1 .....	23225-PRP-020
690.....	186690.....	Parking Gear, (15 Lugs)(4.405" OD) 2002-11 .....	1 .....	23427-PRP-000
694.....	186694.....	Retainer, Holds Horse Shoe Clips To Idler Shaft (.101" Thick)(1.060" OD) (.789" ID) 2002-11.....	1 .....	90432-PRP-000
697.....	186697.....	Oil Guide Collar, In Bell Hsg Under #238 Brg (Alum)(.850" Thick) (1.140" ID, 2-O-Rings) 2002-11 .....	1 .....	23235-PRP-000
698.....	186698.....	Spacer, Differential To Case (.040" Thick)(2.995" OD)(1.620" ID)(1 Tab) 2002-11.....	1 .....	41382-PRP-010
707.....	187707.....	Transfer Gear, BZHA/BZNA/MCLA/MZHA Drive (69 Teeth, 1-ID) 2003-11 .....	1 .....	29011-RZH-000
707.....	186707.....	Transfer Gear, GPPA-3/MKZA Drive (69 Teeth, No -ID)(1.180" Thick)(10 Bolt) 2005-06 .....	1 .....	29011-PRV-010
710.....	187710.....	Gear, BZNA/MNZA/MZJA Idler (Mainshaft)(39 Teeth, 3-ID)(3.500" OD) 2007-11 .....	1 .....	23511-RCL-A00
710.....	187710A.....	Gear, BZHA/BZKA-1/B90A/MCLA/MM7A/MZHA Idler (Mainshaft)(39 Teeth, No -ID) 2003-11 .....	1 .....	23511-R90-000
710.....	186710.....	Gear, BCLA Idler (Mainshaft)(39 Teeth, 2-ID) 2003-06 .....	1 .....	TBA



## 5-SPEED, 4-SHAFT (BCLA, B90A, MZJA)

ILL#	Part#		QTY	REF#
710.....	186710A.....	Gear, GPLA/GPPA-3/MCTA/MKYA/MKZA/MMRA Idler (Mainshaft)(39 Teeth, 1 -ID) 2002-08.....	1.....	23511-RCL-010
712.....	187712.....	Gear, BCLA/GPLA/GPPA-3/MCTA/MKYA Idler (2ndary)(34T, 2-ID On 4-Notch Side)(3.380" OD).....	1.....	23521-RCL-000
712.....	187712A.....	Gear, BZHA/BZKA-1/BZNA/MCLA/MZHA Idler (2ndary)(34T, 2 -IDs Smooth Side)(3.380" OD).....	1.....	23521-RFK-900
712.....	187712B.....	Gear, MRMA Idler (2ndary Shaft)(39 Teeth, No -ID)(3.365" OD) 2002-06.....	1.....	23521-PRP-010
712.....	187712C.....	Gear, B90A/MM7A/MZJA Idler (2ndary Shaft)(34T, 2 -ID)(1-ID On Each Side)(3.380" OD) 2007-11.....	1.....	23251-R90-000
714.....	187714.....	Idler Gear, BCLA/BZHA/BZKA-1/MZHA/MZJA (33T, 1 -ID)(44T, 3 -ID) (2.305" Thick)(1.415" ID).....	1.....	23515-RCL-A00
714.....	187714A.....	Idler Gear, BNZA/MCLA/MNZA (30 Teeth, 1 -ID)(44 Teeth, 1 -ID)(2.305" Thick) (1.415" ID) 2003-08.....	1.....	23515-RCL-A00
714.....	187714B.....	Idler Gear, B90A/MM7A/MRMA (30 Teeth, No -ID)(44 Teeth, 3 -ID)(2.305" Thick) (1.415" ID) 2002-11.....	1.....	23515-R90-000
714.....	187714C.....	Idler Gear, GPLA/GPPA-3/MCTA/MKYA/MKZA (30T, 2 -ID)(44T, No -ID) (2.305" Thick)(1.415" ID).....	1.....	23515-RCL-010
716.....	187716.....	Diff Hsg, BCLA/B90A/GPLA/MCTA/MKYA/MM7A/MRMA (10-Bolt)(.440" Thk Flange)(1.1" ID Axle Hole).....	1.....	41100-R90-000
716.....	187716A.....	Diff Hsg, BZKA-1/MZJA (14-Threaded Bolt Holes)(.630" Thick Flange) (1.095" ID Axle Hole) 07-11.....	1.....	41100-RZJ-003
716.....	187716B.....	Diff Hsg, BZHA/BZNA/MCLA/MNZA/MZHA (14-Non-Thread Holes) (.520" Flange)(1.095" ID Axle Hole).....	1.....	41100-RZH-003
716.....	187716C.....	Diff Hsg, GPPA-3/MKZA (W/10 Non-Threaded Bolt Holes)(.400" Thk Flange) (1.105" ID Axle Hole).....	1.....	41100-RKZ-030
720.....	187720.....	Diff Ring Gear, BZKA-1/MNZA (72 Teeth, 1 -ID)(14 Bolt) 2007-08.....	1.....	41233-RZH-000
720.....	187720A.....	Diff Ring Gear, MRMA (73 Teeth, 2 -ID)(10 Bolt) 2002-06.....	1.....	41233-PRP-000
720.....	187720B.....	Diff Ring Gear, BZHA/BZNA/MCLA/MZHA/MZJA (71 Teeth, 1 -ID)(14 Bolt) 2003-11.....	1.....	TBA
720.....	187720C.....	Diff Ring Gear, MCTA/MM7A (71 Teeth, No -ID)(10 Bolt) 2004-11.....	1.....	41233-RCT-000
720.....	187720D.....	Diff Ring Gear, GPPA-3/MKZA (71 Teeth, 4 -ID)(3 On Case Side, 1 On Bell Side) (10 Bolt) 2005-06.....	1.....	41233-RFL-010
720.....	187720E.....	Diff Ring Gear, GPLA/MKYA (71 Teeth, 4 -ID)(2 On Case Side, 2 On Bell Side) (10 Bolt) 2006-06.....	1.....	TBA
720.....	186720.....	Diff Ring Gear, BCLA/B90A (71 Teeth, 4 -ID) 2003-11.....	1.....	41233-RCL-010

### VALVE BODIES

740.....	186740.....	Valve Body (Less Gears)(Cast # PRP) 2002-11.....	1.....	27000-RXH-000
741.....	K121908A.....	Lube Kit, Conv Overheat, Cooler Flow/Conv Charge Fixes Most V-6 1997-Up (Transgo).....	1.....	HONDA-LK
741.....	K121908B.....	Lube Kit, Conv Overheat, Cooler Flow/Conv Charge Fixes Most 4-Cyl 1994-Up (Transgo).....	1.....	HONDA-LK2
746.....	187746.....	Sep Plate, BCLA/BZNA/GPPA-3/MCTA/MKZA/MNZA/MRMA Accum Body To VB(For PRP Body) 02-08.....	1.....	27212-PRP-020
746.....	187746A.....	Sep Plate, BZHA/BZKA-1/B90A/GPLA/MCLA/MKYA/MM7A/MZHA/MZJA Accum Body To VB (#RXH Body).....	1.....	27212-RCT-010
747.....	187747.....	Sep Plate, Valve Body 2002-11.....	1.....	27112-PRP-030

### HOUSINGS, CASES & COMPONENTS

750.....	187750.....	Bell Housing, BCLA/MCTA (2WD)(19-Bolts To Case)(Cast # RCL Or RCL-1) 2003-08.....	1.....	21111-RCL-305
750.....	187750A.....	Bell Hsg, BZKA-1/MNZA/MZJA (2WD)(20-Bolts)(Cast# RZH-1 Or RZJ-2) 2007-11 (Looks Like AWD).....	1.....	21111-RZJ-305
750.....	187750B.....	Bell Housing, GPLA/MKYA/MRMA (2WD)(19-Bolts To Case)(Cast #PRP-2 Or PRP-4) 2002-06.....	1.....	21111-PRM-305
750.....	187750C.....	Bell Housing, B90A/MM7A (2WD)(19 Bolts To Case)(Cast # R90-1) 2008-11.....	1.....	21111-R90-305
750.....	187750D.....	Bell Housing, GPPA-3/MKZA (AWD)(20 Bolts To Case)(Cast # PRW-1 Or PRW-2) 2005-06.....	1.....	21111-PRV-306
750.....	187750E.....	Bell Housing, BZHA/BZNA/MCLA/MZHA (AWD)(20 Bolts To Case)(Cast# RZH Or RZH-1) 2003-11.....	1.....	21111-RZH-305
757.....	187757.....	Solenoid Cover, BCLA/BZHA/MCLA/MCTA/MM7A/MZHA/MZJA (Alum, 9-Bolt)(W/Dip Stick Hole)(# PRP).....	1.....	28450-RCL-000
757.....	187757A.....	Solenoid Cover, BZKA-1/BZNA/B90A/GPLA/GPPA-3/MKYA/MKZA/MNZA/MRMA (Alum, 9-Bolt) 2002-11.....	1.....	28450-PRP-000
759.....	187759.....	Rear Cover, BCLA/GPLA/GPPA-3/MCLA/MCTA/MKYA/MKZA (16 Bolt)(Cast # RCL) 2003-08.....	1.....	21240-RCL-010
759.....	187759A.....	Rear Cover, MRMA (16 Bolt)(Cast # PRP)2002-06.....	1.....	21240-PRP-010
759.....	187759B.....	Rear Cover, BZHA/BZKA-1/B90A/MM7A/MNZA/MZHA/MZJA (16 Bolt)(Cast # RCR Or RCV) 2003-11.....	1.....	21240-RCV-010
760.....	187760.....	Case, GPPA-3/MKZA (AWD)(20 Bolts To Bell)(Cast # RKZ) 2005-06.....	1.....	21210-RKZ-000
760.....	187760A.....	Case, BCLA/MCTA (2WD)(19-Bolts To Bell)(Cast # RCL) 2003-08.....	1.....	21210-RCL-010
760.....	187760B.....	Case (AWD) BZHA/BZNA/MCLA/MZHA / (2WD) BZKA-1/MNZA/MZJA-Dummy AWD (20-Bolt)(# RXH).....	1.....	21210-RXH-020
760.....	187760C.....	Case, B90A/MM7A (2WD)(19 Bolts To Bell)(Cast # R90) 2008-11.....	1.....	21210-R90-000
760.....	187760D.....	Case, GPLA/MKYA (2WD)(19 Bolts To Bell)(Cast # RKY) 2005-06.....	1.....	21210-RKY-000
760.....	187760E.....	Case, MRMA (2wd)(19 Bolts To Bell)(Cast # PRP-3) 2002-06.....	1.....	21210-PRP-020
776.....	187776.....	Bolt, BCLA/B90A/GPLA/MCTA/MM7A/MRMA/MKYA Bell Housing To Case, 2002-11.....	19.....	TBA
776.....	187776A.....	Bolt, BZHA/BZKA-1/BZNA/GPPA-3/MCLA/MKZA/MNZA/MZHA/MZJA Bell Housing To Case, 2003-11.....	20.....	TBA
780.....	187780.....	Bolt, Rear Cover To Case, 2002-11.....	16.....	TBA
786.....	187786.....	Bolt, BZKA-1/MNZA Differential Ring Gear (1.235" Long) 2007-08.....	14.....	90003-P7T-000
786.....	187786A.....	Bolt, BZHA/BZNA/MCLA/MZHA/MZJA Differential Ring Gear (1.655" Long) 2003-11.....	14.....	90003-PGV-000
786.....	186786.....	Bolt, GPPA-3/MKZA Differential Ring Gear/Transfer Gear (1.475" Long) 2005-06.....	10.....	90017-PET-000
786.....	186786A.....	Bolt, BCLA/B90A/GPLA/MCTA/MKYA/MM7A/MRMA Differential Ring Gear (1.030" Long) 2002-11.....	10.....	90003-PA9-003
795.....	121949.....	Nut (Right Hand Thread) 2002-11.....	1.....	90203-PX4-010
796.....	121949.....	Nut, Mainshaft (Right Hand Thread) 2002-11.....	1.....	90203-PX4-010
796.....	121948A.....	Nut, Countershaft (Left Hand Thread)(.515" Thick) 2002-11 2002-11.....	1-2.....	90201-PRP-000
797.....	121948A.....	Nut, 2ndary Shaft (Left Hand Thread)(.515" Thick) 2002-11.....	1-2.....	90201-PRP-000

### GEARS, FORKS & CUSHIONS

801.....	187801.....	Gear, BZHA/BZKA-1/BZNA/MCLA/MNZA/MZHA/MZJA 1st (Counter)(61T, No-ID) (5.653" OD) 2003-11.....	1.....	23421-RZH-000
801.....	187801A.....	Gear, B90A/GPLA/GPPA-3/MKYA/MKZA/MM7A 1st (Counter)(56T, 1 -ID) (5.605" OD) 2005-11.....	1.....	23421-RFK-000
801.....	186801.....	Gear, BCLA/MCTA/MRMA 1st (Countershaft)(56 Teeth, 1 Very Light -ID)(5.600" OD) 2002-08.....	1.....	23421-PPV-010
802.....	187802.....	Gear, BCLA/MRMA 1st (2ndary Shaft)(27 Teeth, No -ID) 2002-06.....	1.....	23411-PRP-010
802.....	187802A.....	Gear, BZHA/BZKA-1/BZNA/MCLA/MNZA/MZHA/MZJA 1st (2ndary Shaft)(28 Teeth, 3 -ID) 2003-11.....	1.....	23411-RZH-000
802.....	187802B.....	Gear, B90A/MCTA/MM7A 1st (2ndary Shaft)(27 Teeth, 1 -ID) 2004-11.....	1.....	23411-RCT-000
802.....	187802C.....	Gear, GPLA/GPPA-3/MKYA/MKZA 1st (2ndary Shaft)(27 Teeth, 2 -ID) 2005-06.....	1.....	23411-RFK-000
803.....	187803.....	Gear, BCLA/MCTA 2nd (2ndary Shaft)(43 Teeth, 3 -ID) 2003-08.....	1.....	23431-RCL-000

## 5-SPEED, 4-SHAFT (BCLA, B90A, MZJA)

ILL#	Part#		QTY	REF#
803.....	187803A.....	Gear, MRMA 2nd (2ndary Shaft)(44 Teeth, No -ID) 2002-06 .....	1.....	23431-PRP-010
803.....	187803B.....	Gear, BZHA/BNZA/MCLA/MNZA/MZHA/MZJA 2nd (2ndary Shaft)(42 Teeth, 1 -ID Next To Hub) 03-11.....	1.....	23431-RZH-000
803.....	187803C.....	Gear, BZKA-1/MM7A 2nd (2ndary Shaft)(42 Teeth, 1 -ID In Middle) 2008-11.....	1.....	23431-R90-B00
803.....	187803D.....	Gear, B90A 2nd (2ndary Shaft)(42 Teeth, 2 -ID) 2008-11.....	1.....	TBA
803.....	187803E.....	Gear, MKYA 2nd (2ndary Shaft)(43 Teeth, 1 -ID)(3.755" OD) 2005-06 .....	1.....	TBA
803.....	187803F.....	Gear, MKZA 2nd (2ndary Shaft)(43 Teeth, No -ID) 2005-06 .....	1.....	TBA
803.....	187803G.....	Gear, GPLA/GPPA-3 2nd (2ndary Shaft)(43 Teeth, 1 -ID)(3.902" OD) 2005-06 .....	1.....	23431-RFK-000
804.....	187804.....	Gear, BCLA/GPLA/GPPA-3/MCTA/MKYA/MKZA/MRMA 2nd (Counter)(51T, No -ID Or 1 -ID)(4.535" OD).....	1.....	23441-RFK-000
804.....	187804A.....	Gear, BZNA/MCLA/MNZA/MZJA 2nd (Countershaft)(53 Teeth, 1 Wide -ID)(4.665" OD) 2003-11.....	1.....	23441-RZH-000
804.....	187804B.....	Gear, BZHA/BZKA-1/B90A/MM7A/MZHA 2nd (Counter)(53T, 1 Narrow -ID) (4.665" OD) 2007-11.....	1.....	23441-R90-B00
807.....	187807.....	Gear, BCLA/GPLA/GPPA-3/MKYA/MKZA 3rd (Countershaft)(43 Teeth, 1 -ID)(3.770" OD) 2003-11.....	1.....	23451-RCL-000
807.....	187807A.....	Gear, MRMA 3rd (Countershaft)(38 Teeth, 2 -ID)(3.685" OD) 2002-06 .....	1.....	23451-PRM-A01
808.....	187808.....	Gear, BCLA/GPLA/GPPA-3/MKYA/MKZA 3rd (2ndary Shaft)(53 Teeth, 1 -ID)(4.615" OD) 2003-06.....	1.....	23455-RCL-000
808.....	187808A.....	Gear, MRMA 3rd (2ndary Shaft)(50 Teeth, 2 -ID) 2002-06 .....	1.....	23455-PRM-A01
808.....	187808B.....	Gear, BZNA 3rd (2ndary Shaft)(52 Teeth W/2 -IDs, 1 At Each Side)(4.540" OD) 2008.....	1.....	23455-RZH-000
808.....	187808C.....	Gear, MNZA/MZJA 3rd (2ndary Shaft)(52 Teeth, 1 Wide -ID)(4.540" OD) 2007-11.....	1.....	TBA
808.....	187808D.....	Gear, BZHA/BZKA-1/B90A/MM7A/MZHA 3rd (2ndary Shaft) (52T, 2 -ID On Edge, 4.540" OD) 2003-11.....	1.....	23455-R90-B00
808.....	187808E.....	Gear, MCTA 3rd (2ndary Shaft)(52 Teeth, No -ID) 2004-08 .....	1.....	23455-RCT-000
809.....	187809.....	Gear, BCLA 4th (Mainshaft)(42 Teeth, No -ID)(22 Teeth, 1 -ID) 2003-06 .....	1.....	23461-RCL-020
809.....	187809A.....	Gear, MRMA 4th (Mainshaft)(45 Teeth, 2 -ID)(22 Teeth, No -ID) 2002-06 .....	1.....	23461-PRM-A01
809.....	187809B.....	Gear, BZNA/MCLA/MNZA/MZJA 4th (Mainshaft)(44 Teeth, 1 -ID)(22 Teeth, No -ID) 2003-11.....	1.....	23461-RCT-900
809.....	187809C.....	Gear, BZKA-1/B90A/MM7A 4th (Mainshaft)(44 Teeth, No -ID)(22 Teeth, 1 -ID) 2008-11.....	1.....	TBA
809.....	187809D.....	Gear, GPLA/GPPA-3/MKYA/MKZA 4th (Mainshaft)(42 Teeth, 2 -ID)(22 Teeth, No -ID) 2005-06.....	1.....	23461-RCR-000
809.....	187809E.....	Gear, BZHA/MZHA 4th (Mainshaft)(44 Teeth, No -ID)(22 Teeth, No -ID) 2007-11.....	1.....	23461-R90-B00
809.....	187809.....	Gear, MCTA 4th (Mainshaft)(44 Teeth, No -ID)(22 Teeth, 3 -ID) 2004-08 .....	1.....	TBA
810.....	187810.....	Gear, BCLA/GPLA/GPPA-3/MKYA/MKZA 4th (Countershaft)(31 Teeth, 2 -ID)(3.260" OD) 2003-06.....	1.....	23471-RCL-010
810.....	187810A.....	Gear, MCTA 4th (Countershaft)(34 Teeth, 3 -ID)(3.330" OD) 2004-08.....	1.....	23471-RFK-901
810.....	187810B.....	Gear, MRMA 4th (Countershaft)(33 Teeth, 2 -ID)(3.225" OD) 2002-06 .....	1.....	23471-PRM-A01
810.....	187810C.....	Gear, BZHA/BZNA/MCLA/MNZA/MZHA/MZJA 4th (Counter)(34T, 1 -ID) (3.330" OD) 2003-11.....	1.....	23471-R90-B00
810.....	187810D.....	Gear, BZKA-1/B90A/MM7A 4th (Countershaft)(34 Teeth, No -ID) 2008-11.....	1.....	23471-R90-B00
812.....	187812.....	Gear, 5th (Main) (53T, 1-ID)(4.750" OD) 02-11.....	1.....	23481-RCT-000
812.....	187812A.....	Gear, MRMA 5th (Mainshaft)(56 Teeth, No -ID) 2002-06.....	1.....	23481-PRP-010
812.....	187812B.....	Gear, MM7A 5th (Mainshaft)(56 Teeth, 2 -ID)(4.680" OD) 2009-11.....	1.....	23481-RCT-A00
812.....	187812C.....	Gear, GPLA/GPPA-3/MKYA/MKZA 5th (Mainshaft)(53 Teeth, 3 -ID)(4.750" OD) 2005-06 .....	1.....	23481-RFK-900
813.....	187813.....	Gear, BCLA/MCTA 5th (Countershaft)(30 Teeth, No -ID)(.731" Thick)(2.695" OD) 2003-08.....	1.....	23491-RCL-000
813.....	187813A.....	Gear, 5th (Counter)(30T, No-ID)(.865" Thick)(2.695" OD) 03-11.....	1.....	23491-RCT-A00
813.....	187813B.....	Gear, MRMA 5th (Countershaft)(32 Teeth, 1 -ID)(.731" Thick)(2.695" OD) 2002-06.....	1.....	23491-PRP-000
813.....	187813C.....	Gear, MM7A 5th (Countershaft)(30 Teeth, 1 -ID)(.731" Thick)(2.695" OD) 2009-11.....	1.....	23491-RM7-000
813.....	187813D.....	Gear, GPLA/GPPA-3/MKYA/MKZA 5th (Counter)(30T, 2 -ID)(.865" Thick) (2.695" OD) 2005-06.....	1.....	23491-RFK-900
816.....	186816.....	Gear, Reverse (Countershaft)(44 Teeth)(4.485" OD)(1.805" ID) 2002-11.....	1.....	23531-PRP-010
818.....	186818.....	Gear, Reverse Idler (26 Teeth, No -ID)(.610" Thick)(2.810" OD)(.786" ID) 2002-11.....	1.....	23541-PRP-000
820.....	186820.....	Bracket, Reverse Idler (1 Bolt, Aluminum)(W/Shaft) 2002-11 .....	1.....	21215-PRP-000
830.....	186830.....	Selector, Reverse (.648" Thick) 2002-11 .....	1.....	23565-PRP-010
835.....	186835.....	Hub, Reverse Selector (26 Outer Teeth)(1.008" Thick) 2002-11 .....	1.....	23566-PRP-000
840.....	186840.....	Fork, Reverse (2.455" ID At Forks) 2002-11.....	1.....	24111-PRP-000
850.....	186850.....	Cushion, 4th Clutch Wave Spring (.071" Thk, 4.605" OD) 2002-11.....	1.....	22536-PRP-013
851.....	187851.....	Cushion, Except MCTA 5th Clutch Wave Spring (.060" Thick)(4.600" OD) 2002-11.....	1.....	TBA
851.....	186850.....	Cushion, MCTA, 5th Clutch Wave Spring (.071" Thk, 4.605" OD) 2004-08 .....	1.....	22536-PRP-013
852.....	187852.....	Cushion, Except MRMA 2nd Clutch Wave Spring (.079" Thick)(4.462" OD) 2003-11.....	1.....	22537-RCL-013
852.....	186850.....	Cushion, MRMA, 2nd Clutch Wave Spring (.071" Thk, 4.605" OD) 2002-06 .....	1.....	22536-PRP-013
853.....	186850.....	Cushion, Except MCTA 1st Clutch Wave Spring (.071" Thk, 4.605" OD) 2002-11.....	1.....	22536-PRP-013
853.....	188850.....	Cushion, MCTA 1st Clutch(.067" Thick)(4.540" OD)(Waved) 2004-08.....	1-2.....	22536-RCT-014
858.....	186850.....	Cushion, Except MCTA 3rd Clutch Wave Spring (.071" Thk, 4.605" OD) 2002-11.....	1.....	22536-PRP-013
858.....	188850.....	Cushion, MCTA 3rd Clutch (.067" Thick)(4.540" OD)(Waved) 2004-08.....	1-2.....	22536-RCT-014
<b>SNAP RINGS</b>				
861.....	186861.....	Snap Ring, Holds 4th Clutch Pressure Plate In (.070" Thick, 5.230" OD) 2002-11.....	1-2.....	90605-P7T-003
862.....	186862.....	Snap Ring, Holds 4th Clutch Spring Retainer In 2002-11.....	1-2.....	90603-PX4-000
864.....	186861.....	Snap Ring, Holds 5th Clutch Pressure Plate In (.070" Thick, 5.230" OD) 2002-11.....	1-2.....	90605-P7T-003
865.....	186862.....	Snap Ring, Holds 5th Clutch Spring Retainer In 2002-11.....	1-2.....	90603-PX4-000
870.....	186870.....	Snap Ring, Holds Bearing In Stator (Front) 2002-11.....	1.....	TBA
871.....	186874.....	Snap Ring, Holds 3rd Clutch Spring Retainer In (.070" Thick)(1.945" OD) 2002-11.....	1-3.....	90603-P6H-003
871.....	187871.....	Snap Ring, MCTA Holds 3rd Clutch Spring Retainer In (.075" Thick)(1.930" OD) 2004-08.....	1-2.....	90603-RCT-004
873.....	184861.....	Snap Ring, Holds 2nd Clutch Pressure Plate (.069" Thk, 5.070" OD) 2002-11.....	1-3.....	90605-PX4-000
873.....	187873.....	Snap Ring, 2nd Cl Press Plate (.070" Thk, 5.165" OD).....	1-2.....	90605-RCL-A01
874.....	186874.....	Snap Ring, Holds 2nd Clutch Spring Retainer In (.070" Thick)(1.945" OD) 2002-11.....	1-3.....	90603-P6H-003
876.....	184861.....	Snap Ring, Holds 1st Clutch Pressure Plate In (.069" Thk, 5.070" OD) 2002-11.....	1-3.....	90605-PX4-000
876.....	187873.....	Snap Ring, Holds 1st Cl Press Plate (.070", 5.165" OD).....	1-2.....	90605-RCL-A01



## 5-SPEED, 4-SHAFT (BCLA, B90A, MZJA)

ILL#	Part#		QTY	REF#
876	188861	Snap Ring, MCTA Holds 1st Clutch Pressure Plate In (.079" Thick, 5.210" OD) 2004-08	1-2	90605-RCT-004
877	186874	Snap Ring, Holds 1st Clutch Spring Retainer In (.070" Thick)(1.945" OD) 2002-11	1-3	90603-P6H-003
877	187871	Snap Ring, MCTA Holds 1st Clutch Spring Retainer In (.075" Thick)(1.930" OD) 2004-08	1-2	90603-RCT-004
878	184861	Snap Ring, Except MCTA Holds 3rd Clutch Pressure Plate In (.069" Thk, 5.070" OD) 2002-11	1-3	90605-PX4-000
878	188861	Snap Ring, MCTA Holds 3rd Clutch Pressure Plate In (.079" Thick, 5.210" OD) 2004-08	1-2	90605-RCT-004
879	186879	Snap Ring, Holds Caged Bearing To Mainshaft 2002-11	1	90603-P0X-000
880	186880	Snap Ring, Holds Bearing # 235 To Case (.077" Thick)(3.355" OD) 2002-11	1	90615-POZ-000
881	186881	Snap Ring, Holds 2nd Clutch Drum To 2ndary Shaft (.078" Thick)(1.405" OD) 2002-11	1	90621-PRP-000
886	186886	Snap Ring, Holds Collar # 269 To Countershaft (.040" Thick) 2002-11	1	90614-PX4-700
887	98621A	Horse Shoe Clips, Countershaft (.078" Thick)(1.699" Long)(.187" Wide) (2 Per Pack) 2002-11	1	90431-P6H-000
889	186889	Snap Ring, Holds Bearing # 286 To Case (.078" Thick)(2.285" OD) (W/Bent Ends) 2002-11	1	90614-PRP-000
890	186890	Snap Ring, Holds Bearing # 274 To Case (.077" Thick)(3.285" OD) (W/Bent Ends) 2002-11	1	90609-PX4-000
897	186897	Horse Shoe Clips, Idler Shaft (.056" Thick)(.970" Long)(2 Per Pack) 2002-11	1	90431-PRP-000
899	186899	Snap Ring, Holds Retainer To Idler Shaft (.047" Thick)(.088" OD) (W/2 Eyelets) 2002-11	1	94510-20000

### ACCUMULATORS, REGULATORS, PISTONS & MISCELLANEOUS

900	187900	Accum, BCLA/GPLA/GPPA-3/MCTA/MKYA/MKZA/MRMA (W/Pistons)(Cast # PRP) 2002-08	1	27405-PRP-J00
900	187900A	Accum, BZHA/BZKA-1/BZNA/B90A/MCLA/MM7A/MNZA/MZHA/MZJA (W/Pistons) (#RXH) 2003-11	1	27405-RCL-A02
924	187924	Regulator Body Assembly, BCLA/MCTA (Cast # PRP On Body & PRP On Accum Cover) 2003-08	1	27200-PRP-J02
924	187924A	Reg Body Assy, BZKA-1/B90A/GPLA/MCLA/MKYA/MM7A/MZJA (# RXH On Body & RFK On Accum Cov)	1	27200-RZH-000
924	187924B	Regulator Body Assy, BZNA/GPPA-3/MKZA/MNZA (Cast # PRP On Body & RFK On Accum Cover)	1	27200-RCR-000
924	187924C	Regulator Body Assembly, BZHA/MZHA (Cast # RXH On Body & PRP On Accum Cover) 2007-11	1	TBA
924-3	187924-3	Separator Plate, Regulator Body To Valve Body 2002-11	1	27412-PRP-010
960	187960	Piston, 4th Clutch Except BCLA/GPLA (.338" Thick At Edge)(4.710" OD)(1.860" ID) 2002-11	1-2	TBA
960	186960	Piston, BCLA/GPLA 4th Clutch (.443" Thick)(4.710" OD)(1.860" ID) 2003-06	1-2	22680-RCL-003
961	187960	Piston, 5th Clutch Except BCLA/GPLA (.338" Thick At Edge)(4.710" OD)(1.860" ID) 2002-11	1	TBA
961	186960	Piston, BCLA/GPLA 5th Clutch (.443" Thick)(4.710" OD)(1.860" ID) 2003-06	1-2	22680-RCL-003
962	187962	Piston, B/MCLA/BZHA/BZKA-1/BZNA/B90A/MM7A/MNZA/MZHA/MZJA 2nd (.496" Thk)(4.710" OD)(1.795" ID)	1	22621-RCL-A05
962	187962A	Piston, MRMA 2nd Cl (.550" Thick)(4.710" OD)(1.795" ID)(4.595" OD At Wavy Ring) 2002-06	1	22621-PRP-003
962	187962B	Piston, GPLA/GPPA-3/MCTA/MKYA/MKZA 2nd (.550" Thk)(4.710" OD)(1.795" ID) (4.495" OD At Wavy Ring)	1	22621-RCL-003
965	186967	Piston, Except MCTA 3rd Clutch (.550" Thick)(4.710" OD) 2002-11	1-2	22521-RCL-003
965	187965	Piston, MCTA 3rd Clutch (.550" Thick)(4.710" OD) 2004-08	1-2	22521-RCT-024
967	186967	Piston, Except MCTA 1st Clutch (.550" Thick)(4.710" OD) 2002-11	1-2	22521-RCL-003
967	187965	Piston, MCTA 1st Clutch (.550" Thick)(4.710" OD) 2004-08	1-2	22521-RCT-024
970	88744MA	Spring, 4th Clutch (1.320" Tall Coil Height) 2002-11	1-2	22541-PX4-004
971	88744MA	Spring, 5th Clutch (1.320" Tall Coil Height) 2002-11	1-2	22541-PX4-004
972	188972	Spring, 2nd Clutch Return (.275" Thick Wire)(2.550" OD) 2002-11	1-3	22541-PRP-003
975	188972	Spring, Except MCTA 3rd Clutch Return (.275" Thick Wire)(2.550" OD) 2002-11	1-3	22541-PRP-003
975	187975	Spring, MCTA 3rd Clutch Return (.295" Thick Wire)(2.560" OD) 2004-08	1-2	22541-RCT-004
977	188972	Spring, Except MCTA 1st Clutch Return (.275" Thick Wire)(2.550" OD) 2002-11	1-3	22541-PRP-003
977	187975	Spring, MCTA 1st Clutch Return (.295" Thick Wire)(2.560" OD) 2004-08	1-2	22541-RCT-004
980	88745MA	Retainer, 4th Clutch Spring 2002-11	1-2	22533-PX4-010
981	88745MA	Retainer, 5th Clutch Spring 2002-11	1-2	22533-PX4-010
982	121754A	Retainer/Piston, 2nd Clutch (Bonded) (.930" Thk, 4.190" OD) 2002-11	1-3	22533-PRP-003
985	121754A	Retainer, BCLA/GPLA/GPPA-3/MCLA/MKYA/MKZA/MRMA 3rd Clu (Bonded) (.930" Thk, 4.190" OD) 02-06	1-3	22533-PRP-003
985	187985	Retainer, BZHA/BZKA-1/BZNA/B90A/MCLA/MM7A/MNZA/MZHA/MZJA 3rd (Bonded)(.905" Thk, 4.19" OD)	1-2	22534-R90-003
985	187985A	Retainer/Piston, MCTA 3rd Clutch (Bonded)(.887" Thk, 4.190" OD) 2004-08	1-2	22533-RCT-004
987	121754A	Retainer, BCLA/GPLA/GPPA-3/MCLA/MKYA/MKZA/MRMA 1st Clu (Bonded) (.930" Thk, 4.190" OD)	1-3	22533-PRP-003
987	187985	Retainer, BZHA/BZKA-1/BZNA/B90A/MCLA/MM7A/MNZA/MZHA/MZJA 1st (Bonded)(.905" Thk, 4.19" OD)	1-2	22534-R90-003
987	187985A	Retainer/Piston, MCTA 1st Clutch (Bonded)(.887" Thk, 4.190" OD) 2004-08	1-2	22533-RCT-004
991-4	186991-4	Shift Rod, (# 991-4)(18-3/4" Long) 2002-11	1	24410-PPV-000
995	186995	Park Pawl Assembly, 2002-11	1	TBA
999	187999	Tube Set, BCLA/MCLA Case & Bell Hsg (2-pc) (Included In K187999) 2003-11	1	22770-RCL-305
999	K187999	Tube Set, BCLA/GPLA/GPPA-3/MCTA/MKYA/MKZA/MRMA Case & Bell Hsg (8-Pc) 2002-08	1	TBA
999	K187999A	Tube Set, BZHA/BZKA-1/BZNA/B90A/MCLA/MM7A/MNZA/MZHA/MZJA Case & Bell (8-pc)	1	TBA
999-3	187999-3	Tube Set, In Rear Cover (2 Tubes) 2002-11	1	TBA
999-4	186999-4	Tube, Solenoid Housing To Regulator Body (No Screen)(1.375" Long) (1-Per Trans) 2002-11	1	22749-PW4-000
999-5	186999-5	Tube, Solenoid Housing To Regulator Body (Screened)(1.400" Long) (6-Per Trans) 2002-11	6	22760-PPW-000

### Notes