

4-SPEED, 4-SHAFT (MCVA, MZKA, BZKA)

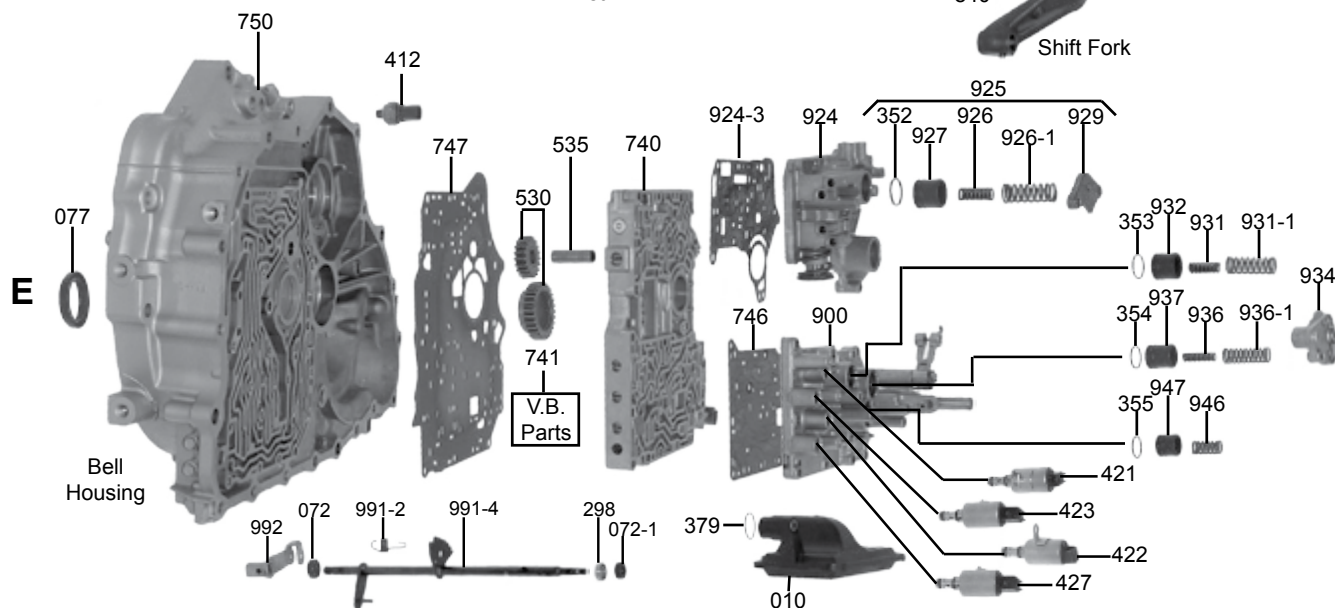

HONDA & ACURA

4-SPEED, 4-SHAFT (MCVA, MZKA, BZKA)

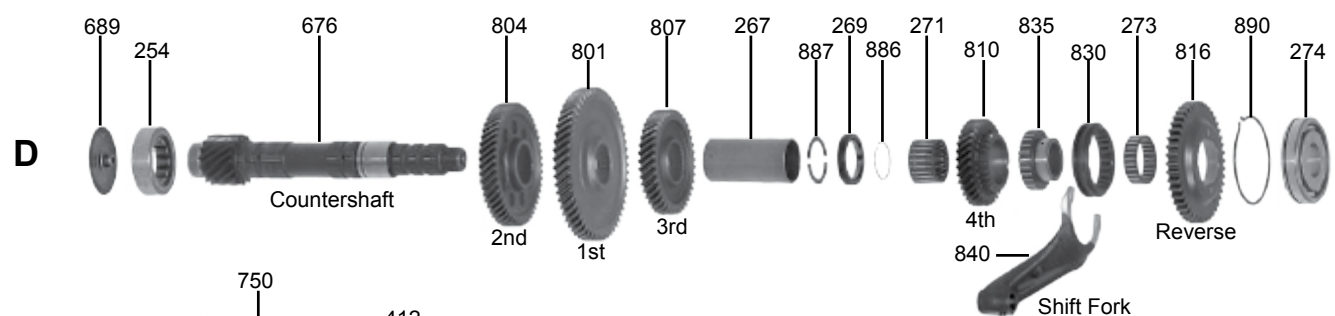
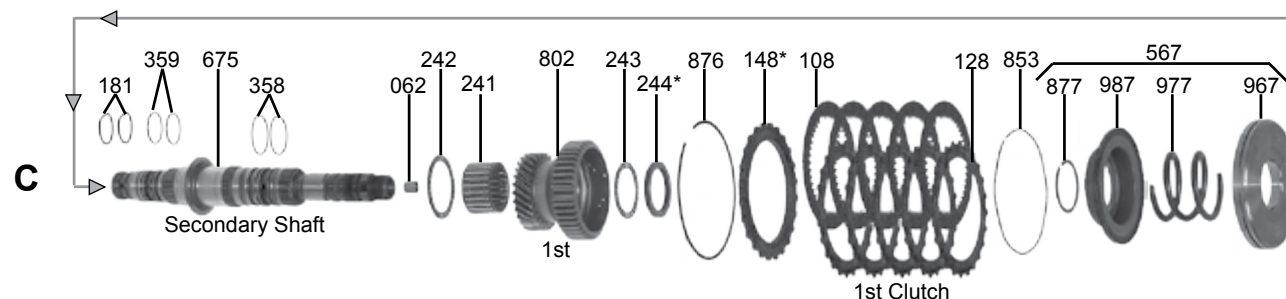
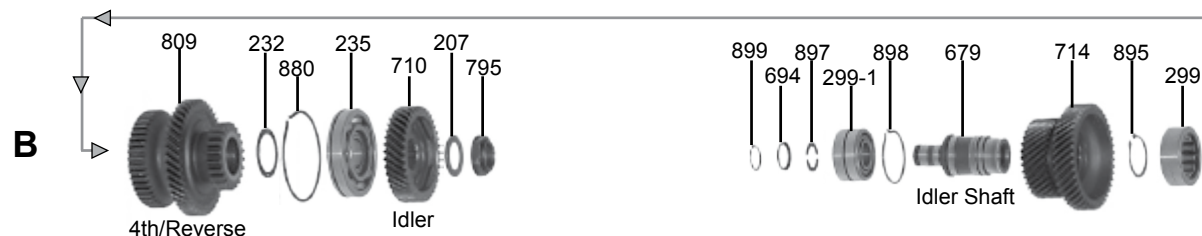
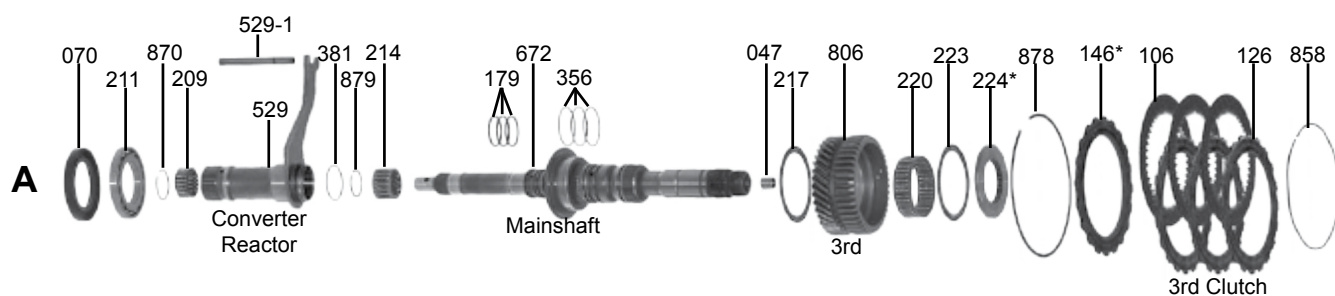
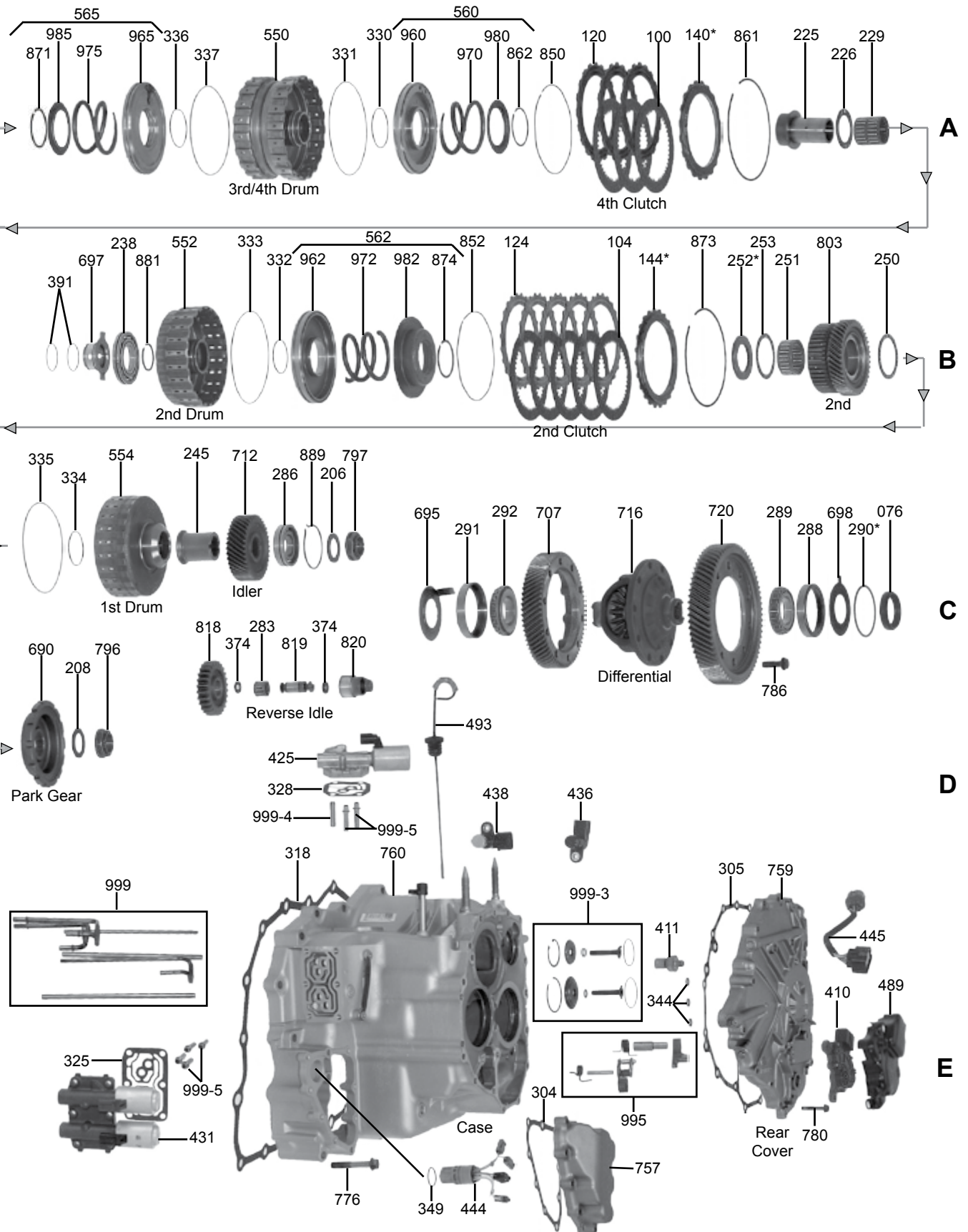

HONDA & ACURA

4-SPEED, 4-SHAFT (MCVA, MZKA, BZKA)

| ILL# | Part# | | QTY | REF# |
|-------------------------|---------|---------------------------------------------------------------------------------------------|-----|---------------|
| KITS | | | | |
| | | BZKA-5-6-7/GPPA-2/MCVA/MRVA/MZKA-1-2-3-4-8 | | |
| | | **SEE HONDA/ACURA OVERHAUL / BANNER / MASTER KIT QUICK REF ** | | |
| FILTERS | | | | |
| | | MCVA/MRVA/BZKA/MZKA/GPPA-2 | | |
| | | **SEE HONDA/ACURA FILTER QUICK REF FOR INTERNAL & AUX FILTERS** | | |
| BUSHINGS | | | | |
| 047 | 186047 | Bushing, MCVA/MRVA/BZKA/MZKA/GPPA, Mainshaft (.398" Wide)(.415" OD) (.315" ID) 2002-06..... | 1 | TBA |
| METAL CLAD SEALS | | | | |
| | | **SEE HONDA/ACURA KIT & FRONT SEAL / AXLE SEAL QUICK REF** | | |
| 072-1 | 88198 | Seal, MCVA/MRVA/BZKA/MZKA/GPPA Position Sensor (In Rear Cover)(.715" OD) 2006-11 | 1 | 91201-PA9-004 |
| 072 | 78197 | Seal, MCVA/MRVA/BZKA/MZKA/GPPA Manual Control Shaft, 2006-11..... | 1 | 91209-612-003 |
| FRICTIONS | | | | |
| 100 | 98105G | Friction, MCVA/MRVA/BZKA/MZKA/GPPA, 4th Clutch (.075", 44T, 4.830" OD) 2002-06 | 3 | 22546-PPV-A01 |
| 104 | 98101G | Friction, MCVA/MRVA/BZKA/MZKA/GPPA, 2nd Clutch (.076", 42T, 4.670" OD) 2002-06 | 5 | 22545-PRP-013 |
| 106 | 98105G | Friction, MCVA/MRVA/BZKA/MZKA/GPPA, 3rd Clutch (.075", 44T, 4.830" OD) 2002-06..... | 3 | 22546-PPV-A01 |
| 108 | 98101G | Friction, MCVA/MRVA/BZKA/MZKA/GPPA, 1st Clutch (.076", 42T, 4.670" OD) 2002-06 | 5 | 22545-PRP-013 |
| STEELS | | | | |
| 120 | 121113C | Steel, MCVA/MRVA, 4th Clutch (.091", 20T, 3.695" ID) 2002-06..... | 3 | 22653-PPV-A01 |
| 120 | 121116B | Steel, GPPA/BZKA/MZKA, 4th Clutch (.079", 24T-Notched, 3.695" ID) 2002-06..... | 4 | 22653-PRP-901 |
| 124 | 98111 | Steel, MCVA/MRVA/BZKA/MZKA/GPPA, 2nd Clutch (.079", 24T, 3.682" ID) 2002-06..... | 5 | 22643-RCL-003 |
| 124 | 121112A | Steel, GPPA/BZKA/MZKA, 2nd Clutch (.157", 24T, 3.680" ID) 2002-06..... | 1 | 22643-RCL-801 |
| 126 | 121113C | Steel, MCVA/MRVA, 3rd Clutch (.091", 20T, 3.695" ID) 2002-06 | 3 | 22653-PPV-A01 |
| 126 | 121116B | Steel, BZKA/MZKA, 3rd Clutch (.079", 24T-Notched, 3.695" ID) 2002-06 | 4 | 22653-PRP-901 |
| 126 | 98119 | Steel, GPPA 3rd Clutch (.063", 24T, 3.675" ID) 2002-06..... | 5 | 22543-RCL-003 |
| 128 | 98119 | Steel, MCVA/MRVA/BZKA/MZKA/GPPA, 1st Clutch (.063", 24T, 3.675" ID) 2002-06..... | 5 | 22543-RCL-003 |
| PRESSURE PLATES | | | | |
| 140 | 186140 | Press Plate, , 4th Clutch (.082")(#1, 20T, 3.695" ID)2002-06 | 1-2 | 22571-PPV-A01 |
| 140 | 186140A | Press Plate, , 4th Clutch (.086")(#2, 20T, 3.695" ID)2002-06 | 1-2 | TBA |
| 140 | 186140B | Press Plate, , 4th Clutch (.090")(#3, 20T, 3.695" ID)2002-06 | 1-2 | 22573-PPV-A01 |
| 140 | 186140C | Press Plate, , 4th Clutch (.094")(#4, 20T, 3.695" ID)2002-06 | 1-2 | 22574-PPV-A01 |
| 140 | 186140D | Press Plate, , 4th Clutch (.098")(#5, 20T, 3.695" ID)2002-06 | 1-2 | 22575-PPV-A01 |
| 140 | 186140E | Press Plate, , 4th Clutch (.102")(#6, 20T, 3.695" ID)2002-06 | 1-2 | 11576-PPV-A01 |
| 140 | 186140F | Press Plate, , 4th Clutch (.106")(#7, 20T, 3.695" ID)2002-06 | 1-2 | 22577-PPV-A01 |
| 140 | 186140G | Press Plate, , 4th Clutch (.110")(#8, 20T, 3.695" ID)2002-06 | 1-2 | 22578-PPV-A01 |
| 140 | 186140H | Press Plate, , 4th Clutch (.114")(#9, 20T, 3.695" ID)2002-06 | 1-2 | 22579-PPV-A01 |
| 144 | 186144 | Press Plate, , 2nd Clutch (.102")(#1)(24T, 3.675" ID) 2002-06..... | 1 | 22571-PRP-003 |
| 144 | 186144A | Press Plate, , 2nd Clutch (.106")(#2)(24T, 3.675" ID) 2002-06..... | 1 | 22572-PRP-003 |
| 144 | 186144B | Press Plate, , 2nd Clutch (.110")(#3)(24T, 3.675" ID) 2002-06..... | 1 | 22573-PRP-003 |
| 144 | 186144C | Press Plate, , 2nd Clutch (.114")(#4)(24T, 3.675" ID) 2002-06..... | 1 | 22574-PRP-003 |
| 144 | 186144D | Press Plate, , 2nd Clutch (.118")(#5)(24T, 3.675" ID) 2002-06..... | 1 | 22575-PRP-003 |
| 144 | 186144E | Press Plate, , 2nd Clutch (.122")(#6)(24T, 3.675" ID) 2002-06..... | 1 | 22576-PRP-003 |
| 144 | 186144F | Press Plate, , 2nd Clutch (.126")(#7)(24T, 3.675" ID) 2002-06..... | 1 | TBA |
| 144 | 186144G | Press Plate, , 2nd Clutch (.130")(#8)(24T, 3.675" ID) 2002-06..... | 1 | 22578-PRP-003 |
| 144 | 186144H | Press Plate, , 2nd Clutch (.134")(#9)(24T, 3.675" ID) 2002-06..... | 1 | 22579-PRP-003 |
| 146 | 186140 | Press Plate, , 3rd Clutch (.082")(#1, 20T, 3.695" ID)2002-06 | 1-2 | 22571-PPV-A01 |
| 146 | 186140A | Press Plate, , 3rd Clutch (.086")(#2, 20T, 3.695" ID)2002-06 | 1-2 | TBA |
| 146 | 186140B | Press Plate, , 3rd Clutch (.090")(#3, 20T, 3.695" ID)2002-06 | 1-2 | 22573-PPV-A01 |
| 146 | 186140C | Press Plate, , 3rd Clutch (.094")(#4, 20T, 3.695" ID)2002-06 | 1-2 | 22574-PPV-A01 |
| 146 | 186140D | Press Plate, , 3rd Clutch (.098")(#5, 20T, 3.695" ID)2002-06 | 1-2 | 22575-PPV-A01 |
| 146 | 186140E | Press Plate, , 3rd Clutch (.102")(#6, 20T, 3.695" ID)2002-06 | 1-2 | 11576-PPV-A01 |
| 146 | 186140F | Press Plate, , 3rd Clutch (.106")(#7, 20T, 3.695" ID)2002-06 | 1-2 | 22577-PPV-A01 |
| 146 | 186140G | Press Plate, , 3rd Clutch (.110")(#8, 20T, 3.695" ID)2002-06 | 1-2 | 22578-PPV-A01 |
| 146 | 186140H | Press Plate, , 3rd Clutch (.114")(#9, 20T, 3.695" ID)2002-06 | 1-2 | 22579-PPV-A01 |
| 148 | 186148 | Press Plate, , 1st Clutch (.102")(#1)(24T, 3.675" ID) 2002-06..... | 1 | 22551-RCL-003 |
| 148 | 186148A | Press Plate, , 1st Clutch (.106")(#2)(24T, 3.675" ID) 2002-06..... | 1 | 22552-RCL-003 |
| 148 | 186148B | Press Plate, , 1st Clutch (.110")(#3)(24T, 3.675" ID) 2002-06..... | 1 | 22553-RCL-003 |
| 148 | 186148C | Press Plate, , 1st Clutch (.114")(#4)(24T, 3.675" ID) 2002-06..... | 1 | 22554-RCL-003 |
| 148 | 186148D | Press Plate, , 1st Clutch (.118")(#5)(24T, 3.675" ID) 2002-06..... | 1 | 22555-RCL-003 |
| 148 | 186148E | Press Plate, , 1st Clutch (.122")(#6)(24T, 3.675" ID) 2002-06..... | 1 | 22556-RCL-003 |
| 148 | 186148F | Press Plate, , 1st Clutch (.126")(#7)(24T, 3.675" ID) 2002-06..... | 1 | 22557-RCL-003 |
| 148 | 186148G | Press Plate, , 1st Clutch (.130")(#8)(24T, 3.675" ID) 2002-06..... | 1 | 22558-RCL-003 |

HONDA & ACURA

4-SPEED, 4-SHAFT (MCVA, MZKA, BZKA)

| ILL# | Part# | | QTY | REF# |
|-------------------------------|--------------|--------------------------------------------------------------------------------------------------|----------|---------------|
| 148..... | 186148H..... | Press Plate, 1st Clutch (.134")(#9)(24T, 3.675" ID) 2002-06..... | 1..... | 22559-RCL-003 |
| SEALING RINGS | | | | |
| 175..... | 186175..... | Ring Kit, MCVA/MRVA/BZKA/MZKA/GPPA, 2002-06..... | 1..... | TBA |
| WASHERS & BEARINGS | | | | |
| 206..... | 98401..... | Washer, MCVA/MRVA/BZKA/MZKA/GPPA, 2002-06..... | 1..... | 23926-P24-J00 |
| 207..... | 98401..... | Washer, MCVA/MRVA/BZKA/MZKA/GPPA, 2002-06..... | 1..... | 23926-P24-J00 |
| 208..... | 98401..... | Washer, MCVA/MRVA/BZKA/MZKA/GPPA, 2002-06..... | 1..... | 23926-P24-J00 |
| 209..... | 88209M..... | Caged Needle Bearing, Stator (Front)(1.040" OD) (1.040" OD)..... | 1..... | TBA |
| 211..... | 186211..... | Ball Brg, MCVA/MRVA/BZKA/MZKA/GPPA Bell To Conv Hub (#DG406808-PRP) 2002-06..... | 1..... | 91001-PRP-004 |
| 214..... | 186214..... | Needle Bearing, Mainshaft To Conv Reactor (.695" Thk)(1.115" OD) 2002-06..... | 1..... | 91017-PZK-003 |
| 217..... | 186217..... | Thrust Bearing, Mainshaft To 3rd Gear (2.790" OD)(2.270" ID) 2002-06..... | 1-2..... | 91026-PRP-003 |
| 220..... | 186220..... | Caged Needle Bearing, 3rd Gear (Inner) To Mainshaft (.697" Thick)(2.215" OD) 2002-06..... | 1..... | 91109-PRP-003 |
| 223..... | 186217..... | Thrust Bearing, 3rd Gear (Mainshaft) To 3rd/4th Drum (2.790" OD)(2.270" ID) 2002-06..... | 1..... | TBA |
| 224..... | 186224..... | Washer, 3rd Gear (Mainshaft) To 3rd/4th Drum (.175" Thick)(2.765" OD) 2002-06..... | 1..... | 90414-RCT-000 |
| 224..... | 186224A..... | Washer, 3rd Gear (Mainshaft) To 3rd/4th Drum (.176" Thick)(2.765" OD) 2002-06..... | 1..... | 90415-RCT-000 |
| 224..... | 186224B..... | Washer, 3rd Gear (Mainshaft) To 3rd/4th Drum (.177" Thick)(2.765" OD) 2002-06..... | 1..... | 90416-RCT-000 |
| 224..... | 186224C..... | Washer, 3rd Gear (Mainshaft) To 3rd/4th Drum (.216" Thick)(2.765" OD) 2002-Up..... | 1..... | 90418-RCT-000 |
| 224..... | 186224D..... | Washer, 3rd Gear (Mainshaft) To 3rd/4th Drum (.219" Thick)(2.765" OD) 2002-06..... | 1..... | 90419-RCT-000 |
| 224..... | 186224E..... | Washer, 3rd Gear (Mainshaft) To 3rd/4th Drum (.255" Thick)(2.765" OD) 2002-06..... | 1..... | 90417-PRP-010 |
| 225..... | 186225..... | Collar, 3rd/4th Drum To 4th Gear (Mainshaft) (2.615" Long)(1.060" ID) 2002-06..... | 1..... | 90501-PRP-000 |
| 226..... | 186226..... | Bearing, (.097" Thick)(2.094" OD)..... | 1..... | 91023-P7Z-003 |
| 229..... | 186229..... | Caged Needle Bearing, 4th/Reverse Gear To Mainshaft (1.535" Long)(1.545" OD) 2002-06..... | 1..... | 91107-PRP-003 |
| 232..... | 186232..... | Bearing, BZKA-5/BZKA-6/BZKA-7/MCVA/MRVA/MZKA-1/MZKA-2 # 232 (.078" Thick) 2002-06..... | 1..... | 91018-PW7-A02 |
| 232..... | 186232A..... | Bearing, BZKA-5/GPPA-2/MCVA/MRVA/MZKA-1 (.099" Thick) 2002-06..... | 1..... | 91021-PRP-013 |
| 235..... | 186235..... | Ball Bearing, Mainshaft To Case (.607" Thick) (3.330" OD)(9-Balls)(#27BC08S3N) 2002-06..... | 1..... | 91002-RCR-016 |
| 238..... | 186238..... | Ball Bearing, Bell Housing To Secondary Shaft (Cast # TA-SX06C51NV1) 2002-06..... | 1..... | 91005-PRP-003 |
| 241..... | 186241..... | Caged Needle Bearing, 1st Gear To 2nd Shaft (Inner)(1.125" Thick)(1.815" OD) 2002-06..... | 1..... | 91105-PRH-003 |
| 242..... | 186242..... | Thrust Bearing, 2nd Shaft To 1st Gear (.099" Thick)(2.338" OD)(1.842" ID) 2002-06..... | 1-2..... | 91022-PRP-003 |
| 243..... | 186232A..... | Bearing, BZKA-5/GPPA-2/MCVA/MRVA/MZKA-1 1st Gear(2ndary) To 1st Clu Drum (.099" Thk)..... | 1..... | 91021-PRP-013 |
| 244..... | 186244..... | Washer, 1st Gear (Secondary Shaft) To 1st Drum (.189" Thick)(2.030" OD) 2002-06..... | 1..... | 90503-RCT-000 |
| 244..... | 186244A..... | Washer, 1st Gear (Secondary Shaft) To 1st Drum (.191" Thick)(2.030" OD) 2002-06..... | 1..... | 90504-RCT-000 |
| 244..... | 186244B..... | Washer, 1st Gear (Secondary Shaft) To 1st Drum (.193" Thick)(2.030" OD) 2002-06..... | 1..... | 90505-PRP-000 |
| 244..... | 186244C..... | Washer, 1st Gear (Secondary Shaft) To 1st Drum (.195" Thick)(2.030" OD) 2002-06..... | 1..... | 90506-RCT-000 |
| 244..... | 186244D..... | Washer, 1st Gear (Secondary Shaft) To 1st Drum (.197" Thick)(2.030" OD) 2002-06..... | 1..... | 90507-PRP-000 |
| 244..... | 186244E..... | Washer, 1st Gear (Secondary Shaft) To 1st Drum (.199" Thick)(2.030" OD) 2002-06..... | 1..... | 90508-PRP-000 |
| 245..... | 186245..... | Collar, 1st Clutch Drum To Idler Gear (1.732" Long) 2002-06..... | 1..... | 90443-PRH-000 |
| 250..... | 186242..... | Thrust Bearing, (.099" Thick)(2.338" OD)(1.842" ID) 2002-06..... | 1..... | 91022-PRP-003 |
| 251..... | 186251..... | Needle Bearing, 2nd Gear (Inner) To Secondary Shaft (.790" Thick)(1.783" OD) 2002-06..... | 1..... | 91106-PRP-025 |
| 252..... | 186252..... | Washer, 2nd Drum To 2nd Gear (.153" Thick) (2.285" OD) 2002-06..... | 1..... | 90511-PRP-010 |
| 252..... | 186252A..... | Washer, 2nd Drum To 2nd Gear (.154" Thick) (2.285" OD) 2002-06..... | 1..... | TBA |
| 252..... | 186252B..... | Washer, 2nd Drum To 2nd Gear (.155" Thick) (2.285" OD) 2002-06..... | 1..... | 90513-PRP-010 |
| 252..... | 186252C..... | Washer, 2nd Drum To 2nd Gear (.156" Thick) (2.285" OD) 2002-06..... | 1..... | 90514-PRP-010 |
| 252..... | 186252D..... | Washer, 2nd Drum To 2nd Gear (.157" Thick) (2.285" OD) 2002-06..... | 1..... | 90515-PRP-010 |
| 252..... | 186252E..... | Washer, 2nd Drum To 2nd Gear (.158" Thick) (2.285" OD) 2002-06..... | 1..... | 90516-PRP-010 |
| 252..... | 186252F..... | Washer, 2nd Drum To 2nd Gear (.159" Thick) (2.285" OD) 2002-06..... | 1..... | 90517-PRP-010 |
| 252..... | 186252G..... | Washer, 2nd Drum To 2nd Gear (.160" Thick) (2.285" OD) 2002-06..... | 1..... | 90518-PRP-010 |
| 252..... | 186252H..... | Washer, 2nd Drum To 2nd Gear (.161" Thick) (2.285" OD) 2002-06..... | 1..... | 90519-PRP-010 |
| 252..... | 186252J..... | Washer, 2nd Drum To 2nd Gear (.162" Thick) (2.285" OD) 2002-06..... | 1..... | 90520-PRP-010 |
| 252..... | 186252K..... | Washer, 2nd Drum To 2nd Gear (.163" Thick) (2.285" OD) 2002-06..... | 1..... | 90521-PRP-010 |
| 252..... | 186252L..... | Washer, 2nd Drum To 2nd Gear (.164" Thick) (2.285" OD) 2002-06..... | 1..... | 90522-PRP-010 |
| 252..... | 186252M..... | Washer, 2nd Drum To 2nd Gear (.165" Thick) (2.285" OD) 2002-06..... | 1..... | 90523-RP-000 |
| 252..... | 186252N..... | Washer, 2nd Drum To 2nd Gear (.166" Thick) (2.285" OD) 2002-06..... | 1..... | 90524-PRP-000 |
| 252..... | 186252P..... | Washer, 2nd Drum To 2nd Gear (.167" Thick) (2.285" OD) 2002-06..... | 1..... | 90525-PRP-000 |
| 252..... | 186252Q..... | Washer, 2nd Drum To 2nd Gear (.168" Thick) (2.285" OD) 2002-06..... | 1..... | 90526-PRP-000 |
| 252..... | 186252R..... | Washer, 2nd Drum To 2nd Gear (.169" Thick) (2.285" OD) 2002-06..... | 1..... | 90527-PRP-000 |
| 252..... | 186252S..... | Washer, 2nd Drum To 2nd Gear (.170" Thick) (2.285" OD) 2002-06..... | 1..... | 90528-PRP-000 |
| 252..... | 186252T..... | Washer, 2nd Drum To 2nd Gear (.171" Thick) (2.285" OD) 2002-06..... | 1..... | 90529-PRP-000 |
| 252..... | 186252U..... | Washer, 2nd Drum To 2nd Gear (.172" Thick) (2.285" OD) 2002-06..... | 1..... | 90530-PRP-000 |
| 253..... | 186253..... | Thrust Bearing, (.099" Thick)(2.338" OD)(1.842" ID) 2002-06..... | 1..... | 91022-PRP-003 |
| 254..... | 186254..... | Roller Bearing, Bell Housing To Countershaft (.710" Thick)(2.520" OD)(12 Rollers) 2002-06..... | 1..... | 91102-PZK-003 |
| 267..... | 186267..... | Collar, 3rd Gear (Countershaft)(3.260" Long) (1.610" OD)(1.455" ID) 2002-06..... | 1..... | 90441-PPV-000 |
| 269..... | 186269..... | Collar, 4th Gear (Countershaft)(.305" Thick) (1.845" OD)(1.380" ID) 2002-06 1.90445-PPV-000..... | 1..... | 90441-PPV-000 |
| 271..... | 98440..... | Caged Needle Bearing (1.007" Thick)..... | 1..... | TBA |
| 273..... | 186273..... | Needle Bearing, Reverse Gear To Countershaft (Inner)(.560" Thick)(1.780" OD) 2002-06..... | 1..... | 91024-PRP-004 |
| 274..... | 186274..... | Ball Bearing, Countershaft To Case (3.150" OD)(11-Balls)(Cast # HTF B31-10NX) 2002-06..... | 1..... | 91003-RFK-015 |
| 283..... | 186283..... | Caged Needle Bearing, Reverse Idler Gear (Inner)(.615" Thick)(.750" OD) 2002-06..... | 1..... | 91025-POX-003 |

4-SPEED, 4-SHAFT (MCVA, MZKA, BZKA)

| ILL# | Part# | | QTY | REF# |
|-----------------------------------------|----------|---------------------------------------------------------------------------------------------|-----|---------------|
| 286 | 186286 | Ball Bearing, 2ndary Shaft To Case (.550" Thk, 2.165" OD)(9-Balls)(#SX05B52NPX1V1) 2002 | 1 | 91004-RCL-003 |
| 288 | 186288 | Cup Race, Diff To Case (.540" Thick) (3.003" OD)(Cast # NTN ECO CR-08A78-1) 2002-06 | 1 | TBA |
| 289 | 186289 | Cone Brg, Diff To Case (1.575" ID) (21-Roller)(Cast # NTN ECO CR-08A78-1 Or -2) 2002-06 | 1 | TBA |
| 290 | *186290 | *Selective Shim, Diff Bearing To Case (.061" To .121" Thick) (2.980" OD, 2.680" ID) 2002-06 | 1 | 41428-PRP-000 |
| 291 | 98430B | Cup Race, Diff To Bell Hsg (3.150" OD) (ET-CR-08A32ST) | 1 | TBA |
| 292 | 98420B | Cone Brg, Diff To Bell Hsg (20 Rollers) (ET-CR-0834ST) | 1 | TBA |
| 292 | 98420BK | Cone Bearing W/Cup Race, Diff To Bell Hsg # 291/292 | 1 | 08A71ST |
| 298 | 186298 | Ball Bearing, (.235" Thick)(.945" OD) (.472" ID)(Cast # NSK6901) | 1 | 91010-RJF-005 |
| 299-1 | 186299-1 | Double Ball Bearing, Idler Shaft To Case (.943" Thk)(1.890" OD) (Cast # 20BG04S6N) 2002-06 | 1 | 91006-PRP-026 |
| 299 | 186299 | Roller Brg, Idler Gear To Shaft (.727" Thk)(11-Rollers, #HL-BE-NK 32X55X18.5PX1) 2002-06 | 1 | 91103-RCL-023 |
| ELECTRICAL COMPONENTS | | | | |
| | | **SEE HONDA/ACURA SOLENOID QUICK REF FOR SOLENOIDS & PRESS SWITCHES** | | |
| 410 | 186410 | Neutral Safety Switch, MCVA/MRVA/BZKA/MZKA/GPPA (10-Blade Rectangle Conn) 2002-06 | 1 | 28900-PPV-013 |
| 436 | 98910 | Speed Sensor, (On The Side Rear Of Case) (1.985" Long)(W/.700" OD Plastic Tip) 2002-06 | 1 | 28820-PPW-013 |
| 438 | 98910A | Sensor, MCVA/MRVA/BZKA/MZKA/GPPA (3-Prong, Chrome Tip) 2002-06 | 1 | 28810-PPW-013 |
| 444 | 186444 | Case Conn, W/ Temp Sensor & 4 Solenoid Conn (7 Pin)(10-Hole Rectangle Conn) 2002-06 | 1 | 28360-PRH-003 |
| 445 | 186445 | Wire Harness, MCVA/MRVA/BZKA/MZKA/GPPA (10-7/8" Long)(10 Wire) 2002-06 | 1 | 28950-PRP-010 |
| 489 | 186489 | Cover, MCVA/MRVA/BZKA/MZKA/GPPA Neutral Safety Switch (Black)(Tin) 2002-06 | 1 | 21720-RCT-010 |
| MISCELLANEOUS COMPONENTS | | | | |
| 492 | 98628 | Drain Plug, MCVA/MRVA/BZKA/MZKA/GPPA | 1 | 90081-PX4-003 |
| 493 | 186493 | Dip Stick, MCVA/MRVA/BZKA/MZKA/GPPA(12" Long)(Goes Into Top Rear Of Case) 2002-06 | 1 | 25610-PPW-023 |
| PUMP COMPONENTS | | | | |
| 529-1 | 186529-1 | Dowel Pin, Stator Tube Stop (.313" OD) (3.145" Long) 2002-06 | 1 | 90701-PK4-000 |
| 529 | 186529 | Tube, BZKA-5/GPPA-2/MCVA/MRVA/MZKA-1/MZKA-2 Stator (3.910" Long Shaft) 2002-06 | 1 | 25155-PRP-000 |
| 530 | 88201 | Pump Gears, (38 Spline Gear)(28 Teeth)(.470" Thick) | 1 | TBA |
| 535 | 88535 | Pin, Pump Gear, 2002-06 | 1 | 25145-PA9-010 |
| DRUMS | | | | |
| 550 | 186550 | Drum, 3rd/4th Drum (2.780" Thick) 2002-06 | 1 | 22651-PRP-003 |
| 552 | 186552 | Drum, 2nd Clutch (Uses 24 Teeth Steels) (5.155" OD) 2002-06 | 1 | 22610-PPV-A03 |
| 554 | 186554 | Drum, 1st Clutch (Uses 24 Teeth Steels) (5.203" OD) 2002-06 | 1 | 22510-PPV-A02 |
| SHAFTS | | | | |
| 672 | 186672 | Mainshaft, (14 3/8" Long)(2.750" OD Flange) 2002-06 | 1 | 23210-PPV-000 |
| 675 | 186675 | Secondary Shaft, (12 1/16" Long)(.148" Thick Flange) 2002-06 | 1 | 23230-PRH-020 |
| 676 | 186676 | Countershaft, BZKA-5/MCVA (Some)/MRVA/MZKA-1/MZKA-2 (16T, 2-ID)(11-5/8") 2002-06 | 1 | 23221-PPV-A03 |
| 676 | 186676A | Countershaft, GPPA-2/MCVA (Some)(16 Teeth, 1 Groove)(11 5/8" Long) 2002-04 | 1 | TBA |
| 679 | 186679 | Shaft, Idler (3.400" Long)(.152" Thick Flange) 2002-06 | 1 | 23516-RCL-010 |
| 689 | 186689 | Oil Guide, Bell Housing To Countershaft (Tin) (.026" Thick)(2.510" OD) 2002-06 | 1 | 23225-PRP-020 |
| 690 | 186690 | Parking Gear, (15 Lugs)(4.405" OD) 2002-06 | 1 | 23427-PRP-000 |
| 694 | 186694 | Retainer, Holds Horseshoe Clips To Idler Shaft (.101" Thick)(1.060" OD)(.789" ID) 2002-06 | 1 | 90432-PRP-000 |
| DIFFERENTIALS | | | | |
| 695 | 186695 | Oil Baffle, Diff Hsg To Bell Hsg (.040" Thick)(3.140" OD)(1.612" ID)(1-Tab) 2002-06 | 1 | 41381-PRP-010 |
| 697 | 186697 | Oil Guide Collar, In Bell Hsg Under Brg # 238 (Alum)(.850" Thick)(1.140" ID) 2002-06 | 1 | 23235-PRP-000 |
| 698 | 186698 | Spacer, Diff To Case (.040" Thick) (2.995" OD)(1.620" ID)(1 Tab) 2002-06 | 1 | 41382-PRP-010 |
| 707 | 186707 | Transfer Gear, MRVA/MZKA-1/MZKA-2 Drive (69 Teeth, No-ID)(1.180" Thick)(10 Bolt) 2002-06 | 1 | 29011-PRV-010 |
| 710 | 186710 | Gear, BZKA-5/MZKA-1/MZKA-2 Idler (Mainshaft)(39 Teeth, 2 Groove) 2003-06 | 1 | TBA |
| 710 | 186710A | Gear, GPPA-2/MCVA/MRVA Idler (Mainshaft)(39 Teeth, 1 Groove) 2002-04 | 1 | 23511-RCL-010 |
| 712 | 186712 | Gear, Idler (Secondary Shaft)(39 Teeth, 1 Groove)(1.045" Thick)(3.365" OD) 2002-06 | 1 | 23521-PRH-000 |
| 714 | 186714 | Idler Gear, (34 Teeth / 44 Teeth)(2.305" Thick) (1.415" ID) 2002-06 | 1 | TBA |
| 715 | 186715 | Diff Assembly, BZKA/MCVA (71 Teeth, 2-ID Ring Gear) 2002-06 | 1 | TBA |
| 715 | 186715A | Diff Assembly, MRVA/MZKA (71 Teeth, 4-ID Ring Gear)(69T Drive Transfer Gear) 2002-06 | 1 | TBA |
| 716 | 186716 | Diff Hsg, BZKA-5/MCVA (W/10-Threaded Bolt Holes)(.430" Thick Bolt Flange) 2002-06 | 1 | TBA |
| 716 | 186716A | Diff Hsg, GPPA-2/MRVA/MZKA-1/MZKA-2 (10-Unthreaded Holes)(.400" Thk Flange) 2002-06 | 1 | 41100-RCL-J05 |
| 720 | 186720 | Diff Ring Gear, BZKA-5/MCVA (71 Teeth, 4 Groove) 2002-06 | 1 | 41233-RCL-010 |
| 720 | 186720A | Diff Ring Gear, GPPA-2/MRVA/MZKA-1/MZKA-2 (71 Teeth, 2 Grooves) 2002-06 | 1 | 41233-PZN-000 |
| VALVE BODIES | | | | |
| 740 | 186740 | Valve Body, MCVA/MRVA/BZKA/MZKA/GPPA (Less Gears)(Cast # PRP) 2002-06 | 1 | 27000-RXH-000 |
| 741 | K121908A | Lube Kit, Conv Overheat, Cooler Flow/Conv Charge Fixes Most V-6 1997-Up (Transgo) | 1 | HONDA-LK |
| 741 | K121908B | Lube Kit, Conv Overheat, Cooler Flow/Conv Charge Fixes Most 4-Cyl 1994-Up (Transgo) | 1 | HONDA-LK2 |
| 746 | 186746 | Separator Plate, MCVA/MRVA/BZKA/MZKA/GPPA Servo Body To Valve Body 2002-06 | 1 | 27412-PRH-000 |
| 747 | 186747 | Plate, MCVA/MRVA/BZKA/MZKA/GPPA Valve Body 2002-06 | 1 | 27112-PRH-010 |
| HOUSINGS, CASES & COMPONENTS | | | | |

HONDA & ACURA

4-SPEED, 4-SHAFT (MCVA, MZKA, BZKA)

| ILL# | Part# | | QTY | REF# |
|--------------------------------------------------------------|---------|--------------------------------------------------------------------------------------------|-----|---------------|
| 750..... | 186750 | Bell Hsg, BZKA-5 (2WD) (Cast # PRP-1)(2.4L) 2003-06 | 1 | 21111-PZK-305 |
| 750..... | 186750A | Bell Hsg, GPPA-2/MRVA/MZKA-1/2 (2WD, 2.4L) (#PRH-3 Or PRH-4) 2002-06 | 1 | 21111-PRV-305 |
| 750..... | 186750B | Bell Hsg, MCVA (2WD) (8 3/4" Top Bolts)(Cast # PZK-1)(2.4L) 2002-04 | 1 | 21111-PRM-305 |
| 757..... | 186757 | Solenoid Cover, BZKA/MCVA/MRVA/MZKA (Aluminum)(9 Bolt) 2002-06 | 1 | 28450-PRP-000 |
| 759..... | 186759 | Rear Cover, BZKA-5/GPPA-2/MCVA/MRVA/MZKA-1/2 (16 Bolt)(Cast # PRH) 2002-06 | 1 | 21240-PRH-020 |
| 760..... | 186760 | Case, BZKA-5 (2WD)(19 Bolts To Bell)(Cast # PZK-1) 2003-06 | 1 | 21210-PZK-000 |
| 760..... | 186760A | Case, MZKA-1/MZKA-2 (AWD)(20 Bolts To Bell)(Cast # PRH) 2003-04 | 1 | 21210-PRW-900 |
| 760..... | 186760B | Case, MCVA (2WD)(19 Bolts To Bell)(Cast # PRP-3) 2002-04 | 1 | 21210-PRP-020 |
| 760..... | 186760C | Case, GPPA-2/MRVA (AWD)(20 Bolts To Bell)(Cast # PRH) 2002-04 | 1 | 21210-PRH-020 |
| 776..... | 186776 | Bolt, BZKA-5/GPPA-2/MCVA Bell Housing To Case, 2002-06 | 19 | TBA |
| 776..... | 186776A | Bolt, MRVA/MZKA Bell Housing To Case, 2002-06 | 20 | TBA |
| 780..... | 186780 | Bolt, BZKA-5/GPPA-2/MCVA/MRVA/MZKA-1/MZKA-2 Rear Cover To Case, 2002-06 | 16 | TBA |
| 786..... | 186786 | Bolt, GPPA-2/MRVA/MZKA-1/MZKA-2 Diff Ring Gear/Transfer Gear (1.475" Long) 2002-06 | 10 | 90017-PET-000 |
| 786..... | 186786A | Bolt, BZKA-5/MCVA Differential Ring Gear (1.030" Long) 2002-06 | 10 | 90003-PA9-003 |
| 795..... | 121949 | Nut, MCVA/MRVA/BZKA/MZKA/GPPA, 2002-06 | 1 | 90203-PX4-010 |
| 796..... | 121948A | Nut, MCVA/MRVA/BZKA/MZKA/GPPA # 796 & 797 (Left Hand Thread) 2002-06 | 1 | 90201-PRP-000 |
| 797..... | 121948A | Nut, MCVA/MRVA/BZKA/MZKA/GPPA # 796 & 797 (Left Hand Thread) 2002-06 | 1 | 90201-PRP-000 |
| GEARS, FORKS & CUSHIONS | | | | |
| 801..... | 186801 | Gear, , 1st (Counter)(56T, 1-ID, 5.600" OD) 2002-06 | 1 | 23421-PPV-010 |
| 802..... | 186802 | Gear, , 1st (2ndary Shaft)(27T, No-ID, 2.595" Thick) 2002-06 | 1 | 23411-PRH-010 |
| 803..... | 186803 | Gear, , 2nd (2ndary Shaft)(43T, 2-ID, 1.983" Thick) 2002-06 | 1 | 23431-PPV-020 |
| 804..... | 186804 | Gear, , 2nd (Counter)(51T, 1-ID, 4.520" OD) 2002-06 | 1 | 23441-PPV-000 |
| 806..... | 186806 | Gear, BZKA-5/MZKA-1/MZKA-2 3rd (Mainshaft)(37 Teeth, 3 Groove)(3.620" OD) 2003-06 | 1 | 23455-PZK-000 |
| 806..... | 186806A | Gear, GPPA-2/MCVA/MRVA 3rd (Mainshaft)(39 Teeth, 2 Groove)(3.740" OD) 2002-04 | 1 | 23455-PPV-A01 |
| 807..... | 186807 | Gear, BZKA-5/MZKA-1/2 3rd (Countershaft)(40 Teeth, 1 Groove)(3.890" OD) 2003-06 | 1 | 23451-PRH-000 |
| 807..... | 186807A | Gear, GPPA-2/MCVA/MRVA 3rd (Countershaft)(38 Teeth, 2 Groove)(3.765" OD) 2002-04 | 1 | 23451-PPV-A00 |
| 809..... | 186809 | Gear, BZKA-5/MZKA-1/2, 4th/Rev (Main) (45T, 2-ID on 4th) (22T, No-ID on Rev) 2003-06 | 1 | 23461-PZK-000 |
| 809..... | 186809A | Gear, GPPA-2/MCVA/MRVA 4th/Rev (Main)(45T, 3-ID on 4th) (22T, No-ID on Rev) 2002-04 | 1 | 23461-PPV-A01 |
| 810..... | 186810 | Gear, BZKA-5/MZKA-1/MZKA-2 4th (Countershaft)(No Groove)(3.230" OD) 2003-06 | 1 | 23741-PZK-000 |
| 810..... | 186810A | Gear, GPPA-2/MCVA/MRVA 4th (Countershaft)(30 Teeth, 1 Groove) 2002-04 | 1 | 23741-PPV-A00 |
| 816..... | 186816 | Gear, Reverse (Counter)(44T, 4.485" OD, 1.805" ID) 2002-06 | 1 | 23531-PRP-010 |
| 818..... | 186818 | Gear, , Reverse Idler (26T, No-ID, .610" Thk, 2.810" OD, .786" ID) 2002-06 | 1 | TBA |
| 820..... | 186820 | Bracket, , Reverse Idler (1-Bolt)(Aluminum) (W/Shaft) 2002-06 | 1 | 21215-PRP-000 |
| 830..... | 186830 | Selector, , Reverse (.648" Thick) 2002-06 | 1 | 23565-PRP-010 |
| 835..... | 186835 | Hub, , Reverse Selector (26 Outer Teeth) (1.008" Thick) 2002-06 | 1 | 23566-PRP-000 |
| 840..... | 186840 | Fork, Reverse (2.455" ID At Forks) 2002-06 | 1 | 24111-PRP-000 |
| 850..... | 186850 | Cushion, , 4th Clutch Wave Spring (.071" Thk, 4.605" OD) 2002-06 | 1 | 22536-PRP-013 |
| 852..... | 186852 | Cushion, , 2nd Clutch Wave Spring (.071" Thk, 4.605" OD) 2002-06 | 1 | 22537-PRP-003 |
| 853..... | 186850 | Cushion, , 1st Clutch Wave Spring (.071" Thk, 4.605" OD) 2002-06 | 1 | 22536-PRP-013 |
| 858..... | 186850 | Cushion, , 3rd Clutch Wave Spring (.071" Thk, 4.605" OD) 2002-06 | 1 | 22536-PRP-013 |
| SNAP RINGS | | | | |
| 861..... | 186861 | Snap Ring, Holds 4th Clutch Pressure Plate In Drum (.070" Thick)(5.230" OD) 2002-06 | 1 | 90605-P7T-003 |
| 862..... | 186862 | Snap Ring, Holds 4th Clutch Retainer In, 2002-06 | 1 | 90603-PX4-000 |
| 870..... | 186870 | Snap Ring, 2002-06 | 1 | TBA |
| 871..... | 186862 | Snap Ring, Holds 3rd Clutch Retainer In, 2002-06 | 1 | 90603-PX4-000 |
| 873..... | 184861 | Snap Ring, Holds 2nd Clutch Pressure Plate In Drum (.069" Thk, 5.070" OD) 2002-06 | 1 | 90605-PX4-000 |
| 874..... | 186874 | Snap Ring, 2nd Clutch Retainer In # 877 & # 874 (.070" Thick)(1.945" OD) | 1 | 90603-P6H-003 |
| 876..... | 184861 | Snap Ring, Holds 1st Clutch Pressure Plate In Drum (.069" Thick)(5.070" OD) 2002-06 | 1 | 90605-PX4-000 |
| 877..... | 186874 | Snap Ring, 1st Clutch Retainer In # 877 & # 874 (.070" Thick)(1.945" OD) | 1 | 90603-P6H-003 |
| 878..... | 186861 | Snap Ring, Holds 3rd Clutch Pressure Plate In Drum (.070" Thick)(5.230" OD) 2002-06 | 1 | 90605-P7T-003 |
| 879..... | 186879 | Snap Ring, Holds Caged Bearing To Mainshaft | 1 | 90603-P0X-000 |
| 880..... | 186880 | Snap Ring (.077" Thick, 3.355" OD) 2002-06 | 1 | 90615-POZ-000 |
| 881..... | 186881 | Snap Ring, Holds 2nd Clutch Drum To 2ndary Shaft (.078" Thick)(1.405" OD) 2002-06 | 1 | 90621-PRP-000 |
| 886..... | 186886 | Snap Ring, Holds Collar To Countershaft (.040" Thick) 2002-06 | 1 | 90614-PX4-700 |
| 887..... | 98621A | Horse Shoe Clips (.078" Thick, 1.699" Long, .187" Wide) 2002-06 | 1 | 90431-P6H-000 |
| 889..... | 186889 | Snap Ring, Holds Bearing # 286 To Case (.078" Thick)(2.285" OD, Bent Ends) 2002-06 | 1 | 90614-PRP-000 |
| 890..... | 186890 | Snap Ring, Holds Bearing # 274 To Case (.077" Thick)(3.285" OD, Bent Ends) 2002-06 | 1 | 90609-PX4-000 |
| 895..... | 186895 | Snap Ring, Holds Idler Gear # 714 To Idler Shaft (.070" Thk)(1.540" OD)(2-Eyelets) 2002-06 | 1 | 94510-36000 |
| 897..... | 186897 | Horse Shoe Clips, Idler Shaft (.056" Thick)(.970" Long)(2 Per Pack) 2002-06 | 1 | 90431-PRP-000 |
| 898..... | 186898 | Snap Ring, Holds Idler Shaft Bearing To Case (.077" Thick)(1.970" OD, Bent Ends) 2002-06 | 1 | 90613-PRP-000 |
| 899..... | 186899 | Snap Ring, Holds Retainer To Idler Shaft (.047" Thick)(.880" OD)(W/2 Eyelets) 2002-06 | 1 | 94510-20000 |
| ACCUMULATORS, REGULATORS, PISTONS & MISCELLANEOUS | | | | |
| 900..... | 186900 | Accumulator, MCVA/MRVA/BZKA/MZKA/GPPA, With Pistons (Cast # PRH) 2002-06 | 1 | 27405-PZK-010 |
| 924..... | 186924 | Regulator Body, (Cast # PPW Or PRH) (Less Plate) 2002-06 | 1 | 27200-PPW-000 |
| 960..... | 186960 | Piston, 4th Clutch (.443" Thk, 4.710" OD, 1.860" ID) 2002-06 | 1 | 22680-RCL-003 |

HONDA & ACURA

4-SPEED, 4-SHAFT (MCVA, MZKA, BZKA)

| ILL# | Part# | | QTY | REF# |
|-----------|---------------|-------------------------------------------------------------------------------------------|----------|---------------|
| 962..... | 186962..... | Piston, , 2nd Clutch (.550" Thick)(4.710" OD) 2002-06..... | 1..... | 22721-PRP-003 |
| 965..... | 186960..... | Piston, , 3rd Clutch (.443" Thk, 4.710" OD, 1.860" ID) 2002-06..... | 1..... | 22680-RCL-003 |
| 967..... | 186967..... | Piston, , 1st Clutch (.550" Thick)(4.710" OD) 2002-06..... | 1..... | 22680-RCL-003 |
| 970..... | 88744MA..... | Spring, 4th Clutch Return (1.320" Tall Coil Height) 2002-06..... | 1..... | 22541-PX4-004 |
| 972..... | 186972..... | Spring, 2nd Clutch Return (.275" Thick Wire) (2.550" OD) 2002-06..... | 1..... | 22541-PRP-003 |
| 975..... | 88744MA..... | Spring, 3rd Clutch Return (1.320" Tall Coil Height) 2002-06..... | 1..... | 22541-PX4-004 |
| 977..... | 188972..... | Spring, 1st Clutch Return (.275" Thick Wire) (2.550" OD) 2002-06..... | 1..... | 22541-PRP-003 |
| 980..... | 88745MA..... | Retainer, 4th Clutch, 2002-06..... | 1..... | 22533-PX4-010 |
| 982..... | 121754A..... | Retainer/Piston, 2nd Clutch (Bonded) (.930" Thick Through Center)(4.190" OD) 2002-06..... | 1..... | 22533-PRP-003 |
| 985..... | 88745MA..... | Retainer, 3rd Clutch, 2002-06..... | 1..... | 22533-PX4-010 |
| 987..... | 121754A..... | Retainer/Piston, 1st Clutch (Bonded) (.930" Thick Through Center)(4.190" OD) 2002-06..... | 1-2..... | 22533-PRP-003 |
| 991-4.... | 186991-4..... | Shift Rod, BZKA-5/GPPA-2/MCVA/MRVA/MZKA-1/MZKA-2 (18 3/4" Long) 2002-06..... | 1..... | 24410-PPV-000 |
| 995..... | 186995..... | Park Pawl Assembly, BZKA-5/GPPA-2/MCVA/MRVA/MZKA-1/MZKA-2 (2 Pieces) 2002-06..... | 1..... | TBA |
| 996..... | 88631M..... | Fitting, (Cooler Line Fitting)(1 1/2" Long)(Holds Cooler Line To Bell)..... | 1..... | 25951-639-000 |
| 999-3.... | 186999-3..... | Tube Set, In Rear Cover (2 Tubes) 2002-06..... | 1..... | TBA |
| 999-4.... | 186999-4..... | Tube, Solenoid Hsg To Regulator Body (No Screen)(1.375" Long)(1-Per Trans) 2002-06..... | 1..... | 22749-PW4-000 |
| 999-5.... | 186999-5..... | Tube, Solenoid Hsg To Regulator Body (Screened)(1.400" Long)(6-Per Trans) 2002-06..... | 6..... | 22760-PPW-000 |
| 999..... | 186999..... | Tube Set, Regulator Body & Accumulator To Bell Housing & Case (6 Pieces) 2002-06..... | 1..... | TBA |

Notes