

4L80E, 4L85E

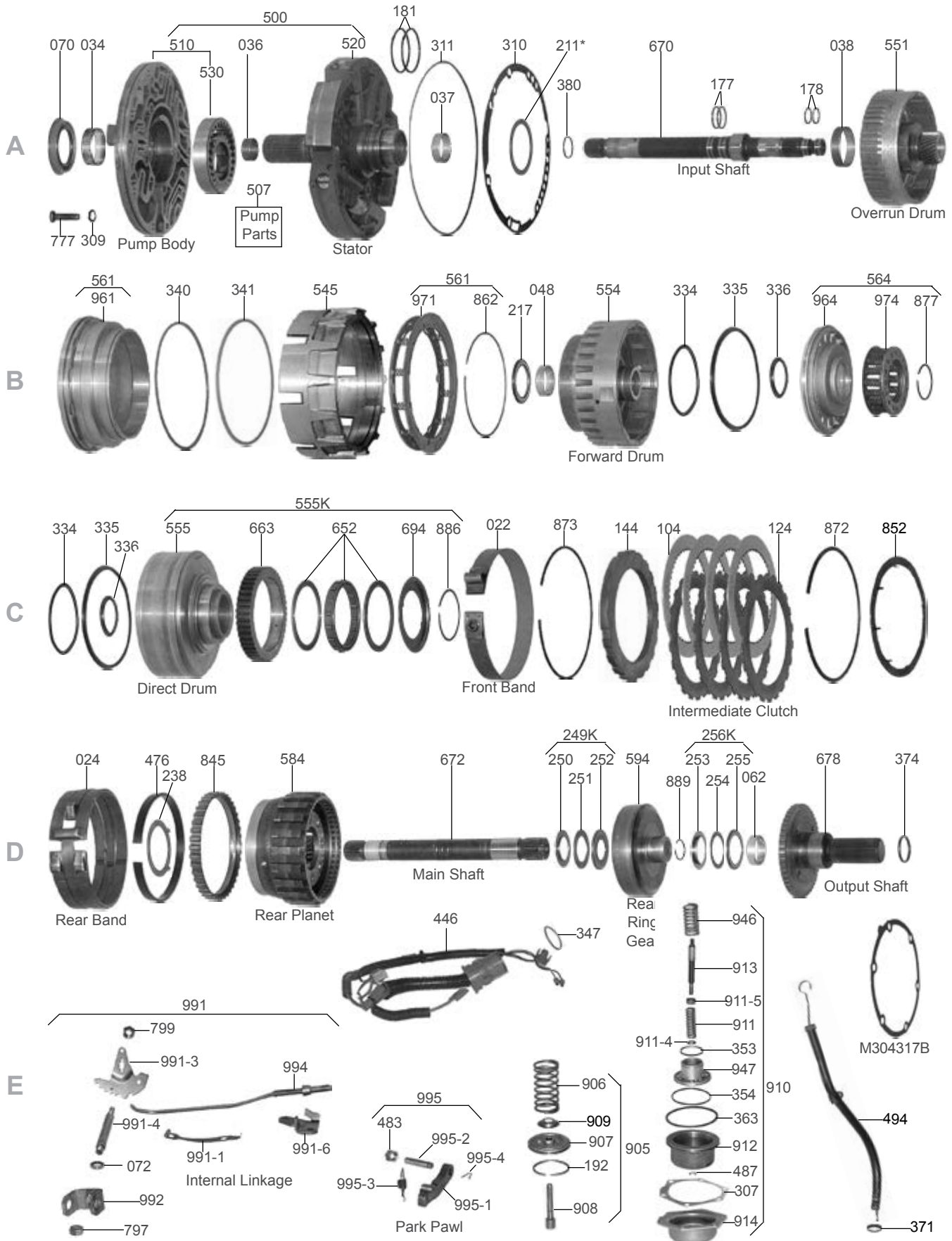

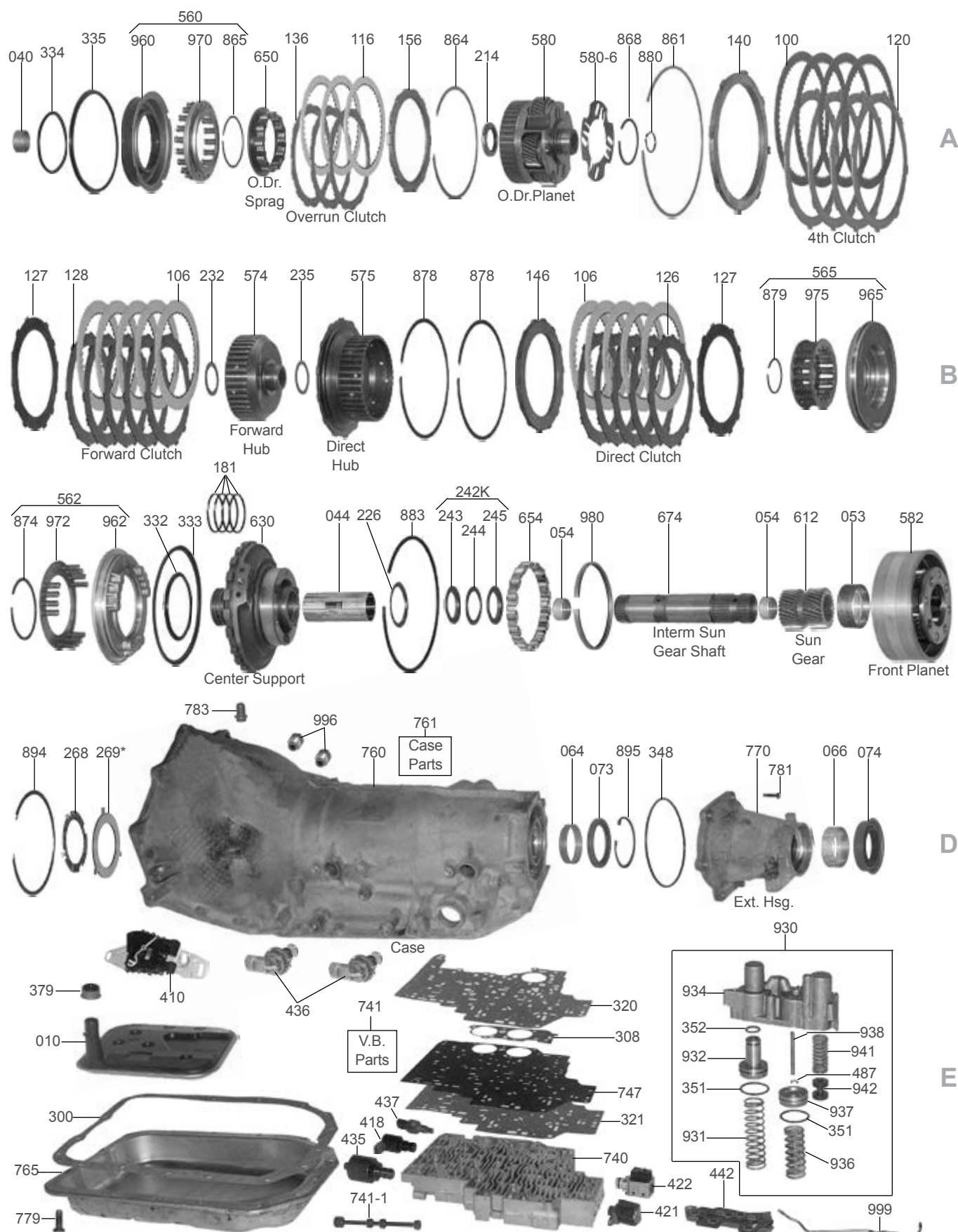



400, 3L80, 4L80E, 4L85E

ILL#	Part#		QTY	REF#
OVERHAUL KITS & PISTON KITS				
NI.....	K34900A.....	Overhaul Kit, 400 (Short Ring Kit) 1965-Up	1.....	N/A
NI.....	K34900AL.....	Overhaul Kit, 400 (Full Ring Kit) 1965-Up	1.....	N/A
NI.....	K34900F.....	Overhaul Kit, 425 1966-78.....	1.....	N/A
NI.....	K34900E.....	Overhaul Kit, 4L80E 1991-96	1.....	N/A
NI.....	K34900G.....	Overhaul Kit, 4L80E 97-Up W / Bonded Pistons	1.....	N/A
NI.....	K34900GX.....	Overhaul Kit, 4L80E 97-Up W/ Out Bonded Pistons	1.....	N/A
NI.....	K34941.....	Piston Kit, 4L80E (Bonded) (Direct/Forward/Overrun) 1997-Up	1.....	N/A
MASTER L/STEEL KITS				
NI.....	DK3400AS.....	Master L/Steel Kit, 400 (Short Ring Kit) 1965-Up	1.....	N/A
NI.....	DK3400ASL.....	Master L/Steel Kit, 400 (Full Ring Kit) 1965-Up	1.....	N/A
NI.....	DK3400FS.....	Master L/Steel Kit, 425 1966-78	1.....	N/A
NI.....	DK3400ES.....	Master L/Steel Kit, 4L80E 1991-96.....	1.....	N/A
NI.....	DK3400GS.....	Master L/Steel Kit, 4L80E 97-Up W / Bonded Pistons	1.....	N/A
NI.....	DK3400GXS.....	Master L/Steel Kit, 4L80E 97-Up W/ Out Bonded Pistons.....	1.....	N/A
MASTER W/STEELS KITS				
NI.....	DK3400A.....	Master W/Steel Kit, 400 (Short Ring Kit) 1965-Up	1.....	N/A
NI.....	DK3400AL.....	Master W/Steel Kit, 400 (Full Ring Kit) 1965-Up	1.....	N/A
NI.....	DK3400HD.....	Super W/Steels (Hi-Perf-Red, Kolene, 2-Kevlar Bands, Modulator, Brass Filter, Fairbanks Kit).....	1.....	N/A
NI.....	DK3400F.....	Master W/Steel Kit, 425 1966-78.....	1.....	N/A
NI.....	DK3400E.....	Master W/Steel Kit, 4L80E 1991-96	1.....	N/A
NI.....	DK3400G.....	Master W/Steel Kit, 4L80E 97-Up W / Bonded Pistons	1.....	N/A
NI.....	DK3400GX.....	Master W/Steel Kit, 4L80E 97-Up W/ Out Bonded Pistons	1.....	N/A
FILTERS				
010.....	34661.....	Filter, 400 1964-E67	1.....	5579822
010.....	34661A.....	Filter, 400 Flat (Felt) L1967-Up.....	1.....	6438348
010.....	34661C.....	Filter, 400 Flat (Brass) L1967-Up	1.....	6437741
010.....	34661B.....	Filter, 425 1966-78	1.....	6438336
010.....	34661E.....	Filter, 4L80E 1991-96	1.....	8678757
010.....	34661F.....	Filter, 4L80E Deep Pan 1997-Up w/4 Raised Projections	1.....	24204277
MISCELLANEOUS FILTERS				
016.....	34665.....	Screen, 400 Governor (Tapered) 1964-Up	1.....	8627509
018.....	34663.....	Screen, 4L80E Force Motor/Pressure Control 1991-Up.....	1.....	8685041
018.....	34664.....	Screen, 4L80E Shift Solenoid 1991-Up.....	1.....	8661709
016.....	34662.....	Screen, 4L80E TCC/PWM Solenoid 1991-Up.....	1.....	8661834
BANDS				
022.....	34325.....	Band, 400/425 Front (1" Wide) 1964-Up	1.....	8675578
022.....	34325A.....	Band, 400/4L80E Front (Hi-Energy) (1.25" Wide) 1964-Up	1.....	24210080
022.....	34325HD.....	Band, 400/425 Front (Kevlar) (1" Wide) 1964-Up.....	1.....	TBA
022.....	R34325A.....	Band, 400/4L80E Front (Kevlar) (1.25" Wide) 1964-Up	1.....	TBA
024.....	34510.....	Band, 400/4L80E Rear/Reverse (New Design, Smooth Lining) 1964-Up	1.....	8677313
024.....	34510HD.....	Band, 400/425/4L80E Rear (Reverse) (Kevlar Lining) 1964-Up	1.....	24202229
BUSHINGS				
030.....	K34903.....	Bushing Kit, 400 1964-Up.....	1.....	TBA
030.....	K34903E.....	Bushing Kit, 4L80E (W/Center Support Bushing # 34044) 1991-E97	1.....	TBA
030.....	K34903F.....	Bushing Kit, 4L80E (W/Center Support Bushing # 34044C) L1997-Up	1.....	TBA
034.....	8005.....	Bushing, 400 Pump (Babbit) 1964-Up.....	1.....	8623940
034.....	8005A.....	Bushing, 400 Pump (Bronze) 1964-Up.....	1.....	TBA
034.....	8005T.....	Bushing, 400 Pump Body 1964-Up Teflon-lined Kryptonite™ Sonnax.....	1.....	34034T-01
034.....	8005E.....	Bushing, 4L80E Pump (OE Style) (Narrow .575") 1991-Up	1.....	8682195
034.....	8005F.....	Bushing, 4L80E Pump (Babbit) (Wide .700") 1997-Up.....	1.....	24205783
034.....	8005FB.....	Bushing, 4L80E Pump (Bronze) (Wide .700") 1997-Up	1.....	24205783
036.....	34016.....	Bushing, 4L80E Stator Support (Front) 1991-Up	1.....	8683008
036.....	34016W.....	Bushing, 4L80E Stator Supp (Front)(Wider)(Corrects No OD (Bag Of 4ea) 1991-Up	1.....	Sonnax
037.....	34002.....	Bsh, 400 Stator Supp(Frt & Rear), 400/4L80E Sun Gr Shaft, 4L80E O-Run Drum Rear, Small.....	3-5.....	8623944
037.....	34017.....	Bushing, 4L80E Stator Support (Rear) 1991-Up	1.....	8681614
038.....	34002E.....	Bushing, 4L80E Overrun Drum (Front) 2.001" OD 1991-Up	1.....	8661604
040.....	34002.....	Bushing, 400/4L80E Overrun Drum (Rear) 1964-Up	1.....	8623944
044.....	34003.....	Bushing, 400 Center Support 1964-Up	1.....	8623942
044.....	34003E.....	Bushing, 4L80E Center Support 1991-96.....	1.....	8655622
044.....	34003F.....	Bushing, 4L80E Center Support (4.02" Long) w/3 Holes 1997-Up.....	1.....	24203510
048.....	34013.....	Bushing, 4L80E Forward Drum 1991-Up	1.....	8661284

400, 3L80, 4L80E, 4L85E

ILL#	Part#		QTY	REF#
053.....	34008	Bushing, 400/4L80E Front Planet (rear drum) 1964-Up.....	1.....	8623192
054.....	34002	Bushing, 400/4L80E Sun Gear Shaft (No Groove) 1964-Up.....	2.....	8623944
054.....	34002A	Bushing, 4L80E Sun Gear Shaft (With 4 ID Grooves) 1997-Up.....	2.....	27207201
062.....	34004	Bushing, 400 Output Shaft (Wide) 1964-74.....	1.....	8623943
062.....	34004A	Bushing, 400/4L80E Output Shaft (Narrow) 1970-Up.....	1.....	8653985
064.....	34006	Bushing, 400 Case 1964-Up.....	1.....	8623941
064.....	34006E	Bushing, 4L80E Rear Case (OE Style) 1991-Up.....	1.....	8677221
064.....	34006-SP	Bushing, 400/4L80E Case (No Walk Out) 1964-Up (Sonnax).....	1.....	34006-SP
064.....	30104A	Bushing, 400 Governor Bore 1964-Up (Use With T-0107).....	1.....	TBA
066.....	34005A	Bushing, 400 Extension Housing (1.995" OD) 1 1/2" long 1964-Up.....	1.....	8623966
066.....	8008	Bushing, 400 Extension Housing (1.626" OD)(Babbitt)(375 Only) 72-76.....	1.....	6260048
066.....	4008	Bushing, 400 Extension Housing (1.795" OD) 1 1/4" long 1964-Up.....	1.....	8619943
066.....	34005B	Bushing, 400 Extension Housing (1.995" OD) 1" long 1964-Up.....	1-2.....	8626901
066.....	34005E	Bushing, 4L80E Extension Housing (1.000" Long) 1991-03.....	1.....	8661368
066.....	34005F	Bushing, 4L80E Extension Housing (1.100" Long) 2004-Up.....	1.....	TBA
066.....	34908	Bearing, HD 400/4L80E Extension Housing (Brake Drum Type) 1964-Up.....	1.....	8670754
METAL CLAD SEALS				
070.....	35151	Seal, 400/425 Front 1964-Up.....	1.....	8641826
070.....	34151	Seal, 4L80E Front 1991-Up.....	1.....	8661602
072.....	38511	Seal, 400/4L80E Linkage Shaft 1964-Up.....	1.....	8623056
073.....	34551	Seal, 4L80E Case (Rear Lube) 1991-Up.....	1.....	8675517
074.....	34743A	Seal, 400/4L80E Rear (2.705" OD) 1.829" ID (Large, Truck Type) (Without Boot) 1964-Up.....	1.....	8626009
074.....	34743C	Seal, 400 Rear 1 11/16" ID (Medium, Car Type) 1964-Up.....	1.....	8625892
074.....	8850B	Seal, 400 Rear (Small, 375 Type) 1964-Up.....	1.....	3871649
074.....	8850A	Seal, 400 Rear (Small, 375 Type)(With Flange) With Short Boot 1964-Up.....	1.....	1251450
074.....	34743B	Seal, 475 Rear 2.887" OD(2.100" ID) 1984-Up (Can Use 34743B).....	1.....	8655032
074.....	34743B	Seal, 4L80E Rear 2.887" OD(2.100" ID)(W / Brake Assembly) 1991-Up.....	1.....	8675731
074.....	34743E	Seal, 4L80E Rear W/Boot 1991-Up.....	1.....	8677463
078.....	3991A	Seal, 400 Speed-O Shaft (W/Spring) 1964-Up.....	1.....	25519078
078.....	3991	Seal, 400 Speed-O Shaft (W/Out Spring) 1964-Up.....	1.....	1240382
079.....	34153	Seal, 4L80E Cooler Line Fitting to Center Support 1997-Up.....	1.....	24203511
FRICTIONS				
100.....	34103	Friction, 4L80E 4th Clutch (.080") 1991-Up.....	4.....	8682802
104.....	34404	Friction, 400/425 Intermediate Clutch .080" (Waved) 1964-Up.....	4.....	TBA
104.....	34404HD	Friction, 400/425 Intermediate Clutch .080" (Waffle) 1964-Up.....	4.....	8655620
104.....	34404HP	Friction, 400/4L80E Intermediate Clutch (.080")(Hi-Perf-Red) 1964-95.....	4.....	TBA
104.....	BP34404	Friction, 400/425 Intermediate Clutch .080" (Ray Blur Plate) 1964-Up.....	4.....	R577430
104.....	34404C	Friction, 4L80E Intermediate Clutch .080" (Flat) 1991-Up.....	4.....	8675521
104.....	34404E	Friction, 4L80E Intermediate Clutch .071" (High Energy) 1996-Up.....	4-5.....	24202966
104.....	K34404EHP	Friction & Steel Kit, 4L80E Intermediate Clutch .080" (Flat)(W/Snap Ring) 1991-Up (Alto).....	1.....	031757AHP
106.....	34304	Friction, 400/425/4L80E Forward & Direct Clutch .080" (Smooth) 1964-Up.....	10-11.....	8655619
106.....	34304B	Friction, 400 Forward & Direct Clutch .080" (Waffle)(Graphitic) 1964-Up.....	10-11.....	8625300
106.....	34304F	Friction, 400/4L80E Forward & Direct Clutch (High-Energy, Smooth) 1964-Up.....	10-11.....	24202646
106.....	34304HD	Friction, 400/4L80E Forward & Direct Clutch .080" (Hi-Perf-Red) 1964-Up.....	10-11.....	TBA
106.....	BP34304	Friction, 400/4L80E Forward & Direct Clutch .080" (Ray Blue Plate) 1964-Up.....	10-11.....	R577420
106.....	34304XHD	Friction, 400/4L80E Forward & Direct Clutch Thin .061" (Stage-1) 1964-Up.....	AR.....	R600085
106.....	34304GPZ	Friction, 4L80E Forward & Direct Clu ((Ray GPZ-Resists Hi-Temp & Hi-Cycles) 1996-Up.....	10-11.....	GPZ110
106.....	K34304AHD	Friction/Steel Kit, 400 Forward Clutch (Hi-Perf.) (Red W/Pressure Plate) (Alto) 1964-Up.....	1.....	TBA
106.....	K34304HD	Friction/Steel Kit, 400/4L80E Direct Clutch (Hi-Perf.) (Red W/Pressure Plate) (Alto) 1964-Up.....	1.....	TBA
116.....	34102	Friction, 4L80E Overrun Clutch .080" 1991-Up.....	3.....	8661571
116.....	34102HD	Friction, 4L80E Overrun Clutch (.080") (Hi-Perf.) 1991-Up (Not Blue).....	3.....	TBA
119.....	K34AF	Friction Module, 400 1964-Up.....	1.....	TBA
119.....	K34FF	Friction Module, 425 1966-78.....	1.....	TBA
119.....	K34FHD	Friction Module, 400 (Hi-Perf Red) 1964-Up.....	1.....	TBA
119.....	K34-1	Friction Module, 400 (Stage 1) 1964-Up.....	1.....	RCPS-03
119.....	K34FBP	Friction Module, 400 (Raybestos Blue Plates) 1964-Up.....	1.....	RCPBP-03
119.....	K34EF	Friction Module, 4L80E 1991-95.....	1.....	TBA
119.....	K34GF	Friction Module, 4L80E 1996-Up.....	1.....	TBA
119.....	K34E-1	Friction Module, 4L80E (Stage 1) 1991-95.....	1.....	RCPS-31
119.....	K34G-1	Friction Module, 4L80E (Stage 1) 1996-Up.....	1.....	RCPS-36
119.....	K34GGPZF	Friction Module, 4L80E (W/ GPZ Fwd & Direct) 1996-Up.....	1.....	RGPZ-010
119.....	K34EFBP	Friction Module, 4L80E (Raybestos Blue Plate) 1991-95.....	1.....	RCPBP-31
119.....	K34GFBP	Friction Module, 4L80E (Raybestos Blue Plate) 1996-Up.....	1.....	RCPBP-36
STEELS				
120.....	34104	Steel, 4L80E 4th Clutch .099" 1991-96.....	4.....	8661579

400, 3L80, 4L80E, 4L85E

ILL#	Part#		QTY	REF#
120.....	34104A.....	Steel, 4L80E 4th Clutch (w/4 Turbulator Holes) 1997-Up.....	4.....	24204283
124.....	34405.....	Steel, 400/425 Intermediate Clutch .100" (Flat) 1964-Up.....	3.....	8655621
124.....	34405E.....	Steel, 4L80E Intermediate Clutch .076" 1991-Up.....	4.....	8675522
124.....	34405EK.....	Steel, 4L80E Intermediate Clutch .076" (Kolene) 1991-Up.....	4.....	TBA
125.....	34420.....	Steel, 400/4L80E Intermediate Clutch .070" (Waved) 1964-Up.....	1.....	8624199
125.....	34420.....	Steel, 400/425/4L80E Intermediate Clutch .070" (Waved) 1964-Up.....	1.....	8624199
125.....	34420A.....	Steel, 4L80E Intermediate Clutch .076" (Waved) 1996-Up.....	1.....	24204497
126.....	34305C.....	Steel, 400/425/4L80E Direct Clutch .090" 1964-Up.....	4.....	8625197
126.....	34305XHD.....	Steel, 400/425/4L80E Forward & Direct Clutch .060" (Commercial) 1964-Up.....	AR.....	TBA
126.....	34305XHP.....	Steel Kit, 400/4L80E Forward & Direct (.060") Kolene (6 Per Kit) 1964-95.....	1.....	TBA
126.....	34305CK.....	Steel, 400/425/4L80E Forward & Direct Clutch .090" (Kolene) 1964-Up.....	8.....	TBA
127.....	34305B.....	Steel, 400 Forward & Direct Clutch .060" (Waved) 1967-Up.....	1.....	8679940
127.....	34305.....	Steel, 400 Forward & Direct Clutch .068" (Waved) 1964-66.....	1.....	8623113
127.....	34305D.....	Steel, 400/4L80E Forward & Direct Clutch .054" (Dished) 1964-98.....	1.....	8680816
127.....	34305E.....	Steel, 4L80E Forward & Direct Clutch (.042")(12 Teeth)(8 Waves) 1997-Up.....	1.....	24205559
127.....	34305F.....	Steel, 4L80E Forward & Direct Clutch (.042")(6 Teeth)(7 Waves) 1997-Up.....	1.....	24205560
127.....	34305G.....	Steel, 4L80E Forward & Direct Clutch (.042")(14 Teeth)(6 Waves) 1997-Up.....	1.....	24205561
128.....	34305A.....	Steel, 400/425/4L80E Forward Clutch .077" (Flat) 1964-Up.....	5.....	8623849
128.....	34305AK.....	Steel, 400/425/4L80E Forward Clutch .077" (Flat)(Kolene) 1964-Up.....	5.....	TBA
128.....	34305AA.....	Steel, 400/4L80E Forward Clutch (Turbulator) (.068") 1964-Up.....	5.....	TBA
136.....	34101.....	Steel, 4L80E Overrun Clutch .099" 1991-96.....	3.....	8661569
136.....	34101A.....	Steel, 4L80E Overrun Clutch (w/ 7 Turbulator Holes) 1997-Up.....	3.....	24204287
139.....	K34S.....	Steel Module, 400 1964-Up.....	1.....	TBA
139.....	K34FS.....	Steel Module, 425 1966-78.....	1.....	TBA
139.....	K34ES.....	Steel Module, 4L80E 1991-96.....	1.....	TBA
139.....	K34GS.....	Steel Module, 4L80E 1997-Up.....	1.....	TBA
PRESSURE PLATES				
140.....	34482.....	Pressure Plate, 4L80E 4th Clutch (8 lugs) 1991-98.....	1.....	8661582
140.....	34482A.....	Pressure Plate, 4L80E 4th Clutch (2 lugs) 1999-Up.....	1.....	24205818
144.....	34422.....	Backing Plate, 400/425 Intermediate Clutch (.431") 1964-Up.....	1.....	8623152
144.....	34422E.....	Backing Plate, 4L80E Intermediate Clutch (.366") W/ Lip, 1991-95.....	1.....	8675519
144.....	34422F.....	Backing Plate, 4L80E Intermediate Clutch (.275") No Lip, 1996-Up.....	1.....	24205827
146.....	34421.....	Pressure Plate, 400/4L80E Direct Clutch 1964-Up.....	1.....	8661575
146.....	34421E.....	Pressure Plate, 4L80E Direct Clutch 1991-Up (Can Use 34146).....	1.....	8675557
156.....	34473.....	Pressure Plate, 4L80E Overrun Clutch 1991-Up.....	1.....	8661573
MODULATORS				
160.....	35820R.....	Modulator, 400 Single Red Stripe 1964-Up.....	1.....	3035519
160.....	35820Y.....	Modulator, 400 Black/Red Stripe 1964-Up.....	1.....	3035518
160.....	35820P.....	Modulator, 400 Dual Red Stripe 1964-Up.....	1.....	TBA
160.....	84820X.....	Modulator, 400 Dual Red Stripe (Universal 400 & 440/4T60 Combo) 1964-Up.....	1.....	8646956
160.....	84820A.....	Modulator, 400 Black/Red Stripe, Diesel, 1964-Up.....	1.....	TBA
160.....	36820A.....	Modulator, 400 Large Can 1964-Up.....	1.....	TBA
160.....	7-40M.....	Modulator, 400 Mechanical (Teckpak).....	1.....	40M
162.....	13266.....	Hose, 400 Modulator Elbow, 1964-Up.....	1.....	TBA
163.....	34621.....	Valve, 400 Under Modulator 1964-Up.....	1.....	TBA
VALVE BODY KITS				
165.....	K34908S.....	Valve Body Kit, 400 1964-Up (Superior).....	1.....	K-400
165.....	K34908.....	Valve Body Kit, 400 1964-Up (Transgo).....	1.....	SK400
165.....	K34908TL.....	Valve Body Kit, 400 1964-Up (Fixes 5 Transmissions).....	1.....	Translab
165.....	K34908R.....	Valve Body Kit, 400 (Reverse Cushion Kit) 1964-Up (Transgo).....	1.....	400RK
165.....	K34908SP.....	Valve Body Kit, 400 (W/Plate) 1964-Up (Superior).....	1.....	K400-SP
165.....	K34908ES.....	Valve Body Kit, 4L80E 1991-Up (Superior).....	1.....	K4L80E
165.....	K34908E.....	Valve Body Kit, 4L80E 1991-Up (Transgo).....	1.....	SK4L80E
165.....	K34877.....	Ring Kit, 4L80E Ring & End Play Kit 1991-Up (Transgo).....	1.....	4L80E-HTRK
165.....	K34908A.....	Valve Body Kit, 425 1966-78 (Transgo).....	1.....	SK425
169.....	F400-2.....	Valve Body Kit, 400 (Posi-Shift 2 Stage Pac) 1964-Up (Fairbanks).....	1.....	20806-2
169.....	400-1&2.....	Reprogramming Kit, 400 (Heavy Duty & Competition) 1964-Up (Transgo).....	1.....	400-1&2
169.....	4L80E-HD2.....	Reprogramming Kit, 4L80E (Heavy Duty & Competition) 1991-Up (Transgo).....	1.....	4L80E-HD2
171.....	F400-3.....	Valve Body Kit, 400 (Transaction III & IV Stage Kit) 1965-Up (Fairbanks).....	1.....	20812
171.....	400-PRO.....	Reprogramming Kit, 400 (Pro Race/Heavy Duty/Super Show Off) (Transgo) 1965-Up.....	1.....	400-PRO
173.....	400-3.....	Reprogramming Kit, 400 (Competition Stick Shift) 1964-Up (Transgo).....	1.....	400-3
173.....	4L80E-3.....	Reprogramming Kit, 4L80E (Competition Stick Shift-Full Manual Control) 1991-Up.....	1.....	4L80E-3
SEALING RINGS				
175.....	K34901.....	Ring Kit, 400, 8-Ring (Metal) 1964.....	1.....	TBA

400, 3L80, 4L80E, 4L85E

ILL#	Part#		QTY	REF#
175.....	K34901M.....	Ring Kit, 400/425 Short 6-Ring (Metal) 1965-Up.....	1.....	TBA
175.....	K34901C.....	Ring Kit, 400/425 Full 11-Ring (Metal) 1965-Up.....	1.....	TBA
175.....	K34901T.....	Ring Kit, 400/425 Full 11-Ring (Teflon) 1965-Up.....	1.....	TBA
175.....	K34901E.....	Ring Kit, 4L80E 13-Ring (Teflon) (Solid Pump & Center Supp Rings) 1991-96.....	1.....	TBA
175.....	K34901F.....	Ring Kit, 4L80E 11-Ring (Peek Scarf Cut Pump & Center Supp Rings) 1997-Up.....	1.....	TBA
177.....	34715T.....	Ring, 4L80E Turbine Shaft to Stator Support (Metal) 1991-Up.....	2.....	8637170
178.....	34120.....	Ring, 400 Turbine Shaft (W/Variable Pitch)(Metal) 1964-78.....	1.....	8623296
178.....	34716T.....	Ring, 4L80E Turbine Shaft to Forward Drum (Metal) 1991-Up.....	2.....	8661893
181.....	34406.....	Ring, 400/425 Front Stator & Center Support (Metal) 1964-98.....	6.....	8623148
181.....	34406T.....	Ring, 400/425 Front Stator & Center Support (Teflon) 1964-Up.....	6.....	8626356
181.....	34714T.....	Ring, 4L80E Stator (Teflon) 1991-Up.....	2.....	8661789
181.....	34714A.....	Ring, 4L80E Stator (Peek Material, Retro-Fit to 1991) 1998-Up.....	2.....	24205833
181.....	34713T.....	Ring, 4L80E Center Support (Teflon) 1991-97.....	4.....	8675729
181.....	34713A.....	Ring, 4L80E Center Support (Peek Material, Retro-Fit to 1991) 1998-Up.....	4.....	24205722
181.....	K34713A.....	Ring Kit, 4L80E Center Support (4 Rings Per Kit)(Teflon) 1991-Up.....	1.....	TBA
192.....	34711.....	Ring, 400/425 Front Accumulator Piston (Outer)(Metal) 1964-Up.....	1.....	8623653
192.....	34711T.....	Ring, 400/425 Front Accum Piston (Outer Teflon) 1964-Up.....	1.....	TBA
195.....	34310.....	Ring, 400 Front Servo Piston (Metal) 1964-Up.....	1.....	8626423
195.....	34711T.....	Ring, 400 Front Servo Piston (Teflon) 1964-Up.....	1.....	8626423
195.....	34711.....	Ring, 4L80E Front Servo Piston (Metal) 1991-Up.....	1.....	8623131
195.....	34310T.....	Ring, 400 Front Servo Piston (Teflon) 1964-Up.....	1.....	8626423
195.....	34711T.....	Ring, 4L80E Front Servo Piston (Teflon) 1991-Up.....	1.....	8623131
198.....	34710A.....	Ring, 400 Rear Accumulator (Inner)(Metal) 1964-Up.....	1.....	8623671
198.....	34710T.....	Ring, 400/4L80E Rear Accumulator (Inner)(Teflon) 1964-Up.....	1.....	8623671
353.....	34567.....	Lathe Cut Seal, 400/4L80E Rear Accumulator (Inner)(Rubber) 1991-Up.....	1.....	8661647
199.....	34710B.....	Ring, 400 Rear Accumulator (Outer)(Metal) 1964-70.....	1.....	8623672
199.....	34712R.....	Ring, 400/4L80E Rear Accumulator (Outer)(Metal) 1971-Up.....	1.....	8627153
199.....	34712T.....	Ring, 400/4L80E Rear Accumulator (Outer)(Teflon) 1971-Up.....	1.....	8627153
354.....	34658.....	Lathe Cut Seal, 400/4L80E Rear Accumulator (Outer)(Rubber) 1991-Up.....	1.....	TBA
WASHERS & BEARINGS				
200.....	K34907.....	Washer Kit, 400 1964-Up.....	1.....	TBA
200.....	K34907E.....	Washer Kit, 4L80E W/Out Selectives 1991-Up.....	1.....	TBA
200.....	K34907F.....	Washer Kit, 4L80E Selectives Only 1991-Up.....	1.....	TBA
200.....	K34907A.....	Bearing Kit, 400, 3 Bearings (ILL #242, 249, 256) 1964-Up.....	1.....	SBK-G10
200.....	K34907B.....	Bearing Kit, 4L80E, 5-Bearings, 1991-Up.....	1.....	SBK-G20
211.....	34208.....	Washer, 400 Stator .062" 1964-Up (yellow).....	1.....	8623300
211.....	34208A.....	Washer, 400 Stator .073" 1964-Up (blue).....	1.....	8623301
211.....	34208B.....	Washer, 400 Stator .084" 1964-Up (red).....	1.....	8623302
211.....	34208C.....	Washer, 400 Stator .095" 1964-Up (brown).....	1.....	8623303
211.....	34208D.....	Washer, 400 Stator .106" 1964-Up (green).....	1.....	8623304
211.....	34208E.....	Washer, 400 Stator .117" 1964-Up (black).....	1.....	8623305
211.....	34208F.....	Washer, 400 Stator .128" 1964-Up (purple).....	1.....	8623306
211.....	34602.....	Washer, 4L80E Pump .059" (Blue) 1991-Up.....	1.....	8677571
211.....	34602A.....	Washer, 4L80E Pump .075" (Red) 1991-Up.....	1.....	8677572
211.....	34602B.....	Washer, 4L80E Pump .091" (Brown) 1991-Up.....	1.....	8677573
211.....	34602C.....	Washer, 4L80E Pump .107" (Green) 1991-Up.....	1.....	8677574
211.....	34602D.....	Washer, 4L80E Pump .123" (Black) 1991-Up.....	1.....	8677575
211.....	K34907F.....	Washer Kit, 4L80E Stator (5 Selectives) 1991-Up.....	1.....	TBA
214.....	34214E.....	Bearing W/Race, 4L80E Overrun Drum to Overdrive Planet (Stays in Planet) 1991-Up.....	1.....	TBA
217.....	65405.....	Bearing W/Race, 4L80E Overdrive Planet to Forward Drum 1991-Up.....	1.....	8628202
226.....	34401.....	Washer, 400/4L80E Center Support to Front Planet (Metal) 1964-Up.....	1.....	8624783
226.....	34401A.....	Washer, 400/4L80E Center Support to Front Planet (Plastic) 1964-Up.....	1.....	TBA
232.....	34339.....	Washer, 400/4L80E Fwd Drum to Forward Clutch Hub 1964-Up.....	1.....	8624196
235.....	34301.....	Washer, 400/4L80E Forward Hub to Direct Drum (Metal) 1964-Up.....	1.....	8624781
235.....	34301P.....	Washer, 400/4L80E Forward Hub to Direct Drum (Plastic) 1964-Up.....	1.....	TBA
235.....	34301-078.....	Washer, 400/4L80E Fwd Drum to Fwd Hub, Oversize (.078" Washers 5 Per Bag).....	1.....	Sonnax
235.....	34301-094.....	Washer, 400/4L80E Fwd Drum to Fwd Hub, Oversize (.094" Washers 5 Per Bag).....	1.....	Sonnax
238.....	34501A.....	Washer, 400/4L80E Front Planet to Rear Planet 4 Tab (Metal) 1964-98.....	1.....	8626372
238.....	65407A.....	Washer, 400/4L80E Front Planet to Rear Planet 4 Tab (Plastic) 1964-98.....	1.....	TBA
238.....	34501B.....	Washer, 4L80E Front Planet to Rear Planet 2 Tab (Plastic) 1999-Up.....	1.....	TBA
242.....	K34500.....	Brg W/Race, 400/4L80E Center Supp to Sun Gear (3 Piece) 1964-Up.....	1.....	8623920
249.....	K34500C.....	Brg W/Races, 400/4L80E Sun Gr to Rear Ring Gr (4 Notches on ID) 1997-Up (Retros 64-Up).....	1.....	24208848
249.....	K34500A.....	Bearing W/Races, 400/4L80E Sun Gear to Rear Ring Gear (3 Piece) 1964-96.....	1.....	8623921
249.....	34512.....	Shim, 4L80E Rear Internal Gear Bearing Between # 252 & # 594 (.040") 1999-Up.....	1.....	24211821
252.....	34500-Z.....	Shim Kit, 400/4L80E (Under # 252 to Reduce End Play)(10 Per Kit) 1964-Up (Sonnax).....	1.....	34500-Z
256.....	K34500B.....	Bearing W/Race, 400/4L80E Rear Ring Gear to Output Shaft (3 Piece) 1964-Up.....	1.....	8623922
268.....	34501A.....	Wsh, 400/4L80E Output Shaft to Case 4 Tab (Metal) 1964-Up (Also Frt Planet To Rear Planet).....	1-2.....	8626372



400, 3L80, 4L80E, 4L85E

ILL#	Part#		QTY	REF#
269.....	34601.....	Washer, 400/4L80E Output Shaft to Case 3 Tab (.074"-.078") 1964-Up.....	1.....	8625401
269.....	34601A.....	Washer, 400/4L80E Output Shaft to Case 3 Tab (.082"-.086") 1964-Up.....	1.....	8625402
269.....	34601B.....	Washer, 400/4L80E Output Shaft to Case 3 Tab (.090"-.094") 1964-Up.....	1.....	8625403
269.....	34601C.....	Washer, 400/4L80E Output Shaft to Case 3 Tab (.098"-.102") 1964-Up.....	1.....	8625404
269.....	34601D.....	Washer, 400/4L80E Output Shaft to Case 3 Tab (.106"-.110") 1964-Up.....	1.....	8625405
269.....	34601E.....	Washer, 400/4L80E Output Shaft to Case 3 Tab (.114"-.118") 1964-Up.....	1.....	8625406
066.....	34908.....	Bearing, 400/4L80E Extension Housing (Brake Drum Type) 1964-Up.....	1.....	8670754
287.....	34083.....	Washer, 400 Under Bolt That Holds Output Shaft Yoke on.....	1.....	TBA

GASKETS & RUBBER COMPONENTS

300.....	3893.....	Gasket, 400 Pan 1964-Up.....	1.....	8655625
300.....	3893G.....	Gasket, 4L80E Pan (Except Jaguar) 1991-Up.....	1.....	8677743
300.....	3893J.....	Gasket, 4L80E Pan (Jaguar) 1991-Up.....	1.....	TBA
300.....	3893E.....	Gasket, 4L80E Pan (Bonded Gasket)(Except Jaguar) 1991-Up.....	1.....	TBA
300.....	13270.....	Gasket, 425 Bottom Pan 1966-78.....	1.....	8626932
301.....	13269.....	Gasket, 425 Sprocket Cover 1966-78.....	1.....	8625031
305.....	13271.....	Gasket, 400 Extension Housing 1964-Up.....	1.....	8624709
305.....	13303.....	Gasket, 425 Final Drive to Case 1966-78.....	1.....	389948
317.....	100123.....	Gasket, 400 Adapter To 205 Transfer Case 8-Bolt 1969-86.....	1.....	TBA
317.....	100127.....	Gasket, 400 Adapter To 208/241 Transfer Case 6-Bolt 1987-Up.....	1.....	TBA
317.....	100130.....	Gasket, 400 Adapter To 231 Transfer Case 5-Bolt 1988-Up.....	1.....	TBA
306.....	3914F.....	Gasket, 400 Governor Cover 1964-Up.....	1.....	8623263
307.....	3916.....	Gasket, 400 Rear Servo Cover 1964-Up.....	1.....	8623174
307.....	3916E.....	Gasket, 4L80E Rear Servo Cover 1991-Up.....	1.....	8675728
308.....	3993E.....	Gasket, 4L80E Accumulator Housing 1991-Up.....	1.....	8681829
309.....	13268A.....	Gasket, 400 Pump Bolt Washer 1964-Up.....	6-8.....	8626281
310.....	3994.....	Gasket, 400 Pump 1964-Up.....	1.....	8623978
310.....	3994E.....	Gasket, 4L80E Pump Cover to Case 1991-Up.....	1.....	8677782
310.....	13274.....	Gasket, 425 Pump 1966-78.....	1.....	8625018
311.....	3877.....	O-Ring, 400 Pump 1964-Up.....	1.....	8626309
311.....	3877V.....	O-Ring, 400 Pump Body (Viton) 1964-Up.....	1.....	8654716
311.....	3877V.....	O-Ring, 4L80E Pump Body 1991-Up.....	1.....	8654716
311.....	13273.....	O-Ring, 425 Pump 1966-78.....	1.....	8625007
312.....	13268C.....	O-Ring, 400 Pump Bolt 1985-Up.....	1.....	TBA
312.....	13268E.....	O-Ring, 4L80E Pump Bolt 1991-Up.....	1.....	8655281
320.....	3993.....	Gasket, 400 Case to Spacer Plate (6 Check Ball Type) yellow stripe 1965-E87.....	1.....	8623563
320.....	3993A.....	Gasket, 400 Case to Spacer Plate (7 Check Ball Type) no stripe L1987-Up.....	1.....	8670458
320.....	34205.....	Gasket, 4L80E Case to Spacer Plate 1991-96 (will work for 97-Up units) Gasket, VB-Upper.....	1.....	8684205
320.....	34205A.....	Gasket, 4L80E Case to Spacer Plate 1997-Up Gasket, Valve Body - Upper.....	1.....	24204253
320.....	13275.....	Gasket, 425 Case to Spacer Plate 1966-78.....	1.....	8625203
321.....	3992.....	Gasket, 400 Valve Body to Spacer Plate (6 Check Ball Type) 1965-E87.....	1.....	8623174
321.....	3992A.....	Gasket, 400 Valve Body to Spacer Plate (7 Check Ball Type) L1987-Up (Will Retro to 1965).....	1.....	8670447
321.....	34733.....	Gasket, 4L80E Valve Body to Spacer Plate - Lower 1991-96 (will work for 97-Up units).....	1.....	2420115
321.....	34733B.....	Gasket, 4L80E Valve Body to Spacer Plate - Lower 1997-Up.....	1.....	24204268
328.....	3913.....	Gasket, 400 Valve Body Detent Solenoid 1964-Up.....	1.....	8623741
328.....	3913A.....	Gasket, 425 Solenoid to Case 1966-78.....	1.....	8625086
332.....	3963.....	Lip Seal, 400 Intermediate Clutch (Inner) 1964-Up.....	1.....	8627627
332.....	34504.....	Lip Seal, 4L80E Intermediate Clutch (Inner) 191-Up.....	1.....	8675636
333.....	3962.....	Lip Seal, 400 Intermediate Clutch (Outer) 1964-Up.....	1.....	8623143
333.....	34505.....	Lip Seal, 4L80E Intermediate Clutch (Outer) 1991-Up.....	1.....	8675637
334.....	3284.....	Lip Seal, 400 Forward & Direct Clutch (Center) 1964-Up.....	1.....	8623121
334.....	13322.....	Lip Seal, 400/4L80E Forward Clutch (Center, Bevel Cut) 1964-Up.....	1.....	8627690
334.....	34501.....	Lip Seal, 4L80E Forward Clutch (Center) 1991-Up.....	1.....	8675526
334.....	34503.....	Lip Seal, 4L80E Direct Clutch (Center) 1991-Up.....	1.....	8677584
334.....	34818B.....	Bonded Lip Seal & Sleeve, 4L80E Fwd Cl. .086" Orifice, 1997-Up (Retros To 1991) In Kits.....	1.....	24204958
334.....	34818A.....	Bonded Lip Seal & Sleeve, 4L80E Fwd Cl. .070" Orifice, 1997-Up (Retros To 1991).....	1.....	24204959
334.....	34818C.....	Bonded Lip Seal & Sleeve, 4L80E Fwd Cl. .050" Orifice, 1997-Up (Retros To 1991).....	1.....	TBA
335.....	3643.....	Lip Seal, 400 Forward & Direct Clutch (Outer) 1964-Up.....	1.....	8623101
335.....	34502.....	Lip Seal, 4L80E Forward & Direct Clutch (Outer) 1991-Up.....	1.....	8677583
336.....	3956.....	Lip Seal, 400 Forward & Direct Clutch (Inner) 1964-Up.....	1.....	8623102
336.....	34500.....	Lip Seal, 4L80E Forward & Direct Clutch (Inner) 1991-Up.....	1.....	8677582
340.....	34561.....	Lip Seal, 4L80E 4th Clutch (Inner) 1991-Up.....	1.....	8661586
341.....	34566.....	Lip Seal, 4L80E 4th Clutch (Outer) 1991-Up.....	1.....	8681587
345.....	13304.....	O-Ring, 425 Governor Cover 1966-78.....	1.....	8625058
346.....	3410.....	O-Ring, 400 Modulator 1964-Up.....	1.....	10054241
347.....	3410.....	O-Ring, 400 Case Connector (Small) 1994.....	1.....	TBA
347.....	3410L.....	O-Ring, 400 Case Connector 1995-Up.....	1.....	TBA
347.....	34570.....	O-Ring, 4L80E Wire Harness Connector 1991-Up.....	1.....	TBA

400, 3L80, 4L80E, 4L85E

ILL#	Part#		QTY	REF#
348.....	34506	Lathe Cut Seal, 4L80E Extension Housing 1991-Up.....	1.....	8681168
349.....	3302	O-Ring, 400 Linkage Shaft 1964-67.....	1.....	8621767
351.....	34710E	D-Ring, 4L80E/4L85E 3rd & 4th Clutch Accumulator Piston (Large)(Viton) 1991-Up.....	2.....	8681647
352.....	34711E	D-Ring, 4L80E/4L85E 3rd Clutch Accumulator Piston (Small)(Viton) 1991-Up.....	1.....	8681639
353.....	34567	O-Ring, 400/4L80E Rear Accumulator (Inner) 1991-Up.....	1.....	8678294
354.....	34568	O-Ring, 400/4L80E Rear Accumulator (Outer) 1991-Up.....	1.....	TBA
363.....	3921	Lathe Cut Seal, 400/4L80E Rear Servo Piston 1964-Up.....	1.....	8623430
336.....	3410	O-Ring, 400 Modulator & Case Connector 1964-Up.....	2.....	10054241
368.....	3547	O-Ring, 400 Filter Pick-Up Tube 1964-Up.....	1.....	1363951
369.....	3126	O-Ring, 400 Speed-O Housing 1964-Up.....	1.....	1359319
370.....	12448	O-Ring, 4L80E Output Speed Sensor 1991-Up.....	1.....	TBA
371.....	3291	O-Ring, 400 Filler Tube 1964-78.....	1.....	6264902
371.....	3292	Boot, 400/4L80E Filler Tube 1979-Up.....	1.....	1259475
374.....	3267	O-Ring, 400/4L80E Output Shaft to Yoke 1964-Up.....	1.....	8616504
379.....	84548	Boot, 4L80E Filter Neck 1991-Up.....	1.....	8656613
379.....	3547B	Boot, 400 Filter Neck (Flat Filter Type) L1967-Up.....	1.....	TBA
380.....	34569	O-Ring, 4L80E Input Shaft 1991-Up.....	1.....	8661760
387.....	3205	O-Ring, 400 Parking Pawl Pin 1964-Up.....	1.....	8623040
390.....	K34900-2	External Seal Kit, 400 W/Pan Gasket 1964-Up.....	1.....	TBA
390.....	K34900E-2	External Seal Kit, 4L80E W/Pan Gasket 1991-Up.....	1.....	TBA
TECHNICAL MANUALS				
400.....	TM400	Tech Manual, 400 1964-91 (ATSG).....	1.....	400TM
400.....	TM4L80-E	Tech Manual, 4L80E 1991-Up (ATSG).....	1.....	4L80E
400.....	TM4L68CODE	Diagnostic Code Book, 4L80E / 4L85E 1991-Up.....	1.....	TBA
407.....	V4L80E	Tech Video, 4L80E (Includes Manual) 1991-Up.....	1.....	VV4L80E
ELECTRICAL COMPONENTS				
410.....	77947	Switch, 4L80E MPLS/PRNDL (4 & 7 Pin Connectors) (Black Plastic) 1995-03 (ACD# D2263C).....	1.....	24229422
410.....	77947A	Switch, 4L80E MPLS/PRNDL (11 Pin Single Connector) 2004-Up (ACD# D2257C).....	1.....	24221125
NI.....	K77971R	Repair Kit, GM Universal Park / Neut Switch Includes 7 & 4-Pin Harness, 1991-Up (Rostra).....	1.....	350-0077
NI.....	77973	Repair Kit, Park / Neut Switch Harness, For 11-Pin, 1-Conn Type, 2001-09 (Rostra).....	1.....	350-0096
414.....	34600	Switch, 400 Spark Control 1964-Up.....	1.....	8627332
418.....	34326E	Solenoid, 4L80E Lock-Up TCC, PWM 1991-Up.....	1.....	24210864
420.....	34326	Solenoid, 400 Valve Body Detent short wire 1964-Up.....	1.....	8629935
420.....	34326A	Solenoid, 425 Valve Body Detent 1966-Up.....	1.....	TBA
420.....	MS4L80ER	Sol Kit, 4L80E (1 TCC(or PWM), 2 Shift, Force Motor, Manifold Press & Int Harness 1991-Up.....	1.....	52-9018
420.....	MS-4L80E	Solenoid Master Kit, 4L80E 1 TCC (or PWM), 2 Shift & 1 Pressure Regulator 1991-Up.....	1.....	MS-4L80E
420.....	MS-4L80E-H	Sol Kit, 4L80E 1 TCC (or PWM), 2 Shift & Press Reg, Int Harn 1994-Up Teckpak.....	1.....	MS-4L80E-H
421.....	34825	Solenoid, 4L80E 1-2 Shift (Purple) "A" 1991-Up.....	1.....	8678638
422.....	34826	Solenoid, 4L80E 2-3 Shift (Tan) "B" 1991-Up.....	1.....	8678639
429.....	34955E	Throttle Position Sensor, 4L80E (TPS)(Diesel) 1991-Up.....	1.....	10137417
431.....	48-MOD	Vacuum Pressure Control System, 4L80E (Transgo) 1991-Up.....	1.....	48-MOD
434.....	34326	Solenoid, 400 Kickdown 1964-Up.....	1.....	1242101
435.....	34605U	Solenoid, 4L80E Pressure Control (Force Motor) Teckpak 1991-03.....	1.....	34605U
435.....	34605A	Solenoid, 4L80E Press Control (Force Motor) 1994-03 (Has 2 Flat Blades On End Of Sol).....	1.....	24220158
435.....	34605D	Solenoid, 4L80E Pressure Control (Force Motor) 2004-Up.....	1.....	24224905
435.....	4L6-SOL	Repair Kit, 4L80E EPC (Force Motor) 1993-Up (W/Tool Kit, Fixes 4).....	1.....	Transgo
435.....	4L6-SOL-4	Repair Kit Refills For 4L6-SOL, 4L80E (Force Motor Solenoid).....	1.....	Transgo
436.....	34960	Speed Sensor, TH400 Vehicle Speed (VSS) 1985-Up.....	1.....	8655291
436.....	34823	Speed Sensor, 4L80E Input & Output 1991-Up.....	1-2.....	24203876
436.....	100958G	Speed Sensor, 4L80/85E, Output, On Transfer Case (NP126 Or NP226) 1991-Up.....	1.....	12376520
436.....	34829	Repair Kit, 4L80E (Repairs The 2 Pin VSS Harness Only) 1991-Up.....	1.....	350-0056
437.....	34824	Sensor, 4L80E Temperature 1991-Up.....	1.....	8661818
442.....	34657	Switch, 4L80E Manifold Pressure Switch 1991-Up.....	1.....	8681413
444.....	34327	Connector, 400 Case 1 Prong 1964-65.....	1.....	2977975
444.....	34329	Connector, 400 Case 1 Prong 1968-Up.....	1.....	24205373
444.....	34327A	Connector, 400 Case 2 Prong (W/Variable Pitch) 1964-67.....	1.....	2984091
444.....	34329A	Connector, 400 Case 2 Prong (w/Insulator) 1970-82.....	1.....	8629502
445.....	34998	Wire Harness Kit, 4L80E External & Internal Harness W/Temp Sensor, 1991-03.....	1.....	350-9000
445.....	34986	Wire Harness, 4L80E External (Female) W/ Snap-Type Conn 1991-Up.....	1.....	350-0033
445.....	77994ER	Repair Kit / Test Harness, 4L80E External Harness (20 Pin) 1994-Up (Rostra).....	1.....	350-0083
446.....	34985	Wire Harness, 4L80E Internal (Male) W/Temp Sensor, 1991-03.....	1.....	350-0032
446.....	34985A	Wire Harness, 4L80E Internal (Male) W/Temp Sensor, 2004-Up.....	1.....	24224906
446.....	34985AR	Wire Harness, 4L80E Internal (Male) W/Temp Sensor, 2004-Up (Rostra).....	1.....	350-0071
446.....	34985J	Wire Harness, 4L80E Internal (Jaguar) 1991-Up.....	1.....	TBA
447.....	RECAL-UN	Recalibrator, 4L80E Electronic Speed-O-Meter.....	1.....	RECAL-GM
447.....	34790A	Interceptor, 4L80E (Electronic Modulator) 1994-Up.....	1.....	INT34B



400, 3L80, 4L80E, 4L85E

ILL#	Part#		QTY	REF#
MISCELLANEOUS COMPONENTS				
476.....	34930	Silencer Ring for Output Carrier, 400/4L80E (Black Plastic) 1964-Up	1	8626112
483.....	65168	Cup Plug, 400/4L80E Parking Pawl Pin 1964-Up	1	8620318
484.....	34507E	Lube Orifice Seal, 4L80E Extension Housing Rear Lube 1991-Up	1	9427692
484.....	34818B	Orifice, 4L80E Forward Clutch Sleeve .086" 1997-Up	1	27207501
487.....	30130	E-Clip, GM (3/16") 1964-Up	2	9431762
489.....	K35803U	Dust Cover, GM Universal (Teckpak) 1964-Up	1	K35803U
490.....	35910	Vent Tube, 400/4L80E Case 1964-Up	1	8633408
494.....	K34999	Filler Tube & Dip Stick, 400 Deep Pan	1	TBA
494.....	K35999U	Filler Tube & Dip Stick, GM Fitz All (Teckpak) 1964-Up	1	14046820
495.....	34893	Filler Pipe Intake, 400 Deep Pan (Plastic) L1967-Up	1	8629526
495.....	34893A	Filler Pipe Intake, 400 Shallow Pan (Plastic) L1967-Up	1	8626886
495.....	K35999R	Filler Tube Repair 1964-98	1	TBA
PUMPS & PUMP COMPONENTS				
500.....	34911	Pump, 400 Variable Pitch (Solenoid On Pump) 1964-67	1	TBA
500.....	34911B	Pump, 400 Fixed Pitch (Cast #068/649) 1964-67	1	TBA
500.....	34910	Pump, 400 Fixed Pitch (Cast #121/174, 121/176) 1968-70	1	TBA
500.....	34910A	Pump, 400 8-Bolt To Case (Body Cast # 895/000, 895/896) 1971-Up	1	TBA
500.....	34910BA	Pump, 400 6-Bolt To Case (Body Cast # 895/000, 895/896) 1973-Up	1	TBA
500.....	34200E	Pump, 4L80E (Body Cast # 778/779/702, Stator Cast # 779/263/184) 1991-96	1	TBA
500.....	34200F	Pump, 4L80E (Body Cast # 302/779, Stator Cast # 512/379) 1997-03	1	124200314
500.....	34200G	Pump, 4L80E 2004-Up (Case Has Only One Raised Front Cooler Line Boss)	1	TBA
500.....	34200R	Pump, 4L80E Bentley/Rolls Royce (Cast # 212 / #214) 1991-96	1	TBA
500.....	34200RA	Pump, 4L80E Bentley/Rolls Royce (Cast # ??) 1997-Up	1	TBA
PUMP COMPONENTS				
507.....	34994-14K	End Plug Set, 4L80E TCC Bore (5 Per Set) 1991-Up (Sonnax)	1	34994-11
507.....	34641E	Retainer, 4L80E (Metal)(Oil Deflector)(1 Pump Body Bolt Holds This on) 1997-Up	1	24200357
507.....	34200-PL	Pump Channel Plug, 4L80E, Converts 1997-03 Pump To 2004-Up Pump	1	24232339
507.....	34994-12	Retaining Pin Set, 4L80E Overdrive/Reverse Check Ball (10 Per Set) (Sonnax)	1	34994-12
507.....	34892	Spring, 400 Pressure Regulator Valve 1964-Up	1	8623090
507.....	34200-05K	Balance Plug Set, 4L80E Pressure Regulator End Plug (Without Rings) (5 Per Set)	1	34200-05K
507.....	8682998	Pressure Regulator Assembly, 4L80E 1991-Up	1	8682998
507.....	34209	Sleeve, 4L80E Reverse Boost Valve (.855" ID) (Valve not included) 1991-96	1	8676456
507.....	34200-09K	Sleeve, 4L80E Reverse Boost Valve (.830" ID) 1997-Up (Sonnax)	1	34200-2A
507.....	34200-03K	Boost Valve & Sleeve, 4L80E Reverse 1991-Up (OEM Type)	1	34200-03K
507.....	34200-01K	Reverse Boost Valve & Sleeve, 4L80E (W/ 2-O-Rings For Sleeve) 1991-Up Sonnax	1	34200-01K
507.....	34200-10K	Rev Boost Valve & Sleeve, 4L80E (W/O-Rings)(Self Regul Boost Valve Kit W/Relief Valve)	1	34200-10K
507.....	34910-S-25	Ring Set, 400 Pressure Regulator Valve (Teflon) (25 Per Pack) (Fits 34910-03K)	1	34910-S-25
507.....	34910-03K	Pressure Regulator Assembly, 400 1964-Up	1	34910-03K
507.....	34910-01K	Boost Valve & Sleeve, 400 Reverse 1964-Up	1	34910-01K
510.....	34910B	Pump Body, 400 (Variable Pitch) 1964-67	1	TBA
510.....	34910BB	Pump Body, 400 (Fixed Pitch) (Cast #068) 1964-67	1	TBA
510.....	34919	Pump Body, 425 1966-78	1	8625330
510.....	34910BC	Pump Body, 400 (Cast # 121) 1968-70	1	TBA
510.....	34910BD	Pump Body, 400 8-Bolt To Case (Cast # 895) 1971-Up	1	TBA
510.....	34910BE	Pump Body, 400 6-Bolt To Case (Cast # 895) 1973-Up	1	TBA
510.....	34202	Pump Body, 4L80E (Narrow Bushing .550" Type) 1991-96	1	24211287
510.....	34202A	Pump Body, 4L80E (Wide Bushing .700" Type) 1997-Up	1	TBA
510.....	34202R	Pump Body, 4L80E Bentley/Rolls Royce (Cast # 212) 1991-96	1	TBA
510.....	34202RA	Pump Body, 4L80E Bentley/Rolls Royce (Cast # ??) 1997-Up	1	TBA
520.....	34911C	Stator, 400 (Variable Pitch) 1964-67	1	TBA
520.....	34911CA	Stator, 400 (Fixed Pitch) (Cast # 649) 1964-67	1	TBA
520.....	34911BA	Stator, 400 (Fixed Pitch) (Cast # 174/176) 1968-70	1	TBA
520.....	34910C	Stator, 400 (For 6-Bolt & 8-Bolt Type Body) (Cast # 896) 1971-Up	1	TBA
520.....	34203	Stator, 4L80E (Cast # 779, 263, or 184) 1991-96	1	8681180
520.....	34203A	Stator, 4L80E (Cast # 512 Or 379) 1997-Up	1	24204303
520.....	34203AA	Stator, 4L80E (Cast # 512 Or 379) 2004-Up	1	TBA
520.....	34203R	Stator, 4L80E Bentley/Rolls Royce (Cast # 214) 1991-96	1	TBA
520.....	34203RA	Stator, 4L80E Bentley/Rolls Royce (Cast # ??) 1997-Up	1	TBA
530.....	K34201E	Pump Gear Set, 4L80E 1991-Up	1	TBA
530.....	K35201B	Pump Gear Set, 400 (.727" Thick) 1964-Up	1	TBA
530.....	K34201EX	Pump Gear Set, 4L80E (Oversize)	1	TBA
DRUMS, DRUM PISTON KITS & CLUTCH HUBS				
545.....	34876	Housing, 4L80E 4th Clutch (Cast # 8661266)(For 8 Lug Pressure Plate) 1991-98	1	24200789
545.....	34876A	Housing, 4L80E 4th Clutch (Cast # 24205817)(For 2 Lug Pressure Plate) 1999-Up	1	24215124

400, 3L80, 4L80E, 4L85E

ILL#	Part#		QTY	REF#
547.....	34171	Apply Ring, 400/4L80E Forward Clutch #1, .562" (For Steel Pistons) 1964-Up.....	1.....	TBA
547.....	34171A	Apply Ring, 400/4L80E Forward Clutch #2, .625" (For Steel Pistons) 1964-Up.....	1.....	TBA
547.....	34171B	Apply Ring, 400/4L80E Forward Clutch #3, .742" (For Steel Pistons) 1964-Up.....	1.....	TBA
547.....	34171C	Apply Ring, 400/4L80E Forward Clutch #4, .783" (For Steel Pistons) 1964-Up.....	1.....	TBA
548.....	34171	Apply Ring, 400/4L80E Direct Clutch #1, .562" (For Steel Pistons) 1964-Up.....	1.....	TBA
548.....	34171A	Apply Ring, 400/4L80E Direct Clutch #2, .625" (For Steel Pistons) 1964-Up.....	1.....	TBA
548.....	34171B	Apply Ring, 400/4L80E Direct Clutch #3, .742" (For Steel Pistons) 1964-Up.....	1.....	TBA
548.....	34171C	Apply Ring, 400/4L80E Direct Clutch #4, .783" (For Steel Pistons) 1964-Up.....	1.....	TBA
551.....	34898	Drum, 4L80E O-Run Clu W/Sun Gr (Sprag Has .309" OD Rollers) 1991-01.....	1.....	8680918
551.....	34898A	Drum, 4L80E O-Run Clu W/Sun Gr (Sprag Has .196" OD Rollers) 2002-Up.....	1.....	TBA
554.....	34803B	Drum, 400 Forward Clutch 1964-Up.....	1.....	8624908
554.....	34815	Drum, 4L80E Forward Clutch W/Ring Gear (Uses Aluminum Piston) 1991-96.....	1.....	8680917
554.....	34815A	Drum, 4L80E Forward Clutch W/Ring Gear (Uses Bonded Piston) 1997-Up.....	1.....	24208850
555.....	34837	Drum, 400 Direct Clutch, 5 Clutch (Element Type Sprag) 1964-70.....	1.....	TBA
555.....	34836	Drum, 400/425 Direct Clutch, 6 Clutch (Element Type Sprag) 1964-70.....	1.....	TBA
555.....	34837B	Drum, 400 Direct Clutch, 5 Clutch (No Check Ball) (Roller Type Sprag) 1971-76.....	1.....	TBA
555.....	34838A	Drum, 400/425 Direct Clutch, 6 Clutch (No Check Ball) (Roller Type Sprag) 1971-76.....	1.....	TBA
555.....	34837A	Drum, 400 Direct Clutch, 5 Clutch (W/Check Ball) (Roller Type Sprag) 1977-Up.....	1.....	TBA
555.....	34838	Drum, 400/425 Direct Clutch, 6 Clutch (W/ Check Ball) (Roller Type Sprag) 1977-Up.....	1.....	TBA
555.....	34838F	Drum, 4L80E Direct Clutch (Works With Alum Or Bonded Piston) 1991-Up.....	1.....	TBA
555.....	K34838E	Drum, Direct W/ Sprag Assy, 4L80E (Alum Piston Type) 1991-96.....	1.....	TBA
555.....	K34838F	Drum, Direct W/ Sprag Assy, 4L80E (Bonded Piston Type) 1997-Up.....	1.....	TBA
560.....	K34967	Piston Kit, 4L80E Overrun Clutch (.079" Snap Ring) 1991-01.....	1.....	TBA
560.....	K34967A	Piston Kit, 4L80E Overrun Clutch (.060" Snap Ring) 2001-Up.....	1.....	TBA
561.....	K34807	Piston Kit, 4L80E 4th Clutch 1991-Up.....	1.....	TBA
562.....	K34810	Piston Kit, 400 Intermediate Clutch (Aluminum).....	1.....	8670196
562.....	K34810A	Piston Kit, 400 Intermediate Clutch (Steel).....	1.....	TBA
562.....	K34810EA	Piston Kit, 4L80E Intermediate Clutch (Piston Cast # 24202553).....	1.....	TBA
562.....	K34810EB	Piston Kit, 4L80E Intermediate Clutch (Piston Cast # 8661657).....	1.....	TBA
564.....	K34819A	Piston Kit, 400 Forward Cl Alum Pist (4 Clutch) (Cast # 402) (No Check Ball) .906". 1964-Up.....	1.....	TBA
564.....	K34819	Piston Kit, 400 Forward Cl Alum Pist (5 Clutch) (Cast # 401, 709) (No Check Ball) .740", 1964-Up.....	1.....	TBA
564.....	K34832AA	Piston Kit, 400 Fwd Cl Alum Pist (5 Clutch) (Cast # 206, 391, 501) (No Check Ball) .615", 1964-Up.....	1.....	TBA
564.....	K34809	Piston Kit, 400/425 Forward Cl Alum Pist (6 Clutch) (Cast # 204) (No Check Ball) .585", 1964-Up.....	1.....	TBA
564.....	K34832A	Piston Kit, 400/425 Forward Cl Steel Piston Type, 1977-Up.....	1.....	TBA
564.....	K34808	Piston Kit, 4L80E Forward Clutch, Alum Pist Cast # 8675507) 1991-96.....	1.....	TBA
565.....	K34832AD	Piston Kit, 400 Direct Cl Alum Pist (4 Clutch) (Cast # 402) (W/ Check Ball) .906". 1964-76.....	1.....	TBA
565.....	K34832AC	Piston Kit, 400 Direct Cl Alum Pist (5 Clutch) (Cast # 099, 709) (W/ Check Ball) .740", 1964-76.....	1.....	TBA
565.....	K34832AE	Piston Kit, 400 Direct Cl Alum Pist (5 Clutch) (Cast # 501, 391) (W/ Check Ball) .615", 1964-76.....	1.....	TBA
565.....	K34832AB	Piston Kit, 400/425 Direct Cl Alum Pist (6 Clutch) (Cast # 204) (W/ Check Ball) .585", 1964-76.....	1.....	TBA
565.....	K34832AF	Piston Kit, 400 Direct Cl Alum Pist (4 Clutch) (Cast # 557) (No Check Ball) .862", 1977-Up.....	1.....	TBA
565.....	K34832AA	Piston Kit, 400 Direct Cl Alum Pist (5 Clu) (Cast # 206, 391, 501) (No Check Ball) .615", 1964-Up.....	1.....	TBA
565.....	K34809	Piston Kit, 400/425 Direct Cl Alum Pist (6 Clutch) (Cast # 204) (No Check Ball) .585", 1977-Up.....	1.....	TBA
565.....	K34832A	Piston Kit, 400/425 Direct Cl Steel Piston Type, 1977-Up.....	1.....	TBA
565.....	K34808B	Piston Kit, 4L80E Direct Clutch, Alum Pist Cast # 8675510) (No Check Ball) 1991-96.....	1.....	TBA
574.....	34322	Clutch Hub, 400, Forward Clutch (Cast) 1964-Up.....	1.....	8661611
574.....	34322E	Clutch Hub, 4L80E Forward Clutch (Steel) 1991-96.....	1.....	8661611
574.....	34322EA	Clutch Hub, 4L80E Forward Clutch (W/4 Wide Splines) 1997-Up.....	1.....	TBA
575.....	34323AA	Clutch Hub, 400 Direct Clutch W/ Fwd B/Plate (Shorter) 1964.....	1.....	TBA
575.....	34323	Clutch Hub, 400/4L80E Direct Clutch W/ Fwd B/Plate (Cast Type) 1965-98.....	1.....	TBA
575.....	34323A	Clutch Hub, 4L80E Direct Clutch W/ Fwd B/Plate (Steel Type) 1991-Up.....	1.....	8661837

GEARTRAINS

PLANETS & PLANET ASSEMBLIES

580.....	34821AA	Planet, 4L80E Overdrive (Early Sprag W/ .309" OD Rollers) For 1st Des Input Shaft, 1991-92.....	1.....	TBA
580.....	34821	Planet, 4L80E Overdrive (Early Sprag W/ .309" OD Rollers) For 2nd Des Input Shaft, 1993-00.....	1.....	24200130
580.....	34821A	Planet, 4L80E Overdrive (Late Sprag W/ .196" OD Rollers) 2001-Up.....	1.....	TBA
580.....	K34821	Overdrive Assy (Sprag Has .309" OD Rollers) 1991-01 (Includes All From #551 To #580).....	1.....	8680918
580.....	K34821A	Overdrive Assy (Sprag Has .196" OD Rollers) 2002-Up (Includes All From #551 To #580).....	1.....	TBA
582.....	34875	Planet, 400 Front (Element Type Sprag) 1964-67.....	1.....	8624971
582.....	34879	Planet, 425 Front (Element Type Sprag) 1966-67.....	1.....	TBA
582.....	34879A	Planet, 425 Front (Roller Type Sprag) 1968-78.....	1.....	TBA
582.....	34875B	Planet, 475 Front (Straight Cut Gears) 1968-Up.....	1.....	TBA
582.....	34875A	Planet, 400 Front (Roller Type Sprag) 1968-Up.....	1.....	8627893
582.....	34875C	Planet, 4L80E Front (Uses No-Finger Type Sprag) 1991-96.....	1.....	TBA
582.....	34875E	Planet, 4L80E Front (Uses 8-Finger Type Sprag) 1996-98.....	1.....	24212051
582.....	34875F	Planet, 4L80E Front (Straight Cut Gears) 1991-Up.....	1.....	24205552
582.....	34875H	Planet, 4L80E Front (4-Gear Late Gear Type) 1999-Up.....	1.....	TBA



400, 3L80, 4L80E, 4L85E

GM

ILL#	Part#		QTY	REF#
582	34875G	Planet, 4L80E Front (5-Gear Late Gear Type) 1999-Up	1	TBA
584	34880	Planet, 400 Rear (Short .5" Park Lugs) 1964-98	1	8655132
584	34880AB	Planet, 400 Rear (Short 1.5" Park Lugs) 1964-98	1	TBA
584	34883	Planet, 425 Rear, 1966-78	1	TBA
584	34880A	Planet, 475 Rear (Straight Cut Gears) (Short .5" Park Lugs) 1968-Up	1	8655133
584	34880FA	Planet, 475 Rear (Straight Cut Gears) (Short 1.5" Park Lugs) 1968-Up	1	TBA
584	34880E	Planet, 4L80E Rear (4-Gear) (W/ Sensor Ring) 1991-98	1	8675611
584	34880EB	Planet, 4L80E Rear (4-Gear) Some 4WD (No Sensor Ring) 1991-98	1	TBA
584	34880EA	Planet, 4L80E Rear (4-Gear) (W/ Sensor Ring) 1999-Up	1	TBA
584	34880F	Planet, 4L80E Rear HD (Straight Cut Gears) 1991-98	1	TBA
584	34880G	Planet, 4L80E Rear (5-Gear) (W/ Sensor Ring) 1999-Up	1	TBA
		Include : Sun Gr Shaft, Sun Gear, FT & RR Planet, Main Shaft, R. Ring Gear		
584	K34875	Geartrain 400 (Element Type Sprag) 1964-67	1	TBA
584	K34883	Geartrain 425 (Element Type Sprag) 1966-67	1	TBA
584	K34883A	Geartrain 425 (Roller Type Sprag) 1968-78	1	TBA
584	K34875A	Geartrain 400 (Roller Type Sprag) 1968-98	1	TBA
584	K34880A	Geartrain 475 (Straight-Cut Gears) 1968-98	1	TBA
584	K34875E	Geartrain 4L80E (4-Gear) (W/ Sensor Ring) 1991-98	1	TBA
584	K34575EA	Geartrain 4L80E (4-Gear) (W/ Sensor Ring) 1999-Up	1	TBA
584	K34875F	Geartrain 4L80E HD (Straight-Cut Gears) (W/ Sensor Ring) 1991-98	1	TBA
584	K34875G	Geartrain 4L80E (5-Gear) (W/ Sensor Ring) 1999-Up	1	TBA

RING GEARS, SUN GEARS & CENTER SUPPORTS

594	34853	Ring Gear, 400/4L80E Rear Planet (Angled Teeth) (30-Spline To Mainshaft) 1964-96	1	8661892
594	34853A	Ring Gear, 475/4L80E Rear Planet (Straight Teeth) (30-Spline To Mainshaft) 1964-96	1	TBA
594	34854	Ring Gear, 425 Rear Planet 1966-78	1	TBA
594	34583G	Ring Gear, 4L80E Rear Planet (Angled Teeth) (22-Spline To Mainshaft) 1997-Up	1	TBA
594	34583GA	Ring Gear, 4L80E Rear Planet (Straight Teeth) (22-Spline To Mainshaft) 1997-Up	1	TBA
612	34872AA	Sun Gear, 400 (26-Splines To 26-Spline Interm Sun Gear Shaft) 1964-67	1	TBA
612	34873	Sun Gear, 425 (26-Splines To 26-Spline Interm Sun Gear Shaft) 1966-67	1	TBA
612	34873A	Sun Gear, 425 (30-Splines To 32-Spline Interm Sun Gear Shaft) 1966-67	1	TBA
612	34872	Sun Gear, 400/4L80E (30-Splines To 32-Spline Interm Sun Gear Shaft) 1968-96	1	8626807
612	34872A	Sun Gear, 475/4L80E (Straight-Cut) (30-Splines To 32-Spline Interm Sun Gear Shaft) 1968-96	1	24203396
612	34872B	Sun Gear, 4L80E (28-Splines To 32-Spline Interm Sun Gear Shaft) 1997-Up	1	TBA
612	34872C	Sun Gear, 4L80E (Straight-Cut Gears) (28-Splines To 32-Spline Interm Sun Gear Shaft) 1997-Up	1	TBA
630	34845	Center Support, 400/425 (Element Type Sprag) (.375" Lugs To Case) 1964-67	1	8680914
630	34846	Center Support, 400/425 (Roller Type Sprag) (.330" Lugs To Case) 1968-98	1	8625990
630	34822	Center Support, 4L80E (No Lube Hole Type) 1991-96	1	8680914
630	34822A	Center Support, 4L80E (W/ Lube Hole, No Shim Type) 1997-98	1	24208849
630	34822B	Center Support, 4L80E (W/ Lube Hole, W/ Shim Type) 1999-Up	1	24217454

SPRAGS & ONE WAY CLUTCHES

650	34417	Sprag, 4L80E Overdrive (3.25" OD W/.309" Rollers) 1991-01	1	7471001
650	34417A	Sprag, 4L80E Overdrive (3.00" OD W/.196" Rollers) 2002-Up	1	12431003
652	34419	Sprag, 400 Intermediate (8-Roller Type) 1971-Up	1	8625814
652	34418X	Sprag, 400/4L80E Intermediate HD (34-Element Type) 1964-Up	1	8663173
652	34418	Sprag, 400/4L80E Intermediate (16-Element Type) 1964-Up	1	8623116
654	34402	Sprag, 400/425 Low Clutch (Rear) (Element Type) 1964-67	1	TBA
654	6239G	Sprag, 400/425 Low Clutch (Rear) (Roller Type) 1966-98	1	8623842
654	6293G	Sprag, 4L80E Low Clutch (Rear) (Roller Type, No-Legs To Planet) 1991-E95	1	7471002
654	34727	Sprag, 4L80E Low Clutch (Rear) (Roller Type, 8-Legs To Planet) L1995-Up	1	7471009
662	34841	Inner Race, 400/4L80E Intermediate Sprag (Lug Type)	1	TBA
663	34839	Outer Race, 400 Intermediate Sprag (.751" Thick) 1964-98	1	8629487
663	34839E	Outer Race, 4L80E Intermediate Sprag (.795" Thick) 1991-Up	1	8680915
663	K34839	Outer Race Kit, 400/425 Interm (Elem Type) (Sprag, Outer Race, Retainer & Snap Ring) 1964-70	1	TBA
663	K34839A	Outer Race Kit, 400/425 Interm (Roller Type) (Sprag, Outer Race, Retainer & Snap Ring) 1971-88	1	TBA
663	K34839E	Outer Race Kit, 4L80E Interm (Element Type) (Sprag, Outer Race, Retainer & Snap Ring) 1991-Up	1	8680915

SHAFTS & GOVERNORS

670	34801	Input Shaft (Turbine), 400 (Variable Pitch Type) (1-Ring Type) 1964-67	1	TBA
670	34800B	Input Shaft (Turbine), 425 8-1/8" (Variable Pitch Type) (2-Ring Type) 1966-67	1	TBA
670	34800A	Input Shaft (Turbine), 425 8-1/8" (Fixed Pitch Type) (1-Ring Type) 1968-78	1	TBA
670	34800	Input Shaft (Turbine), 400 (Fixed Pitch Type) 1964-98	1	8624772
670	34801E	Input Shaft (Turbine), 4L80E (1-Lube Hole Type) 1991-93	1	8683900
670	34801G	Input Shaft (Turbine), 4L80E (2-Lube Hole Type) 1993-Up	1	24222184
672	34851	Main Shaft, 400/425/4L80E (Hollow Type) 1964-96	1	TBA
672	34851F	Main Sh, 4L80E (Solid Type, No Lube Holes) 1997-Up	1	TBA
674	34870A	Shaft, 400/425 Interm Sun Gear (28 Splines To Sun Gear) 1964-67	1	TBA

400, 3L80, 4L80E, 4L85E

ILL#	Part#		QTY	REF#
674.....	34870.....	Shaft, 400/425/4L80E Interm Sun Gear (32 Splines To Sun Gear) 1968-96.....	1.....	8661708
674.....	34813A.....	Shaft, 4L80E Interm Sun Gear (32 Splines To Sun Gear, No-ID Groove) 1997-98.....	1.....	TBA
674.....	34813B.....	Shaft, 4L80E Interm Sun Gear (32 Splines To Sun Gear, 1-ID Groove) 1999-Up.....	1.....	TBA
678.....	34862.....	Output Shaft, 400, Cadillac, 18" Long, Press-On Speedo Gear) 1965-Up.....	1.....	TBA
678.....	34862A.....	Output Shaft, 400, Cadillac, 18" Long, Clip-On Speedo Gear) 1965-Up.....	1.....	TBA
678.....	34863.....	Output Shaft, 400 15" Long (32-Spline, Has O-Ring, Press-On Speedo Gear) 1964-Up.....	1.....	TBA
678.....	34863A.....	Output Shaft, 400 15" Long (32-Spline, No O-Ring, Press-On Speedo Gear) 1964-Up.....	1.....	TBA
678.....	34863B.....	Output Shaft, 400 15" Long (32-Spline, Has O-Ring, Clip-On Speedo Gear) 1964-Up.....	1.....	TBA
678.....	34852.....	Output Flange, 425 FWD 15" Long, 1966-78.....	1.....	TBA
678.....	34863C.....	Output Shaft, 400 15" Long (32-Spline, No O-Ring, Clip-On Speedo Gear) 1964-Up.....	1.....	TBA
678.....	34866A.....	Output Shaft, 375, 15" Long (27-Spline, Clip-On Speedo Gear) 1972-Up.....	1.....	TBA
678.....	34866B.....	Output Shaft, 375, 15" Long (27-Spline, Press-On Speedo Gear) 1972-Up.....	1.....	TBA
678.....	34866.....	Output Shaft, 400, 13" Long, Jeep (10-Spline Type) 1973-Up.....	1.....	8624900
678.....	34860.....	Output Shaft, 400 9" Long (Slip-Yoke Type, Has O-Ring, Press-On Speedo Gear) 1965-Up.....	1.....	TBA
678.....	34865.....	Output Shaft, 400 9" Long (Slip-Yoke Type, No O-Ring, Press-On Speedo Gear) 1965-Up.....	1.....	TBA
678.....	34866D.....	Output Shaft, 400 9" Long (Slip-Yoke Type, Has O-Ring, Clip-On Speedo Gear) 1965-Up.....	1.....	TBA
678.....	34866E.....	Output Shaft, 400 9" Long (Slip-Yoke Type, No O-Ring, Clip-On Speedo Gear) 1965-Up.....	1.....	TBA
678.....	34934.....	Output Shaft, 400 9" Long Truck (Bolt-On Yoke Type, Clip-On Speedo Gear) 1965-Up.....	1.....	TBA
678.....	34934A.....	Output Shaft, 400 9" Long Truck (Bolt-On Yoke Type, Press-On Speedo Gear) 1965-Up.....	1.....	TBA
678.....	34934B.....	Output Shaft, 400 9" Long Truck (Bolt-On Yoke Type, W/ Speedo Reluctor) 1985-Up.....	1.....	TBA
678.....	34935A.....	Output Shaft, 400, 7" Long, 4WD (32-Spline Type).....	1.....	TBA
678.....	34935.....	Output Shaft, 400, 6" Long, 4WD (32-Spline Type).....	1.....	TBA
678.....	34966A.....	Output Shaft, 400, 6" Long, 4WD (27-Spline Type).....	1.....	TBA
678.....	34867D.....	Output Shaft, 4L80E, 9" Long (W/ Lube Hole, Bolt-On Yoke Type) 1991-96.....	1.....	TBA
678.....	34867E.....	Output Shaft, 4L80E, 9" Long (No Lube Hole, Bolt-On Yoke Type) 1997-Up.....	1.....	TBA
678.....	34867K.....	Output Shaft, 4L80E 8-1/8" Long (Slip-On Yoke Type, W/ Lube Hole) 1991-96.....	1.....	TBA
678.....	34867L.....	Output Shaft, 4L80E 8-1/8" Long (Bolt-On Yoke Type, W/ Lube Hole) 1991-96.....	1.....	TBA
678.....	34867M.....	Output Shaft, 4L80E 8-1/8" Long (Slip-On Yoke Type, No Lube Hole) 1997-Up.....	1.....	TBA
678.....	34867N.....	Output Shaft, 4L80E 8-1/8" Long (Bolt-On Yoke Type, No Lube Hole) 1997-Up.....	1.....	TBA
678.....	34867R.....	Output Shaft, 4L80E 7-7/8" Long (Bolt-On Yoke Type, W/ Lube Hole) 1991-96.....	1.....	TBA
678.....	34867S.....	Output Shaft, 4L80E 7-7/8" Long (Bolt-On Yoke Type, No Lube Hole) 1997-Up.....	1.....	TBA
678.....	34867.....	Output Shaft, 4L80E 7-3/8" Long, Jaguar, 1993-96.....	1.....	TBA
678.....	34867F.....	Output Shaft, 4L80E 4WD 5" Long (W/ Lube Hole) 1991-96.....	1.....	TBA
678.....	34867G.....	Output Shaft, 4L80E 4WD 5" Long (No Lube Hole) 1997-Up.....	1.....	TBA
678.....	34867B.....	Output Shaft, 4L80E 4-3/8" Long (Short Spline-Type) 1991-96.....	1.....	8661598
680.....	34410A.....	Governor, 400 1964.....	1.....	TBA
680.....	34410.....	Governor, 400 2nd Design 1965-Up.....	1.....	8623852
680.....	34410D.....	Governor, 400 Diesel 1964-Up.....	1.....	TBA
680.....	34410B.....	Governor, 425 1966-78.....	1.....	8626853
684.....	K34411.....	Governor Gear & Pin Kit, 400 1964-Up.....	1.....	8623924
684.....	K34411A.....	Governor Gear & Pin Kit, 425 (Left Angle) (With 1 Pin & 2 Nails) 1964-98.....	1.....	8624939
686.....	34409.....	Cover, 400 Governor 1964-Up.....	1.....	TBA
694.....	34642.....	Retainer, 400/4L80E Intermediate Sprag 1964-Up.....	1.....	8626334
700.....	34419C.....	Chain, 425 Drive 1966-78.....	1.....	8625946
VALVE BODIES (DACCO VB#)				
740.....	GM-4614.....	Valve Body, 400 1987-UP, WITHOUT REVERSE CHECK BALL.....	1.....	TBA
740.....	GM-4615.....	Valve Body, 400 1987-UP, WITH REVERSE CHECK BALL.....	1.....	TBA
740.....	GM-4622.....	Valve Body, 4L80E W / TEMP SENSOR 1991-92.....	1.....	TBA
740.....	GM-4623.....	Valve Body, 4L80E W / OUT TEMP SENSOR 1993-96.....	1.....	TBA
740.....	GM-4624.....	Valve Body, 4L80E WITH CASTING # 24204267 1997-03.....	1.....	TBA
740.....	GM-4624B.....	Valve Body, 4L80E UPDATED EPC 2003-Up.....	1.....	TBA
VALVE BODIES				
740.....	34992AA.....	Valve Body, 400, 1964 Only.....	1.....	TBA
740.....	34997.....	Valve Body, 425, 1966-78.....	1.....	TBA
740.....	34992.....	Valve Body, 400 (Canister Filter Type) 1965-67.....	1.....	TBA
740.....	34994.....	Valve Body, 400 6-Check Ball (Flat Filter Type) 1968-87.....	1.....	TBA
740.....	34994A.....	Valve Body, 400 7-Check Ball (Flat Filter Type) 1988-Up (Can Use 34994).....	1.....	TBA
740.....	34994E.....	Valve Body, 4L80E (Cast #811) (W/ Temp Switch) 1990-91.....	1.....	TBA
740.....	34994F.....	Valve Body, 4L80E (Cast #811) (No Temp Switch) 1992-1993.....	1.....	TBA
740.....	34994H.....	Valve Body, 4L80E (Cast #479) 1993-94.....	1.....	TBA
740.....	34994J.....	Valve Body, 4L80E (Cast #212) 1995-96.....	1.....	TBA
740.....	34994G.....	Valve Body, 4L80E (Cast #267) (Early EPC Solenoid Type) 1997-03.....	1.....	TBA
740.....	34994GA.....	Valve Body, 4L80E (Cast #267) (Late EPC Solenoid Type) 2004-Up.....	1.....	TBA
VALVE BODY COMPONENTS				
741.....	34994-07.....	Roll Pin Set, 4L80E (Holds Valve Assembly In Valve Body) (Sonnax) (10 Per Set).....	1.....	34994-07



400, 3L80, 4L80E, 4L85E

ILL#	Part#		QTY	REF#
741	34992A	Manual Valve, 400 (in Valve Body)	1	TBA
741	34994-01K	Valve Kit, 4L80E TCC Regulator (Sonnax)	1	34994-01K
741	SC-4L80E	Sure Cure Kit, 4L80E 1991-Up (Sonnax) (Requires Tool # T-77754-TL)	1	SC-4L80E
741	34994-15	Snap Ring, 4L80E (Holds .684" OD End Plug In Valve Body) (10 Per Set) TCC Valve	1	34994-15
741	34994-13	End Plug Set, 4L80E (Valve Body End Plug .495" OD With O-Rings) (Sonnax) (5 Per Set)	1	34994-13
741	34994-14K	End Plug Set, 4L80E (Valve Body End Plug .684" OD With O-Rings) (Sonnax) (5 Per Set)	1	34994-14K
741	34200-01K	Valve & Sleeve, 4L80E Reverse Boost "O-Ring" Style (Sonnax)	1	34200-01K
741	34200-03K	Valve & Sleeve, 4L80E Reverse Boost "Factory" Style (Sonnax)	1	34200-03K
741	34200-16K	Limit Valve Kit, 4L80E Actuator Feed (Requires 77754TL Tool) (Sonnax)	1	34200-16K
741	77754TL	Reamer, 4L80E (For S34741FK) (Sonnax)	1	77754TL
741	34994-16	Manual Valve, 4L80E (In Valve Body) (Sonnax)	1	34994-16
741	34994-16K	Manual Valve Kit (Valve W/ End Plug & 2-O-rings) (Sonnax)	1	34994-16K
741	34994-17K	Manual Valve Kit, 4L80E W/Out Valve, (End Plug & 2 O-Rings) (Sonnax)	1	34994-17
741	34200-14K	Valve, 4L80E Line To Lube Pressure Regulator (Sonnax)	1	34200-14K
741	34994-02K	Spring Kit, 4L80E 1-2 & 2-3 Shift Valve (1 Of Each Spring) Sonnax	1	34994-02K
741	48-ACT-TL	Boring Kit, 4L80E Actuator Limit Valve (Oversize) Includes: Boring Kit, 6 Valves & Springs	1	48-ACT-TL
741	48-ACT-VL6	REFILL FOR 48-ACT-TL (6-Valves & 6-Springs)	1	48-ACT-VL6
747	VB101-5	Valve Body Plate Ball Seat Repair Kit (Teckpak)	1	VB-101
747	34999	Plate, 400 Valve Body	1	8661468
747	34999A	Plate, 400 Valve Body (W/Code VUV)	1	8670858
747	34999B	Plate, 400 Valve Body (W/350 Engine) 1989-Up	1	8655791
747	34999C	Plate, 400 Valve Body (W/Codes FD/FF/FP/FR/FS/FX)	1	8629796
747	34999D	Plate, 400 Valve Body (W/6.2L Diesel)	1	8655887
747	48-PLT-01	Plate, 4L80E Valve Body, (Transgo) Tempered Steel, Replaces ALL 1991-2009	1	48-PLT-01
747	34999E	Plate, 4L80E Valve Body (W/Cast # BA/BB/BJ/BM/BN)(W/Stamped Code 0654)	1	8680654
747	34999EA	Plate, 4L80E Valve Body (W/Stamped Code 8016)	1	8678016
747	34999EB	Plate, 4L80E Valve Body (W/Stamped Code 5688)	1	8685688
747	34999EC	Plate, 4L80E Valve Body (W/Stamped Code 5689)	1	8685689
747	34999ED	Plate, 4L80E Valve Body (W/Cast # 4225)(W/Stamped Code 5690)	1	8685690
747	34999EF	Plate, 4L80E Valve Body (W/Stamped Code 5691)	1	8685691

CASES, PANS, EXTENSION HOUSINGS & CASE COMPONENTS

755	34909	Case Cover, 425 (Channel Plate) 1966-78	1	8625009
760	34917	Case, 400 Buick (W/Round Bell, Shorter Case) 1964-Only	1	TBA
760	34917F	Case, 400 Chevy / GMC (Early Filter) 1965-67	1	TBA
760	34912AA	Case, 400 Buick (W/Round Bell, Taller Case) 1965-66	1	TBA
760	34912	Case, 400 Oldsmobile (Early Filter, No Speedo Hole) 1965-66	1	TBA
760	34912A	Case, 400 Cadillac (Early Filter, Flat Top) 1965-66	1	TBA
760	34912AB	Case, 400 Pontiac 65-66, Buick & Cadillac 1967-Only (Early Filter, W/Speedo Hole)	1	TBA
760	34917DA	Case, 425 FWD (Variable Pitch Type) 1966-67	1	TBA
760	34917D	Case, 425 FWD (Fixed Pitch Type) 1968-78	1	TBA
760	34917G	Case, 400 2WD Chevy / GMC (Flat Filter, 8-Bolt Pump) 1968-72	1	TBA
760	34917H	Case, 400 4WD Chevy / GMC (Flat Filter, 8-Bolt Pump) 1969-72	1	TBA
760	34912AD	Case, 400 Buick/Pontiac/Oldsmobile/Cadillac (Flat Filter, 8-Bolt Pump) 1968-72	1	TBA
760	34914	Case, 400 2WD Chevy / GMC (6-Bolt Pump, 6-Check Ball VB, Standard Bolts) 1973-81	1	TBA
760	34917J	Case, 400 4WD Chevy / GMC (6-Bolt Pump, 6-Check Ball VB, Standard Bolts) 1973-81	1	TBA
760	34912AE	Case, 400 Buick/Pontiac/Oldsmobile/Cadillac (6-Bolt Pump, Standard Bolts) 1973-81	1	TBA
760	34917A	Case, 400, Jeep (Round Bell, Starter On Pass Side) 1973-85	1	TBA
760	34917C	Case, 400, Jaguar (Round Bell, Starter On Driver Side) 1973-81	1	TBA
760	34917K	Case, 400 2WD Chevy / GMC (6-Check Ball VB, Metric Bolts) 1982-87	1	TBA
760	34917B	Case, 400 4WD Chevy / GMC (6-Check Ball VB, Metric Bolts) 1982-87	1	TBA
760	34912AE	Case, 400 Buick/Pontiac/Oldsmobile/Cadillac (6-Check Ball VB, Metric Bolts) 1982-87	1	TBA
760	34914A	Case, 400 2WD Chevy / GMC (7-Check Ball VB, Metric Bolts) 1988-Up	1	TBA
760	34912B	Case, 400 4WD Chevy / GMC (7-Check Ball VB, Metric Bolts) 1988-Up	1	TBA
760	34912C	Case, 4L80E (1st Design Type) 1990-E91	1	TBA
760	34913E	Case, 4L80E GM (No Neutral Switch Bosses) L/1991-94	1	TBA
760	34913K	Case, 4L80E Jaguar (Round Bell Type) 1993-96	1	TBA
760	34913F	Case, 4L80E (W/ Neutral Switch Bosses & No Cable Bosses) 1995	1	TBA
760	34913G	Case, 4L80E (W/ Neutral Switch Bosses & W/ Cable Bosses) 1996	1	TBA
760	34913H	Case, 4L80E (6-Bolt Bell Type) 1997-98	1	TBA
760	34913I	Case, 4L80E (7-Bolt Bell Type) 1999-03	1	TBA
760	34913J	Case, 4L80E (7-Bolt Bell Type) (Front Cooler Line Boss Is Only Raised Boss) 2004-Up	1	TBA
760	34913L	Case, 4L80E Hummer (Top Bolt Shaved Off) 2004-Up	1	TBA
760	34913R	Case, 4L80E, Bentley/Rolls Royce, 1991-96	1	TBA
760	34913RA	Case, 4L80E, Bentley/Rolls Royce, 1997-Up	1	TBA
761	K34354	Inserts, 400/4L80E Case Saver Inserts (5-Piece)	1	TBA
761	34761AC	Inserts, 400, Intermediate Snap Ring Support H-Perf (Adapt-A-Case)	1	HP34761AC
765	34980	Pan, 400 (W/3 Dimples) 1964-67	1	TBA

400, 3L80, 4L80E, 4L85E

ILL#	Part#		QTY	REF#
765.....	34981	Pan, 400 (W/2 Dimples) 1968-Up.....	1.....	TBA
765.....	34982	Pan, 400 Deep 1964-Up.....	1.....	8679994
765.....	K34982	Pan Kit, 400 Deep Pan, Filter Tube, Bolt, & Bolt Spacer.....	1.....	TBA
765.....	34701F	Pan, 4L80E 2WD (W/Drain Plug on The Side) Deep 1991-96.....	1.....	TBA
765.....	34701E	Pan, 4L80E (W/Out Drain Plug on The Side) 1991-96.....	1.....	TBA
765.....	34701EA	Pan, 4L80E (W/Drain Plug on Bottom) 1997-Up (Pan Is Shallow On One End).....	1.....	TBA
765.....	34701EB	Pan, 4L80E (W/Out Drain Plug On Bottom) 1997-Up (Pan Is Shallow On One End).....	1.....	TBA
765.....	K34701EB	Pan Kit, 4L80E (W/Bottom Drain Plug) (With Pan Gskt) 1997-Up (Pan Is Shallow On One End).....	1.....	24204278
765.....	34701EC	Pan, 4L80E Jaguar 1993-96.....	1.....	TBA
770.....	34915BA	Extension Housing, 400 Cadillac, 13-1/2" Long (Uses Small 1.795" OD Bushing) 1965-67.....	1.....	TBA
770.....	34915B	Extension Housing, 400 Cadillac, 13-1/2" Long (Uses Large 1.995" OD Bushing) 1968-Up.....	1.....	TBA
770.....	34915C	Extension Housing, 400 9-1/4" Long (Uses Large 1.995" OD Bushing) 1965-Up.....	1.....	TBA
770.....	34915D	Extension Housing, 400 9-1/4" Long (Uses Small 1.795" OD Bushing) 1965-70.....	1.....	TBA
770.....	34915AA	Ext Hsg, 400 9-1/4" Long #B (1.995" OD Bsh, 1-Threaded Boss Between Mount & Seal) 1965-Up.....	1.....	TBA
770.....	34915A	Extension Housing, 375 9-1/4" Long (Uses Small 1.626" OD Bushing) 1972-Up.....	1.....	TBA
770.....	34915	Extension Housing, 400 4" Long #C (Uses Large 1.995" OD Bushing) 1965-Up.....	1.....	TBA
770.....	34915AB	Extension Housing, 400 4" Long (Uses Small 1.795" OD Bushing) 1965-70.....	1.....	TBA
770.....	34915E	Extension Hsg/Adapter, 400 Jeep 5-1/8" Long, 1973-Up.....	1.....	TBA
770.....	34915F	Extension Hsg/Adapter, 400 4WD 5-1/8" Long (NP208 Type) 1973-Up.....	1.....	TBA
770.....	34915AC	Extension Housing, 4L80E 7-1/4" Long (Truck, Bolt-On Yoke Type) 1991-Up.....	1.....	TBA
770.....	34915AF	Extension Housing, 4L80E 7-1/4" Long (Bolt-On Park Brake, Bearing Type) 1991-Up.....	1.....	TBA
770.....	34915AE	Extension Housing, 4L80E 5-3/4" Long (#24221768) 1991-03.....	1.....	TBA
770.....	34915G	Extension Housing, 4L80E 5-3/4" Long (Uses Large Bushing) 2004-Up.....	1.....	TBA
770.....	34915AG	Extension Housing, 4L80E 5-3/8" Long (Bolt-On Park Brake, Bearing Type) 1991-Up.....	1.....	TBA
770.....	34915AH	Extension Hsg, 4L80E Jaguar 5-1/2" Long (1 Large & 4 Small Mounting Holes) #531, 1993-96.....	1.....	TBA
770.....	34915J	Extension Hsg, 4L80E Jaguar 5-1/2" Long (1 Large Offset Mounting Hole) #933, 1993-96.....	1.....	TBA
770.....	34915AJ	Extension Hsg/Adapter, 4L80E 4WD 2-5/8" Long (Cast Iron) #15654927, 1991-Up.....	1.....	TBA
770.....	34915AK	Extension Hsg/Adapter, 4L80E 4WD 2-5/8" Long (Aluminum) #15724251, 1991-Up.....	1.....	TBA
770.....	34915AK	Extension Hsg/Adapter, 4L80E 4WD 2-5/8" Long (Aluminum) #15724745, 1991-Up.....	1.....	TBA
774.....	34922	Speed-O Housing, 400 (Uses 35-39 Teeth Speed-O Gear) (Black) 1969-86.....	1.....	1362294
774.....	34922A	Speed-O Housing, 400 (Uses 40-45 Teeth Speed-O Gear) (Purple) 1969-86.....	1.....	1362293
777.....	34085	Bolt, Pump To Case, 400, 1964-Up.....	6-8.....	TBA
777.....	34085B	Bolt, Pump To Case, 4L80E, 1991-Up.....	7.....	TBA
779.....	34086	Bolt, Pan To Case, 400 (5/16") 1964-Up.....	13.....	TBA
779.....	34086A	Bolt, Pan To Case, 4L80E (10mm) 1991-Up.....	17.....	TBA
783.....	34846B	Bolt, 400 Center Support to Case (1 15/16" Long) 1964-Up.....	1.....	8670757
783.....	34802	Bolt, 4L80E Center Support to Case (1 3/8" Long) 1991-Up.....	1.....	8661762
789.....	34923	Spacer, 400 Filter to Valve Body (Deep Pan Type) 1968-98.....	1.....	8629523
790.....	34928	Bolt, 400 Filter to Valve Body (Deep Pan Type) 1968-98.....	1.....	8633208
790.....	34928A	Bolt, 400 Filter (Shallow Pan Type) 1964-Up.....	1.....	8633207
797.....	34081	Nut, 400 Holds External Shift Lever (SAE) 1964-Up.....	1.....	TBA
797.....	34081A	Nut, 400/4L80E Holds External Shift Lever (Metric).....	1.....	TBA
798.....	34082	Bolt, 400 Holds Yoke to Output Shaft.....	1.....	TBA
839.....	31866	Pan Magnet.....	1.....	TBA
841.....	34951	Yoke, 400 (Bolt-On Type)(5 7/8" Long).....	1.....	TBA
841.....	34951S	Yoke, 400 (Slip-On Type).....	1.....	TBA
842.....	77842	Bracket, TH400 Holds Large (2" OD) Speed-O Housing To Ext Hsg 1964-Up.....	1.....	12338069
843.....	35994	Bracket, 400 Holds Modulator to Case 1964-Up.....	1.....	8626886
843.....	34890	Bracket, 4L80E Solenoid (2nd Design) 1992-Up.....	1.....	8684217
845.....	34880-01	Reluctor, 4L80E Output Speed Sensor (On Rear Planet) (Sonnax).....	1.....	TBA
846.....	34998-01K	Bracket, 4L80E Wiring Harness Connector (Sonnax).....	1.....	34998-01K
846.....	34913-01	Bracket, 4L80E Shift Cable (Uses Pan Bolts) 1996 (Sonnax).....	1.....	TBA
847.....	34477	Reluctor / Rotor, TH400, Speedo (Electronic Pick-Up).....	1.....	8655315
847.....	NI	SEE GM SPEEDO DRIVE GEAR SECTION.....	1.....	TBA
848.....	***	SEE GM SPEEDO DRIVEN GEAR SECTION.....	1.....	TBA
852.....	34812G	Cushion Spring, 4L80E Intermediate Clutch (8 Inner Tabs) 1997-Up.....	1.....	TBA

SNAP RINGS

NI.....	K34928	Snap Ring Kit, TH400 1964-95.....	1.....	31680
NI.....	K34928A	Snap Ring Kit, 4L80E 1991-Up.....	1.....	TBA
861.....	34606	Snap Ring, 4L80E Holds 4th Clutch Pressure Plate in 1991-98.....	1.....	8677887
861.....	34606A	Snap Ring, 4L80E Holds 4th Clutch Pressure Plate in 1999-Up.....	1.....	TBA
862.....	34607	Snap Ring, 4L80E Holds 4th Clutch Pressure Retainer In 1991-Up.....	1.....	TBA
864.....	34617	Snap Ring, 4L80E Holds Overrun Clutch Pressure Plate in 1991-Up.....	1.....	8661572
865.....	34613	Snap Ring, 400/4L80E Holds Overrun Clutch Retainer in Drum (.079") 1964-00.....	1.....	8661568
865.....	34613A	Snap Ring, 4L80E Holds Overrun Clutch Retainer In Drum (.060") 2001-Up.....	1.....	24216149
868.....	34618	Snap Ring, 4L80E Holds Overdrive Planet to Pinion Gear Retainer 2002-Up.....	1.....	8679439
872.....	34612	Snap Ring, 400/4L80E Center Support to Case 1964-Up.....	1.....	8623437



400, 3L80, 4L80E, 4L85E

ILL#	Part#		QTY	REF#
873	34611	Snap Ring, 400/4L80E Holds Intermediate Clutch Pressure Plate in (.092") 1964-Up	1	8623149
874	34608	Snap Ring, 400/4L80E Holds Retainer to Center Support 1964-Up	1	8623153
877	34609	Snap Ring, 400/4L80E Holds Retainer to Forward Drum 1964-Up	1	8623105
878	34615	Snap Ring, 400/4L80E Holds Forward & Direct Clutch Pressure Plate in 1964-Up	2	8623112
879	34616	Snap Ring, 400/4L80E Holds Direct Clutch Retainer to Drum 1964-Up	1	8623105
880	34614	Snap Ring, 4L80E Holds Turbine Shaft to Overdrive Planet (.040") 1991-Up	1	8675523
880	34614A	Snap Ring, 4L80E Holds Turbine Shaft to Overdrive Planet (.080") 1991-Up	1	TBA
883	34356	Snap Ring, 400/4L80E Center Support to Case (Rear)(.042") 1964-Up	1	8626816
886	34619	Snap Ring, 400 Intermediate Sprag Retainer to Drum 1964-Up	1	8623120
886	34610	Snap Ring, 4L80E Intermediate Sprag Retainer to Drum 1991-Up	1	8675558
887	34620	Snap Ring, 400 Holds Seal to Speed-O Housing 1964-Up	1	TBA
889	34622	Snap Ring, 400/4L80E Holds Rear Ring Gear to Main Shaft 1964-Up	1	8623212
894	34623	Snap Ring, 400/4L80E Holds Output Shaft to Rear Planet 1964-Up	1	8626173
895	34624	Snap Ring, 4L80E Holds Rear Case Seal to Case 1991-Up	1	8675524

SERVOS, ACCUMULATORS & PISTONS

905	K34989	Servo Assembly, 400 Front (With Aluminum Piston) 1964-70	1	TBA
905	K34989A	Servo Assembly, 400/4L80E Front (Fits 1" Wide Band Type) 1971-00	1	24200418
905	K34989EA	Servo Assembly, 4L80E Front (Fits 1.25" Wide Band Type) 2001-Up	1	24223081
906	34946	Spring, 400/4L80E Front Servo 1964-Up	1	8623489
907	34989	Piston, 400/4L80E Front Servo (W/3 tabs) 1965-Up	1	8678537
907	34989-02K	Piston Kit 4L80E Front Servo (Piston, Sleeve, Spring, Seals, Retaining Clips) 1991-Up	1	Sonnax
907	34989E	Piston, 4L80E Front Servo (No tabs) 1994-Up	1	TBA
908	34625	Pin, 400/425 Front Servo 1964-Up	1	8626879
908	34625A	Pin, 4L80E Front Servo (2.535" Long) 1991-98	1	8661808
908	34625B	Pin, 4L80E Front Servo (2.735" Long) 1999-up	1	TBA
910	K34947	Servo Assy, Rear, W/Out Cover 400/4L80E (4.250" Pin, 1-ID Ring) 1964-96	1	TBA
910	K34947A	Servo Assy, Rear, W/Out Cover 400/4L80E (4.278" Pin, 1-ID Ring, 1-ID Band) 1964-96	1	TBA
910	K34947B	Servo Assy, Rear, W/Out Cover 400/4L80E (4.306" Pin, 2-ID Rings) 1964-96	1	TBA
910	K34947C	Servo Assy, Rear, W/Out Cover 400/4L80E (4.334" Pin, No-ID Ring) 1964-96	1	TBA
910	K34947D	Servo Assy, Rear, W/Out Cover 400/4L80E (4.362" Pin, 3-ID Rings) 1964-96	1	TBA
910	K34947E	Servo Assy, Rear, W/Out Cover 400/4L80E (4.387" Pin, 1-ID Ring, 1-ID Band) 1964-96	1	TBA
910	K34947F	Servo Assy, Rear, W/Out Cover 400/4L80E (4.421" Pin, 2-ID Bands) 1964-96	1	TBA
910	K34528	Servo Assy, Rear, W/Out Cover 4L80E (4.695" Pin) 1997-Up	1	TBA
910	K34528C	Servo Assy, Rear, W/Out Cover 4L80E (4.721" Pin) 1997-Up	1	TBA
910	K34528D	Servo Assy, Rear, W/Out Cover 4L80E (4.750" Pin) 1997-Up	1	TBA
910	K34528E	Servo Assy, Rear, W/Out Cover 4L80E (4.777" Pin) 1997-Up	1	TBA
910	K34528F	Servo Assy, Rear, W/Out Cover 4L80E (4.805" Pin) 1997-Up	1	TBA
910	K34528H	Servo Assy, Rear, W/Out Cover 4L80E (4.861" Pin) 1997-Up	1	TBA
910	K34528G	Servo Assy, Rear, W/Out Cover 4L80E (4.866" Pin) 1997-Up	1	TBA
912	34947	Piston, 400 Rear Servo 1964-Up	1	8623666
912	34528	Piston, 4L80E Rear Servo, Flat Piston, 1991-96	1	8624138
912	34528A	Piston, 4L80E Rear Servo Humped Piston, 1997-Up	1	24202985
912	34912AC	Piston, 4L80E Rear Servo Humped Piston, HD Billet Aluminum, 1997-Up (Adapt-A-Case)	1	34912AAC
913	34968	Pin, 400/4L80E Rear Servo (4.250" Long) 1964-Up	1	8624139
913	34968C	Pin, 400/4L80E Rear Servo (4.278" Long) 1964-91	1	8627192
913	34968A	Pin, 400/4L80E Rear Servo (4.306" Long) 2 Ring 1964-Up	1	8624140
913	34968D	Pin, 400/4L80E Rear Servo (4.334" Long) 1964-91	1	8627193
913	34968B	Pin, 400/4L80E Rear Servo (4.362" Long) 3 Ring 1964-Up	1	8624141
913	34968E	Pin, 400/4L80E Rear Servo (4.387" Long) 1964-91	1	8627194
913	34968F	Pin, 400/4L80E Rear Servo (4.421" Long) 1964-91	1	8627195
913	34968G	Pin, 4L80E Rear Servo (4.695" Long, 1-Ring) 1997-Up	1	24202577
913	34968H	Pin, 4L80E Rear Servo (4.721" Long, 2-Rings-1-Thick, 1-Thin) 1997-Up	1	24202580
913	34968J	Pin, 4L80E Rear Servo (4.750" Long, 2-Rings) 1997-Up	1	24202578
913	34968K	Pin, 4L80E Rear Servo (4.770" Long, No-Rings) 1997-Up	1	24202581
913	34968L	Pin, 4L80E Rear Servo (4.805" Long, 3-Rings) 1997-Up	1	24202579
913	34968N	Pin, 4L80E Rear Servo (4.861" Long, 2-Thick Rings) 1997-Up	1	24202582
913	34968M	Pin, 4L80E Rear Servo (4.866" Long, 2-Thick Rings) 1997-Up	1	24202583
914	34643AA	Cover, 400 Rear Servo 1964-Up	1	TBA
914	34643	Cover, 4L80E Rear Servo 1991-96	1	8676600
914	34643A	Cover, 4L80E Rear Servo 1997-Up	1	TBA
925	K34105A	Accumulator Assembly, 400 (Late, No Legs on piston)	1	TBA
925	K34105	Accumulator Assembly, 400 (Early, W/3 Legs on piston)	1	TBA
925	34989A	Accumulator Assembly, 400 (Upgrade Service Package W/Seals) 1991-96	1	8680929
926	34945	Spring, 400 Front Accumulator (Yellow) 1967-98	1	8625426
926	34945B	Spring, 400 Front Accumulator (Red)	1	8623654
926	34945A	Spring, 400 Front Accumulator (Blue)	1	8626775
927	34105	Piston, 400 Front Accumulator (Aluminum W/3 Legs) 1965-98	1	8626883

400, 3L80, 4L80E, 4L85E

ILL#	Part#		QTY	REF#
930.....	K34107.....	Accum Assy, 4L80E 3rd/4th (1-Tower Type W/Out The Torque Signal Compensator Valve)	1.....	TBA
930.....	K34107A.....	Accum Assy, 4L80E 3rd/4th (2-Tower Type With The Torque Signal Compensator Valve)	1.....	TBA
931.....	34806.....	Spring, 4L80E 3rd Clutch Accumulator Piston 1991-Up	1.....	8675596
932.....	34108.....	Piston, 4L80E 3rd Clutch Accumulator 1991-Up	1.....	8683088
933.....	34105-01K.....	Pin Kit, 400/4L80E Accumulator (Oversized)(Sonnax).....	1.....	34105-01K
933.....	34105-02K.....	Pin & Reamer Kit, 400/4L80E Accumulator (Oversized)(Sonnax).....	1.....	34105-02K
934.....	34995.....	Cover, 4L80E 2-3 & 3-4 Accumulator 1991-93	1.....	8689993
934.....	34995A.....	Cover, 4L80E 2-3 & 3-4 Accumulator 1994-Up	1.....	8684220
936.....	34805.....	Spring, 4L80E 4th Clutch Accumulator Piston 1991-Up	1.....	8675634
937.....	34107.....	Piston, 4L80E 4th Clutch Accumulator (Piston, Pin, Seals & Clip) 1991-Up	1.....	24206749
937.....	34805-01K.....	Repair Kit, 4L80E 4th Accumulator (Piston, Sleeve, Spring, Seals) No Machining (Sonnax)	1.....	34805-01K
938.....	34644.....	Pin, 4L80E 4th Clutch Accumulator 1991-Up	1.....	8661644
941.....	34645.....	Spring, 4L80E Torque Signal Compensator 1991-Up	1.....	8675603
942.....	34106.....	Valve, 4L80E Torque Signal Compensator (Spool Valve) 1991-Up	1.....	8661828
946.....	34706.....	Spring, 400/4L80E Rear Servo Accumulator (Blue) 1967-98	1.....	8624526
946.....	34706A.....	Spring, 400/4L80E Rear Servo Accumulator (Yellow) (Heavy Duty) 1968-98	1.....	8624391
946.....	34706B.....	Spring, 400/4L80E Rear Servo (Black)	1.....	8670753
946.....	34706C.....	Spring, 400/4L80E Rear Servo (Green/Orange or Violet)	1.....	8675778
947.....	34989.....	Piston, 4L80E Rear Accumulator 1991-Up	1.....	8680929
958.....	34646.....	Tin Spacer, 400/4L80E Front Pump to Sprag	1.....	TBA
960.....	34967.....	Piston, 4L80E Overrun Clutch (Bonded) 1991-Up	1.....	8661567
961.....	34807.....	Piston, 4L80E 4th Clutch 1991-Up	1.....	8661271
962.....	34810.....	Piston, 400 Intermediate Clutch (Aluminum) # 142	1.....	TBA
962.....	34810A.....	Piston, 400 Intermediate Clutch (Steel)	1.....	TBA
962.....	34810EA.....	Piston, 4L80E Intermediate Clutch #757 / #553?? 1991-96	1.....	TBA
962.....	34810EB.....	Piston, 4L80E Intermediate Clutch #657 1997-Up	1.....	TBA
964.....	34819A.....	Piston, 400 Forward (4-Clu) (Alum, No Check Ball) #402	1.....	TBA
964.....	34819.....	Piston, 400 Forward (5-Clu) (Alum, No Check Ball) #401/709	1.....	8670199
964.....	34832AA.....	Piston, 400 Forward (5-Clu) (Alum, No Check Ball) #391/501/205	1.....	TBA
964.....	34809.....	Piston, 400/425 Fwd (6-Clu) (Alum, No Check Ball) #204	1.....	TBA
964.....	34832A.....	Piston, 400/425 Forward (Steel-Type).....	1.....	TBA
964.....	34808.....	Piston, 4L80E Forward (Alum) 1991-96	1.....	8675508
964.....	34808A.....	Piston, 4L80E Forward Clutch (Bonded) 1997-Up	1.....	24204957
965.....	34832AD.....	Piston, 400 Direct (4-Clu) (Alum, W/Check Ball) #402	1.....	TBA
965.....	34832AF.....	Piston, 400 Direct (4-Clu) (Alum, No Check Ball) #557	1.....	TBA
965.....	34832AC.....	Piston, 400 Direct (5-Clu) (Alum, W/Check Ball) #099/709	1.....	TBA
965.....	34832AA.....	Piston, 400 Direct (5-Clu) (Alum, No Check Ball) #205/391/501	1.....	TBA
965.....	34832AE.....	Piston, 400 Direct (5-Clu) (Alum, W/Check Ball) #391/501	1.....	TBA
965.....	34809.....	Piston, 400/425 Direct (6-Clu) (Alum, No Check Ball) #204	1.....	TBA
965.....	34832AB.....	Piston, 400/425 Direct (6-Clu) (Alum, W/Check Ball) #204	1.....	TBA
965.....	34832A.....	Piston, 400/425 Direct (Steel-Type).....	1.....	TBA
965.....	34808B.....	Piston, 4L80E Direct (Alum) #510, 1991-96	1.....	TBA
965.....	34809A.....	Piston, 4L80E Direct (Bonded) 1997-Up	1.....	24204961
970.....	34969.....	Retainer W/Spring, 4L80E Overrun Clutch Return 1991-00	1.....	8661629
970.....	34969A.....	Retainer W/Spring, 4L80E Overrun Clutch Return 2001-Up	1.....	24216366
971.....	34878.....	Retainer W/Spring, 4L80E 4th Clutch Return 1991-Up	1.....	8661577
972.....	34888.....	Retainer W/Spring, 4L80E Intermediate Clutch Return 1991-Up	1.....	8675518
974.....	8624101.....	Spring, 400 Forward & Direct Clutch Return 1964-Up	16.....	8624101
974.....	34840.....	Retainer W/Spring, 4L80E Forward & Direct Clutch Return 1991-Up	1.....	8661764
975.....	8624101.....	Spring, 400 Direct Clutch Return 1964-Up (Use 8624101)	16.....	8624101
975.....	34840.....	Retainer W/Spring, 4L80E Direct Clutch Return 1991-Up (Use 34840)	1.....	8661764
980.....	34647.....	Stop Ring, 400/4L80E Rear, Low Sprag To Front Planet, 1964-95	1.....	TBA
982.....	34762.....	Retainer, 400/4L80E Intermediate Return Spring 1964-Up	1.....	8679935
984.....	34763.....	Retainer, 400/4L80E Forward Return Spring 1964-Up	1.....	TBA
985.....	34764.....	Retainer, 400/4L80E Direct Return Spring 1964-Up	1.....	TBA

LINKAGE & MISCELLANEOUS COMPONENTS

991.....	K34814.....	Linkage Assembly, 400 Internal (O-Ring Type) 1964	1.....	TBA
991.....	K34814A.....	Linkage Assembly, 400 Internal (Seal Type) 1965-Up	1.....	TBA
991.....	K34814E.....	Linkage Assembly, 4L80E Internal 1991-95	1.....	TBA
991.....	K34814EA.....	Linkage Assembly, 4L80E Internal 1996-Up	1.....	TBA
991-1.....	34631.....	Lever, 400 Manual Detent Spring 1964-Up	1.....	8625773
991-4.....	34632.....	Shaft, 400 Manual Lever 1964-Up	1.....	8679990
991-4.....	34632E.....	Shaft, 4L80E Manual Lever 1991-94	1.....	TBA
991-4.....	34632EA.....	Shaft, 4L80E Manual Lever 1995-Up	1.....	TBA
992.....	34633.....	Shift Lever, 400 External (Column Shift) 1964-Up	1.....	TBA
992.....	34633E.....	Shaft, 4L80E Manual Lever, 4L80E, 1991-Up	1.....	TBA
994.....	34626A.....	Park Rod, 400, 1964-Up	1.....	TBA



400, 3L80, 4L80E, 4L85E

ILL#	Part#		QTY	REF#
994.....	34626.....	Actuator Rod, 4L80E Park Pawl (Updated).....	1.....	24200173
995.....	K34627.....	Park Pawl Assembly, 400 1964-Up.....	1.....	TBA
995.....	K34627A.....	Park Pawl Assembly, 4L80E 1991-Up.....	1.....	TBA
995.....	34628.....	Lever, 400 Park Pawl 1964-Up.....	1.....	8623037
995.....	34627A.....	Park Pawl Lock, 4L80E (Updated).....	1.....	8661693
995.....	34629.....	Pin, 4L80E Park Pawl Pivot Pin 1991-Up.....	1.....	TBA
995.....	34630.....	Spring, 400 Park Pawl 1964-Up.....	1.....	TBA
995.....	34630A.....	Spring, 4L80E Park Pawl Return (1st Design).....	1.....	TBA
995.....	34630B.....	Spring, 4L80E Park Pawl Return (2nd Design).....	1.....	TBA
995.....	34634.....	Park Pawl Stud, 4L80E (Rivet) 1991-93.....	1.....	TBA
996.....	34280.....	Fitting, 400 Cooler Line (3/8" Lines)(W/Pipe Threads) 1964-77.....	2.....	TBA
996.....	34280B.....	Fitting, 350/400 Cooler Line (5/16" Lines)(W/Pipe Threads) 350-1969-77 / 400-1964-77.....	2.....	TBA
996.....	34280C.....	Fitting, 350/400/4L80E Cooler Line (5/16" Lines)(W/Machine Threads) 400/4L80-1978-96.....	2.....	TBA
996.....	34280D.....	Fitting, 4L80E Cooler Line (Screw-In)(W/Machine Threads) 1997-98.....	1.....	TBA
996.....	34280E.....	Fitting, 4L80E Rear Cooler Line (Push-In Type) 1999-Up.....	1.....	24233367
996.....	34280A.....	Fitting, 4L80E Front Cooler Line (Push-In Type) (Teckpak) 1997-Up.....	1.....	31284
996.....	34281A.....	Fitting, 4L80E Rear Cooler Line (Push-In Type) (Teckpak) 1997-Up.....	1.....	31285
996.....	34281R.....	Fitting, 4L80E Rear Screw-In Repair, Cooler Line, Center (Teckpak) 1997-Up.....	1.....	31285G
996.....	34918-01K.....	Cooler Line Conversion Kit, 4L80E (Converts Late Cases To The Early Style) (Sonnax).....	1.....	34918-01K
999.....	K34635.....	Oil Tube Set, 400 Valve Body to Case 1964-Up.....	1.....	8679342
999.....	34635E.....	Oil Tube, 4L80E Valve Body to Case (2wd) 1991-Up.....	1.....	TBA
999.....	34636.....	Bracket, 4L80E Holds Oil Tubes on 1997-Up.....	1.....	TBA
999.....	34637.....	Oil Tube, 4L80E Valve Body to Case (4X4) 1991-Up.....	1.....	TBA



OE FILTERTEK™ FILTER

Filtertek™ is recognized for manufacturing 100% sealed, **never-leak** transmission filters that remain leak-free for the life of the filter. Through its alliance with Filtertek™, Allomatic is the aftermarket distributor of these high-quality, all-plastic injection molded filters. Filtertek™ provides OE filtration for automotive, truck and commercial vehicle systems, from powertrain to power steering, braking to suspension and hydraulics for many domestic and import manufacturers. Quality is assured by Filtertek's™ QS 9000 certification.

- ADVANTAGES**
- Patented 100% sealed never-leak filters
 - Vibration welded seam for maximum strength
 - OE media filtering to 60 microns
 - High-strength heat resistant plastic with 33% glass content
 - Impact resistant
 - Premium filter media offers maximum debris protection
 - Recyclable

