

6T30, 6T40, 6T45, 6F35

GM

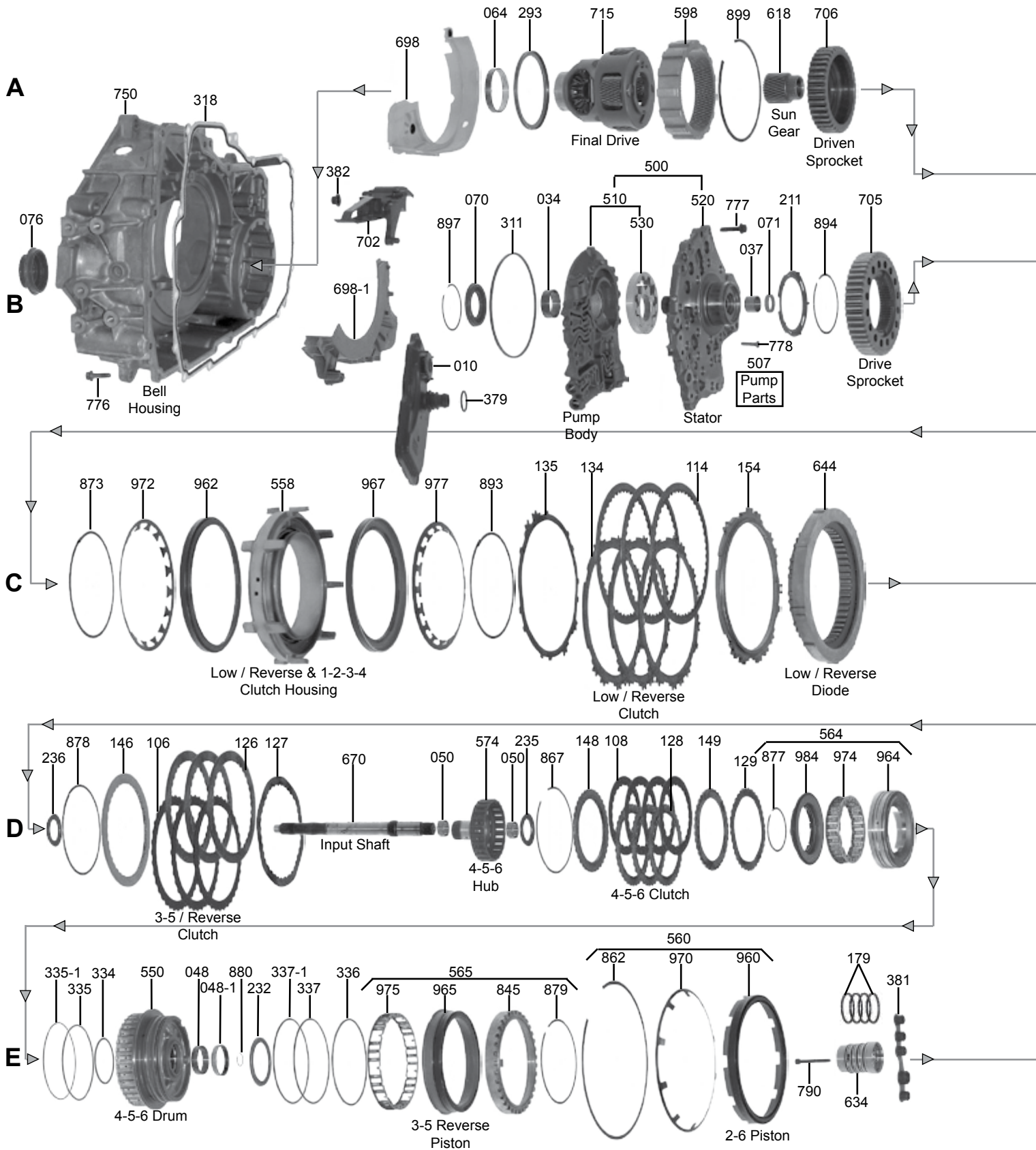

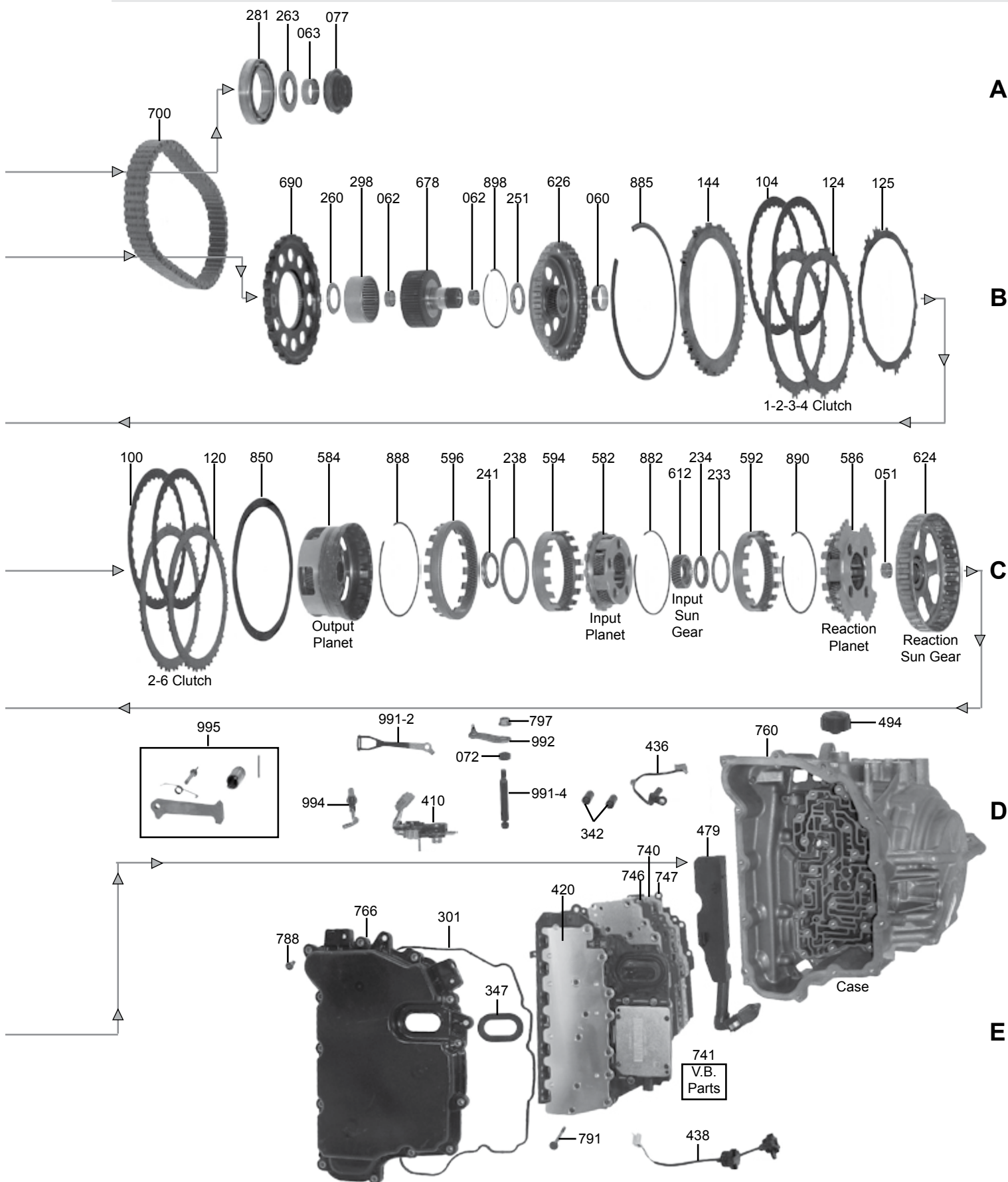



6T30, 6T40, 6T45, 6F35

ILL#	Part#		QTY	REF#
OVERHAUL KITS & PISTON KITS				
NI.....	K118900GX.....	Overhaul Kit, GM 6T40/45 W/Out Pistons 2008-Up	1	N/A
NI.....	K118900GAX	Overhaul Kit, GM 6T30 W/Out Pistons 2009-Up	1	N/A
NI.....	K118900FX	Overhaul Kit, Ford 6F35 W/Out Pistons 2009-Up	1	N/A
NI.....	K118900G-99.....	Bonded Piston, Kit, GM 6T40/45, 2008-Up	1	N/A
NI.....	K118900GA-99.....	Bonded Piston, Kit, GM 6T30, 2009-Up	1	N/A
NI.....	K118900F-99.....	Bonded Piston, Kit, Ford 6F35, 2009-Up	1	N/A
MASTER L/STEEL KITS				
NI.....	DK11800GXS.....	MASTER L/STEELS Kit, GM 6T40/45 W/Out Pistons 2008-Up	1	N/A
NI.....	DK11800GAXS	MASTER L/STEELS Kit, GM 6T30 W/Out Pistons 2009-Up	1	N/A
NI.....	DK11800FXS	MASTER L/STEELS Kit, Ford 6F35 W/Out Pistons 2009-Up	1	N/A
MASTER W/STEELS KITS				
NI.....	DK11800GX	MASTER W/STEELS Kit, GM 6T40/45 W/Out Pistons 2008-Up	1	N/A
NI.....	DK11800GAX	MASTER L/STEELS Kit, GM 6T30 W/Out Pistons 2009-Up	1	N/A
NI.....	DK11800FX	MASTER W/STEELS Kit, Ford 6F35 W/Out Pistons 2009-Up	1	N/A
FILTERS				
010.....	118710G.....	Filter, 6T40/45, 2008-Up	1	24230708
010.....	118710GA.....	Filter, 6T30, 2009-Up	1	TBA
010.....	118710F.....	Filter, 6F35, 2009-Up	1	9L8Z-7A098-B
NI.....	118711.....	Screen, 6T40 Solenoid To Valve Body (Plastic Beaded) 2008-Up	1	24242274
BUSHINGS				
034.....	118005.....	Bushing, 6T30/6T40/45 Pump Body (.700" Wide)(1.560" ID) 2008-Up	1	TBA
034.....	118005.....	Bushing, 6F35 Pump Body 2009-Up	1	TBA
037.....	118002G.....	Bushing, 6T40 Stator (Rear) (.755" Wide)(.792" ID) 2008-Up	1	TBA
037.....	118002F.....	Bushing, 6F35 Stator (Rear) (.829" Wide)(.792" ID) 2009-Up	1	TBA
048-1	118003.....	Bushing, 6T40/6F35 4-5-6 Clutch Drum (Rear)(.324" Wide)(.841" ID) 2008-Up	1	TBA
048.....	118004G.....	Bushing, 6T40 4-5-6 Clutch Drum (Front)(.415" Wide)(1.637" ID) 2008-Up	1	TBA
048.....	118004F.....	Bushing, 6F35 4-5-6 Clutch Drum (Front)(.360" Wide)(1.637" ID) 2009-Up	1	TBA
050.....	118006.....	Bushing, 6T40/6F35 4-5-6 Clutch Hub (.302" Wide)(.824" ID) 2008-Up	2	TBA
051.....	118007.....	Bushing, 6T40/6F35 Reaction Sun Gear (.553" Wide)(1.184" ID) 2008-Up	1	TBA
060.....	118008G.....	Bushing, 6T40 Output Planet Sun Gear (.545" Wide)(1.365" ID) 2008-Up	1	TBA
060.....	118008F.....	Bushing, 6F35 Output Planet Sun Gear (.558" Wide)(1.635" ID) 2009-Up	1	TBA
062.....	118009.....	Bushing, 6T40/6F35 Drive Sprocket Hub (.377" Wide)(.794" ID) 2008-Up	2	TBA
063.....	118010G.....	Bushing, 6T40 Axle To Case (.625" Wide)(1.384" ID) 2008-Up	1	TBA
063.....	118010F.....	Bushing, 6F35 Axle To Case (.615" Wide)(1.378" ID) 2009-Up	1	TBA
063.....	118010.....	Bushing, 6F35/6T40 Axle To Case (Teflon Coated, Reduces Wear, More Support & Lube) 09-Up	1	204200
NI.....	K0100.....	Kit, 6F35/6T40 Axle Bushing/Axle Seal (3-Pc Tool Kit, 5-Teflon Bushings, 5-Axle Seals) 2008-Up	1	Superior
NI.....	K099.....	Kit, Refill 6F35/6T40 Axle Bushing/Axle Seal (1-Teflon Bushing, 1-Axle Seal) 2008-Up	1	Superior
064.....	118011G.....	Bushing, 6T40 Bell Housing To Differential (.420" Wide)(2.552" ID) 2008-Up	1	TBA
064.....	118011F.....	Bushing, 6F35 Bell Housing To Differential (.450" Wide)(3.744" ID) 2009-Up	1	TBA
METAL CLAD SEALS				
070.....	118151G.....	Seal, 6T30/6T40 Pump (.300" Thick)(W/Short Flange) 2008-Up	1	24230691
070.....	118151F.....	Seal, 6F35 Pump (.350" Thick)(W/Long Flange) 2009-Up	1	9L8Z-7A248-D
071.....	118156.....	Seal, 6T30/6T40/6F35 Pump Stator To Input Shaft (In Stator, Rear) 2008-Up	1	9L8Z-7048-AB
071.....	118156A.....	Seal, 6T30 Pump Stator To Input Shaft (In Stator, Rear) 2009-Up	1	TBA
072.....	84511.....	Seal, 6T40/6F35 Manual Shaft (.765" OD) 2008-Up	1	8614709
072.....	118155.....	Seal, 6T30 Manual Shaft, 2009-Up	1	TBA
076.....	118154G.....	Seal, 6T30/6T40 Axle Right (Bell Hsg Side) 2008-Up	1	24230682
076.....	118154F.....	Seal, 6F35 Axle Right FWD (Bell Hsg Side) 2009-Up	1	9L8Z-1177-BA
076.....	118154FA.....	Seal, 6F35 Axle Right AWD (Bell Hsg Side) 2009-Up	1	9L8Z-1177-C
077.....	118153.....	Seal, 6T30/6T40 Axle Left (Case Side) 2008-Up	1	24230715
077.....	118153.....	Seal, 6F35 Axle Left (Case Side) 2009-Up	1	9L8Z-1177-A
FRICTIONS				
100.....	118101G.....	Friction, 6T40 2-6 Clutch (.058")(36 Teeth)(8.562" OD)(Smooth) 2008-Up	2	24248898
100.....	118101GA.....	Friction, 6T30 2-6 Clutch (.062")(30 Teeth)(7.721" OD)(Waved) 2012-Up	2	24261226
100.....	118101F.....	Friction, 6F35 2-6 Clutch (.073")(36 Teeth)(8.562" OD)(Grooved) 2009-Up	2	9L8Z-7B164-B
104.....	118101G.....	Friction, 6T40 1-2-3-4 Clutch (.058")(36 Teeth)(8.562" OD)(Smooth) 2008-Up	2	24248898
104.....	118101GB.....	Friction, 6T30 1-2-3-4 Clutch (.058")(36 Teeth)(7.721" OD)(Waved) 2012-Up	2	24261227
104.....	118101F.....	Friction, 6F35 1-2-3-4 Clutch (.073")(36 Teeth)(8.562" OD)(Grooved) 2009-Up	2	9L8Z-7B164-B
106.....	118107G.....	Friction, 6T40 3-5 Reverse Clutch (.063")(36 External Teeth)(5.710" ID)(Smooth) 2008-Up	3	24247997
106.....	118107GA.....	Friction, 6T30 3-5 Reverse Clutch (.063")(30 External Teeth)(6.403" OD)(Waved) 2012-Up	3	24261225
106.....	118107F.....	Friction, 6F35 3-5 Reverse Clutch (.063")(36 External Teeth)(5.710" ID)(Grooved) 2009-Up	3	9L8Z-7B164-C

6T30, 6T40, 6T45, 6F35

ILL#	Part#		QTY	REF#
108.....	118105G.....	Friction, 6T40 4-5-6 Clutch (.063") (24 Teeth) (4.800" OD) (24 Clutch Lining Segments) 2008-Up	4	24250754
108.....	118105GA.....	Friction, 6T30 4-5-6 Clutch (.063") (24 Teeth) (4.334" OD) (Waved) 2012-Up	4	24261228
108.....	118105F.....	Friction, 6F35 4-5-6 Clutch (.061") (24 Teeth) (4.800" OD) (32 Clutch Lining Segments) 2009-Up	5	9L8Z-7B164-D
114.....	118103G.....	Friction, 6T40 Low/Reverse Clutch (.065") (48 Teeth) (8.500" OD) (W/Grooves) 2008-Up	3	24231257
114.....	118103GA.....	Friction, 6T30 Low/Reverse Clutch (.065") (48 Teeth) (7.641" OD) (Waved) 2012-Up	3	24261224
114.....	118103F.....	Friction, 6F35 Low/Reverse Clutch (.061") (48 Teeth) (8.562" OD) (W/Segments) 2009-Up	3	9L8Z-7B164-A
NI.....	K118GF.....	Friction Module, 6T40 2008-Up.....	1	RCP96-246
NI.....	K118GAF.....	Friction Module, 6T30 2012-Up.....	1	RCP96-280
NI.....	K118FF.....	Friction Module, 6F35 2009-Up.....	1	TBA
STEELS				
120.....	118104G.....	Steel, 6T40 2-6 Clutch (.114") (15 Teeth) (7 3/8" ID) 2008-Up	2	24230731
120.....	118104F.....	Steel, 6F35 2-6 Clutch (.132") (15 Teeth) (7 3/8" ID) 2009-Up	2	9L8Z-7B442-B
124.....	118100G.....	Steel, 6T40 1-2-3-4 Clutch (.067") (12 Teeth W/Half Moon Notches) (7 3/8" ID) 2008-Up	2	24231263
125.....	118100GA.....	Steel, 6T40 Waved, 1-2-3-4 Clutch (.035") (4 Teeth W/Half Moon Notches) (7 1/2" ID) 2008-Up.....	1	24230818
124.....	118100F.....	Steel, 6F35 1-2-3-4 Clutch (.067") (11 Teeth W/Half Moon Notches) (7 3/8" ID) 2009-Up	2	9L8Z-7B442-A
125.....	118100FA.....	Steel, 6F35 Waved, 1-2-3-4 Clutch (.035") (4T W/Half Moon Notches & 1 Square Tooth) (7-1/2" ID)	1	9L8Z-7B070-F
126.....	118108G.....	Steel, 6T40 3-5 Reverse Clutch (.114") (36 Internal Teeth) (6 3/4" OD) 2008-Up	3	24230758
127.....	118110GA.....	Steel, 6T40 Waved, 3-5 Reverse Clutch (.035") (36 Internal Teeth) (6 11/16" OD) 2008-Up	1	24230757
126.....	118108F.....	Steel, 6F35 3-5 Reverse Clutch (.133") (24 Internal Teeth) (6 3/4" OD) 2009-Up	3	9L8Z-7B442-D
127.....	118110F.....	Steel, 6F35 Waved, 3-5 Reverse Clutch (.035") (24 Internal Teeth) (6 3/4" OD) 2009-Up	1	9L8Z-7B070-E
128.....	118106G.....	Steel, 6T40 4-5-6 Clutch (.067") (36 Teeth) (3.780" ID) 2008-Up	3	24231255
129.....	118106GA.....	Steel, 6T40 Waved, 4-5-6 Clutch (.113") (36 Teeth) (3.780" ID) 2008-Up	1	24230753
128.....	118106F.....	Steel, 6F35 4-5-6 Clutch (.067") (24 Teeth) (3.777" ID) 2009-Up	5	9L8Z-7B442-E
134.....	118102G.....	Steel, 6T40 Low/Reverse Clutch (.067") (12 Teeth W/Half Moon Notches) (7 9/16" ID) 2008-Up	3	24231258
135.....	118102GA.....	Steel, 6T40 Waved, Low/Reverse Clutch (.075") (4 Teeth W/Half Moon Notches) (7 3/4" ID)	1	24230812
134.....	118102F.....	Steel, 6F35 Low/Reverse Clutch (.067") (12 Teeth With V Notches) (7 9/16" ID) 2009-Up	3	9L8Z-7B442-C
135.....	118102FA.....	Steel, 6F35 Waved, Low/Reverse Clutch (.038") (5 Teeth W/V Notches) (7 9/16" ID) 2009-Up	1	9L8Z-7E085-C
NI.....	K118GS.....	Steel Module, 6T40 2008-Up.....	1	TBA
NI.....	K118FS.....	Steel Module, 6F35 2009-Up.....	1	TBA
PRESSURE PLATES				
144.....	118131.....	Press Plate, 6T40/6F35 1-2-3-4 Clu (.315") (18T W/Half Moon Notches) (7 3/8" ID) 2008-Up.....	1	24230820
146.....	118132G.....	Pressure Plate, 6T40 3-5 Reverse Clutch (.121") (36 Internal Teeth) (6 3/4" OD) 2008-Up.....	1	24253297
146.....	118132F.....	Pressure Plate, 6F35 3-5 Reverse Clutch (.137") (24 Internal Teeth) (6 3/4" OD) 2009-Up.....	1	TBA
148.....	118133G.....	Pressure Plate, 6T40 4-5-6 Clutch (.120") (36 Teeth) (3.782" ID) 2008-Up	1	24230755
148.....	118133F.....	Pressure Plate, 6F35 4-5-6 Clutch (.103") (24 Teeth) (3.779" ID) 2009-Up.....	1	9L8Z-7B066-C
149.....	118134G.....	Apply Plate, 6T40 4-5-6 Clutch (.114") (36 Teeth) (3.782" ID) 2008-Up	1	24233864
154.....	118135G.....	Pressure Plate, 6T40 Low/Reverse Clutch (.216") (12 Teeth) (7 9/16" ID) 2008-Up	1	24232635
154.....	118135F.....	Pressure Plate, 6F35 Low/Reverse Clutch (.205") (12 Teeth) (7 9/16" ID) 2009-Up	1	9L8Z-7B066-A
SEALING RINGS				
NI.....	K118903.....	Ring Kit, 6T40/6F35, 2009-Up.....	1	TBA
179.....	118301.....	Ring, 6T40/6F35 2-6 Support/3-5 Rev & 4-5-6 Clu (.093" Thk 1.770" OD) (Solid Teflon) 09-Up	4	TBA
WASHERS & BEARINGS				
211.....	118401G.....	Washer, 6T40 Stator To Drive Sprocket (Black Plastic W/5 Tabs) (4.044" OD) 2008-Up	1	24234072
211.....	118401F.....	Washer, 6F35 Stator To Drive Sprocket (Black Plastic W/3 Tabs) (Cast # 9L8P-7G099-BA) 2009-Up	1	9L8Z-7G099-A
232.....	118411.....	Bearing, 6T40/6F35 4-5-6 Clutch Drum To Case (.149" Thick) (2.960" OD) (2.315" ID)	1	24231205
233.....	118412G.....	Bearing, 6T40 Input Planet To Reaction Planet (.115" Thick) (2.610" OD) (2.072" ID) W/ Inner Shoulder.....	1	24230782
233.....	118412F.....	Bearing, 6F35 Input Planet To Reaction Planet (.119" Thick) (2.602" OD) (2.078" ID) No Shoulder.....	1	9L8Z-7G177-A
234.....	118413G.....	Bearing, 6T40 Input Sun Gear To Reaction Planet (.137" Thick) (2.055" OD) (1.409" ID)	1	24230783
234.....	118413F.....	Bearing, 6F35 Input Sun Gear To Reaction Planet (.157" Thick) (2.021" OD) (1.344" ID)	1	9L8Z-7C096-D
235.....	118414G.....	Bearing, 6T40 4-5-6 Clutch Hub To 4-5-6 Clutch Drum (.149" Thick) (1.959" OD) (1.257" ID)	1-2	24230762
235.....	118414F.....	Bearing, 6F35 4-5-6 Clutch Hub To 4-5-6 Clutch Drum (.151" Thick) (1.964" OD) (1.266" ID)	1-2	9L8Z-7F242-A
236.....	118414G.....	Bearing, 6T40 4-5-6 Clutch Hub To Reaction Sun Gear	1	24230762
236.....	118414F.....	Bearing, 6F35 4-5-6 Clutch Hub To Reaction Sun Gear	1	9L8Z-7F242-A
238.....	118415G.....	Bearing, 6T40 Output Planet To Input Planet (.137" Thick) (4.166" OD) (3.353" ID)	1	24230795
238.....	118415F.....	Bearing, 6F35 Output Planet To Input Planet (.137" Thick) (4.244" OD) (3.445" ID)	1	9L8Z-7C096-A
241.....	118416G.....	Bearing, 6T40 Output Planet To Input Sun Gear (.260" Thick W/Shoulder) (1.581" ID)	1	24260431
241.....	118416F.....	Bearing, 6F35 Output Planet To Input Sun Gear (.210" Thick W/Shoulder) (1.581" ID)	1	9L8Z-7C096-B
251.....	118417G.....	Bearing, 6T40 Drive Sprocket Hub To Output Sun Gear (.154" Thick) (2.018" OD) (1.382" ID)	1	24237665
251.....	118417F.....	Bearing, 6F35 Drive Sprocket Hub To Output Sun Gear (.138" Thick) (2.021" OD) (1.430" ID)	1	9L8Z-7D234-A
260.....	118418G.....	Bearing, 6T40 Stator To Drive Sprocket Hub (.148" Thick) (1.958" OD) (1.256" ID)	1	24230762
260.....	118418F.....	Bearing, 6F35 Stator To Drive Sprocket Hub (.150" Thick) (1.964" OD) (1.266" ID)	1	9L8Z-7D234-B
263.....	118419G.....	Bearing, 6T40 Driven Sprocket To Case (.193" Thick) (2.628" OD) (1.575" ID) 2008-Up	1	24237523
263.....	118419F.....	Bearing, 6F35 Driven Sprocket To Case (.190" Thick) (2.628" OD) (1.613" ID) 2009-Up	1	9L8Z-7G355-A
281.....	118421.....	Ball Brg, 6T40/6F35 Driven Sprocket (Inner) (.746" Thick) (4.131" OD) (2.755" ID) (#F-845910)	1	TBA



6T30, 6T40, 6T45, 6F35

ILL#	Part#		QTY	REF#
293.....	118422G.....	Bearing, 6T40 Bell Housing To Differential (.300" W/Shoulder)(4.798" OD)(4.113" ID).....	1.....	TBA
293.....	118422F.....	Bearing, 6F35 Bell Housing To Differential (.150" Thick)(2.806" OD)(2.174" ID) 2009-Up.....	1.....	9L8Z-7G112-A
298.....	118423G.....	Caged Needle Bearing, 6T40 Drive Sprocket Hub (.970" Wide)(3.010" OD)(#24231457).....	1.....	TBA
298.....	118423F.....	Caged Needle Bearing, 6F35 Drive Sprocket Hub (.975" Wide)(3.010" OD)(#F-39344Z02).....	1.....	TBA

GASKETS & RUBBER COMPONENTS

301.....	118500G.....	Gasket, 6T40/45 Side Pan (Molded Rubber) 2008-Up.....	1.....	24234281
301.....	118500GA.....	Gasket, 6T30 Side Pan (Molded Rubber) 2009-Up.....	1.....	TBA
301.....	118500F.....	Gasket, 6F35 Side Pan (Molded Rubber) 2009-Up.....	1.....	TBA
311.....	118211.....	LC Seal (Pump O-Ring) 6F35/6T40, 2009-Up.....	1.....	TBA
318.....	118501G.....	Gasket, 6T40/45 Bell Housing To Case (15 Bolt)(Metal W/Bonded Rubber) 2008-Up.....	1.....	24235140
318.....	118501GA.....	Gasket, 6T30 Bell Housing To Case (16 Bolt)(Metal W/Bonded Rubber) 2009-Up.....	1.....	24231613
379.....	118213G.....	O-Ring, Filter, 6T40, 2008-Up.....	1.....	TBA
379.....	73513.....	O-Ring, Filter, 6F35, 2009-Up.....	1.....	F3RZ-7H223-A
NI.....	118526G.....	Gasket, 6T40, Valve Body, Upper (Upper) 2008-Up.....	1.....	TBA
NI.....	118526GA.....	Gasket, 6T40, Valve Body, Upper (Lower) 2008-Up.....	1.....	TBA
NI.....	118527G.....	Gasket, 6T40, Valve Body, Lower (Upper) 2008-Up.....	1.....	TBA
NI.....	118527GA.....	Gasket, 6T40, Valve Body, Lower (Lower) 2008-Up.....	1.....	TBA
NI.....	118526F.....	Gasket, 6F35, Valve Body, Upper (Upper) 2009-Up.....	1.....	TBA
NI.....	118526FA.....	Gasket, 6F35, Valve Body, Upper (Lower) 2009-Up.....	1.....	TBA
NI.....	118527F.....	Gasket, 6F35, Valve Body, Lower (Upper) 2009-Up.....	1.....	TBA
NI.....	118527FA.....	Gasket, 6F35, Valve Body, Lower (Lower) 2009-Up.....	1.....	TBA
746.....	K118752G.....	Separator Plate, 6T40 (W/Bonded Gaskets) VB To Alum Housing.....	1.....	TBA
746.....	K118752F.....	Separator Plate, 6F35 (W/Bonded Gaskets) VB To Solenoid Plate (#BW28000032 MA).....	1.....	9L8Z-7Z490-A
747.....	K118752GA.....	Separator Plate, 6T40 (W/Bonded Gaskets) VB To Case.....	1.....	TBA
747.....	K118752FA.....	Separator Plate, 6F35 (W/Bonded Gaskets) VB To Case (Cast #9L8P-7J236-AC).....	1.....	9L8Z-7Z490-B

ELECTRICAL COMPONENTS

410.....	118991G.....	Switch, 6T40 MLPS W/Roost Comb (6-Wire Harn & 6-Pin Female Conn)(#0719) 2008-Up.....	1.....	24230719
410.....	118991F.....	Switch, 6F35 MLPS W/Rooster Comb (W/3 Prong Conn)(Cast # C1080) 2009-Up.....	1.....	9L8Z-7H557-A
420.....	118949GA.....	Solenoid Module, 6T40/6T45 (RPO Code: MH7/MH8) (GM TECHM, OEM) 2008-10.....	1.....	24256523
420.....	118949G.....	Solenoid Module, 6T30/40/45 (RPO Code: MH7/MH8/MH9/MH/MHK/MHJ/MCH) (TECHM, OE) 10-12.....	1.....	24256524
420.....	118949GB.....	Solenoid Module, 6T30/40/45 (RPO Code: MH8) (GM TECHM, OEM) 2012-14.....	1.....	24265367
420.....	118949GC.....	Solenoid Module, 6T30/40/45 (RPO Code: MH7/MH8/MH9/MHB/MHH/MHK) (GM TECHM, OEM) 2014.....	1.....	24267723
420.....	118949GD.....	Solenoid Module, 6T30/40/45 (RPO Code: MH7/MNH) (GM TECHM, OEM) 2014.....	1.....	24267724
420.....	118949F.....	Solenoid Assembly, 6F35 2009-Up.....	1.....	AL8Z-7G391-A
420.....	118949FA.....	Solenoid Assembly, 6F35 (7 Solenoid In Top Alum Housing Of VB)(Cast #9L8P-7A092-CA).....	1.....	9L8Z-7G391-A
436.....	118958G.....	Sensor, 6T40 Output Speed (W/2 Wire Harness W/2 Prong Female Conn) 2008-Up.....	1.....	24259852
436.....	118958F.....	Sensor, 6F35 Output Speed (W/3 Wire Harness W/4 Prong Female Conn) 2009-Up.....	1.....	9L8Z-7H103-B
438.....	118954G.....	Sensor, 6T40 Input Speed (W/2 Wire Harness W/2 Prong Female Conn) 2008-Up.....	1.....	TBA
438.....	118954F.....	Sensor, 6F35 Input Speed (W/3 Prong Conn)(Cast # 279101472) 2009-Up.....	1.....	9L8Z-7M101-B
446.....	118987F.....	Circuit Board, 6F35 (14 Pin Conn)(Cast # 9L8P-7G276-CA On Back Side) 2009-Up.....	1.....	9L8P-7G276-A
479.....	118631G.....	Valve, 6T40 Fluid Level Control (Black Plastic)(Goes Beside VB) 2008-Up.....	1.....	24243351

PUMPS & PUMP COMPONENTS

500.....	118912G.....	Pump Assembly, 6T40.....	1.....	TBA
500.....	118912F.....	Pump Assembly, 6F35.....	1.....	TBA
510.....	118916G.....	Pump Body, 6T40 W/Gears (Alum) (Cast # 24245547 On Front) 2008-Up.....	1.....	TBA
510.....	118916F.....	Pump Body, 6F35 W/Gears (Alum) (Cast # 7A103 EXXDA On Front) 2009-Up.....	1.....	TBA
520.....	118918G.....	Stator, 6T40 Cast Iron (Cast # 0A21) 2008-Up.....	1.....	TBA
520.....	118918F.....	Stator, 6T35 Cast Iron (Cast # EXXDA) 2009-Up.....	1.....	TBA
530.....	K118201G.....	Pump Gear Set, 6T40 (.497" Thick) (9T Inner Gear/11T Outer Gear)(W/2 Flats For Hub) 2008-Up.....	1.....	TBA
530.....	K118201F.....	Pump Gear Set, 6F35 (.496" Thick) (7T Inner Gear/8T Outer Gear)(W/2 Flats For Hub) 2009-Up.....	1.....	TBA

DRUMS, HUBS & CLUTCH PISTON KITS

550.....	118734G.....	Drum, 6T40 4-5-6 Clutch (Alum)(4 Clutch)(36 Outer Lugs For 3-5 Reverse Clutch) 2008-Up.....	1.....	24253300
550.....	K118734G.....	Drum Update Kit, 6T40 4-5-6 (Drum, 3-5/Rev Backing Plate, Snap Ring) 2008-Up.....	1.....	24255922
550.....	K118734GA.....	Drum Update Kit, 6T40 4-5-6 (Drum, 3-5/Rev Plate, 3-5/Rev Waved Plate, Snap Ring) 08-Up.....	1.....	TBA
550.....	118734F.....	Drum, 6F35 4-5-6 Clutch (Alum)(5 Clutch)(24 Outer Lugs For 3-5 Reverse Clutch) 2009-Up.....	1.....	9L8Z-7G384-A
558.....	118826G.....	Housing, 6T40 Low/Rev & 1-2-3-4 Clutch (Alum)(#CH6-A Under Low/Rev Cl Piston 2008-Up.....	1.....	TBA
558.....	118826F.....	Housing, 6F35 Low/Rev & 1-2-3-4 Clutch (Alum)(#9L8P-7G033 On Back Side) 2009-Up.....	1.....	9L8Z-7L328-A
560.....	K118763G.....	Piston Kit, 6T40 2-6 Clutch (Bonded)(3 Pieces) 2008-Up.....	1.....	TBA
560.....	K118763F.....	Piston Kit, 6F35 2-6 Clutch (Bonded)(4 Pieces) 2009-Up.....	1.....	TBA
562.....	K118762G.....	Piston Kit, 6T40 1-2-3-4 Clutch (Bonded Piston Cast # 24230816) 2008-Up.....	1.....	TBA
562.....	K118762F.....	Piston Kit, 6F35 1-2-3-4 Clutch (Bonded Piston Cast #9L8P-7A262-AC) 2009-Up.....	1.....	TBA
564.....	K118765G.....	Piston Kit, 6T40 4-5-6 Clutch (Bonded)(4 Pieces) 2008-Up.....	1.....	TBA
564.....	K118765F.....	Piston Kit, 6F35 4-5-6 Clutch (Bonded)(4 Pieces) 2009-Up.....	1.....	TBA
565.....	K118764G.....	Piston Kit, 6T40 3-5 Reverse Clutch (Bonded)(4 Pieces) 2008-Up.....	1.....	TBA

6T30, 6T40, 6T45, 6F35

ILL#	Part#		QTY	REF#
565.....	K118764F.....	Piston Kit, 6F35 3-5 Reverse Clutch (Bonded)(4 Pieces) 2009-Up.....	1.....	TBA
574.....	118744G.....	Hub, 6T40 4-5-6 Clutch (24 Teeth Clutch Hub)(2.602" Overall Height) 2008-Up.....	1.....	24230763
574.....	118744F.....	Hub, 6F35 4-5-6 Clutch (24 Teeth Clutch Hub)(2.729" Overall Height) 2009-Up.....	1.....	9L8Z-7H351-A
576.....	K118766G.....	Piston Kit, 6T40 Low/Reverse Clutch (Bonded Piston Is .450" Thick On Outer Edge) 2008-Up.....	1.....	TBA
576.....	K118766F.....	Piston Kit, 6F35 Low/Reverse Clutch (Bonded Piston Is .415" Thick On Outer Edge) 2009-Up.....	1.....	TBA
PLANETS, RING GEARS & SUN GEARS				
582.....	118747G.....	Planet, 6T40 Input (5 Gear) (Uses 41T 1 Groove Sun Gear)(1.339" Thick) 2008-Up.....	1.....	24250887
582.....	118747F.....	Planet, 6F35 Input (5 Gear) (Uses 41T No Groove Sun Gear)(1.409" Thick) 2009-Up.....	1.....	9L8Z-7D491-B
584.....	118748G.....	Planet, 6T40 Output (5 Gear) (Uses 37T 1 Groove Sun Gear)(2.553" Thick) 2008-Up.....	1.....	24233635
584.....	118748F.....	Planet, 6F35 Output (5 Gear) (Uses 37T No Groove Sun Gear)(2.673" Thick) 2009-Up.....	1.....	9L8Z-7D491-A
586.....	118749G.....	Planet, 6T40 Reaction (4 Gear) (34 Teeth 1 Groove Pinions) 2008-Up.....	1.....	24233625
586.....	118749G.....	Planet, 6F35 Reaction (4 Gear) (34T No Groove Pinions)(Cast # 102810000818) 2009-Up.....	1.....	9L8Z-7D491-D
592.....	118757G.....	Ring Gear, 6T40 Input Planet (5.015" OD W/1 Groove On OD) 2008-Up.....	1.....	TBA
592.....	118757F.....	Ring Gear, 6F35 Input Planet (5.139" OD No Groove On OD) 2009-Up.....	1.....	TBA
594.....	118758G.....	Ring Gear, 6T40 Output Planet (5.017" OD W/1 Groove On OD)(1.206" Thick) 2008-Up.....	1.....	TBA
594.....	118758F.....	Ring Gear, 6F35 Output Planet (5.144" OD W/No Groove On OD)(1.323" Thick) 2009-Up.....	1.....	TBA
596.....	118759G.....	Ring Gear, 6T40 Reaction Planet (1.051" Thick)(5.985" OD W/1 Groove On OD) 2008-Up.....	1.....	TBA
596.....	118759F.....	Ring Gear, 6F35 Reaction Planet (1.044" Thick)(5.945" OD W/No Groove On OD) 2009-Up.....	1.....	TBA
598.....	118845G.....	Ring Gear, 6T40 Differential (1.359" Thk)(89T 1-Groove On Outer Lugs)(15 Lug) 2008-Up.....	1.....	TBA
598.....	118845F.....	Ring Gear, 6F35 Differential (1.336" Thick)(101 Teeth)(12 Lugs) 2009-Up.....	1.....	9L8Z-7F343-A
612.....	118753G.....	Sun Gear, 6T40 Input Planet (41 Teeth, 1 Groove)(.630" Thick)(2.105" OD) 2008-Up.....	1.....	24230784
612.....	118753F.....	Sun Gear, 6F35 Input Planet (41 Teeth, No Groove)(.750" Thick)(2.185" OD) 2009-Up.....	1.....	9L8Z-7D063-A
618.....	118846G.....	Sun Gear, 6T40 Differential (31 Teeth, 1 Groove)(1.845" OD) 2008-Up.....	1.....	TBA
618.....	118846F.....	Sun Gear, 6F35 Differential (39 Teeth, No Groove)(2.345" OD) 2009-Up.....	1.....	9L8Z-7F342-A
624.....	118756G.....	Sun Gear, 6T40 Reaction W/Hub (35 Teeth, 1 Groove)(2.350" Overall Height) 2008-Up.....	1.....	24241247
624.....	118756F.....	Sun Gear, 6T35 Reaction W/Hub (35 Teeth, No Groove)(2.300" Overall Height) 2009-Up.....	1.....	9L8Z-7A019-B
626.....	118755G.....	Sun Gear, 6T40 Output Planet (37 Teeth, 1 Groove)(W/36 Teeth Clutch Hub) 2008-Up.....	1.....	24241246
626.....	118755F.....	Sun Gear, 6F35 Output Planet (37 Teeth, No Groove)(W/36 Teeth Clutch Hub) 2009-Up.....	1.....	9L8Z-7A019-A
634.....	118825.....	Drum Hub Support/Ring Tower 6T40/6F35, (4-Ring, 3-Bolt, 2.322" Long) 09-Up.....	1.....	9L8Z-7A130-A
DIODES, INPUT SHAFTS, CHAINS, CHAIN COMPONENTS & DIFFERENTIALS				
644.....	118727G.....	Diode, 6T40 Low/Reverse (.709" Thick Outer Race)(48T On Inner Race) 2008-Up.....	1.....	24242021
644.....	118727F.....	Diode, 6F35 Low/Reverse (.792" Thick Outer Race)(32T On Inner Race) 2009-Up.....	1.....	9L8Z-7A089-A
670.....	118851G.....	Shaft, 6T40 Input (10 9/16" Long) 2008-Up.....	1.....	24235179
670.....	118851F.....	Shaft, 6F35 Input (10 11/16" Long) 2009-Up.....	1.....	9L8Z-7F213-A
678.....	118741G.....	Hub, 6T40 Drive Sprocket (59 Sprocket Splines)(43 Splines To Output Planet) 2008-Up.....	1.....	24233647
690.....	118824G.....	Park Gear, 6T40 (24 Outer Lugs)(59 Inner Splines)(8" OD) 2008-Up.....	1.....	TBA
690.....	118824F.....	Park Gear, 6F35 W/Drive Sprocket Hub (24 Outer Lugs)(8" OD) 2009-Up.....	1.....	9L8Z-7060-B
698-1.....	118621G.....	Oil Baffle, 6T40 Chain (2 Bolts To Case)(Cast # 24239618)(Plastic) 2008-Up.....	1.....	TBA
698-1.....	118621F.....	Oil Baffle, 6F35 Chain (2 Bolts To Case)(Metal) 2009-Up.....	1.....	9L8Z-7978-A
698.....	118622G.....	Oil Baffle, 6T40 Chain (2 Bolts To Bell)(Cast # 24246165)(Plastic) 2008-Up.....	1.....	TBA
698.....	118622F.....	Oil Baffle, 6F35 Chain (2 Bolts To Bell)(Cast # 9L8P-7H245-AE)(Plastic) 2009-Up.....	1.....	9L8Z-7H245-A
700.....	118885G.....	Chain, 6T40 (1 1/4" Wide)(40 Links) 2008-Up.....	1.....	24238173
700.....	118885F.....	Chain, 6F35 (1" Wide)(41 Links) 2009-Up.....	1.....	9L8Z-7G249-C
702.....	118623G.....	Oil Scoop, 6T40 Chain (8" Long) (Black Plastic) 2008-Up.....	1.....	24237594
702.....	118623F.....	Oil Scoop, 6F35 Chain (5 1/4" Long)(White Plastic)(Cast #BB5P-7J387-AA) 2009-Up.....	1.....	9L8Z-7J387-A
705.....	118883G.....	Sprocket, 6T40 Drive (48 Teeth)(59 Inner Splines)(1.170" Thick) 2008-Up.....	1.....	24231312
705.....	118883F.....	Sprocket, 6F35 Drive (45 Teeth)(.922" Thick) 2009-Up.....	1.....	9L8Z-7G132-D
706.....	118884G.....	Sprocket, 6T40 Driven (40 Teeth)(1.162" Wide Teeth) 2008-Up.....	1.....	24232286
706.....	118884F.....	Sprocket, 6F35 Driven (44 Teeth)(.922" Wide Teeth) 2009-Up.....	1.....	9L8Z-7G132-B
715.....	118910G.....	Differential, 6T40 (5 3/4" Tall)(4 Gear Planet)(Uses 31 Teeth Sun Gear) 2008-Up.....	1.....	TBA
715.....	118910F.....	Differential, 6F35 (7" Tall)(4 Gear Planet)(Uses 39 Teeth Sun Gear) 2009-Up.....	1.....	9L8Z-7F465-B
VALVE BODIES				
740.....	118754G.....	Valve Body, 6T40 W/Top Alum Housing (Cast # 24248223 On Bottom Side) 2008-Up.....	1.....	TBA
740.....	118754F.....	Valve Body, 6F35 Bottom Alum 1/2 Only (Cast # EBJZA On Bottom Side) 2008-Up.....	1.....	9L8Z-7A100-A
746.....	118752G.....	Separator Plate, 6T40 Valve Body To Alum Housing 2008-Up.....	1.....	TBA
746.....	118752F.....	Separator Plate, 6F35 Valve Body To Solenoid Plate (Cast # BW28000032 MA).....	1.....	9L8Z-7Z490-A
747.....	118752GA.....	Separator Plate, 6T40 Valve Body To Case 2009-Up.....	1.....	TBA
747.....	118752FA.....	Separator Plate, 6F35 Valve Body To Case (Cast #9L8P-7J236-AC).....	1.....	9L8Z-7Z490-B
HOUSINGS, CASES, CUSHIONS & SNAP RINGS				
750.....	118703G.....	Bell Housing, 6T40 (6" Top Bolts) (Starter At 3:00)(Cast #CAV. 3.1) 2008-Up.....	1.....	TBA
750.....	118703F.....	Bell Hsg, 6F35 (2.5L)(6-3/8" Top Bolts)(Starter 2:00)(Cast # RFB5P-7976-BB) 2009-Up.....	1.....	9L8Z-7005-V
760.....	118701G.....	Case, 6T40 (15 Bolts To Bell) (Tag # 24252534) 2008-Up.....	1.....	TBA
760.....	118701F.....	Case, 6F35 (17 Bolts To Bell) (Cast # RFCV6P-7006-CC) 2009-Up.....	1.....	9L8Z-7005-D
766.....	118803G.....	Side Pan, 6T40 (13 Bolt)(Connector Hole Is Horizontal)(Plastic) 2008-Up.....	1.....	24253434



6T30, 6T40, 6T45, 6F35

ILL#	Part#		QTY	REF#
766.....	118803F.....	Side Pan, 6F35 (13 Bolt)(Conn Hole Is Vertical)(Plastic)(Cast # CV6P-7G004-AA) 2009-Up.....	1.....	9L8Z-7G004-A
797.....	118081G.....	Nut, 6T40 Shift Lever (W/Shoulder) 2008-Up.....	1.....	TBA
797.....	118081F.....	Nut, 6F35 Shift Lever (No Shoulder) 2009-Up.....	1.....	TBA
845.....	118564G.....	Housing, 6T40 3-5 Reverse Clutch Piston (.708" Thick At Outer Lugs)(6 1/4" OD) 2008-Up.....	1.....	TBA
845.....	118564F.....	Housing, 6F35 3-5 Reverse Clutch Piston (.784" Thick At Outer Lugs)(6 1/4" OD) 2009-Up.....	1.....	9L8Z-7F283-A
850.....	118142G.....	Cushion, 6T40 2-6 Clutch (.058" Thick)(8 5/8" OD)(Waved) 2008-Up.....	1.....	24230729
850.....	118142F.....	Cushion, 6F35 2-6 Clutch (.035" Thick)(8 5/8" OD)(Waved) 2009-Up.....	1.....	9L8Z-7E085-A
862.....	118601G.....	Snap Ring, 6T40 Holds 2-6 Clutch Return Spring In (.058" Thick)(9 9/16" OD) 2008-Up.....	1.....	24230730
862.....	118601F.....	Snap Ring, 6F35 Holds 2-6 Clutch Return Spring In (.084" Thick)(9 7/16" OD) 2009-Up.....	1.....	9L8Z-7D483-A
867.....	118602G.....	Snap Ring, 6T40 Holds 4-5-6 Clutch Pressure Plate In (.057" Thick)(5.200" OD) 2008-Up.....	1.....	24230756
867.....	118602F.....	Snap Ring, 6F35 Holds 4-5-6 Clutch Pressure Plate In (.059" Thick)(5.015" OD) 2009-Up.....	1.....	9L8Z-7B066-C
873.....	118603G.....	Snap Ring, 6T40 Holds 1-2-3-4 Clutch Return Spring In (.060" Thick)(6 3/8" OD) 2008-Up.....	1.....	24230815
873.....	118603F.....	Snap Ring, 6F35 Holds 1-2-3-4 Clutch Return Spring In (.057" Thick)(6 9/16" OD) 2009-Up.....	1.....	9L8Z-7H365-B
877.....	118604.....	Snap Ring, 6T40/6F35 Holds 4-5-6 Clut Spring Retainer In (.059" Thick)(2.660" OD) 2008-Up.....	1.....	24230752
878.....	118605G.....	Snap Ring, 6T40 Holds 3-5 Rev Clutch Pressure Plate In (.062" Thick)(5.490" OD) 2008-Up.....	1.....	24253298
878.....	118605F.....	Snap Ring, 6F35 Holds 3-5 Rev Clutch Pressure Plate In (.059" Thick)(6.030" OD) 2009-Up.....	1.....	TBA
879.....	118606G.....	Snap Ring, 6T40 Holds 3-5 Rev Piston Hsg To 4-5-6 Clutch Drum (.057" Thick)(5.040" OD) 2008-Up.....	1.....	TBA
879.....	118606F.....	Snap Ring, 6F35 Holds 3-5 Rev Piston Hsg To 4-5-6 Clutch Drum (.059" Thick)(5.200" OD) 2009-Up.....	1.....	9L8Z-7C122-E
880.....	118607.....	Snap Ring, 6T40/6F35 Holds Input Shaft To 4-5-6 Clutch Drum (.039" Thick)(.818" OD) 2008-Up.....	1.....	24231268
882.....	118608.....	Snap Ring, 6T40/6F35 Holds Output Planet Ring Gr To Input Planet (.097" Thick)(5.285" OD) 2008-Up.....	1.....	TBA
885.....	118609G.....	Snap Ring, 6T40 Holds 1-2-3-4 Clu Press Plate In (.130" Thick)(9 3/4" OD)(Square Ends) 2008-Up.....	1.....	24231265
885.....	118609F.....	Snap Ring, 6F35 Holds 1-2-3-4 Clu Press Plate In (.128" Thick)(9 3/4" OD)(Hooked Ends) 2009-Up.....	1.....	9L8Z-7D483-A
888.....	118610.....	Snap Ring, 6T40/6F35 Holds React Planet Ring Gear To Output Planet (.079" Thick)(5.763" OD) 08-Up.....	1.....	TBA
890.....	118611G.....	Snap Ring, 6T40 Holds Input Ring Gr To React Planet (.099" Thick)(5.118" OD)(.160" Wide) 08-Up.....	1.....	TBA
890.....	118611F.....	Snap Ring, 6F35 Holds Input Ring Gr To React Planet (.099" Thick)(5.110" OD)(.156" Wide) 09-Up.....	1.....	TBA
893.....	118603G.....	Snap Ring, 6T40 Holds Low/Reverse Clutch Return Spring In (.060" Thick)(6 3/8" OD) 2008-Up.....	1.....	24230815
893.....	118612F.....	Snap Ring, 6F35 Holds Low/Reverse Clutch Return Spring In (.057" Thick)(6 1/2" OD) 2009-Up.....	1.....	9L8Z-7C122-G
894.....	118613G.....	Snap Ring, 6T40 Holds Drive Sprocket To Hub (.058" Thick)(3.642" OD) 2008-Up.....	1.....	24231278
894.....	118613F.....	Snap Ring, 6T35 Holds Drive Sprocket To Hub (.058" Thick)(3.684" OD) 2009-Up.....	1.....	9L8Z-7C122-B
897.....	118614G.....	Snap Ring, 6T40 Holds Pump Seal In (.059" Thick)(2.846" OD) 2008-Up.....	1.....	TBA
898.....	118613G.....	Snap Ring, 6T40 Holds Park Gear To Drive Sprocket Hub 2008-Up.....	1-2.....	24231278
899.....	118614G.....	Snap Ring, 6T40 Holds Ring Gear To Bell Hsg (.114" Thick)(6 1/4" OD)(W/Square Ends) 2008-Up.....	1.....	TBA
899.....	118614F.....	Snap Ring, 6F35 Holds Ring Gear To Bell Housing (.111" Thick)(7" OD)(W/Hooked Ends) 2009-Up.....	1.....	9L8Z-7C122-A
NI.....	118615F.....	Apply Ring, 6F35 2-6 Clutch (Snaps Onto Bonded Piston)(Steel)(.635" Thick)(8 1/8" OD) 2009-Up.....	1.....	9L8Z-7E005-B

CLUTCH PISTONS, SPRINGS, RETAINERS & MISCELLANEOUS

960.....	118763G.....	Piston, 6T40 2-6 Clutch (Bonded) (.870" Thick)(7 3/4" OD) 2008-Up.....	1.....	24230727
960.....	118763F.....	Piston, 6F35 2-6 Clutch (Bonded) (.630" Thick)(7 3/4" OD) 2009-Up.....	1.....	9L8Z-7E005-A
962.....	118762G.....	Piston, 6T40 1-2-3-4 Clutch (Bonded)(8 1/16" OD)(Cast #24230816) 2008-Up.....	1.....	24230816
962.....	118762F.....	Piston, 6F35 1-2-3-4 Clutch (Bonded)(8 1/16" OD)(Cast #9L8P-7A262-AC) 2009-Up.....	1.....	9L8Z-7A262-A
964.....	118765G.....	Piston, 6T40 4-5-6 Clutch (Alum) (1.076" Thick)(4.622" OD) 2008-Up.....	1.....	24231250
964.....	118765G.....	Piston, 6F35 4-5-6 Clutch (Alum) (1.101" Thick)(4.622" OD) 2009-Up.....	1.....	9L8Z-7A262-C
965.....	118764.....	Piston, 6T40 3-5 Reverse Clu(Bonded) No-Notches (Replaces 3-Notch Design) 2008-Up.....	1.....	24259061
965.....	118764.....	Piston, 6F35 3-5 Reverse Clutch (Bonded)(Cast # 9L8P-7F254-AC) 2009-Up.....	1.....	9L8Z-7F283-A
967.....	118766G.....	Piston, 6T40 Low/Reverse Clutch (Bonded)(.450" Thick On Outer Edge)(8 1/16" OD) 2008-Up.....	1.....	24257106
967.....	118766F.....	Piston, 6F35 Low/Reverse Clutch (Bonded)(.415" Thick On Outer Edge)(8" OD) 2009-Up.....	1.....	9L8Z-7D402-A
970.....	118873G.....	Spring, 6T40 2-6 Clutch Return (10 Fingers)(8 5/8" OD) 2008-Up.....	1.....	24230728
970.....	118873F.....	Spring, 6F35 2-6 Clutch Return (11 Fingers)(8 5/8" OD) 2009-Up.....	1.....	9L8Z-7B070-A
972.....	118872G.....	Spring, 6T40 1-2-3-4 Clutch Return (16 Triangle Fingers)(7 7/8" OD) 2008-Up.....	1.....	24230817
972.....	118872F.....	Spring, 6F35 1-2-3-4 Clutch Return(16 Square Fingers)(7 7/8" OD) 2009-Up.....	1.....	9L8Z-7B070-G
974.....	118875G.....	Spring/Retainer, 6T40 4-5-6 Clutch Return (28 Springs)(.856" Thick)(4.076" OD) 2008-Up.....	1.....	TBA
974.....	118875F.....	Spring/Retainer, 6F35 4-5-6 Clutch Return (30 Springs)(.670" Thick)(4.232" OD) 2009-Up.....	1.....	9L8Z-7F222-A
975.....	118874G.....	Spring/Retainer, 6T40 3-5 Reverse Clutch Return (27 Springs)(5 3/4" OD) 2008-Up.....	1.....	24230741
975.....	118874F.....	Spring/Retainer, 6F35 3-5 Reverse Clutch Return (26 Springs)(5 15/16" OD) 2009-Up.....	1.....	9L8Z-7F235-A
977.....	118876G.....	Spring, 6T40 Low/Reverse Clutch Return (18 Fingers)(7 3/4" OD) 2008-Up.....	1.....	24230814
977.....	118876F.....	Spring, 6F35 Low/Reverse Clutch Return (16 Fingers)(7 11/16" OD) 2009-Up.....	1.....	9L8Z-7B070-C
984.....	118865G.....	Retainer/Piston, 6T40 4-5-6 Clutch (Bonded)(Cast # 24231252) 2008-Up.....	1.....	24231252
984.....	118865F.....	Retainer/Piston, 6F35 4-5-6 Clutch (Bonded)(Cast #9L8P-7J029-AA) 2009-Up.....	1.....	9L8Z-7H360-A
991-2.....	118624G.....	Detent Spring, 6T40 Rooster Comb (Roller Is .543" Long) 2008-Up.....	1.....	24231174
991-2.....	118624F.....	Detent Spring, 6F35 Rooster Comb (Roller Is .645" Long) 2009-Up.....	1.....	9L8Z-7E332-A
991-4.....	118625G.....	Manual Shaft, 6T40 (3.387" Long)(2-Roll Pins To Hold Shaft To Case & 1-Roll Pin To MLPS) 08-Up.....	1.....	24231168
991-4.....	118625F.....	Manual Shaft, 6F35 (3.387" Long)(Uses 1-Roll Pin To Hold Shaft To MLPS) 2009-Up.....	1.....	9L8Z-7A256-A
992.....	118626G.....	Manual Lever, 6T40 (2.812" Long With 1/8" Bend) 2008-Up.....	1.....	TBA
992.....	118626F.....	Manual Lever, 6F35 (3.055" Long With 1/2" Bend)(Cast # 26T) 2009-Up.....	1.....	TBA
994.....	118627.....	Actuator, 6T40/6F35 Park Rod (6 1/4" Long) 2008-Up.....	1.....	9L8Z-7A256-A
995.....	K118628G.....	Park Pawl Assembly, 6T40 (5 Pieces) 2008-Up.....	1.....	TBA
995.....	K118628F.....	Park Pawl Assembly, 6F35 (4 Pieces) (Cast # 9L8P-7A441-AD On Park Pawl) 2009-Up.....	1.....	TBA
NI.....	118480F.....	Cooler, 6F35 (Alum)(2 Bolt) (Mounts On Top Of Case)(Cast # CV6P-7869-AD) 2009-Up.....	1.....	TBA

Notes