

AISIN WARNER

AW 55-50SN, 55-51SN

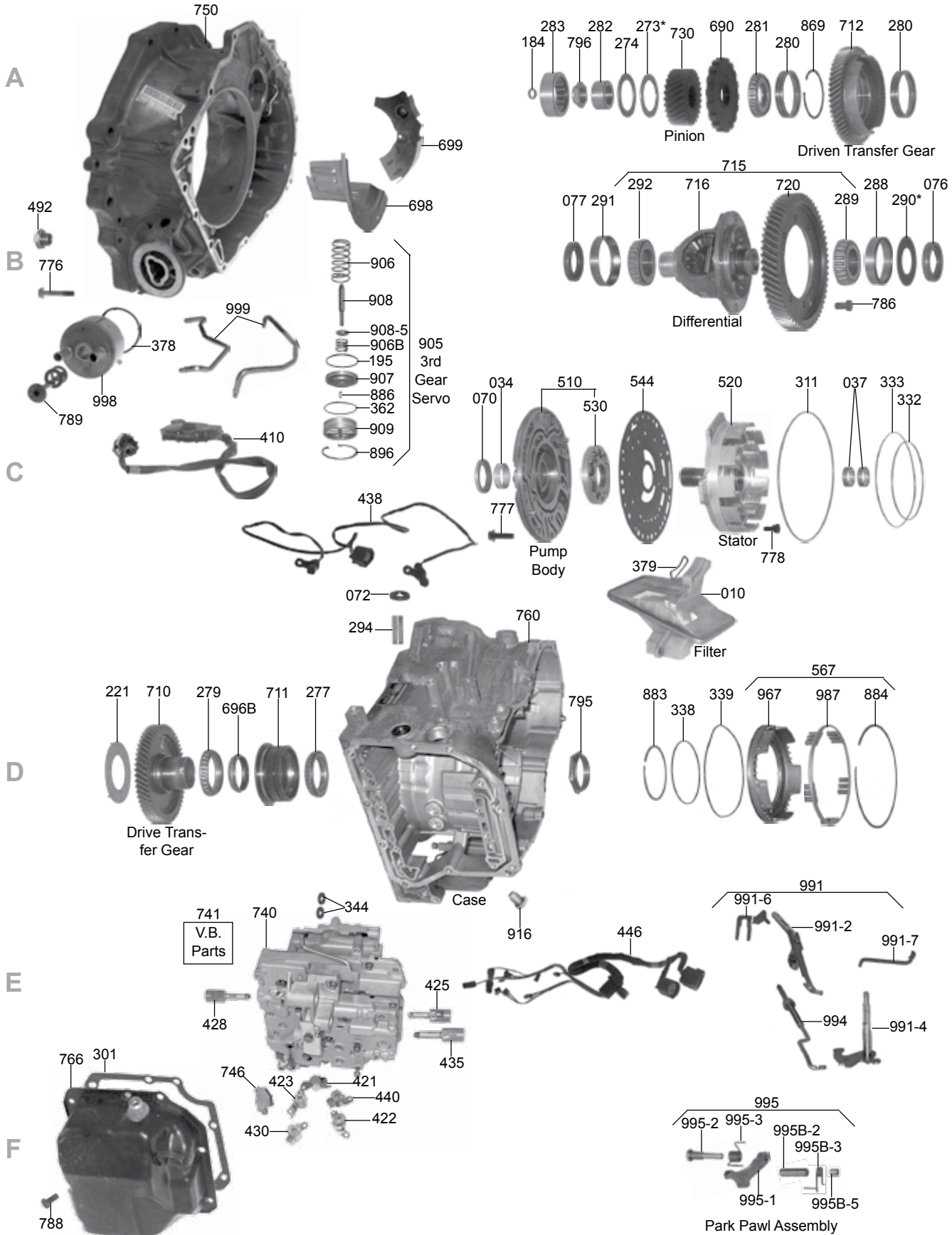

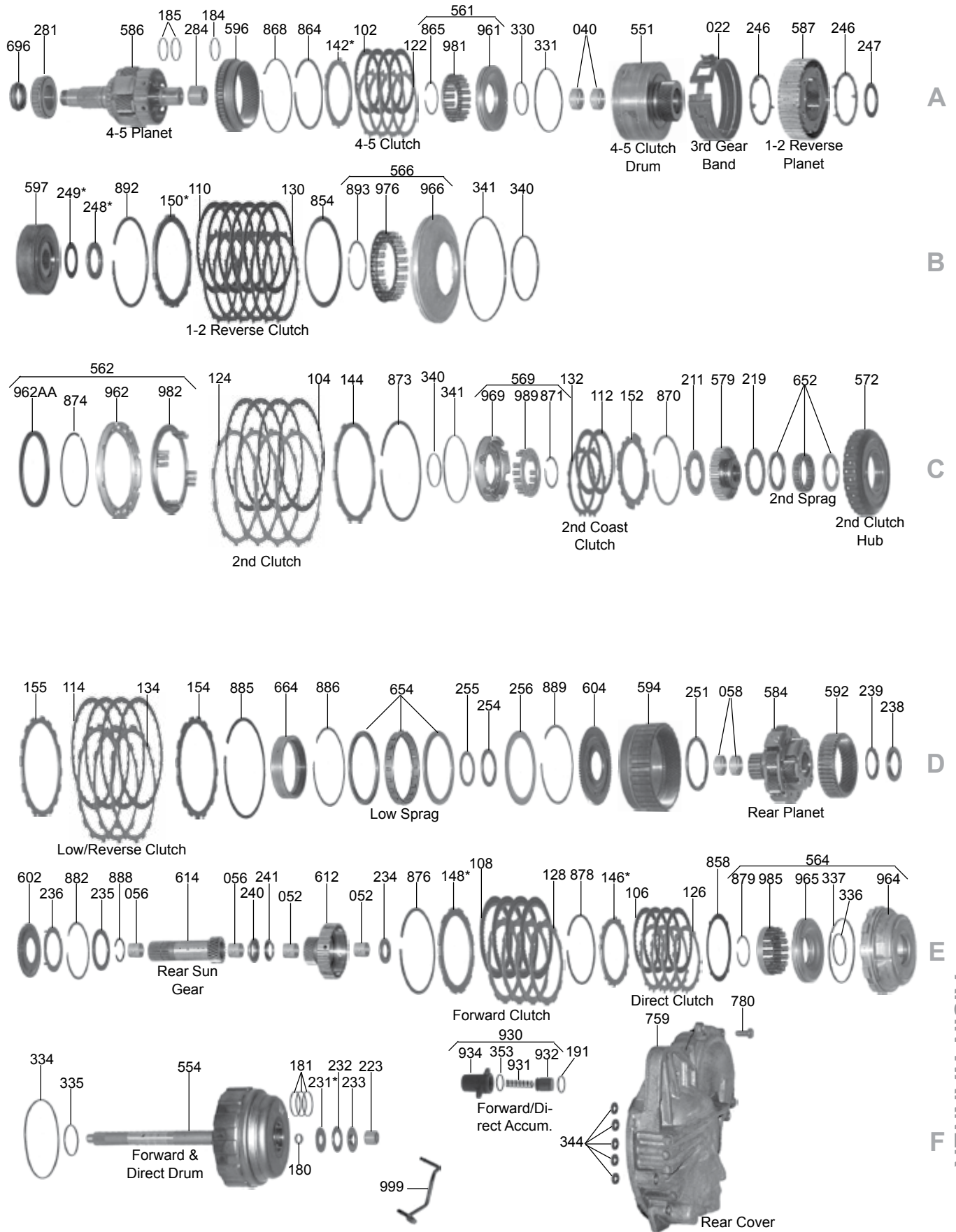

AW 55-50SN, 55-51SN

ILL#	Part#		QTY	REF#
OVERHAUL KITS				
NI.....	K59900D	Overhaul Kit, AW55-50SN / AW55-51SN (5 Speed FWD/AWD) 2000-Up	1	N/A
MASTER L/STEEL KITS				
NI.....	DK5900FS	Master L/Steels Kit, AW55-50SN, Saturn ION 03-04, VUE 02-06, Chev Equinox 05-07, Pontiac Torrent 06-07, SAAB 9-3 04-07, 9-5 02-07, Volvo C70 01-07, S40 01-07, S60 01-07, S70 2000, S80 04-06, V40 01-04, V50 05-07, V70 00-07, XC70 03-07, XC90 03-06, Cross Country 2002	1	N/A
NI.....	DK5900GS	Master L/Steels Kit, AW55-51SN (RE5F22A) Nissan Altima 3.5L 2005-06, Maxima 3.5L 2004-04, Quest 3.5L 2004-07, Infiniti I35 2003-04	1	N/A
MASTER W/STEELS KITS				
NI.....	DK5900F	Master W/Steels Kit, AW55-50SN, Saturn ION 03-04, VUE 02-06, Chev Equinox 05-07, Pontiac Torrent 06-07, SAAB 9-3 04-07, 9-5 02-07, Volvo C70 01-07, S40 01-07, S60 01-07, S70 2000, S80 04-06, V40 01-04, V50 05-07, V70 00-07, XC70 03-07, XC90 03-06, Cross Country 2002	1	N/A
NI.....	DK5900G	Master W/Steels Kit, AW55-51SN (RE5F22A) Nissan Altima 3.5L 2005-06, Maxima 3.5L 2004-06, Quest 3.5L 2004-07, Infiniti I35 2003-04	1	N/A
FILTERS				
010.....	59710D	Filter, AW55-51SN (Nissan, Infiniti) 2000-Up	1	31728-8Y000
010.....	59710DA	Filter, AW55-50SN (Saturn, Volvo, Saab, Opel) 2000-Up	1	24220578
010.....	59710DB	Filter, AW55-50SN (Chevy Equinox, Pontiac Torrent) 2000-Up	1	24240239
BANDS				
022.....	59700D	Band, AW55-50SN / AW55-51SN 3rd Gear (2 1/16" Wide) (Double Wrap) 2000-Up	1	31630-8Y000
BUSHINGS				
030.....	K59901D	Bushing Kit, AW55-50SN (Large Shaft .873") 2000-Up	1	TBA
030.....	K59901DA	Bushing Kit, AW55-51SN (Small Shaft .843") 2000-Up	1	TBA
034.....	67001	Bushing, AW55-50SN / AW55-51SN Pump Body (1.490" ID) 2000-Up	1	TBA
037.....	59002D	Bushing, AW55-50SN / AW55-51SN Stator (Front) (Brass) 2000-Up	1	TBA
037.....	59003D	Bushing, AW55-50SN / AW55-51SN Stator (Rear) Grooved (Brass) 2000-Up	1	TBA
040.....	59010D	Bushing, AW55-50SN / AW55-51SN 4-5 Clutch Drum (1.425" OD) 2000-Up	1	TBA
040.....	K59010D	Bushing Repair Kit, 4-5 Clutch Drum (Bushing & Steel Sleeve) 2000-Up	1	TBA
052.....	59017D	Bushing, Sun gear / Direct Hub, Large Shaft, 2000-Up	2	TBA
052.....	59017G	Bushing, Sun gear / Direct Hub, Small Shaft, 2000-Up	2	TBA
052.....	59017DA	Bushing, Sun gear / Direct Hub, Large Shaft (1-Pc Style Bushing) 2000-Up	1	TBA
052.....	59017GA	Bushing, Sun gear / Direct Hub, Small Shaft (1-Pc Style Bushing) 2000-Up	1	TBA
056.....	59017D	Bushing, Rear Sun gear, Large Shaft, 2000-Up	2	TBA
056.....	59017G	Bushing, Rear Sun gear, Small Shaft, 2000-Up	2	TBA
058.....	59015D	Bushing, Rear Planet (Front) 2000-Up	1	TBA
058.....	59016D	Bushing, Rear Planet (Rear) 2000-Up	1	TBA
NI.....	59024	Bushing, Linear Solenoid Inductor Hsg (2ea Per Sol) See Tools At End Of Electrical	2	55526
METAL CLAD SEALS				
070.....	59151	Seal, AW55-50SN / AW55-51SN Pump, 2000-Up	1	TBA
072.....	78197	Seal, AW55-50/51SN Linkage / Manual Control Shaft 2000-Up	1	TBA
076.....	59152	Seal, AW55-50/51SN, Axle, Case Side (Nissan, Volvo 2WD & AWD) 2000-Up	1	TBA
076.....	59153F	Seal, AW55-50/51SN, Axle, Case Side (Opel) 2000-Up	1	TBA
076.....	59154DA	Seal, AW55-50/51SN, Axle, Case Side (Saturn AWD, Equinox/Torrent All) 2000-Up	1	24220622
076.....	59154DA	Seal, AW55-50/51SN, Axle, Both Sides (Saturn 2WD, Saab) 2000-Up	2	24220622
077.....	59154D	Seal, AW55-50/51SN, Axle, Bell Hsg Side (Volvo 2WD, Opel) 2000-Up	1	TBA
077.....	59154F	Seal, AW55-50/51SN, Axle, Bell Hsg Side (Volvo AWD) 2000-Up	1	TBA
077.....	59152	Seal, AW55-50/51SN, Axle, Bell Hsg Side (Nissan) 2000-Up	1	TBA
077.....	59154DB	Seal, AW55-50/51SN, Axle, Bell Hsg Side (Saturn AWD, Equinox/Torrent AWD) 2000-Up	1	24220724
077.....	59154DC	Seal, AW55-50/51SN, Axle, Bell Housing Side (Equinox/Torrent 2WD) 2000-Up	1	24229812
NI.....	33139	Seal, AW55-50/51SN, Cooler Line, 2000-Up	2	24200326
FRICTIONS				
102.....	59100C	Friction, AW55-50SN C3 Underdrive (4-5) Clutch (.067") 34 Teeth (4.483" OD) 2000-Up	4	TBA
102.....	59100G	Friction, AW55-51SN C3 Underdrive(4-5) Clutch (.059") 34 Teeth (4.483" OD) 2005-Up	4	TBA
104.....	59108B	Friction, AW55-50SN B2 2nd Brake Clutch (.067") 40 Teeth (6.302" OD) 2000-Up	4	TBA
104.....	59108D	Friction, AW55-51SN B2 2nd Brake Clutch (.076") 40 Teeth (6.302" OD) 2005-Up	4	TBA
106.....	59100D	Friction, AW55-50SN C2 Direct Clutch (.068") 34 Teeth (4.254" OD) 2000-Up	4	TBA
106.....	59100DA	Friction, AW55-51SN C2 Direct Clutch (.059") 34 Teeth (4.254" OD) 2005-Up	4	TBA
108.....	59104A	Friction, AW55-50SN / AW55-51SN C1 Forward Clu (.068") 49T (5.375" OD) 2000-Up	4	TBA
110.....	59106	Friction, AW55-50SN / 51SN B4 5th Brake (1-2 Rev) (.068") 47T (5.551" OD) 00-Up	6	TBA

AW 55-50SN, 55-51SN

ILL#	Part#		QTY	REF#
112.....	59100.....	Friction, AW55-50SN B1 2nd Coast Clutch (.067") 34 Teeth (4.260" OD) 2000-Up.....	3.....	TBA
112.....	59100D.....	Friction, AW55-51SN B1 2nd Coast Clutch (.068") 34 Teeth (4.254" OD) 2005-Up.....	3.....	TBA
114.....	59108.....	Friction, AW55-50SN B3 Low/Reverse Clutch (.067") 33 Teeth (6.302" OD) 2000-Up.....	4-5.....	TBA
114.....	59102.....	Friction, AW55-51SN B3 Low/Reverse Clutch (.067") 33T (6.302" OD)(Grooved) 2005-Up.....	5.....	TBA
119.....	K59DF.....	Friction Module, AW55-50SN, 2000-Up.....	1.....	TBA
119.....	K59DAF.....	Friction Module, AW55-51SN, 2005-Up.....	1.....	TBA
STEELS				
122.....	59109B.....	Steel, AW55-50SN / AW55-51SN C3 Underdrive (4-5) Cl (.071") 18T (3.582" ID) 2000-Up.....	4.....	TBA
124.....	59103C.....	Steel, AW55-50SN / AW55-51SN B2 2nd Brake Clutch (.071") 10T (5.538" ID) 2000-Up.....	4.....	TBA
126.....	59109.....	Steel, AW55-50SN / AW55-51SN C2 Direct Clutch (.071") 12 Teeth (3.582" ID) 2000-Up.....	4.....	TBA
128.....	59107A.....	Steel, AW55-50SN / AW55-51SN C1 Forward Clutch (.073") 12T (4.491" ID) 2000-Up.....	4.....	TBA
130.....	59116.....	Steel, AW55-50SN / AW55-51SN B4 5th Brake (1-2 Rev) (.071") 12T (4.898" ID) 2000-Up.....	6.....	TBA
132.....	59101.....	Steel, AW55-50SN / AW55-51SN B1 2nd Coast Clutch (.071") 8T (3.582" ID) 2000-Up.....	2.....	TBA
134.....	59105B.....	Steel, AW55-50SN / AW55-51SN B3 Low/Reverse Clutch (.071") (5.657" ID) 2000-Up.....	3-5.....	TBA
PRESSURE PLATES				
142.....	59715D.....	Pressure Plate, AW55-50SN / AW55-51SN 4-5 Clutch (Selective) 18 Teeth (3.590" ID).....	1.....	TBA
144.....	59716D.....	Pressure Plate, AW55-50SN / AW55-51SN 2nd Clutch (.150") 10 Teeth (5.540" ID).....	1.....	TBA
146.....	59717A.....	Pressure Plate, AW55-50SN / AW55-51SN Direct Clutch (.150") 12 Teeth (3.580" ID).....	1.....	TBA
148.....	59718A.....	Press Plate, AW55-50SN Fwd Cl (Top) 12T (.151") 4.490" ID, (Stepped To .197").....	1.....	TBA
148.....	59718B.....	Press Plate, AW55-50SN Fwd Clutch (Top) 12T (.150") 4.490" ID, Flat.....	1.....	TBA
148.....	59748D.....	Pressure Plate, AW55-51SN Forward Clutch (.205") 12 Teeth (Flat) 2000-Up.....	1.....	TBA
150.....	59721D.....	Press Plate, AW55-50SN / 51SN 1-2 Rev Clutch (Top) Selective (12T) 4.890" ID.....	1.....	TBA
152.....	59719A.....	Pressure Plate, AW55-50SN 2nd Coast Clutch (Top) .138" (12 Spring Guides) 2000-Up.....	1.....	TBA
152.....	59719D.....	Pressure Plate, AW55-51SN 2nd Coast Clutch (Top) .138" (8 Spring Guides) 2000-Up.....	1.....	TBA
154.....	59723D.....	Pressure Plate, AW55-50SN / 51SN Low/Reverse Clutch, 13T, 5.660" ID.....	1.....	TBA
154.....	59722D.....	Pressure Plate, AW55-51SN Low/Reverse Clutch (.098") 13 Teeth (5.655" ID) 2000-Up.....	1.....	TBA
155.....	59723D.....	Apply Plate, AW55-50SN / 51SN Low/Reverse Clutch, 13T, 5.660" ID (Selective).....	1-2.....	TBA
VALVE BODY KITS				
116.....	K59908D.....	Shift Kit, AW55-50SN Transgo) 1999-Up.....	1.....	SKAW55-50
SEALING RINGS				
175.....	K59300D.....	Ring Kit, AW55-50SN / AW55-51SN (Teflon) 2000-Up.....	1.....	TBA
180.....	59301AT.....	Ring, AW55-50SN / AW55-51SN Fwd & Dir Drum Shaft (Small) Rear (Teflon) Butt-Joint.....	1.....	TBA
181.....	59302D.....	Ring, AW55-50SN / AW55-51SN Forward & Direct Clutch (Teflon) (Scarf Cut Joint) 00-Up.....	3.....	TBA
184.....	59303D.....	Ring, AW55-50SN / AW55-51SN 4-5 Planet Shaft Pilot To Rear Cover (Teflon) Scarf Cut.....	1.....	TBA
185.....	59304D.....	Ring, AW55-50SN / AW55-51SN 4-5 Clutch (Teflon) (Scarf Cut Joint) 2000-Up.....	2.....	TBA
191.....	59305D.....	Ring, AW55-50SN / AW55-51SN Forward & Direct Accumulator (Teflon) (Scarf Cut).....	1.....	TBA
WASHERS & BEARINGS				
211.....	59401A.....	Washer, AW55-51SN Stator To Sprag Race (3 Tab Plastic) 2.919" OD (1.847" ID).....	1.....	TBA
211.....	59401D.....	Wsh, AW55-50SN Stator To Sprag Race (3 Tab Metal) (.056" Thk) 2.460" OD, 1.315" ID.....	1.....	TBA
219.....	59402A.....	Washer, AW55-50SN / 51SN 2nd Coast Clutch Hub To 2nd Clutch Hub (3 Tab Plastic).....	1.....	TBA
221.....	59403A.....	Washer, AW55-50SN / 51SN 2nd Coast Clutch Drum To Transfer Gear (3 Tab Plastic).....	1.....	TBA
223.....	59416D.....	Caged Needle Bearing, AW55-50SN Forward & Direct Drum Shaft To Rear Cover.....	1.....	TBA
		(13 Needles) .735" OD (Cast # KOYO BMK131914J) 2000-Up.....		
223.....	59416DA.....	Caged Needle Bearing, AW55-51SN Forward & Direct Drum Shaft To Rear Cover.....	1.....	TBA
		(10 Needles) .835" OD (Cast # KOYO BKM132114BJ) 2000-Up.....		
231.....	59436A.....	Race, AW55-50SN /51SN Fwd & Dir Drum To Rear Cover (.031" Thk) .536" ID, 1.6505" OD.....	1.....	TBA
232.....	59417D.....	Bearing, AW55-50SN /51SN Fwd & Dir Drum To Rear Cov (.117" Thk, .091" ID, 1.64" OD).....	1.....	TBA
233.....	59437D.....	Race, AW55-50SN Fwd & Dir Drum To Rear Cov (Rear) (.031" Thick) .638" ID, 1.604" OD.....	1.....	TBA
233.....	59437G.....	Race, AW55-51SN Fwd & Dir Drum To Rear Cov (Rear) (.031" Thk, .867" ID, 1.604" OD).....	1.....	TBA
234.....	59418D.....	Brg W/Races, AW55-51SN Sun Gr W/ Hub To Fwd/Dir Drum, .140" Thk, 1.70" OD, .903" ID.....	1.....	TBA
235.....	59419D.....	Bearing W/Race, AW55-50SN / AW55-51SN Ring Gear Hub To Direct Clutch Hub.....	1.....	TBA
236.....	59438A.....	Race, AW55-50SN / AW55-51SN Rear Hub To Sun Gear (4 Legs) (.031" Thick).....	1.....	TBA
238.....	59420D.....	Bearing W/Race, AW55-50SN / AW55-51SN Rear Planet To Hub (2.515" OD) (1.831" ID).....	1.....	TBA
239.....	59439D.....	Race, AW55-50SN Rear Planet To Hub (2.395" OD) (1.705" ID) 2000-Up.....	1.....	TBA
239.....	59439DA.....	Race, AW55-51SN Rear Planet To Hub (2.395" OD) (1.975" ID) 2000-Up.....	1.....	TBA
240.....	59429D.....	Bearing W/Race, AW55-50SN Rear Sun Gear To Sun Gear With Hub (.110" Thick).....	1.....	TBA
241.....	59444D.....	Race, AW55-50SN Rear Sun Gear To Sun Gear With Hub (.031" Thick) 1.370" OD.....	1.....	TBA
246.....	59404D.....	Washer, AW55-50SN / 51SN 1-2 Reverse Planet (Both Sides) Plastic 3 Locking Tabs.....	2.....	TBA
247.....	59430D.....	Bearing, AW55-50SN / AW55-51SN Sun Gear To 1-2 Reverse Planet Ring Gear.....	1.....	TBA
248.....	59431D.....	Bearing W/Race, AW55-50SN / 51SN 1-2 Rev Planet Ring Gear To Rear Cover.....	1.....	TBA
249.....	59445D.....	Shim, AW55-51SN 1-2 Reverse Planet Ring Gear To Rear Cover (Selective).....	1.....	TBA
251.....	59421A.....	Bearing, AW55-50SN / AW55-51SN Rear Hub To Planet (3.493" OD) .140" Thick.....	1.....	TBA
254.....	59422D.....	Bearing W/Race, AW55-50SN / 51SN Drive Transfer Gear To Rear Ring Gear Hub.....	1.....	TBA

AW 55-50SN, 55-51SN

ILL#	Part#		QTY	REF#
255	59440A	Race, AW55-50SN / 51SN Ring Gear Hub (Front) 2.275" OD (1.732" ID) .078" Thick	1	TBA
256	59403D	Washer, AW55-50SN Sprag To Rear Ring Gear Hub (.100" Thick) 3.860" ID (Stepped)	1	TBA
273	59441D	Shim, AW55-50SN / 51SN Pinion To Brg #283 (Selective) 2.790" OD, 1.943" ID	1	TBA
274	59424D	Bearing, AW55-50SN / 51SN Pinion To Brg #283 (.077" Thk) 2.775" OD, 1.935" ID	1	TBA
277	59977A	Cone Brg, AW55-50SN / 51SN (30 Rollers) (Cast# NSK R-53-2)	1	TBA
279	59977A	Cone Brg, AW55-50SN / 51SN Driven Transfer (30 Rollers) (Cast# NSK R-53-2)	2	TBA
280	59978D	Cup Race, AW55-50SN / 51SN Driven Transfer Gr (Both Sides) 3.467" Cast# NSK R50-31A	2	TBA
281	59977D	Cone Bearing, AW55-50SN / 51SN Driven Transfer Gr (Both Sides) 30 Roller, # NSK R50-31	2	TBA
282	59978AB	Inner Race, AW55-50SN / 51SN Pinion Brg To Bell .805" Thk, Cast# Koyo 06NU07223C3	1	TBA
283	59425A	Roller Brg, AW55-50SN / 51SN (Volvo, GM, Saturn) Bell To UD Planet, 16 Rollers, # RNU090722)	1	TBA
284	59426D	Needle Brg, AW55-50SN / 51SN Rear Cover To 4-5 Planet Shaft, 11-Needles, # RNU060514	1	TBA
288	59978DA	Cup Race, AW55-50SN / 51SN Diff Hsg To Case (.765" Thk) (KOYO ST4286-N Or G)	1	TBA
289	59977DA	Cone Bearing, AW55-50SN / 51SN Diff Hsg To Case (24 Rollers) (KOYO ST5586)	1	TBA
290	59442D	Shim, AW55-50SN / AW55-51SN Diff Brg To Case (Selective) 3.373" OD, 2.282" ID	1	TBA
291	59978DB	Cup Race, AW55-50SN / 51SN Diff To Bell Hsg (3.542" OD) (Cast # KOYO ST5790-9)	1	TBA
292	59977DB	Cone Bearing, AW55-50SN / 51SN Diff To Bell Hsg (27 Rollers) (KOYO ST5790)	1	TBA
294	59427D	Caged Needle Bearing, AW55-50SN / 51SN Linkage (.925" Long, .708" OD) (NSK 0C501204)	1	TBA

GASKETS & RUBBER COMPONENTS

301	59500D	Gasket, AW55-50SN / AW55-51SN Pan (9 Bolt) 2000-Up	1	TBA
311	89516	O-Ring, AW55-50SN / AW55-51SN Pump	1	TBA
321	K59527D	Kit, Valve Body Gasket Set, All, 2000-Up	1	TBA
344	59216D	Seal, AW55-50SN / 51SN Case To Rear Cover (.113" Thk) (.590" OD) Also VB To Case(2)	5-7	PI89201

TECHNICAL MANUALS

400	TMAW55-50SN	Technical Manual, AW55-50SN	1	TBA
-----	-------------	-----------------------------	---	-----

ELECTRICAL COMPONENTS

410	59991F	Switch, AW55-50SN (Volvo) PRNDL (W/ Wire Harness, 9 Prong Connector) 2000-Up	1	TBA
410	59991FA	Switch, AW55-51SN (Volvo) PRNDL (W/ Wire Harness, 7 Prong Connector) 2000-Up	1	TBA
410	59991FB	Switch, AW55-50SN (GM, Saturn) PRNDL (No Wire Harn, 9 Prong Conn) 2002-Up	1	TBA
421	59931D	Solenoid, Shift "SS1" (Shift & Rev) Fits "A" Or No Mark Valve Bodies (Bolt On Left, Conn On Right)	1	52-0468
421	59931DA	Solenoid, Shift "SS1" (Shift & Rev) Fits "B" Or "C" Valve Bodies (Bolt On Right, Conn On Left)	1	52-0469
423	59923D	Solenoid, Shift "SS2" (2-3, 3-4) Nissan, Volvo, Normally Closed (Flat Top)	1	52-0470
423	59923DA	Solenoid, Shift "SS2" (2-3, 3-4) GM, Saturn, Saab, Normally Open (Domed Top)	1	52-0471
422	59932D	Solenoid, Shift "SS3" (1-2, 2-3, Reverse) Fits All	1	52-0472
440	59929D	Solenoid, Shift "SS4" (3-4, 4-5) Fits All	1	52-0473
430	59927D	Solenoid, Shift "SS5" (Reverse) Fits All	1	52-0474
425	59925D	Solenoid, Linear "SLU" TCC Lock-Up (Black Conn) Fits All Early & Late Valve Bodies	1	52-0458
428	59926D	Solenoid, Linear "SLT" Line Pressure (Blue Conn) Fits All Early & Late Valve Bodies	1	52-0466
428	59926G	Solenoid, Linear "SLT" Line Pressure (Blue Conn) Fits "B" Or "C" Valve Bodies	1	TBA
435	59928D	Solenoid, Linear "SLS" Shift Pressure (Green Conn) Fits All Early & Late Valve Bodies	1	52-0464
435	59928G	Solenoid, Linear "SLS" Shift Pressure (Green Conn) Fits "B" Or "C" Valve Bodies	1	TBA
NI	K59925D	Solenoid Kit, Linear Fits All Early & Late Valve Bodies (SLU, SLT, SLS & Bracket (Rostra)	1	52-9036
NI	59024	Bushing, Linear Solenoid Inductor Hsg (2ea Per Sol) See Tools Below	2	55526
NI	T31333	Tool, Linear Solenoid Opening & Closing Tool	1	31333
NI	T551580	Reamer, Solenoid Bushing, May Be Needed To "Size" New Bushing After Installation	1	551580
438	59958D	Sensor, AW55-50SN, Input & Output, 2000-Up	2	93191689
438	K59954D	Sensor Set, AW55-50SN (Volvo) Input & Output (W/ Wire Harness & 4 Wire Conn) 2000-Up	1	TBA
438	K59954DA	Sensor Set, AW55-50SN (Volvo) Input & Output (2 Blade Connector) (Wire Harness Is Not Made To Sensors) 2000-Up (Also Fits AW55-50SN (GM, Saturn)	1	TBA
446	59986D	Wire Harness, AW55-50SN (Volvo) Internal/External (With 2 Grey External Conn, One Has 8 Wires And One Has 5 Wires With Pass Thru Case Conn and Internal Conn & Temp Sensor	1	TBA
446	59986G	Wire Harness, AW55-51SN (Volvo) Internal/External (With One Brown 7 Wire And One Grey 6 Wire External Conn)(W/ Pass Thru Case Conn And Internal Conn's W/ Temp Sensor) 00-Up	1	TBA
446	59988D	Wire Harness, AW55-50SN (GM, Saturn) Internal (With 13 Prong Case Connector) 2002-Up	1	TBA

MISCELLANEOUS COMPONENTS

492	59628D	Drain Plug, AW55-50SN/AW55-51SN(Hex Head) 2000-Up	1	TBA
-----	--------	---	---	-----

PUMPS & PUMP COMPONENTS

500	59912D	Pump Assy, .845" ID Bushing, 12-Spring Guide Design (ILL# 510 To #520) 2000-Up	1	TBA
500	59912DB	Pump Assy, .875" ID Bushing, 12-Spring Guide Design (ILL# 510 To #520) 2000-Up	1	TBA
500	59912DA	Pump Assy, .875" ID Bushing, 8-Spring Guide Design (ILL# 510 To #520) 2000-Up	1	TBA
510	59916A	Pump Body, (.422" Thick Gear) (8 Bolt Cast Iron) 2000-Up	1	TBA
520	59915D	Stator, .845" ID Bushing, Has 12-Spring Guide Design 2000-Up	1	TBA
520	59915DB	Stator, .875" ID Bushing, Has 12-Spring Guide Design 2000-Up	1	TBA
520	59915DA	Stator, .875" ID Bushing, Has 8-Spring Guide Design 2000-Up	1	TBA

ILL#	Part#		QTY	REF#
530.....	K59201A.....	Pump Gears, AW55-50SN / AW55-51SN (.422" Thick) 2000-Up.....	1.....	TBA
544.....	59919D.....	Pump Plate, AW55-50SN / AW55-51SN (.060" Thick) (8 7/16" OD) 2000-Up.....	1.....	TBA

DRUMS & PISTON KITS

551.....	59732D.....	Drum, 4-5 Clutch, 50T 1-2 Rev Sun Gear, 32T 4-5 Sun Gear.....	1.....	TBA
554.....	59733D.....	Drum, Fwd & Dir W/ Shaft (20-Spline, .845" ID Bushing, 7 + 3 Lube Holes).....	1.....	TBA
554.....	59733DA.....	Drum, Fwd & Dir W/ Shaft (20-Spline, .845" ID Bushing, 6 + 1 Lube Holes).....	1.....	TBA
554.....	59733E.....	Drum, Fwd & Dir W/ Shaft (20-Spline, .870" ID Bushing, 5 + 5 Lube Holes).....	1.....	TBA
554.....	59733EA.....	Drum, Fwd & Dir W/ Shaft (20-Spline, .870" ID Bushing, 6 + 4 Lube Holes).....	1.....	TBA
554.....	59733EB.....	Drum, Fwd & Dir W/ Shaft (20-Spline, .870" ID Bushing, 8 + 2 Lube Holes).....	1.....	TBA
554.....	59733EC.....	Drum, Fwd & Dir W/ Shaft (20-Spline, .870" ID Bushing, 6 + 1 Lube Holes).....	1.....	TBA
554.....	59733ED.....	Drum, Fwd & Dir W/ Shaft (20-Spline, .870" ID Bushing, 4 + 3 Lube Holes).....	1.....	TBA
561.....	K59762D.....	Piston Kit, AW55-50SN / AW55-51SN 4-5 Clutch 2000-Up.....	1.....	TBA
562.....	K59763D.....	Piston Kit, AW55-50SN 2nd Clutch (With 12 Spring Retainer) 2000-Up.....	1.....	TBA
562.....	K59763G.....	Piston Kit, AW55-51SN 2nd Clutch (With 8 Spring Retainer) 2000-Up.....	1.....	TBA
564.....	K59764D.....	Piston Kit, AW55-50SN Fwd & Dir Clutch (Dir Piston Is .505" Thick At The Edge) 2000-Up.....	1.....	TBA
564.....	K59764G.....	Piston Kit, AW55-51SN Fwd & Dir Clutch (Dir Piston Is .487" Thick At The Edge) 2000-Up.....	1.....	TBA
566.....	K59761D.....	Piston Kit, AW55-50SN / AW55-51SN 1-2 Reverse Clutch 2000-Up.....	1.....	TBA
567.....	K59765A.....	Piston Kit, AW55-50SN Low/Reverse (1.222" Thick x 6 1/4" OD Piston) 15 Spring.....	1.....	TBA
567.....	K59765G.....	Piston Kit, AW55-51SN Low/Reverse Clutch (1.175" Thick) (6 1/4" OD Piston) 2000-Up.....	1.....	TBA
569.....	K59766D.....	Piston Kit, AW55-50SN / AW55-51SN 2nd Coast Clutch 2000-Up.....	1.....	TBA

HUBS, PLANETS, RING GEARS & SUN GEARS

572.....	59740D.....	Hub, AW55-50SN / 51SN 2nd Coast Cl (33T) 2.515" ID (W/ 33 Slots In Teeth) 2000-Up.....	1.....	TBA
579.....	59741D.....	Hub, AW55-50SN With Inner Race (Uses A Metal Washer #211) 2000-Up.....	1.....	TBA
579.....	59741G.....	Hub, AW55-51SN With Inner Race (Uses A Plastic Washer #211) 2000-Up.....	1.....	TBA
584.....	59748D.....	Planet, Rear, AW55-50SN (Uses 2-Pc 25T Sun Gear #614) 2000-Up.....	1.....	TBA
584.....	59748G.....	Planet, Rear, AW55-51SN (Uses 1-Pc 27T Sun Gear #614) 2000-Up.....	1.....	TBA
584.....	K59748D.....	Planet Kit, Rear, 25T Sun Gear W/ 1-Pc Bush Installed (Planet, Ring Gear, Sun Gear, Hub).....	1.....	TBA
584.....	K59748G.....	Planet Kit, Rear, 27T Sun Gear W/ 1-Pc Bushing Installed (Planet, Ring Gear, Sun Gear, Hub).....	1.....	TBA
586.....	59749D.....	Planet, 4-5, AW55-50SN / 51SN (25T, 1-ID Pinion Gear) 2000-Up.....	1.....	TBA
586.....	59749DA.....	Planet, 4-5, AW55-50SN / 51SN (23T, 6-ID Pinion Gear) 2000-Up.....	1.....	TBA
586.....	59749DB.....	Planet, 4-5, AW55-50SN / 51SN (23T, 3-ID Pinion Gear) 2000-Up.....	1.....	TBA
586.....	K59749D.....	Planet Kit, 4-5, (25T, 1-ID Pinion Gear) (Includes: Planet, Ring Gear, Transfer Gear) 2000-Up.....	1.....	TBA
586.....	K59749DA.....	Planet Kit, 4-5, (23T, 6-ID Pinion Gear) (Includes: Planet, Ring Gear, Transfer Gear) 2000-Up.....	1.....	TBA
586.....	K59749DB.....	Planet Kit, 4-5, (23T, 3-ID Pinion Gear) (Includes: Planet, Ring Gear, Transfer Gear) 2000-Up.....	1.....	TBA
587.....	59745D.....	Planet, 1-2/Reverse, AW55-50SN / 51SN (5 Gear, 50T Sun Gear, 1.284" Thk) 2000-Up.....	1.....	TBA
587.....	K59745D.....	Planet Kit, 1-2/Reverse, AW55-50SN / 51SN (5 Gear, 50T Sun Gear, 1.284" Thk) 2000-Up.....	1.....	TBA
592.....	59758D.....	Ring Gear, Rear Planet (Rear) AW55-50SN (83T, 1.105" Thk) 2000-Up.....	1.....	TBA
592.....	59758G.....	Ring Gear, Rear Planet (Rear) AW55-51SN (87T, 1.030" Thk) (2-Snap Rings) 2000-Up.....	1.....	TBA
594.....	59758DA.....	Ring Gear, Rear Planet (Front) AW55-50SN (99T, 2.085" Thk, Sprag Type).....	1.....	TBA
594.....	59758DB.....	Ring Gear, Rear Planet (Front) AW55-51SN (87T, 2.160" Thk, Roller Clutch Type).....	1.....	TBA
596.....	59759D.....	Ring Gear, 4-5 Planet, AW55-50SN / AW55-51SN (67T, 1.198" Thick) 2000-Up.....	1.....	TBA
597.....	59757D.....	Ring Gear, AW55-50SN 1-2 Rev Planet (82T, .120" Deep Bearing Pocket) 2000-Up.....	1.....	TBA
597.....	59757G.....	Ring Gear, AW55-51SN 1-2 Rev Planet (82T, .150" Deep Bearing Pocket) 2000-Up.....	1.....	TBA
602.....	59742D.....	Hub, Rear Ring Gear, AW55-50SN (83-Teeth, Small Type) 2000-Up.....	1.....	TBA
604.....	59743A.....	Ring Gear Hub, AW55-50SN (99-Teeth, Large Type) 2000-Up.....	1.....	TBA
604.....	59743G.....	Ring Gear Hub, AW55-51SN (87-Teeth, Large Type) 2000-Up.....	1.....	TBA
612.....	59756D.....	Sun Gear/Direct Hub, .845" Bushing ID, 2000-Up.....	1.....	TBA
612.....	59756G.....	Sun Gear/Direct Hub, .875" Bushing ID, 2000-Up.....	1.....	TBA
614.....	59759D.....	Sun Gear, Rear (2-Pc 25T Sun Gear, .845 Bushing ID) 2000-Up.....	1.....	TBA
614.....	59759DA.....	Sun Gear, Rear (2-Pc 25T Sun Gear, .875 Bushing ID) 2000-Up.....	1.....	TBA
614.....	59759G.....	Sun Gear, Rear (1-Pc 27T Sun Gear, .845 Bushing ID) 2000-Up.....	1.....	TBA
614.....	59759GA.....	Sun Gear, Rear (1-Pc 27T Sun Gear, .875 Bushing ID) 2000-Up.....	1.....	TBA

SPRAGS & ONE WAY CLUTCHES

652.....	97821A.....	One Way Clutch, 2nd Clutch.....	1.....	TBA
654.....	89724.....	Sprag, Low (20 Elements) (Metal Cage) 2000-Up.....	1.....	TBA
654.....	59727G.....	Roller Clutch, Low (20 Rollers) (Plastic Cage) 2000-Up.....	1.....	TBA
654.....	59727GA.....	Roller Clutch, Low (15 Rollers) 2001-Up.....	1.....	TBA
664.....	59729D.....	Inner Race (Volvo, GM) Low (Lug Type Sprag) 2000-Up.....	1.....	TBA
664.....	59729DA.....	Inner Race (Volvo, Saturn) Low (Roller Type Sprag) 2000-Up.....	1.....	TBA

HARD PARTS

690.....	59824D.....	Parking Gear, AW55-50SN / 51SN (18 Lugs) .513" Thk Lugs (4.883" OD) 2000-Up.....	1.....	TBA
696.....	59943D.....	Crush Sleeve, AW55-50SN / AW55-51SN (.485" Thick) 2.675" OD (2.395" ID) 2000-Up.....	1.....	TBA
696.....	59943B.....	Crush Sleeve, AW55-50SN / 51SN Drive Transfer Brgs (2.108" ID, 480" Thick) 2000-Up.....	1.....	TBA
698.....	59624D.....	Oil Deflector (Volvo) Differential, 4-Bolt, 2-5/8" Tall, Goes In Bell Hsg.....	1.....	TBA

AW 55-50SN, 55-51SN

ILL#	Part#		QTY	REF#
698	59624DA	Oil Deflector (GM) Differential, 4-Bolt, 3-1/2" Tall, Goes In Bell Hsg, 2005-Up.....	1	TBA
698	59624DB	Oil Deflector (Saturn) Diff, 4-Bolt, 2-5/8" Tall, Goes In Bell Hsg (Bottom Bolt Countersunk In Lip).....	1	TBA
699	59625D	Oil Deflector (Volvo) Differential, 2-Bolt, Goes In Case, 2000-Up.....	1	TBA
699	59625DA	Oil Deflector (GM, Saturn) Differential, 3-Bolt, Goes In Case, 2002-Up.....	1	TBA
710	59809D	Gear, Drive Transfer, 56T, 3 Groove, .790" Thk, 2.315" Tall, 20-Splines, 2000-Up.....	1	TBA
711	59638D	Sleeve, 50SN / 51SN Drive Transfer Brg Retainer (3.928" OD, 1.551" Thk) 2000-Up.....	1	TBA
712	59809DA	Gear (Volvo, Saturn) Driven Transfer, 57T, 4 Groove, 6-1/4" OD, 2000-Up.....	1	TBA
712	59810D	Gear (GM) Driven Transfer, 57T, 4 Groove, 2005-Up.....	1	TBA
715	59910	Diff W/Ring Gear, AW55-50SN (Volvo) (61T, 1-Groove) 12 Bolt (24 Roller Brg On Ring Gr Side & 27 Roller Brg On Bell Hsg Side) (Hsg Is 7 1/8" Tall With 4 Windows).....	1	TBA
715	59910A	Differential W/Ring Gear, AW55-51SN (Volvo) (59T, 2-Groove) 12 Bolt (24 Roller Bearing On Ring Gear Side And 27 Roller Brg On Bell Housing Side) 2000-Up.....	1	TBA
715	59910B	Diff W/Ring Gear, AW55-50SN (GM) (61T, 5-Groove) 12 Bolt (24 Roller Brg On Ring Gr Side & 27 Roller Brg On Bell Hsg Side) (Hsg Is 5 1/4" Tall) W/ 4 Windows, 2005-Up.....	1	TBA
715	59910C	Diff W/Ring Gear, AW55-50SN (Saturn) (61T, 3-Groove) 12 Bolt (24 Roller Brg On Ring Gr Side & 27 Roller Brg On Bell Hsg Side) (Hsg Is 8 1/4" Tall W/ 2 Windows) AWD, 02-Up.....	1	TBA
716	59911	Diff Hsg, AW55-50SN / 51SN (Volvo) (12 Bolt) 7 1/8" Tall (24 Roller Brg On Ring Gr Side & 27 Roller Brg On Diff Hsg Side) (With 4 Windows) 2000-Up.....	1	TBA
716	59911A	Differential Hsg, AW55-50SN (GM) 12 Bolt (5 1/4" Tall) (24 Roller Brg On Ring Gear Side & 27 Roller Brg On Differential Hsg Side) (With 4 Windows) 2005-Up.....	1	TBA
716	59911B	Differential Hsg, AW55-50SN (Saturn) 12 Bolt (8 1/2" Tall) AWD (24 Roller Brg On Ring Gear Side & 27 Roller Brg On Diff Side) (With 2 Windows) 2002-Up.....	1	TBA
720	59845	Ring Gear, AW55-50SN Differential (61 Teeth, 1 Groove) (12 Bolt) 2000-Up.....	1	TBA
720	59845A	Ring Gear, AW55-51SN Differential (59 Teeth, 2 Groove) (12 Bolt) 2000-Up.....	1	TBA
730	59846	Pinion Gear, AW55-50SN (25 Teeth, 1 Groove) 1.590" Thick (3.670" OD) 2000-Up.....	1	TBA
730	59846A	Pinion Gear, AW55-51SN (26 Teeth, 2 Groove) 1.590" Thick (3.835" OD) 2000-Up.....	1	TBA

VALVE BODIES (DACCO VB#)

740	AW-2910	Valve Body, AW55, Early GM, Saturn, Saab, 9165 "No" Code.....	1	TBA
740	AW-2911	Valve Body, AW55, Early GM, Saturn, Saab, 9167 "A" Code.....	1	TBA
740	AW-2912	Valve Body, AW55, Late GM, Saturn, Saab, 9168 "B" Code (W/Out B5 Spring) 2004.....	1	TBA
740	AW-2913	Valve Body, AW55, Late GM, Saturn, Saab, 9168 "B" Code (W/ B5 Spring) 2005-Up.....	1	TBA
740	AW-2920	Valve Body, AW55, Early Volvo, 9165 "No" Code.....	1	TBA
740	AW-2921	Valve Body, AW55, Early Volvo, 9165 "C" Code.....	1	TBA
740	AW-2922	Valve Body, AW55, Early Volvo, 9167 "A" Code.....	1	TBA
740	AW-2923	Valve Body, AW55, Late Volvo, 9168 "B" Code (W/Out B5 Spring) 2004-Up.....	1	TBA
740	AW-2930	Valve Body, AW55, Nissan, 9168 "B" Code (W/Out B5 Spring) 2004.....	1	TBA
740	AW-2931	Valve Body, AW55, Nissan, 9168 "B" Code (W/ B5 Spring) 2005-Up.....	1	TBA

VALVE BODIES

740	59747D	Valve Body, AW55-50SN (Volvo) (8 Solenoids) Cast # 9165 (With 2 Black, 2 Blue, 2 Grey And 2 Green Connectors) 2000-Up.....	1	TBA
740	59747G	Valve Body, AW55-51SN (Volvo) (8 Solenoids) Cast # 9167 & 9168 (With 2 Black, 2 Blue, 2 Grey, 1 Green And 1 Red Connector) 2000-Up.....	1	TBA
740	59747DA	Valve Body, AW55-50SN (GM/Saturn) (8 Solenoids) Cast # 9165, 9167, 9168 (With 3 Black, 2 Blue, 1 Grey, 1 Green & 1 Red Connector) 2000-Up.....	1	TBA

VALVE BODY COMPONENTS

741	59947-01K	Valve & Sleeve Kit, AW55-50/51SN Lock-Up Relay Control (Sonnax).....	1	Sonnax
741	59947-05K	Valve & Sleeve Kit, AW55-50/51SN Solenoid Relay (Sonnax).....	1	Sonnax
741	59947-03K	Valve & Sleeve Kit, AW55-50/51SN Lock-Up Control (Sonnax).....	1	Sonnax
741	59947-09K	Valve & Sleeve Kit, AW55-50/51SN Solenoid Module Vlv Capsule Kit (Vlv, Sleeve, Spring).....	1	Sonnax
741	59947-12K	Valve & Sleeve Assembly, AW55-50/51SN Oversized Press Regulator Valve & Spring With Main Boost Valve & Sleeve) Requires Tool F-59947-TL12 And VB-FIX.....	1	Sonnax
741	59947-07K	Valve & Sleeve Kit, AW55-50/51SN Main Boost (Sonnax).....	1	Sonnax
741	59947-16K	Valve & Spring Kit, AW55-50/51SN Secondary Reg Vlv, Req: F-59947-TL16 & VB-FIX.....	1	Sonnax
741	59947-21K	Kit, AW55-50/51SN O-Ringed End Plug Kit (4-Sm, 1-Lrg End Plug, 6-Sm, 2 Lrg O-Ring s).....	1	Sonnax
741	59947-26K	Kit, AW55-50/51SN B4 Release Valve, Req: F-59947-TL26 & VB-FIX.....	1	Sonnax
741	59947-LPC	Kit, AW55-50/51SN LPC(Line Press) Accum Piston Kit (1-Piston, 2-Springs, 2-O-Rings).....	1	Sonnax

COVERS, HOUSINGS & PANS

746	59708D	Cover, AW55-50SN / 51SN VB (2 Bolt, Aluminum) Cast #35475-50A010, 2000-Up.....	1	TBA
750	59703D	Bell Housing, AW55-50SN (Volvo) (5" Top Bolts) 2.958" OD Axle Seal (4 1/2" Thick) W/ 8 Threaded Holes Around Axle Seal (Cast # 9165) (Starter At 2:00) 2000-Up.....	1	TBA
750	59703G	Bell Hsg, (Volvo) (3" Top Bolts) 2.480" OD Axle Seal (4 7/8" Thk) Uses External Oil Cooler.....	1	TBA
750	59703DA	Bell Housing, AW55-50SN (GM) (5" Top Bolts) (2.145" OD Axle Seal)(4 11/16" Thick) (With 4 Threaded Holes Around Axle Seal) (Cast # 9191) (Starter At 3:00) 2005-Up.....	1	TBA
750	59703DB	Bell Housing, AW55-50SN (Saturn) (5" Top Bolts) (2.400" OD Axle Seal) 5" Thick.....	1	TBA

ILL#	Part#		QTY	REF#
		(With 6 Threaded Holes Around Axle Seal) (Cast # 9194) (Starter At 4:00) 2002-Up		
759.....	59704D.....	Rear Cover (Volvo, GM, Saturn) 12-Bolt (.735" OD Brg #223) No Threaded Bosses At 12:00.....	1.....	TBA
759.....	59704DA.....	Rear Cover (Volvo, GM, Saturn) 12-Bolt (.735" OD Brg #223) 3-Threaded Bosses At 12:00.....	1.....	TBA
759.....	59704G.....	Rear Cover (Volvo) 12-Bolt (.835" OD Brg #223) 3-Threaded Bosses At 12:00.....	1.....	TBA
759.....	59704GA.....	Rear Cover (Volvo) 12-Bolt (.835" OD Brg #223) No Threaded Bosses At 12:00.....	1.....	TBA
760.....	59701D.....	Case (Volvo) Black Tag) 3-Threaded Bosses Above Axle Seal, 1-Big Boss On Linkage Side.....	1.....	TBA
760.....	59701G.....	Case, AW55-51SN (Volvo) (Red Tag) 2000-Up (These Cases Are Sleeved).....	1.....	TBA
760.....	59701DA.....	Case (GM) (Brown Tag) No Bosses Above Axle Seal, 3-Bosses Same Height Linkage Side.....	1.....	TBA
760.....	59701DB.....	Case (Saturn) (Tan Tag) No Bosses Above Axle Seal, 3-Bosses One Taller On Linkage Side.....	1.....	TBA
760.....	59701DC.....	Case (Saab) (Yellow Tag) (These Cases Are Sleeved).....	1.....	TBA
760.....	59701GA.....	Case, Nissan, 13-Bolt Rear Cover.....	1.....	TBA
760.....	59701F.....	Case, Volvo, 13-Bolt Rear Cover.....	1.....	TBA
766.....	59803D.....	Pan (Volvo) Side (9 Bolt) (With Screw In Vent Fitting) 2000-Up.....	1.....	TBA
766.....	59803G.....	Pan (Volvo) Side (9 Bolt) (With Welded On Vent Tube) 2000-Up.....	1.....	TBA
766.....	59803DA.....	Pan (GM) Side (9 Bolt No Vent) 2005-Up.....	1.....	TBA
789.....	59086D.....	Bolt, AW55-51SN Holds Oil Cooler To Bell Housing 2000-Up.....	1.....	TBA
795.....	59081D.....	Nut, AW55-50SN / 51SN Drive Transfer (2.375" At Flats) Right Hand Threads, 2.000" ID.....	1.....	TBA
796.....	59082D.....	Nut, AW55-50SN / AW55-51SN Holds Pinion To 4-5 Planet Shaft (.965" ID) 2000-Up.....	1.....	TBA
854.....	59142D.....	Cushion, AW55-50SN / 51SN 1-2 Rev Clu (.041" Thick) 4.985" ID, 5.630" OD, 2000-Up.....	1.....	TBA
858.....	59143D.....	Cushion, AW55-50SN Direct Clutch (.032") 4 Teeth, Dished (3.600" ID) 2000-Up.....	1.....	TBA
SNAP RINGS				
NI.....	K59928D.....	Kit, Snap Ring, AW55-50/51 1989-Up.....	1.....	TBA
864.....	59602D.....	Snap Ring, AW55-50/51, Holds 4-5 Clutch Press Plate In Drum.....	1.....	TBA
865.....	59603D.....	Snap Ring, AW55-50/51, Holds 4-5 Clutch Return Spring In Drum.....	1.....	TBA
868.....	59604D.....	Snap Ring, AW55-50/51, Holds 4-5 Planet Ring Gear To Driven Transfer Gear.....	1.....	TBA
869.....	59605D.....	Snap Ring, AW55-50/51, Holds Driven Transfer Gear Cup Races Apart.....	1.....	TBA
870.....	59606.....	Snap Ring, AW55-50/51, 2nd Coast Clutch (4.562" OD).....	1.....	TBA
871.....	59607.....	Snap Ring, AW55-50/51, 2nd Coast Clutch (2.025" OD).....	1.....	TBA
873.....	59608.....	Snap Ring, AW55-50/51, Holds 2nd Brake Clutch Press Plate In.....	1.....	TBA
874.....	59609D.....	Snap Ring, AW55-50/51, Holds 2nd Clutch Press Piston Insert In Stator.....	1.....	TBA
876.....	59610D.....	Snap Ring, AW55-50/51, Holds Forward Clutch Return Spring In Drum.....	1.....	TBA
878.....	59606.....	Snap Ring, AW55-50/51, Direct Clutch.....	1.....	TBA
879.....	59611.....	Snap Ring, AW55-50/51, Forward & Direct Clutch Retainer.....	1.....	TBA
882.....	59612D.....	Snap Ring, AW55-50/51, Holds Rear Ring Gear Hub To Ring Gear.....	1.....	TBA
883.....	59613.....	Snap Ring, AW55-50/51, Retainer To Case.....	1.....	TBA
884.....	59614.....	Snap Ring, AW55-50/51, Low/Rev Retainer.....	1.....	TBA
885.....	59615D.....	Snap Ring, AW55-50/51, Holds Low/Rev Clutch Press Plate In Case.....	1.....	TBA
886.....	59616D.....	Snap Ring, AW55-50/51, Holds Low Sprag To Ring Gear.....	1.....	TBA
888.....	59618D.....	Snap Ring, AW55-50/51, Holds Sun Gear In Planet.....	1.....	TBA
889.....	59617.....	Snap Ring, AW55-50/51, Hub To Ring Gear.....	1.....	TBA
892.....	59619D.....	Snap Ring, AW55-50/51, Holds 1-2/Rev Clutch Press Plate In.....	1.....	TBA
893.....	59620D.....	Snap Ring, AW55-50/51, Holds 1-2/Rev Clutch Spring Retainer.....	1.....	TBA
PISTONS, RETAINERS & LINKAGE				
NI.....	K59928F.....	Kit, Snap Ring, AW55-50SN / AW55-51SN.....	1.....	TBA
905.....	K59998D.....	Servo Assy, 3rd Gear Band (W/ 7/8" Thk Cover) (W/ 2-Stripe Pin).....	1.....	TBA
905.....	K59998DA.....	Servo Assy, 3rd Gear Band (W/ 2 1/2" Thk Cover) (W/ 1-Stripe Pin).....	1.....	TBA
905.....	K59998DB.....	Servo Assy, 3rd Gear Band (W/ 7/8" Thk Cover) (W/ 1-Stripe Pin).....	1.....	TBA
907.....	59998F.....	Servo Piston, 3rd, Except Nissan, No-ID Groove On Shaft, 01-Up.....	1.....	24220756
907.....	59998FA.....	Servo Piston, 3rd, Except Nissan, 1-ID Groove On Shaft, 01-Up.....	1.....	24220757
907.....	59998FB.....	Servo Piston, 3rd, Except Nissan, 2-ID Groove On Shaft, 01-Up.....	1.....	24220758
907.....	59998FC.....	Servo Piston, 3rd, Except Nissan, 3-ID Groove On Shaft, 01-Up.....	1.....	24220759
907.....	59998FD.....	Servo Piston, 3rd, Except Nissan, 4-ID Groove On Shaft, 01-Up.....	1.....	24220760
907.....	59998G.....	Servo Piston, 3rd, Nissan, No-ID Groove On Shaft, 01-Up.....	1.....	31615-84001
907.....	59998GA.....	Servo Piston, 3rd, Nissan, 1-ID Groove On Shaft, 01-Up.....	1.....	31615-84002
907.....	59998GB.....	Servo Piston, 3rd, Nissan, 2-ID Groove On Shaft, 01-Up.....	1.....	31615-84003
907.....	59998GC.....	Servo Piston, 3rd, Nissan, 3-ID Groove On Shaft, 01-Up.....	1.....	31615-84004
907.....	59998GD.....	Servo Piston, 3rd, Nissan, 4-ID Groove On Shaft, 01-Up.....	1.....	31615-84005
909.....	59560D.....	Cover, 3rd Servo, GM/Saturn, Includes: Cover, O-Rings & Snap-Ring.....	1.....	24228347
909.....	59560F.....	Cover, 3rd Servo, Volvo/Saab, Updated Fix, Includes: Cover, O-Rings & Snap-Ring.....	1.....	30651771
916.....	59621D.....	Band Anchor, AW55-50SN / AW55-51SN 3rd Gear (With 5 Sided Head) 2000-Up.....	1.....	TBA
930.....	K59997D.....	Accum Assy, AW55-50SN / AW55-51SN Fwd & Dir Cl (Piston Is .800" OD) 2000-Up.....	1.....	TBA
961.....	59762D.....	Piston, AW55-50SN / AW55-51SN 4-5 Clutch (.475" Thick At The Edge) (4.500" OD).....	1.....	TBA
		(1.970" ID) With Check Ball & 18 Spring Pockets 2000-Up.....		
962.....	59763D.....	Piston, 2nd Clutch (Alum) .492" Thick, 5.590" ID, 6 1/4" OD (No Inner O-Ring Groove) 2000-Up.....	1.....	TBA
962.....	59763DA.....	Piston Insert, 2nd Clu (.315" Thk) 4.895" ID (5.580" OD) 2000-Up.....	1.....	TBA
962.....	59763DB.....	Piston Insert, 2nd Clu (.310" Thk) 4.895" ID (5.580" OD) 2000-Up.....	1.....	TBA

AW 55-50SN, 55-51SN

ILL#	Part#		QTY	REF#
964.....	59764D.....	Piston, Forward Clu (1.850" Thk At Edge) (W/ 2 Check Balls) 2000-Up	1	TBA
964.....	59764G.....	Piston, Forward Clu (1.790" Thick At Edge) (W/ 2 Check Balls) 2000-Up.....	1	TBA
965.....	59760D.....	Piston, Direct Cl (Alum) .505" Thk At Edge (W/ Check Ball, 16 Spring Pockets)	1	TBA
965.....	59760G.....	Piston, AW55-51SN Dir Cl (Alum) .487" Thk At Edge (W/ Check Ball, 16 Spring Pockets)	1	TBA
966.....	59761D.....	Piston, 50SN / 51SN 1-2 Rev Cl (.425" Thk At Edge) 2.725" ID, 5.505" OD, 22 Pockets	1	TBA
967.....	59765A.....	Piston, AW55-50SN Low/Reverse Clutch (1.222" Thick) (6 1/4" OD) 2000-Up.....	1	TBA
967.....	59865G.....	Piston, AW55-51SN Low/Reverse Clutch (1.175" Thick) (6 1/4" OD) 2000-Up.....	1	TBA
969.....	59766D.....	Piston, 50SN / 51SN 2nd Coast Cl (Alum) (.500" Thk) 2.035" ID, 4.24" OD, 15 Pockets.....	1	TBA
976.....	59871D.....	Retainer W/Springs, 1-2 Reverse Cl Return (22 Springs) 2.68" ID, 3.988" OD.....	1	TBA
981.....	59872D.....	Retainer W/Springs, 4-5 Clutch Ret (18 Springs) .792" Thk, 3.105" OD, 1.93" ID	1	TBA
982.....	59873D.....	Retainer W/Springs, AW55-50SN 2nd Brake Clutch (12 Springs) 4.875" ID (5.800" OD).....	1	TBA
982.....	59873G.....	Retainer W/Springs, AW55-51SN 2nd Clutch (8 Springs) 4.875" ID (5.800" OD) 2000-Up	1	TBA
985.....	59874.....	Retainer W/Springs, 50SN / 51SN Fwd & Dir Cl Ret(16 Springs) .950, 3.125" OD, 1.84" ID.....	1	TBA
987.....	59875.....	Retainer W/Springs, AW55-50SN / 51SN Low/Rev Cl (.775" Thk, 6/5/16" OD) 15 Springs	1	TBA
989.....	59876.....	Retainer W/Springs, AW55-50SN / 51SN 2nd Coast Cl (1.84" ID, 3.14" OD, 15 Springs).....	1	TBA
991.....	K59631D.....	Linkage Assembly, AW55-50SN / AW55-51SN (Internal) (5 Pieces) 2000-Up	1	TBA
995.....	K59824D.....	Park Pawl Assembly, AW55-50SN / AW55-51SN (6 Pieces) 2000-Up.....	1	TBA
998.....	59480D.....	Oil Cooler, AW55-51SN External (1 Bolt) (3 7/8" OD) 2000-Up.....	1	TBA
999.....	K59637D.....	Oil Tube Set, AW55-50SN / AW55-51SN (3 Pieces) 2000-Up	1	TBA

